

EAGLE PEAK GH24-GRN-CA

EAGLE PEAK 6x4 Portable Walk-in Greenhouse Instruction Manual

Brand: EAGLE PEAK

Model: GH24-GRN-CA

IMPORTANT SAFETY INFORMATION

This greenhouse contains metal components that may have sharp edges. Handle with care during assembly and use. Some components may be heavy, so use caution when moving or positioning them. Always anchor the greenhouse securely to the ground to prevent damage or injury. Failure to follow these precautions may result in property damage, personal injury, or voided warranty.

SETUP INSTRUCTIONS

The EAGLE PEAK 6x4 Portable Walk-in Greenhouse features an innovative easy setup technology, allowing for quick assembly, often by a single person, without the need for additional tools. The pre-assembled frame simplifies the process significantly.

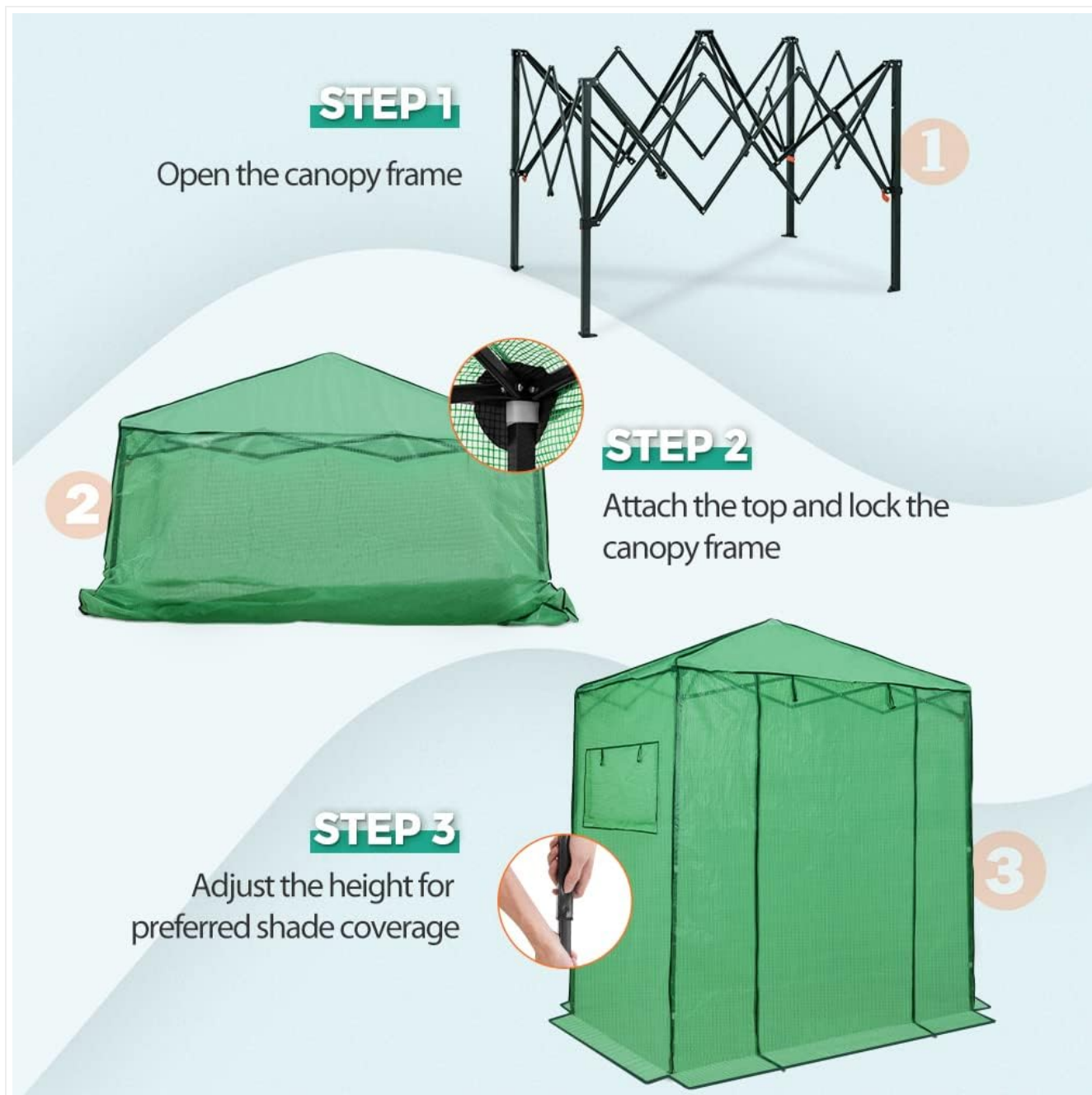

Image: Step-by-step guide for setting up the greenhouse frame and attaching the cover.

1. **Step 1: Open the Canopy Frame.** Carefully unfold the pre-assembled frame until it is fully extended. Ensure all joints are aligned.
2. **Step 2: Attach the Top and Lock the Canopy Frame.** Drape the PE cover over the opened frame. Secure the cover to the frame, ensuring it is properly aligned. Push up on the center lock mechanism until it clicks into place, securing the frame.
3. **Step 3: Adjust the Height for Preferred Shade Coverage.** Locate the leg sliders on each leg. Raise or lower the legs to your desired height, ensuring the red button is pressed to release and lock the legs into one of the three available height settings.

EASY SETUP

With pre-assembled frame



Image: Detailed view of the locking, unlocking, and height adjustment mechanisms on the greenhouse legs.

For optimal stability, especially in outdoor conditions, ensure the greenhouse is securely anchored to the ground using the provided ropes and stakes. This prevents movement and potential damage from wind.

OPERATING YOUR GREENHOUSE

The EAGLE PEAK greenhouse is designed to create an ideal environment for your plants, vegetables, and fruits to flourish. Its features allow for easy access and ventilation control.

- **Access and Ventilation:** The greenhouse features zippered roll-up doors on both ends, providing convenient access and allowing for cross-ventilation. Additionally, two mesh windows are included to further enhance airflow and temperature regulation.
- **Internal Space:** With a spacious 6x4 ft walk-in design, the greenhouse offers ample room for movement and accommodates shelving comfortably for organizing your plants.
- **Environmental Control:** The PE cover helps maintain a warm and stable environment, protecting plants from adverse

weather conditions. Utilize the zippered doors and mesh windows to manage internal temperature and humidity levels as needed for your specific plants.



Image: Key features of the greenhouse, including zippered doors, mesh windows, and reinforced construction.

MAINTENANCE

Proper maintenance will extend the lifespan of your EAGLE PEAK greenhouse and ensure its continued performance.

- **Cleaning:** The PE cover can be cleaned with mild soap and water. Avoid harsh chemicals or abrasive materials that could damage the film. Rinse thoroughly and allow to air dry completely before folding or storing.
- **Anchoring:** Regularly check the security of the anchoring system, including ropes and stakes. Re-secure or adjust as necessary, especially after strong winds or heavy rainfall. Consider additional anchoring methods for increased stability in high-wind areas.
- **Snow and Ice Accumulation:** In areas prone to snowfall or freezing rain, it is crucial to regularly remove snow and ice from the greenhouse roof and cover to prevent excessive weight accumulation. This helps protect the frame and cover

from damage.

- **Storage:** When not in use, or during extreme weather conditions, the greenhouse can be easily taken down and stored. Ensure the cover is clean and dry before folding to prevent mold or mildew. Store the frame and cover in a cool, dry place.

TROUBLESHOOTING

This section addresses common issues you might encounter with your greenhouse.

Problem	Possible Cause	Solution
Greenhouse instability / Tipping over	Insufficient anchoring; strong winds; heavy snow/ice accumulation.	Ensure all ropes and stakes are securely fastened. Consider using heavier-duty stakes or additional anchoring methods in windy areas. Regularly remove snow and ice from the roof.
Tears or damage to PE cover	Sharp objects; excessive tension during setup; prolonged exposure to extreme weather; cover caught in sliding joints during setup.	Handle cover with care. Ensure frame is fully open and aligned before pulling cover over. Repair small tears with appropriate repair tape or glue for polyethylene. Contact customer service for replacement covers if damage is extensive.
Difficulty with frame extension/retraction	Joints are stiff or misaligned; debris in mechanisms.	Ensure all release buttons are fully pressed. Gently wiggle joints to align. Clean any debris from the sliding mechanisms. Apply a silicone-based lubricant if necessary.

SPECIFICATIONS

Feature	Detail
Model Number	GH24-GRN-CA
Product Dimensions	72 x 48 x 88.8 inches (6'L x 4'W x 7.4'H)
Item Weight	22.3 pounds
Cover Material	Reinforced Polyethylene Film (PE Film - Green/Clear)
Frame Material	Alloy Steel
Closure Type	Zipper (Roll Up Doors)
Number of Doors	2
Number of Vents	2 (Mesh Windows)
Indoor/Outdoor Usage	Outdoor

Feature	Detail
Color	Green
UPC	688397976858

WARRANTY AND SUPPORT

EAGLE PEAK offers a **1-year limited after-sale protection** from the original date of purchase. This warranty covers both the frames and the tops of our products. For any questions, concerns, or support needs, please contact our professional service team. We are committed to providing reliable American support for our products.

For further assistance, please visit the [EAGLE PEAK Store](#) or refer to your purchase documentation for specific contact details.