



[Manuals.plus](#) /

› [Diginex](#) /

› HFeng Diginex IP68 Waterproof RFID Access Control Keypad System User Manual

Diginex 1

HFeng Diginex IP68 Waterproof RFID Access Control Keypad System User Manual

1. INTRODUCTION

This manual provides detailed instructions for the installation, programming, and operation of your HFeng Diginex IP68 Waterproof RFID Access Control Keypad System. This robust system is designed for outdoor use, featuring IP68 waterproofing and a touch key-press panel. It supports multiple access methods including RFID card, password, and a combination of both, with a memory capacity for up to 3000 users. Please read this manual thoroughly before installation and use to ensure proper functionality and safety.

2. PRODUCT FEATURES

- IP68 Waterproof/Rainproof design, suitable for outdoor installation.
- High-quality material with a responsive touch key-press panel.
- Memory capacity for up to 3000 user cards.
- Supports multiple identification methods: RFID Card, password, or RFID Card + password.
- Full programming directly from the keypad, including setting a management card.
- Features a blue backlight for clear visibility of digits in low-light conditions.
- Equipped with WG26/34 Wiegand signal input/output for connecting an extra card reader.
- Includes a doorbell button for connecting to an external doorbell.
- Operates independently without requiring a computer connection.
- Designed to work with a DC12V power system.

3. PACKAGE CONTENTS

- 1x RFID Waterproof Keypad
- 10x RFID Blue Color Key Fobs
- Mounting Screws and Wall Plugs

4. SPECIFICATIONS

Feature	Specification
User Capacity	3000
Material	ABS High Quality Material
Panel Type	Touch Screen Panel
Waterproof Level	IP68 (Suitable for outdoor installation)
Working Frequency	125KHz
Card Reading Type	Support EM Compatible Card
Card Reading Distance	0-10CM
Identification Method	Card, Password, Card + Password
Backlight	Blue Backlight
Doorbell Button	Support Wired Doorbell
Wiegand Signal	WG26/34 Input/Output
Management Card	Supported
Working Voltage	DC 12V
Working Current	≤ 30mA
Door Opening Time	0-255 Seconds
Operating Temperature	-20 °C ~ 70 °C
Working Humidity	20% ~ 90%
Product Dimensions	140 x 70 x 16mm (5.51 x 2.76 x 0.63 inches)
Item Weight	8.4 ounces



Image: Detailed dimensions of the access control keypad, showing length, width, and thickness.

5. SETUP AND INSTALLATION

5.1 Wiring Diagram

Proper wiring is crucial for the functionality of the access control system. Refer to the diagram below for connecting the keypad to the power supply, lock, and exit button. Note that the power supply, locks, and door exit button are not included in the package and must be purchased separately.

Wiring Diagram

Note: The power supply, locks, door exit button are not included in the package, need to buy extra.

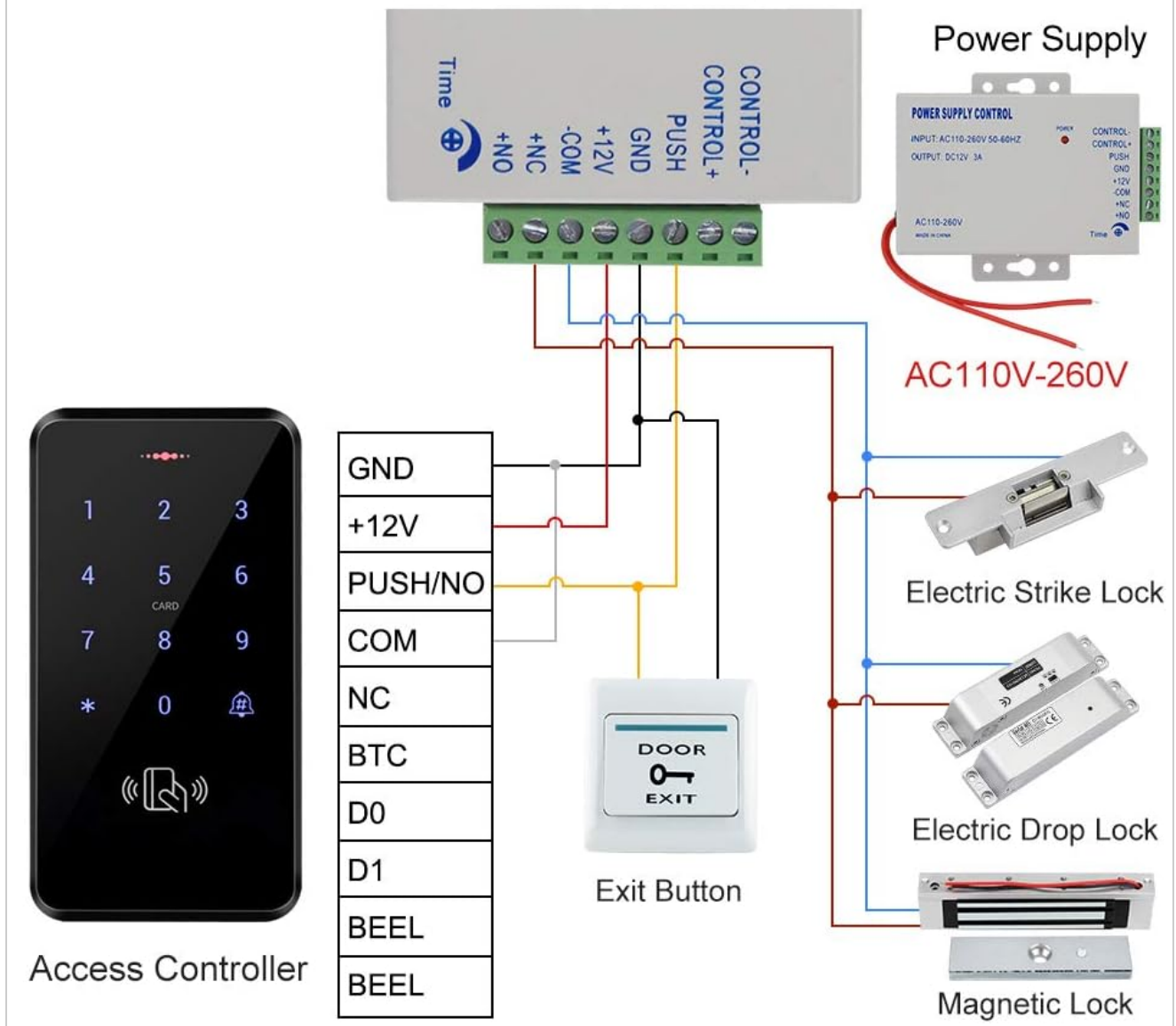

Image: A detailed wiring diagram illustrating connections between the access controller, power supply, electric strike lock, electric drop lock, magnetic lock, and exit button.

5.2 Mounting the Keypad

The keypad is suitable for various door types including wooden, glass, and iron doors. Ensure the mounting surface is stable and secure. Use the provided screws and wall plugs for installation.

Suitable for wooden doors, glass doors, iron doors etc

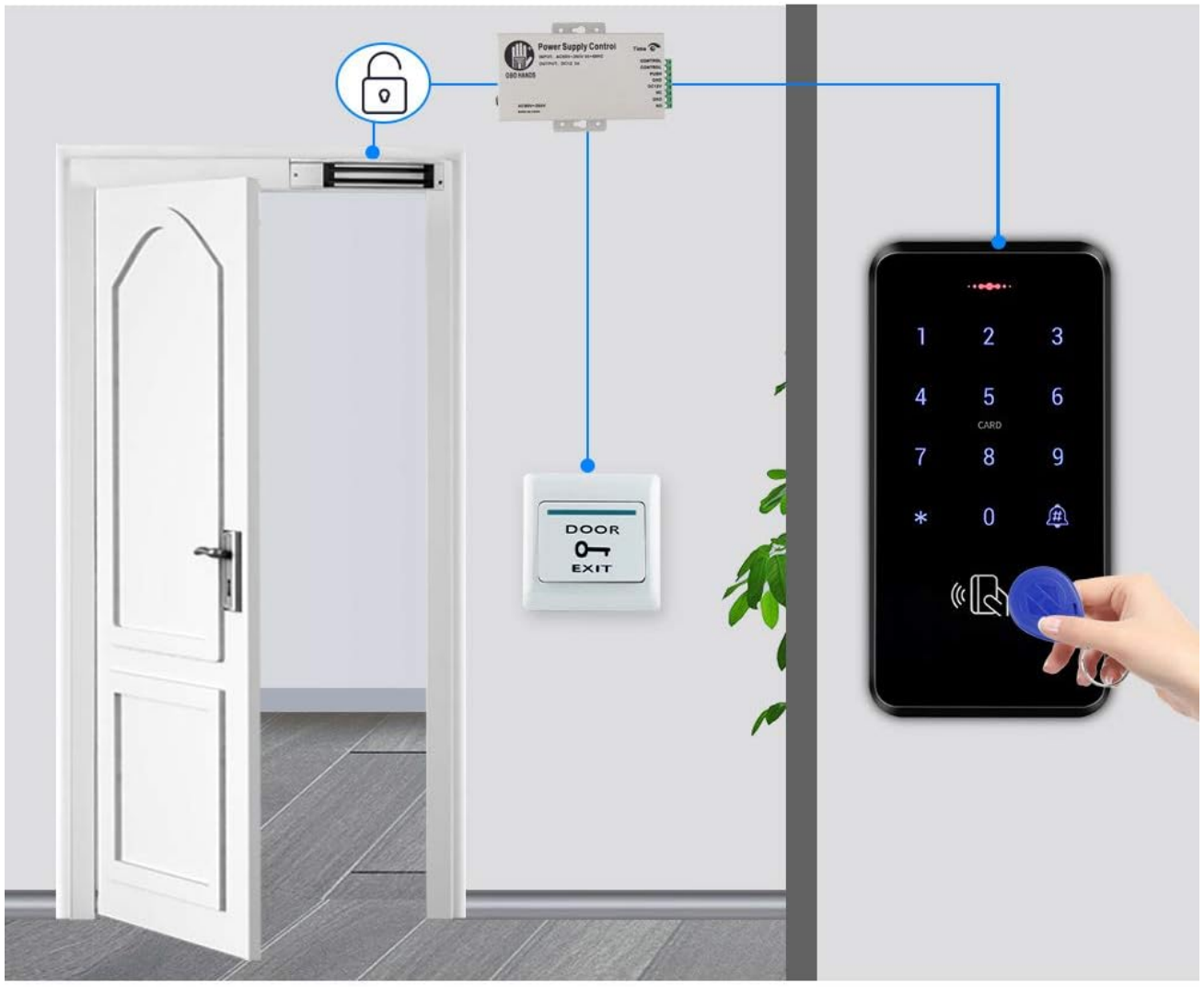

Image: An access control keypad mounted on a door, demonstrating its application in various settings.

6. OPERATING INSTRUCTIONS

6.1 Basic Keypad Functions

The keypad features a touch-sensitive interface and a blue backlight for ease of use in any lighting condition. It also includes a dedicated doorbell button.



Image: A hand interacting with the touch keypad, highlighting the numbers and the doorbell button.

Support backlight function

Can see the digits number clearly even at dark

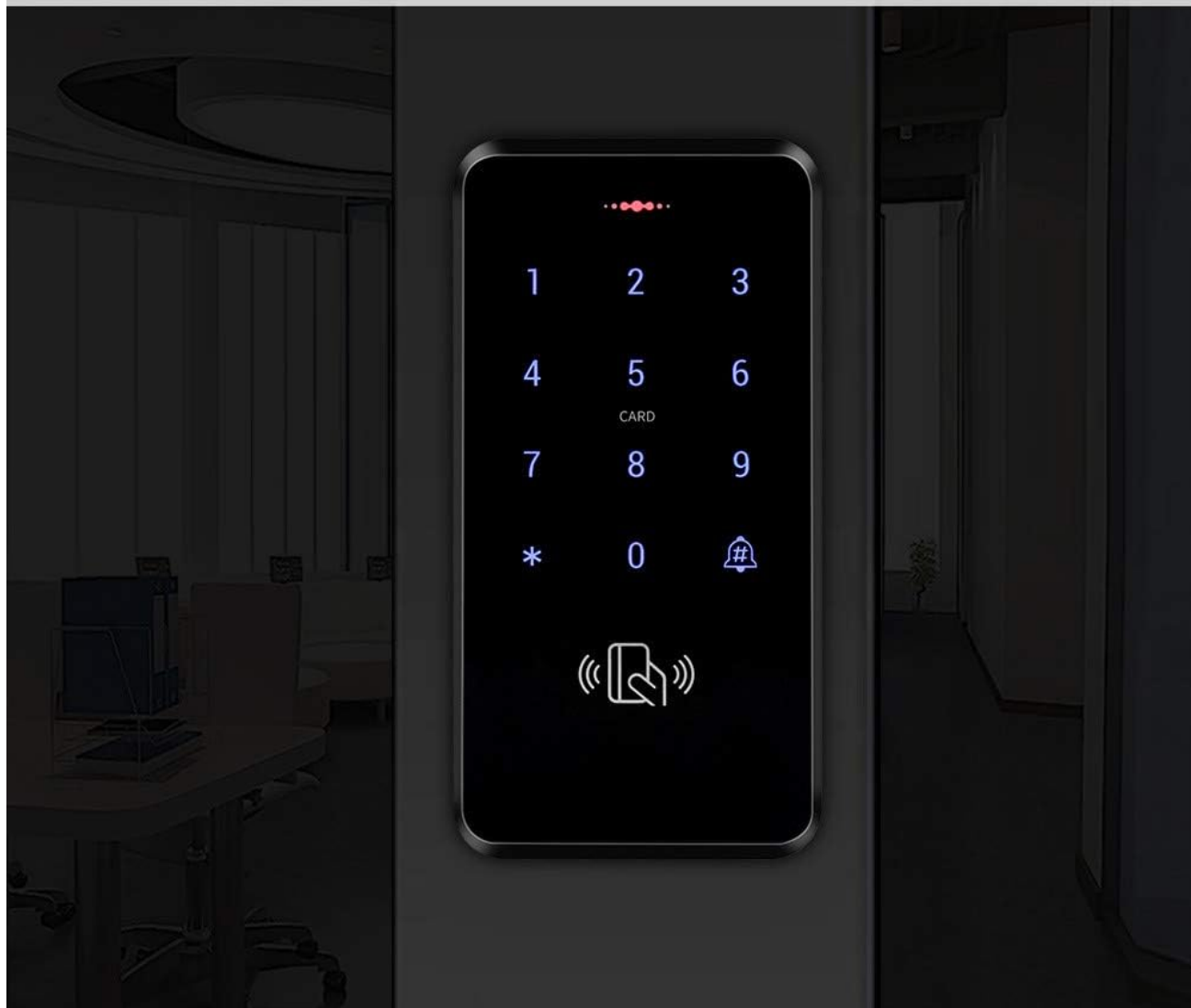

Image: The access control keypad displaying its blue backlight function, making digits clearly visible in the dark.

6.2 Adding Users (Cards and PINs)

The system allows for adding users via RFID cards, PIN codes, or a combination of both. Follow the programming steps outlined in the included Product User Manual for detailed instructions on adding and managing users.

Support RFID Card, password, RFID card + password to open the door



Image: Visual representation of the three supported access methods: RFID card, password, and RFID card + password.

Video: Enroll Card/Fob PIN Code for Magnetic Lock System

Video Description: This video demonstrates the process of enrolling RFID cards and PIN codes for use with a magnetic lock system, providing a visual guide for adding new users.

Video: How to Add User Code

Video Description: A step-by-step guide on how to add a new user code to the access control keypad, ensuring secure and personalized access.

Video: How to Add Users with Retekess T-AC03 (Similar Functionality)

Video Description: This video, though for a similar model (Retekess T-AC03), illustrates the general procedure for adding users to an access control system, which can be applied to this product.

6.3 Unlocking Methods

Users can unlock the door using their registered RFID card, PIN code, or through a connected mobile application.

Video: How to Use Retekess T-AC03 to Open the Door (Similar Functionality)



Video Description: This video demonstrates how to open a door using an access control system, applicable to the general operation of this keypad.

Video: How to Connect Tuya APP Operation



Video Description: This video guides users through the process of connecting the access control keypad to the Tuya mobile application for remote operation and management.

Video: Smart Door Access Control Keypad Tuya App Remote Control



Video Description: This video showcases the remote control capabilities of the smart door access control keypad via the Tuya app, including unlocking and managing access.

7. MAINTENANCE

The HFeng Diginex keypad is designed with an IP68 waterproof rating, ensuring durability against rain and harsh weather conditions. Regular cleaning with a soft, damp cloth is recommended to maintain its appearance and touch sensitivity. Avoid using abrasive cleaners or solvents.

IP68 WATERPROOF



Image: The access control keypad shown under a stream of water, highlighting its IP68 waterproof feature for outdoor resilience.

8. TROUBLESHOOTING

- **Keypad not responding:** Check power connections and ensure the keypad is receiving adequate power (DC12V).
- **Card not reading:** Ensure the RFID card is 125KHz EM compatible. Try swiping the card closer to the keypad. Verify the card is properly enrolled.
- **PIN code not working:** Double-check the entered PIN code. Ensure the user is correctly programmed.
- **Lock not engaging/disengaging:** Verify all wiring connections to the lock and power supply are secure. Check the lock's functionality independently if possible.
- **Doorbell not ringing:** Confirm the external doorbell is correctly wired to the keypad's doorbell terminals.
- **App connection issues:** Ensure the keypad is in pairing mode and your Wi-Fi network is stable. Refer to the Tuya app's troubleshooting guide.

9. WARRANTY AND SUPPORT

Information regarding specific warranty terms and conditions for this product is not provided in the available product details. For warranty claims, technical support, or further assistance, please contact your retailer or the manufacturer directly. Keep your purchase receipt as proof of purchase.