



---

[Manuals.plus](#) /

› [URAQT](#) /

› URAQT Star Projector Night Light U4-LQDD0715-FBA Instruction Manual

## URAQT U4-LQDD0715-FBA

# URAQT Star Projector Night Light

Model: U4-LQDD0715-FBA

---

## INTRODUCTION

---

This manual provides instructions for the safe and effective use of your URAQT Star Projector Night Light. Please read this manual thoroughly before operation and retain it for future reference.

## PACKAGE CONTENTS

---

- 1 x Star Projector Night Light
- 1 x USB Charging Cable
- 1 x Remote Control
- 6 x Projection Films (Themes: Confession of Lovers, Ocean, Birthday, Starry Sky, Christmas, Constellation)
- 1 x Instruction Manual



Image: Contents of the URAQT Star Projector Night Light package, showing the main unit, remote control, USB cable, and a set of projection films.

## PRODUCT OVERVIEW

The URAQT Star Projector Night Light features multiple projection themes, built-in music, adjustable brightness, and a 360° rotation function. It can be used as a projector or a standard night light.



Image: The URAQT Star Projector Night Light displaying multiple projection themes in a bedroom setting, alongside its remote control.

## Main Unit Controls

Refer to the image below for the location of controls on the projector unit.



Image: Close-up of the projector's base, showing the ON/OFF button, music ON/OFF switch, rotation ON/OFF switch, and USB charging port. Also shows the remote control layout and projection films.

- **Power Button:** Turns the projector on or off.
- **Music ON/OFF Switch:** Activates or deactivates the built-in music.
- **Rotation ON/OFF Switch:** Controls the 360° rotation of the projection.
- **Charge Port:** USB port for charging the device.

## Remote Control Functions

The remote control allows for convenient operation from a distance.

- **Lighting Up / Dimming:** Adjusts projection brightness.
- **OFF / ON:** Power on/off the light.
- **W / Y / B / ALL:** Selects white, yellow, blue, or all three colors for projection.
- **Light Mode Switch:** Cycles through different light effects.
- **Music ON/OFF:** Toggles music playback.
- **Rotary ON/OFF:** Starts or stops the 360° rotation.

- **Timing Switch (15 / 30 minutes):** Sets an automatic shut-off timer.
- **Volume Adjustment (+ / -):** Increases or decreases music volume.
- **Switch Music (1-8):** Selects specific built-in music tracks.

## SETUP

---

### Charging the Device

Before first use, fully charge the projector. Connect the provided USB cable to the charge port on the projector and to a standard USB power adapter (not included). The charging time is approximately 2 hours. A full charge provides several hours of operation.

### Installing Projection Films

The projector comes with multiple projection films. Follow these steps to install them:

1. Open the dome by gently twisting and lifting it off the base.
2. Select a projection film. Loop the side film into the cylindrical inner part of the projector.
3. Place the circular film on the inner top of the projector.
4. Close the dome by aligning it and twisting it back into place.



1. Open the dome



2. Loop the side film.



3. Put it into lamp



4. Put the circular film on the inner top.



5. Start projecting the light.



6. Close the dome and projecting

Image: Six panels illustrating the process of opening the projector dome, inserting the side film, placing the top circular film, and closing the dome to prepare for projection.

### Using as a Night Light

To use the device as a standard night light without projection, ensure the dome is closed and the black film (if any) is removed, allowing the white shade to diffuse light.

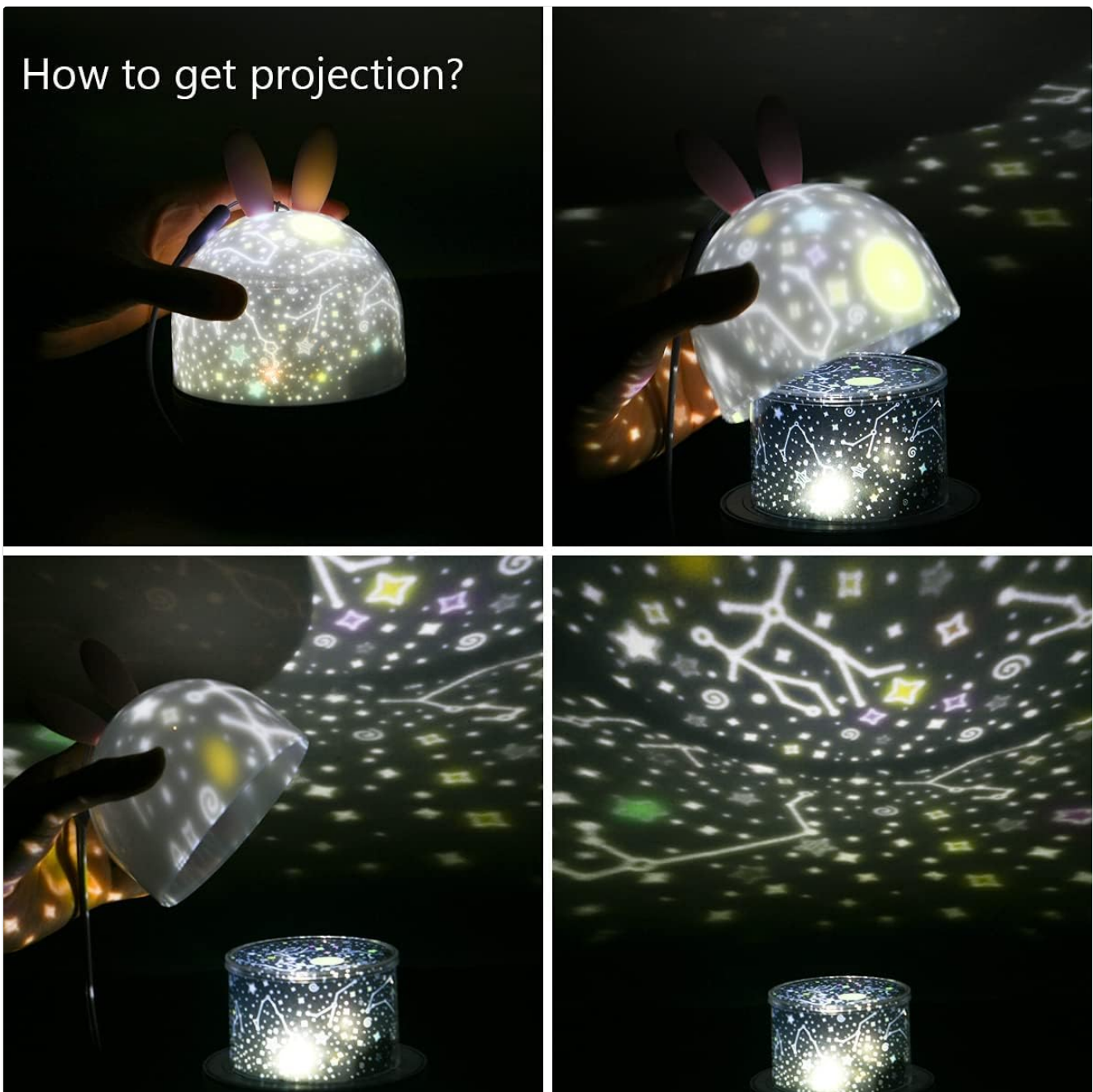

Image: Four panels demonstrating how to remove the outer white dome to enable projection, and how to place it back on for night light mode.

## OPERATING INSTRUCTIONS

---

### Power On/Off

Press the Power Button on the unit or the ON/OFF button on the remote control to turn the projector on or off.

### Adjusting Light Modes and Colors

Use the W, Y, B, or ALL buttons on the remote control to select white, yellow, blue, or a combination of these colors. The Light Mode Switch button cycles through different light effects.



White Light



Yellow Light

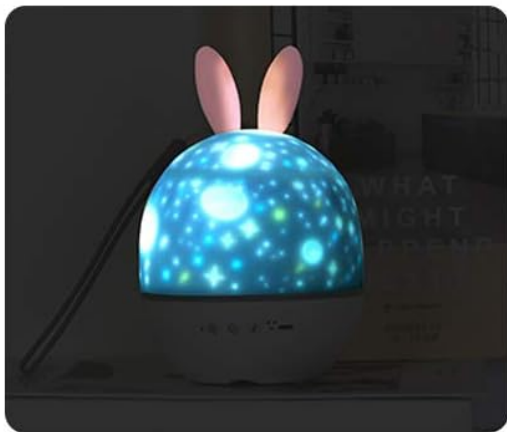

Blue Light



Three Color Light

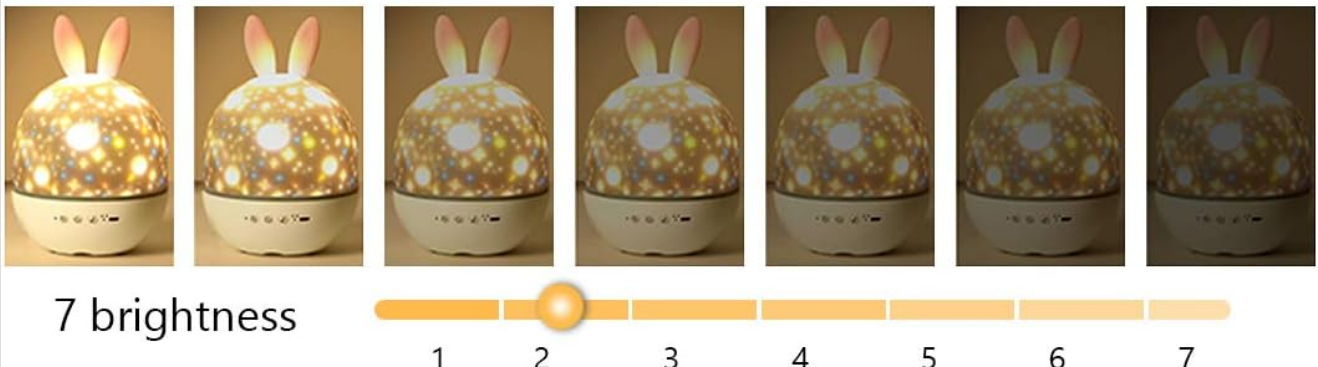

Image: Displays the projector emitting white, yellow, blue, and a mixed three-color light. Below, a series of images shows the projector at 7 different brightness levels.

### Brightness Adjustment

Use the "Lighting Up" and "Dimming" buttons on the remote control to adjust the brightness of the projection.

### Rotation Function

Press the Rotation ON/OFF switch on the unit or the "Rotary ON/OFF" button on the remote control to start or stop the 360° rotation of the projection.

### Music Playback

Use the Music ON/OFF switch on the unit or the "Music ON/OFF" button on the remote control to play or pause the built-in music. Use the number buttons (1-8) on the remote to select a specific track, and the volume buttons (+/-) to adjust the sound level.

The projector includes 8 built-in sleep aid music tracks: Music Box Dance, Hark! The GHeard Angle Sing, Joy The World, Bibbidi Bobbidi Boo, Memory, Oh Christmas Tree, Let It Go, Sky City.

## **Timer Function**

Press the "Timing Switch" button on the remote control to set an automatic shut-off timer for 15 or 30 minutes. If you wish for the light to remain on all night, ensure no timer is set and the device is connected to a power source via the USB cable.

## **Projection Themes**

The projector includes 6 interchangeable projection films, each offering a unique theme:

- Confession of Lovers
- Ocean
- Birthday
- Starry Sky
- Christmas
- Constellation

To change themes, follow the film installation steps described in the "Setup" section.

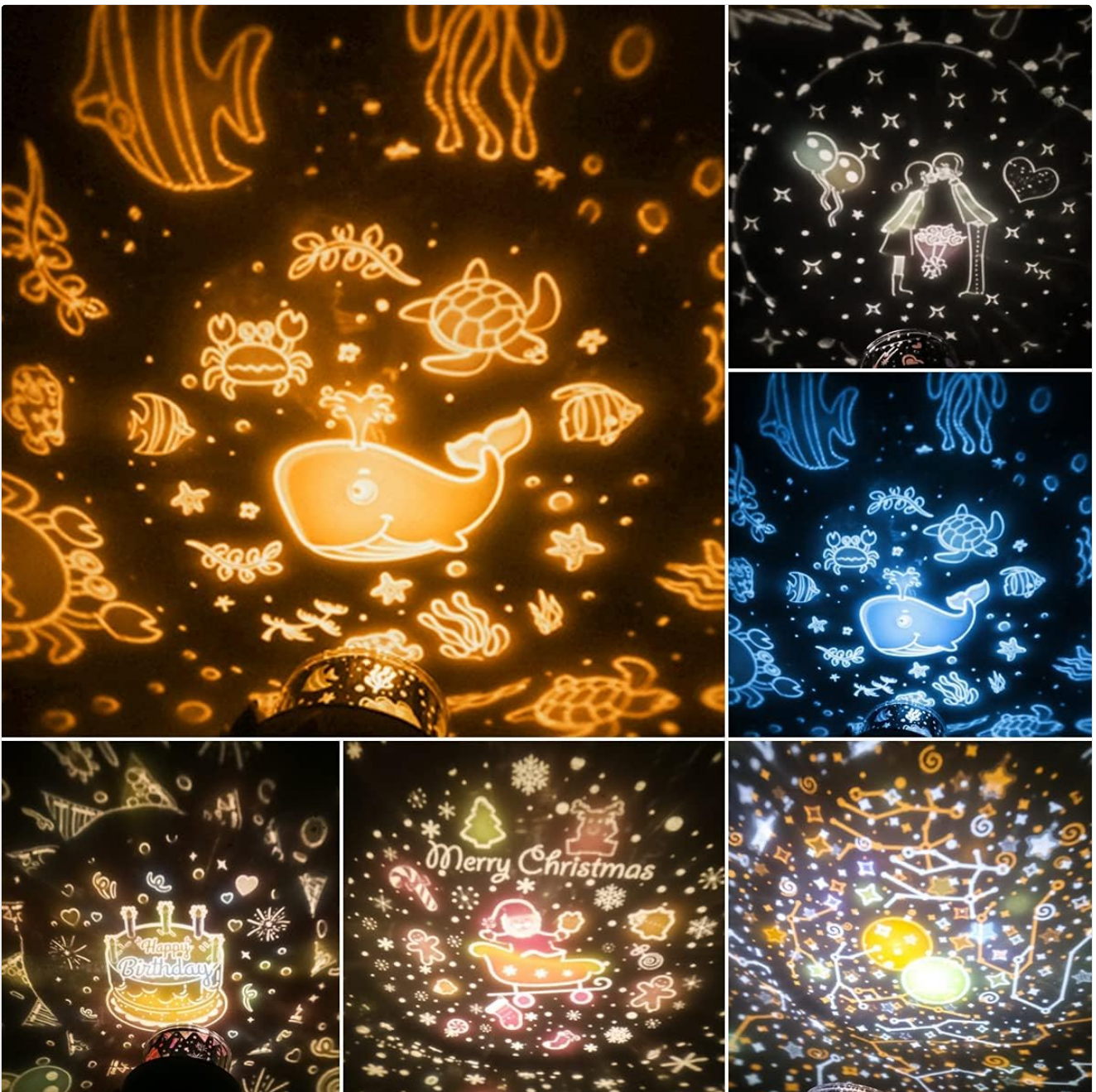

Image: A visual representation of several available projection themes, such as ocean life, birthday celebrations, Christmas scenes, and a starry night sky.

## MAINTENANCE

---

- **Cleaning:** Wipe the projector with a soft, dry cloth. Do not use abrasive cleaners or solvents.
- **Storage:** Store the device in a cool, dry place away from direct sunlight when not in use.
- **Battery Care:** To prolong battery life, avoid fully discharging the battery frequently. Charge the device regularly if stored for extended periods.

## TROUBLESHOOTING

---

- **Projector not turning on:** Ensure the device is charged. Connect it to a USB power source and try again.
- **No projection:** Check if the dome is properly removed and the projection films are correctly installed. Ensure the room is dark enough for the projection to be visible.
- **Projection is blurry:** Ensure the projection films are clean and properly seated. Adjust the distance to the projection surface for optimal clarity.

- **Remote control not working:** Check the battery in the remote control. Ensure there are no obstructions between the remote and the projector.
- **Music not playing:** Ensure the music function is turned on via the unit's switch or the remote control.

## SPECIFICATIONS

Feature	Specification
Model Number	U4-LQDD0715-FBA
Manufacturer	URAQT
Product Dimensions	15.7 x 11.7 x 11.7 cm
Item Weight	378 Grams
Battery	1200mAh Lithium Ion (Rechargeable)
Power	1 W
External Materials	ABS, Acrylonitrile Butadiene Styrene (Shade)
Lamp Type	Light Emitting Diode (LED)
Switch Type	Remote Control, Manual Buttons

## SAFETY INFORMATION

- Do not disassemble or modify the device.
- Keep out of reach of small children to prevent choking hazards from small parts.
- Avoid direct eye exposure to the light source.
- Do not expose the device to water or extreme temperatures.
- Use only the provided USB cable for charging.

## WARRANTY AND SUPPORT

For warranty information or technical support, please refer to the contact details provided with your purchase or visit the official URAQT website. Please have your model number (U4-LQDD0715-FBA) available when contacting support.