

Yesker 028

Yesker 10x10ft Photo Video Studio Background Support Stand Model 028 Instruction Manual

Your guide to setting up and using your Yesker Photography Backdrop System.

INTRODUCTION

Thank you for choosing the Yesker 10x10ft Photo Video Studio Background Support Stand Model 028. This adjustable and heavy-duty system is designed for various photography and video applications, including photoshoots, parties, and video creation. This manual provides detailed instructions for assembly, operation, maintenance, and troubleshooting to ensure optimal performance and longevity of your product.

WHAT'S IN THE BOX

Before you begin, please verify that all components listed below are present in your package:

- 2 x Support Stands (Adjustable height: 2.7 ft - 10 ft)
- 4 x Crossbar Sections (Adjustable width: 5 ft - 10 ft)
- 3 x Background Clips
- 2 x Oxford Cloth Sandbags (Note: Sandbags are empty and require filling for stability)
- 1 x Carry Bag
- Necessary washers and fasteners

ADJUSTABLE CROSSBAR

From 5 - 10ft

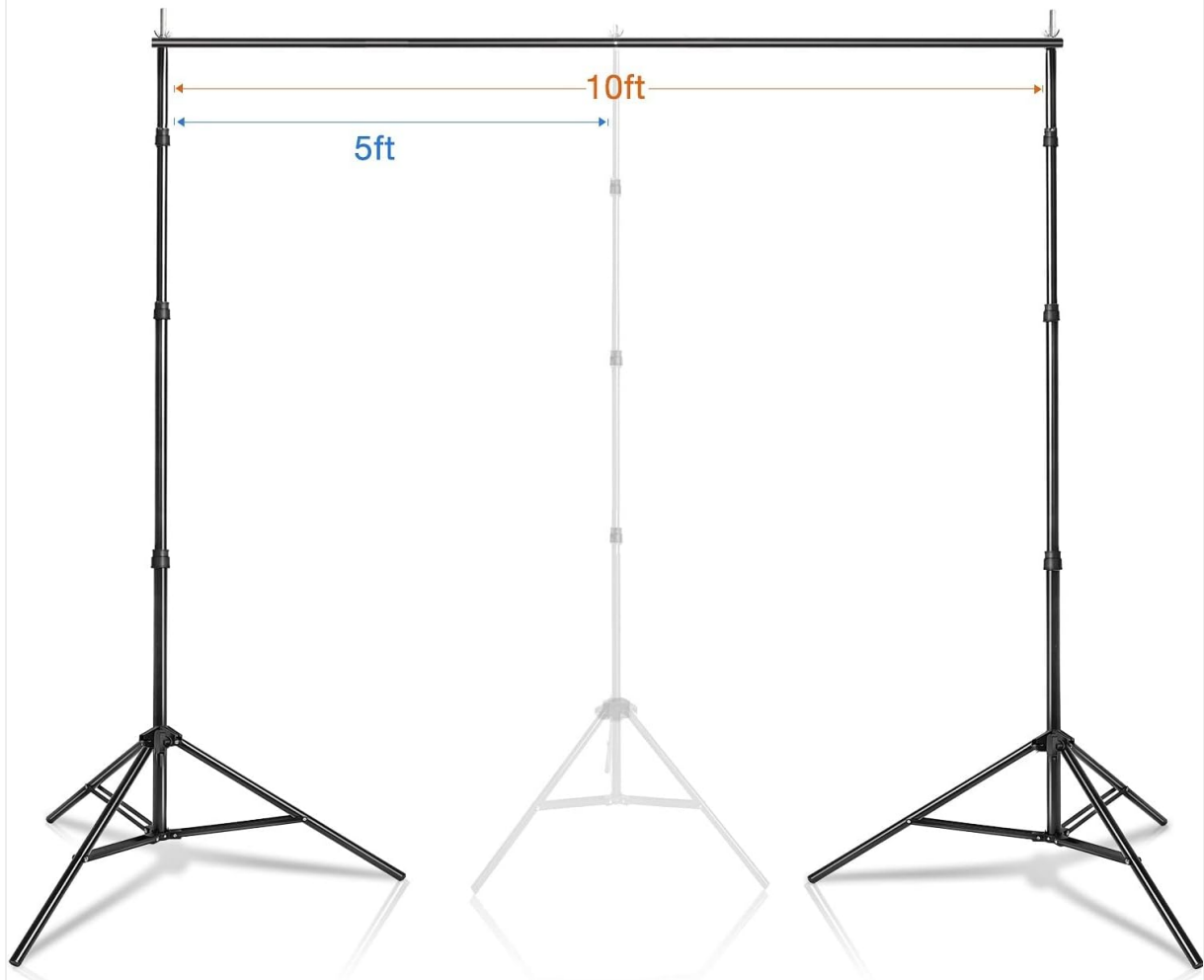

Image: Overview of all included components: two support stands, four crossbar sections, three background clips, two empty sandbags, and a carry bag.

Your browser does not support the video tag.

Video: A user unboxing and showing the components of the backdrop stand kit.

SETUP INSTRUCTIONS

1. Prepare the Support Stands:

Unfold the tripod legs of each support stand. Ensure they are fully extended for maximum stability. Tighten any knobs to secure the legs in place.

BRACKET CONNECTION

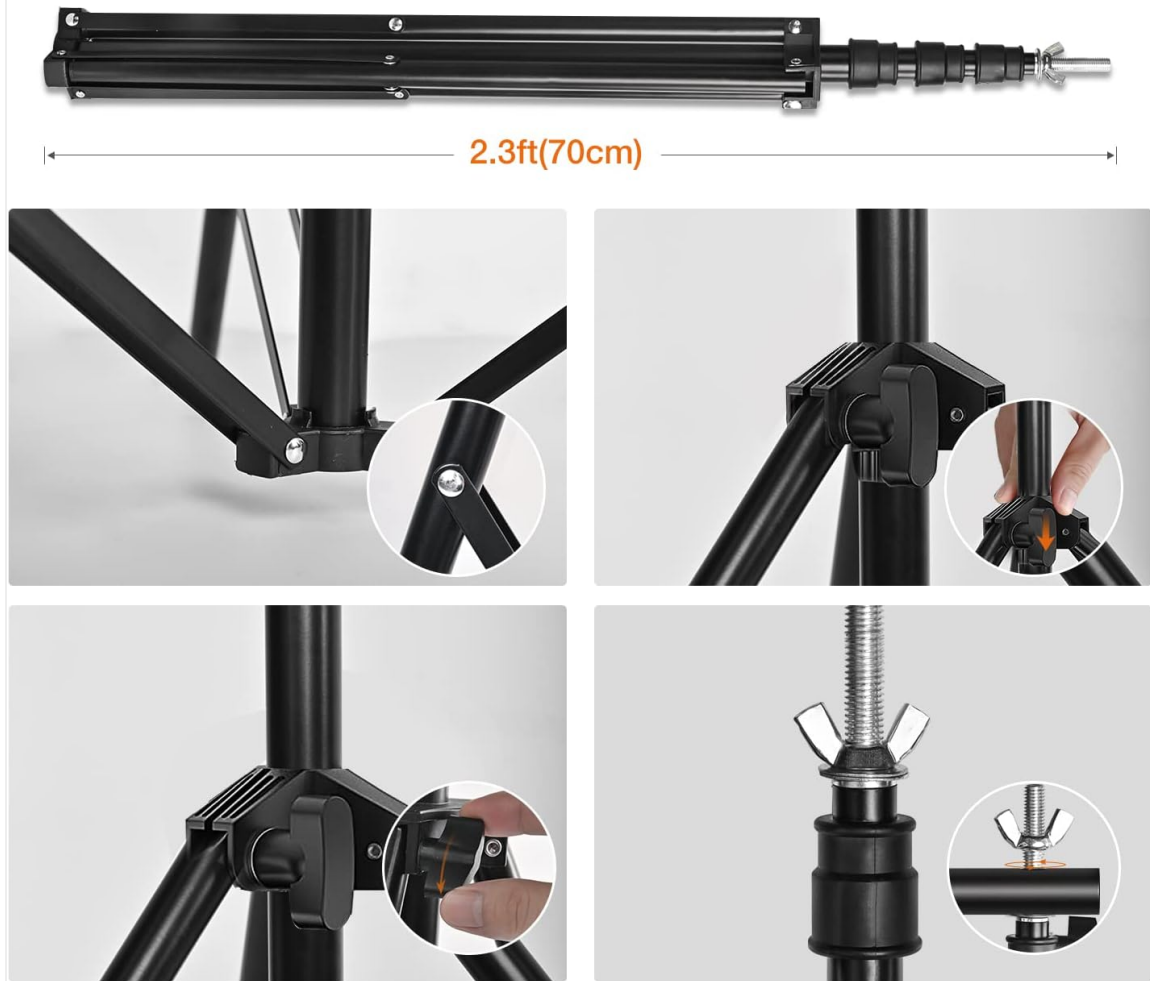

Image: Detail of the support stand's tripod base and connection points, showing how to secure the legs.

2. Assemble the Crossbar:

The crossbar consists of four telescopic sections. Connect these sections by sliding them together. The crossbar width is adjustable from 5ft to 10ft. Ensure the connections are secure.

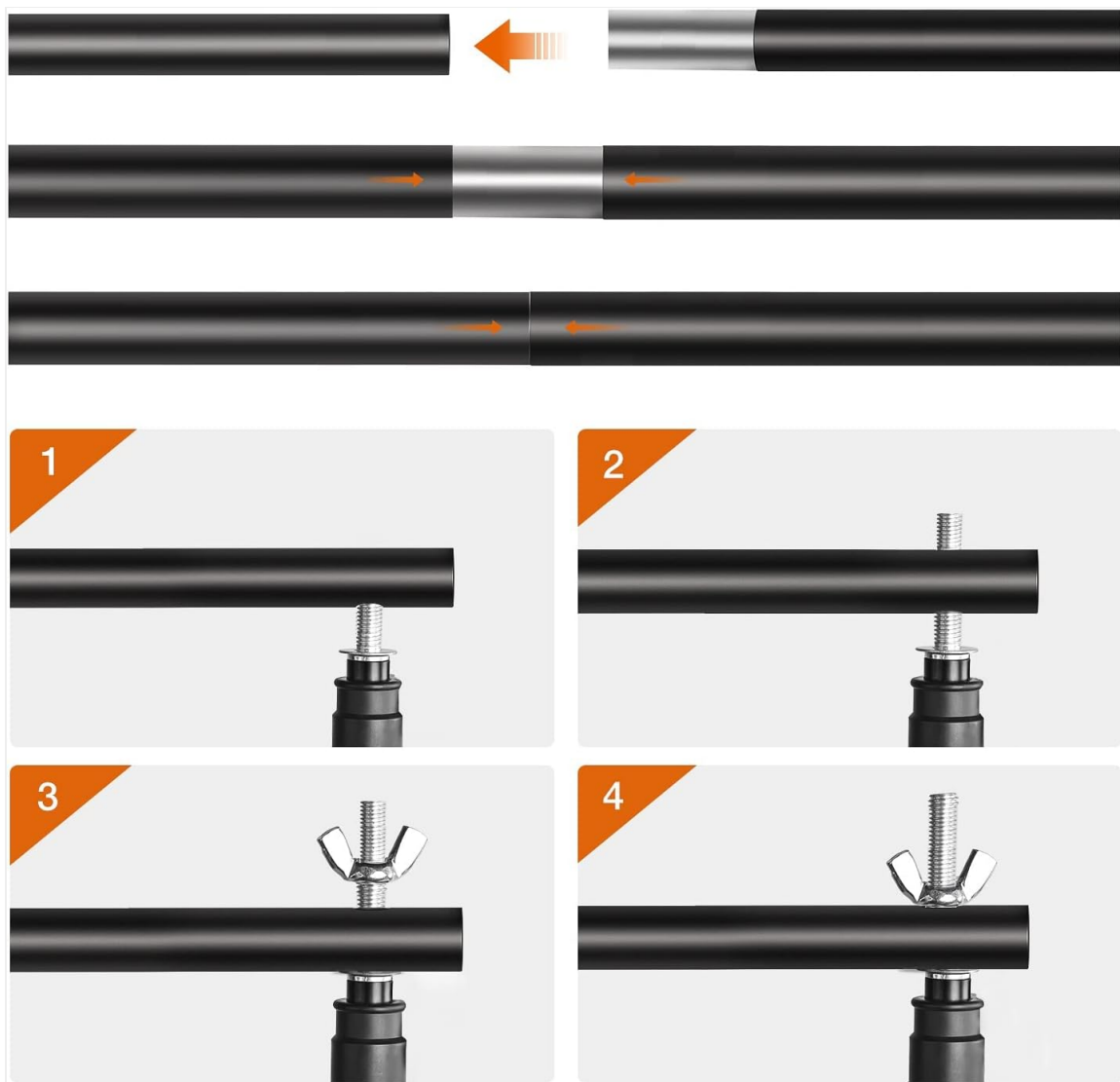

Image: Step-by-step illustration of connecting the crossbar sections.

3. Attach Crossbar to Stands:

Place the assembled crossbar onto the top pins of the two support stands. Secure it using the provided wing nuts or fasteners. Adjust the height of the stands as needed (from 2.7ft to 10ft) by loosening and tightening the knobs on the stand poles.

ADJUSTABLE HEIGHT

from 2.7ft to 10ft

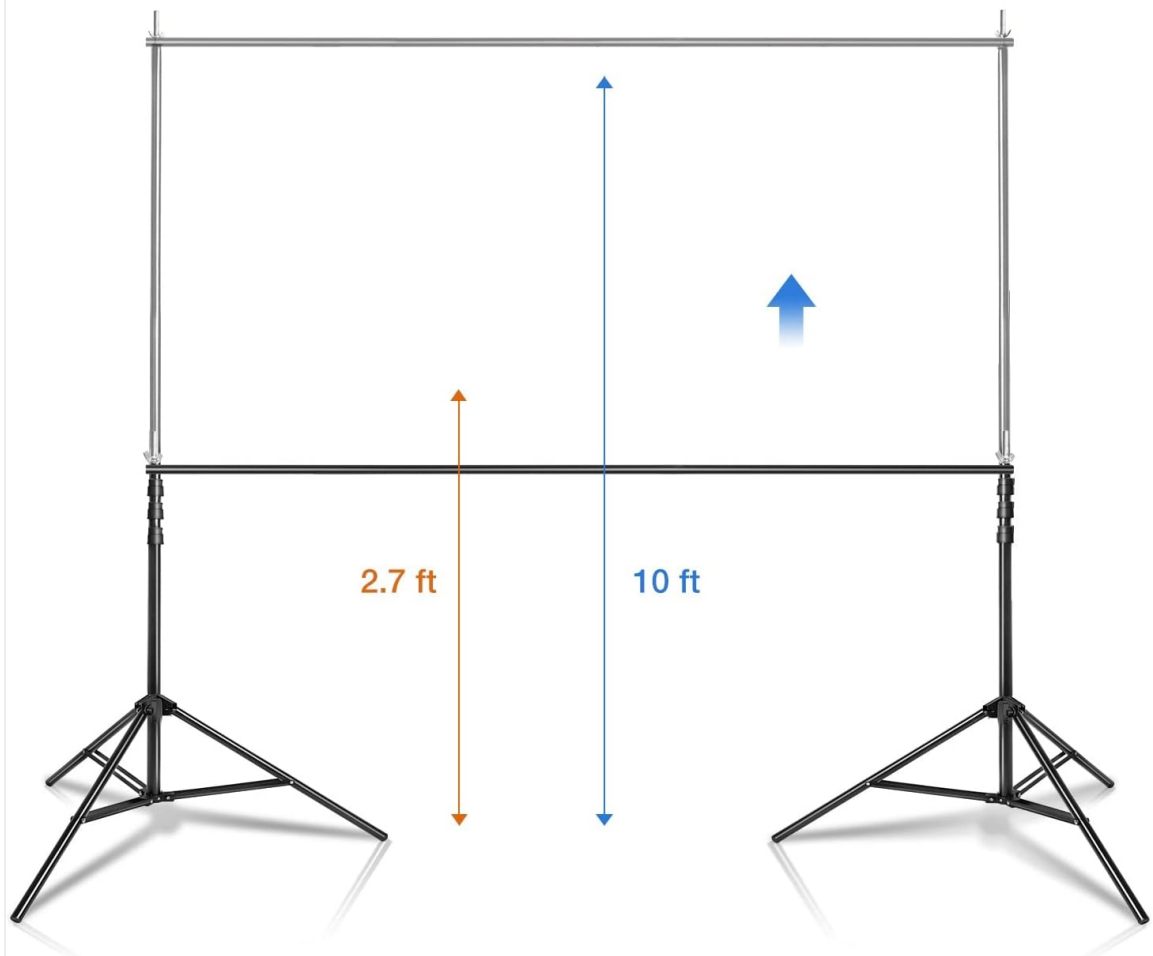

Image: Visual representation of the adjustable height feature of the support stands.



Image: Visual representation of the adjustable width feature of the crossbar.

4. Secure with Sandbags:

Fill the two Oxford cloth sandbags with sand or other heavy material. Attach one sandbag to each tripod leg base to enhance stability and prevent accidental tipping, especially when using heavier backdrops or in windy conditions.



Image: A sandbag attached to the tripod leg, illustrating its use for added stability. Note that the sandbag is empty and needs to be filled.

5. Attach Backdrop:

Drape your chosen backdrop (muslin, canvas, paper, etc.) over the crossbar. Use the included background clips to secure the backdrop firmly to the crossbar, preventing it from slipping or wrinkling.

◀ Perfect For The Famail Party ▶



Image: A fully assembled backdrop stand with a green screen attached, demonstrating how clips hold the fabric.

Your browser does not support the video tag.

Video: A user demonstrating the step-by-step assembly of the backdrop stand, including connecting poles and attaching the crossbar.

OPERATING INSTRUCTIONS

Once assembled, the Yesker Backdrop Support Stand is ready for use. Its adjustable nature allows for versatility in various shooting scenarios:

- **Adjusting Height and Width:** Loosen the knobs on the support stands to extend or retract the poles to achieve your desired height. Similarly, adjust the crossbar sections to set the required width for your backdrop. Always re-tighten all knobs securely after adjustment.
- **Backdrop Compatibility:** This stand is designed to support various types of backdrops, including muslin, canvas, and paper. Ensure the backdrop is evenly distributed and securely clipped to prevent sagging or movement.
- **Stability:** Always use the provided sandbags, filled with appropriate weight, to ensure maximum stability of the stand, especially when using large or heavy backdrops, or in outdoor settings.

MAINTENANCE

Proper maintenance will extend the life of your backdrop support system:

- **Cleaning:** For fabric backdrops, follow the manufacturer's care instructions, typically "Hand Wash Only". For paper backdrops, gently wipe with a dry cloth to remove dust or smudges. Clean the metal poles and plastic components with a damp cloth as needed.
- **Storage:** After use, disassemble the stand and store all components in the provided carry bag. This protects the parts from dust and damage and makes transport easier.
- **Inspection:** Periodically inspect all knobs, fasteners, and pole connections for wear and tear. Ensure all parts are functioning correctly before each use.

TROUBLESHOOTING

Here are solutions to common issues you might encounter:

Problem	Possible Cause	Solution
Stand is unstable or tips over easily.	Tripod legs not fully extended or tightened; insufficient weight at base; heavy backdrop.	Ensure tripod legs are fully spread and all knobs are securely tightened. Fill and attach sandbags to the base of each stand. Consider using lighter backdrops if stability remains an issue.
Crossbar sags in the middle.	Crossbar sections not fully connected; backdrop too heavy for the current span; crossbar not properly secured to stands.	Verify all crossbar sections are firmly connected. Ensure the crossbar is securely attached to the support stands. If using a very wide span, consider reducing the width or using a lighter backdrop.
Poles do not fit together or are too loose.	Incorrect pole matching; missing or damaged fasteners/washers.	Double-check that you are connecting the correct pole sections. Ensure all washers and fasteners are present and correctly installed. If parts are damaged or missing, contact customer support.
Backdrop slips from the crossbar.	Clips not strong enough or not enough clips used; backdrop material is too slick.	Use all provided clips and ensure they are firmly gripping the backdrop and crossbar. If necessary, use additional clips or consider a backdrop with a rod pocket for a more secure fit.

SPECIFICATIONS

- **Model Number:** 028
- **Brand:** Yesker
- **Product Dimensions:** 120 x 32 x 0.1 inches (Assembled)
- **Item Weight:** 6.86 pounds (3.12 Kilograms)
- **Adjustable Height:** Minimum 2.7 ft - Maximum 10 ft
- **Adjustable Width:** Minimum 5 ft - Maximum 10 ft
- **Material:** Metal (Stands and Crossbar), Oxford Cloth (Sandbags)
- **Color:** Black (Stand components)

WARRANTY AND SUPPORT

For information regarding product warranty, please refer to the terms and conditions provided at the time of

purchase or visit the official Yesker product page on Amazon. Protection plans are also available for extended coverage.

If you have any questions, concerns, or require assistance with your Yesker Backdrop Support Stand, please contact customer service at kimoutlet.cs@gmail.com. Please include your Amazon Order ID, a description of the issue, and any illustrative pictures to help us assist you efficiently.