

Oster 2132650

Oster Convection 4-Slice Toaster Oven

Model: 2132650

IMPORTANT SAFEGUARDS

When using electrical appliances, basic safety precautions should always be followed to reduce the risk of fire, electric shock, and/or injury to persons, including the following:

- Read all instructions before using this product.
- Do not touch hot surfaces. Use handles or knobs.
- To protect against electrical shock, do not immerse cord, plug, or appliance in water or other liquid.
- Close supervision is necessary when any appliance is used by or near children.
- Unplug from outlet when not in use and before cleaning. Allow to cool before putting on or taking off parts.
- Do not operate any appliance with a damaged cord or plug, or after the appliance malfunctions or has been damaged in any manner. Return appliance to the nearest authorized service facility for examination, repair, or adjustment.
- The use of accessory attachments not recommended by the appliance manufacturer may cause injuries.
- Do not use outdoors.
- Do not let cord hang over edge of table or counter, or touch hot surfaces.
- Do not place on or near a hot gas or electric burner, or in a heated oven.
- Extreme caution must be used when moving an appliance containing hot oil or other hot liquids.
- Always attach plug to appliance first, then plug cord into the wall outlet. To disconnect, turn any control to "off", then remove plug from wall outlet.
- Do not use appliance for other than intended use.
- Oversize foods or metal utensils must not be inserted in a toaster oven as they may create a fire or risk of electric shock.
- A fire may occur if the toaster oven is covered or touching flammable material, including curtains, draperies, walls, and the like, when in operation. Do not store any item on top of the appliance when in operation.
- Do not clean with metal scouring pads. Pieces can break off the pad and touch electrical parts, creating a risk of electric shock.

- Extreme caution should be exercised when using containers constructed of other than metal or glass.
- Do not store any materials, other than manufacturer's recommended accessories, in this oven when not in use.
- Do not place any of the following materials in the oven: paper, cardboard, plastic, or any materials that may catch fire or melt.
- Do not cover crumb tray or any part of the oven with metal foil. This will cause overheating of the oven.

SAVE THESE INSTRUCTIONS

GETTING STARTED

Unpacking

1. Carefully remove the toaster oven and all accessories from the packaging.
2. Remove any packing materials, stickers, or labels from the unit.
3. Wash the baking pan, wire rack, and crumb tray in warm, soapy water. Rinse and dry thoroughly.
4. Wipe the exterior of the oven with a damp cloth. Do not immerse the oven in water.

Components

- Temperature Control Dial
- Function Control Dial
- Timer Control Dial
- Oven Door with Handle
- Wire Rack
- Baking Pan
- Removable Crumb Tray



Image: The Oster Convection 4-Slice Toaster Oven, showing the front view with a small pizza cooking inside. The control dials are visible on the right side.

SETUP

1. **Placement:** Place the toaster oven on a flat, stable, heat-resistant surface. Ensure there is at least 4 inches (10 cm) of clearance on all sides and above the oven for proper ventilation.
2. **Power Connection:** Plug the power cord into a standard 120V AC electrical outlet.
3. **Initial Burn-Off:** Before first use, operate the oven empty for approximately 15 minutes at 450°F (230°C) on the "Bake" function. This will burn off any manufacturing residues and odors. A slight smoke or odor is normal during this process. Ensure the area is well-ventilated.

OPERATING INSTRUCTIONS

Control Dials Overview

- **Temperature Control Dial:** Adjusts the cooking temperature from Warm to 450°F (230°C).
- **Function Control Dial:** Selects the desired cooking mode: Toast, Bake, Broil, Turbo, or Warm.
- **Timer Control Dial:** Sets the cooking time up to 60 minutes. Includes a "Stay On" setting for longer cooking.



Image: A close-up view of the three control dials on the right side of the Oster Toaster Oven, showing temperature, function, and timer settings.

Cooking Functions

1. Toast:

- Place items directly on the wire rack.
- Set Function Dial to "Toast".
- Set Temperature Dial to "Toast" (usually 450°F).
- Set Timer Dial to desired toast shade. The oven will automatically turn off when the timer expires.

2. Bake:

- Place food in the baking pan on the wire rack.
- Set Function Dial to "Bake".
- Set Temperature Dial to the desired baking temperature.
- Set Timer Dial to the desired baking time. For longer cooking, turn to "Stay On" and monitor manually.

3. Broil:

- Place food on the baking pan, positioned on the wire rack. Use the upper rack position for best results.
- Set Function Dial to "Broil".
- Set Temperature Dial to the desired broiling temperature (e.g., 450°F).
- Set Timer Dial to the desired broiling time. Monitor food closely to prevent burning.

4. Turbo Convection:

- This function uses a fan to circulate hot air, resulting in faster and more even cooking.
- Set Function Dial to "Turbo".
- Set Temperature Dial to the desired temperature. Cooking times may need to be reduced compared to conventional baking.
- Set Timer Dial to the desired cooking time.

5. Warm:

- Use to keep cooked food warm.
- Set Function Dial to "Warm".
- Set Temperature Dial to "Warm".
- Set Timer Dial to the desired warming time or "Stay On".

Adjustable Rack Positions

The oven features 3 adjustable rack positions to accommodate various food sizes and cooking needs.

- **Upper Position:** Ideal for broiling or for items requiring intense top heat.
- **Middle Position:** Suitable for most baking and roasting tasks.
- **Lower Position:** Best for larger items or for gentle cooking.



Image: The interior of the Oster Toaster Oven, showing the baking pan placed on the wire rack in a middle position.

CARE AND CLEANING

Always unplug the toaster oven from the electrical outlet and allow it to cool completely before cleaning.

- **Exterior:** Wipe the exterior surfaces with a damp cloth and mild detergent. Do not use abrasive cleaners or scouring pads.
- **Interior:** Wipe the interior walls with a damp cloth. For stubborn stains, use a non-abrasive cleaner. Avoid spraying cleaners directly into the oven.
- **Wire Rack and Baking Pan:** These accessories are dishwasher-safe. Alternatively, wash them in warm, soapy water, rinse, and dry thoroughly.
- **Crumb Tray:** Pull out the removable crumb tray from the bottom front of the oven. Discard crumbs. Wash the tray in warm, soapy water, rinse, and dry thoroughly before reinserting. Clean regularly to prevent grease buildup and potential fire hazards.



Image: The Oster Toaster Oven with its crumb tray partially pulled out from the bottom, illustrating the ease of cleaning.

TROUBLESHOOTING

Problem	Possible Cause	Solution
Oven does not turn on.	Not plugged in; power outage; timer not set.	Ensure plug is securely in outlet; check household circuit breaker; set timer past 0.
Food not cooking evenly.	Incorrect rack position; overcrowding; uneven food placement.	Adjust rack position; avoid overcrowding; arrange food in a single layer. Consider using the "Turbo" convection function for more even heat distribution.
Excessive smoke or odor.	Food spills; crumb tray needs cleaning; initial burn-off.	Clean interior and crumb tray thoroughly. If it's the first use, this is normal and will subside. Ensure good ventilation.
Toast is too light/dark.	Timer setting incorrect.	Adjust the Timer Dial to a higher setting for darker toast or a lower setting for lighter toast.

SPECIFICATIONS

- **Brand:** Oster
- **Model Name:** Convection 4-Slice Toaster Oven
- **Model Number:** 2132650
- **Color:** Black
- **Control Type:** Knob Control
- **Power Source:** AC adapter (Standard 120V)
- **Product Dimensions:** 18.62 x 15.35 x 10.75 inches (L x W x H)
- **Item Weight:** 11.95 pounds
- **Included Components:** Oven, Wire Rack, Baking Pan, Removable Crumb Tray





WARRANTY AND SUPPORT

This Oster product is covered by a limited warranty. For detailed warranty information, please refer to the warranty card included with your purchase or visit the official Oster website.

For technical assistance, troubleshooting, or to inquire about replacement parts, please contact Oster Customer Service:

- **Website:** www.oster.com (Note: This is a generic link as no specific support link was provided)
- **Phone:** Refer to your product registration or warranty documentation for regional contact numbers.

Related Documents - 2132650

	<p>Oster TSSTTV7118 & TSSTTV7118R 18-Liter 4-Slice Toaster Oven Instruction Manual</p> <p>Comprehensive instruction manual for the Oster TSSTTV7118 and TSSTTV7118R 18-liter, 4-slice toaster oven. Learn about safety precautions, appliance description, functions (Toast, Turbo Convection Bake, Bake, Warm, Broil), rack and pan positioning, cleaning, maintenance, and troubleshooting.</p>
	<p>Oster 4-Slice Toaster TSSTTA4440 Instruction Manual</p> <p>This manual provides essential safety information, operating instructions, toasting tips, and maintenance guidelines for the Oster 4-Slice Toaster, model TSSTTA4440.</p>
	<p>Oster 6-Slice Toaster Oven (Model 6058) User Manual</p> <p>Comprehensive user manual for the Oster 6-Slice Toaster Oven (Model 6058), covering features, operation, cleaning, troubleshooting, and warranty information. Includes instructions for bake, broil, toast, pizza, dehydrate, and defrost functions.</p>
	<p>Oster French Door Toaster Oven TSSTTVFDXL Instruction Manual</p> <p>Comprehensive instruction manual for the Oster TSSTTVFDXL French Door Toaster Oven, covering safety precautions, appliance description, operating instructions for various functions (Warm, Bake, Pizza, Turbo Convection, Broil, Toast, Rotisserie), troubleshooting, and recipes.</p>

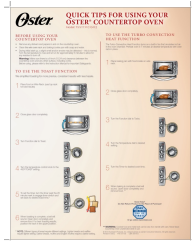

[Oster Countertop Oven User Guide - Model TSSTTVCG02](#)

Quick tips and instructions for using your Oster countertop oven, model TSSTTVCG02, including toast and turbo convection heat functions.

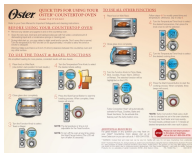

[Quick Tips for Using Your Oster Countertop Oven](#)

Concise guide with quick tips for using your Oster Countertop Oven (Model TSSTTVDG01), covering initial setup, toast/bagel functions, and other cooking functions. Includes important warnings and additional resources.