



[Manuals.plus](#) /

› [TESSAN](#) /

› TESSAN TS-WS06US00 8-in-1 USB C Charger Block and Power Outlet Extender User Manual

## TESSAN TS-WS06US00

# TESSAN TS-WS06US00 8-in-1 USB C Charger Block and Power Outlet Extender

User Manual

### INTRODUCTION

---

Thank you for choosing the TESSAN TS-WS06US00 8-in-1 USB C Charger Block and Power Outlet Extender. This device is designed to expand a single wall outlet into multiple power sources, offering convenience for charging various electronic devices simultaneously. Its compact and foldable design makes it ideal for use in homes, offices, dormitories, and especially for travel, including cruise ships.



Figure 1: TESSAN TS-WS06US00 8-in-1 USB C Charger Block and Power Outlet Extender.

## KEY FEATURES

- **USB Charger Block:** Equipped with 2 USB-C ports (up to 20W max each) and 2 USB-A ports (up to 12W max each) for efficient charging of various USB devices.
- **8-in-1 USB Wall Plug:** Expands to 4 AC outlets (1875W max) and 4 USB ports (2 USB-C, 2 USB-A), allowing simultaneous charging of up to 8 devices.
- **Foldable Design:** Features foldable prongs to prevent damage and scratches to devices, making it easy to store and carry in pockets or bags.
- **Cruise Essentials:** Designed without surge protection, making it suitable for use on cruise ships. Its compact size (2.20 × 1.17 × 3.43 inches) and light weight (4 ounces) ensure portability.
- **Space Saving:** The 4-sided outlet design allows for simultaneous use of large plugs without blocking adjacent outlets, fitting standard and decorator outlets.

# PD 20W Fast Charging

Quickly charge devices to reduce waiting time



**USB C2**  
**20W Max**



**USB C1**  
**15W Max**



**USB A1/A2**  
**12W Max**

Note: USB total output 15W max



Figure 2: TESSAN 8-in-1 Extender illustrating PD 20W Fast Charging capabilities for USB-C and 12W for USB-A ports.

# Foldable Plug Design

Saving space in your pocket

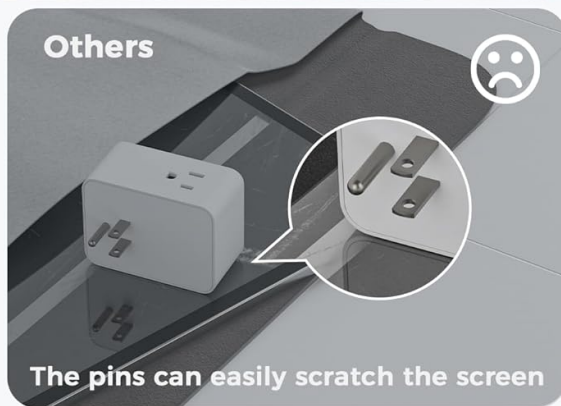

Figure 3: Overview of the TESSAN 8-in-1 USB Wall Charger, showing 4 AC outlets and 4 USB ports.

## SAFETY INSTRUCTIONS

- Do not exceed the maximum power rating of 1875W for AC outlets.
- For indoor use only.
- Keep away from water and damp environments.
- Do not attempt to disassemble or modify the device.
- Ensure the wall outlet is properly grounded before plugging in the extender.
- This device does not convert voltage. Ensure your devices are compatible with the local voltage.
- This product does not include surge protection, making it suitable for cruise ships where surge protectors are often prohibited.

## SETUP

1. Unfold the prongs of the TESSAN extender.
2. Insert the extender firmly into a standard 3-prong wall outlet.
3. Ensure the connection is secure and the extender is stable.

# 8 IN 1 USB Wall Charger

Simultaneously charge 8 devices



Figure 4: The foldable plug design ensures easy setup and portability.

## OPERATING INSTRUCTIONS

- **Using AC Outlets:** Plug your appliances and electronic devices into the 4 AC outlets. Ensure the total wattage does not exceed 1875W.
- **Using USB-C Ports:** Connect your USB-C compatible devices for fast charging. Each USB-C port delivers up to 20W.
- **Using USB-A Ports:** Connect your USB-A compatible devices for charging. Each USB-A port delivers up to 12W.
- **Simultaneous Charging:** The extender allows you to charge up to 8 devices (4 AC, 2 USB-C, 2 USB-A) simultaneously. Note that the total combined USB output is limited to 15W.

# 4-Sided Outlets Design

Won't block each other



Figure 5: The 4-sided design allows multiple devices to be plugged in without interference.

## MAINTENANCE

- To clean the extender, unplug it from the wall outlet and wipe it with a dry, soft cloth.
- Do not use liquid cleaners or abrasive chemicals.
- Store the extender in a cool, dry place when not in use.

## TROUBLESHOOTING

- **No Power:** Ensure the extender is fully plugged into a functional wall outlet. Test the wall outlet with another device to confirm it has power.
- **Slow Charging:** Verify that your device supports fast charging if using USB-C ports. Ensure the charging cables are not damaged and are compatible with your devices. Note that the total combined USB output is 15W, which may affect charging speed if multiple high-power devices are connected simultaneously.
- **Loose Fit in Outlet:** If the extender feels loose in the wall outlet, it may be due to a worn outlet. Consider using a different outlet or consulting an electrician.

## SPECIFICATIONS

<b>Brand</b>	TESSAN
<b>Model Number</b>	TS-WS06US00
<b>AC Outlets</b>	4 (1875W Max)
<b>USB-C Ports</b>	2 (20W Max each)
<b>USB-A Ports</b>	2 (12W Max each)
<b>Total USB Output</b>	15W Max
<b>Input Voltage</b>	100-125V~, 15A Max
<b>Dimensions</b>	2.20 × 1.17 × 3.43 inches
<b>Weight</b>	4 ounces (0.25 Pounds)
<b>Material</b>	Plastic
<b>Special Feature</b>	Compact, Foldable Plug, No Surge Protection

# Cruise Ship Must Have

A non-surge-protected outlet extender meets the requirements of cruise ships



**Cruise Ship Essentials**



**No Surge Protection**



**No Extension Cord**



**4 oz**

Figure 6: The TESSAN extender is a suitable travel companion, especially for cruises.

The TESSAN TS-WS06US00 8-in-1 USB C Charger Block and Power Outlet Extender comes with a **2-year warranty** from the date of purchase. For any product inquiries, technical support, or warranty claims, please refer to the official TESSAN website or contact their customer service directly.

# Suitable for Many Occasions

Making life and work easier



Figure 7: The TESSAN extender is versatile for use in various environments like bedrooms, offices, living rooms, and kitchens.