

- › [Axial](#) /
- › [Axial SCX10 III Jeep JLU Wrangler with Portals RTR Instruction Manual](#)

Axial AXI03003T2

Axial SCX10 III Jeep JLU Wrangler with Portals RTR Instruction Manual

Model: AXI03003T2

INTRODUCTION

This manual provides essential information for the setup, operation, and maintenance of your Axial SCX10 III Jeep JLU Wrangler with Portals RTR. Please read this manual thoroughly before operating your vehicle to ensure safe and optimal performance.



Image: The Axial SCX10 III Jeep JLU Wrangler with Portals RTR in orange, showcasing its detailed exterior and large off-road tires.

SAFETY INFORMATION

WARNING:

- Always operate your RC vehicle in open areas away from people, pets, and obstacles.
- Do not operate near water unless the vehicle is specifically designed for it.
- Keep fingers, hair, and loose clothing away from moving parts.
- Adult supervision is recommended for users under 14 years of age.
- Refer to the included Product Manual for additional safety guidelines.

WHAT'S IN THE BOX

Your Axial SCX10 III Jeep JLU Wrangler with Portals RTR package includes the following components:

- (1) Axial SCX10 III Jeep JL Wrangler 4WD RTR Vehicle
- (1) Spektrum DX3 3-Channel 2.4GHz DSMR Radio System
- Product Manual

NEEDED TO COMPLETE (NOT INCLUDED)

To operate your Axial SCX10 III Jeep JLU Wrangler, you will need the following items, which are not included in the package:

- (4) AA Batteries for the transmitter
- (1) LiPo Battery (accepts both Standard and Shorty LiPo batteries)
- (1) Compatible LiPo Battery Charger

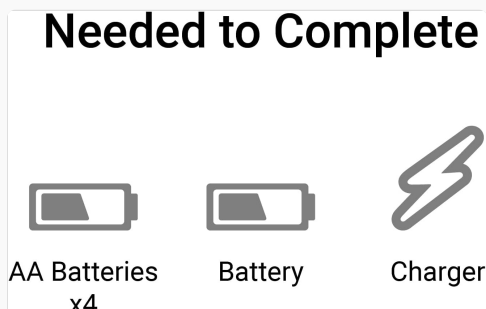

Image: Icons representing AA batteries, a main vehicle battery, and a charger, indicating items required for operation but sold separately.

SETUP GUIDE

1. Battery Installation

Install the required AA batteries into the Spektrum DX3 transmitter. Ensure correct polarity. Then, install a charged LiPo battery into the vehicle's battery tray. The vehicle accepts both standard and shorty LiPo batteries.

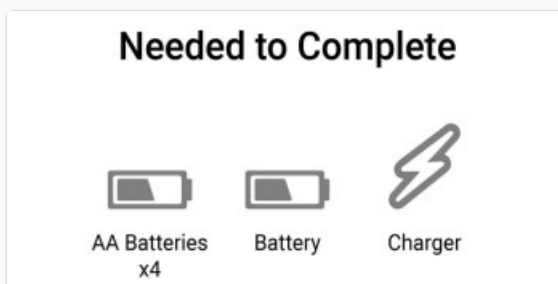

Image: A close-up view of the battery tray within the Axial SCX10 III chassis, designed to secure the vehicle's power source.

2. Transmitter and Receiver Binding

Your vehicle comes pre-bound from the factory. If re-binding is necessary, refer to the Spektrum DX3 manual for detailed instructions. Ensure the transmitter and receiver are properly linked for control.

3. Initial Inspection

Before first use, inspect all connections, screws, and moving parts to ensure they are secure and free from obstruction. Check the shock absorbers for proper function and ensure no leaks are present.



Image: A detailed view of a shock absorber on the Axial SCX10 III, highlighting its spring and dampening mechanism.



Image: The Spektrum DX3 3-Channel 2.4GHz DSMR Radio System transmitter, used for controlling the RC vehicle.



Image: A close-up of the Spektrum Firma Smart 40A ESC/receiver unit, showing its wiring and compact design within the vehicle chassis.

OPERATING INSTRUCTIONS

1. Starting the Vehicle

Turn on the transmitter first, then connect the battery to the vehicle's ESC. The vehicle is now ready for operation. Always disconnect the battery from the vehicle before turning off the transmitter.

2. Driving Controls

- **Steering:** Use the steering wheel on the transmitter to control the direction of the front wheels.
- **Throttle:** Use the trigger on the transmitter to control forward and reverse movement, as well as braking.

3. DIG Function

The Axial SCX10 III features a DIG function, allowing you to lock the rear axle directly from the transmitter. This provides front-wheel drive only, enabling a tighter turning radius and improved maneuverability in challenging terrain. Consult your Spektrum DX3 manual for specific instructions on activating and utilizing the DIG function.



**Transmitter, Battery and Charger Not Included*

**1/10 SCX10 III Jeep JLU
Wrangler with Portals
RTR RC Vehicle**

Image: The Axial SCX10 III Jeep JLU Wrangler navigating a rocky incline, demonstrating its off-road capabilities.



Image: A side view of the Axial SCX10 III Jeep JLU Wrangler traversing a rugged outdoor trail.

MAINTENANCE

1. Cleaning

After each use, especially in dusty or muddy conditions, clean your vehicle. Use a soft brush or compressed air to remove dirt and debris. Avoid using water directly on electronics unless the components are specifically rated as waterproof.

2. Inspection

Regularly inspect the vehicle for loose screws, damaged parts, or worn tires. Pay close attention to the drivetrain, suspension components, and steering linkages. Replace any damaged parts promptly to maintain performance and prevent further issues.



Image: A close-up of the robust suspension links and portal axle system of the Axial SCX10 III, designed for extreme articulation.



Image: A pair of Axial SCX10 III tires, featuring an aggressive tread pattern for maximum grip on various terrains.

3. Lubrication

Periodically lubricate moving parts such as gears and bearings as recommended in the full product manual to reduce wear and ensure smooth operation.

TROUBLESHOOTING

Problem	Possible Cause	Solution
Vehicle does not respond to transmitter.	Transmitter batteries low or dead. Vehicle battery not connected or discharged. Transmitter and receiver not bound. Power switch off.	Replace AA batteries in transmitter. Connect or charge vehicle battery. Perform binding procedure (refer to Spektrum DX3 manual). Ensure power switch on vehicle is ON.
Poor steering response.	Steering servo issue. Loose steering linkages. Low battery voltage.	Check servo connections and function. Inspect and tighten steering linkages. Charge or replace vehicle battery.
Vehicle runs slowly or lacks power.	Vehicle battery discharged. Motor or ESC overheating. Obstruction in drivetrain.	Charge vehicle battery fully. Allow components to cool down. Inspect gears and axles for debris.

SPECIFICATIONS

Feature	Detail
Brand	Axial
Model Number	AXI03003T2
Product Dimensions	24.6 x 13.7 x 12.7 inches
Item Weight	6 pounds
Recommended Age	14 years and up
Release Date	July 30, 2020
Radio System	Spektrum DX3 2.4GHz DSMR
ESC/Receiver	Spektrum Firma Smart 40A
Special Features	Replica V8 engine, DIG function, Portal axles

WARRANTY AND SUPPORT



For detailed warranty information and technical support, please refer to the official Axial website or contact their customer service directly. Keep your proof of purchase for any warranty claims.



Manufacturer: Axial
Website: www.axialracing.com



© 2024 Axial. All rights reserved. This manual is for informational purposes only.

Related Documents - AXI03003T2

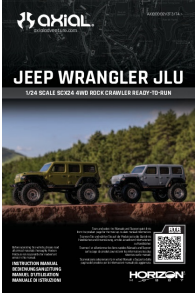
	<p>Axial SCX24 Jeep Wrangler JLU 1/24 Scale 4WD Rock Crawler RTR Instruction Manual</p> <p>Comprehensive instruction manual for the Axial SCX24 Jeep Wrangler JLU 1/24 Scale 4WD Rock Crawler Ready-to-Run (RTR). Covers safety precautions, operating instructions, maintenance, troubleshooting, parts lists, and warranty information.</p>
	<p>Axial SCX6 Jeep JLU Wrangler 1/6 Scale Rock Crawler RTR - Instruction Manual</p> <p>Comprehensive instruction manual for the Axial SCX6 Jeep JLU Wrangler 1/6 scale rock crawler RTR. Covers setup, operation, maintenance, troubleshooting, and warranty information. Features waterproof electronics and a two-speed transmission.</p>

	<p>Axial SCX10 III Jeep Gladiator RTR Instruction Manual</p> <p>Comprehensive instruction manual for the Axial SCX10 III Jeep Gladiator RTR RC rock crawler, covering setup, operation, maintenance, safety, and troubleshooting. Includes parts lists and specifications.</p>
	<p>Axial Jeep Wrangler JLU 1/24 Scale SCX24 4WD Rock Crawler RTR Instruction Manual</p> <p>Comprehensive instruction manual for the Axial Jeep Wrangler JLU 1/24 Scale SCX24 4WD Rock Crawler Ready-to-Run RC vehicle, covering setup, operation, maintenance, safety, and troubleshooting.</p>
	<p>Axial SCX24 Jeep Wrangler JLU 1/24 Scale Rock Crawler: Manuel d'instructions</p> <p>Manuel d'instructions complet pour le véhicule Axial SCX24 Jeep Wrangler JLU 1/24 Scale 4WD Rock Crawler Ready-to-Run. Ce guide couvre la configuration, le fonctionnement, la maintenance, le dépannage et les précautions de sécurité pour une utilisation optimale et sécurisée.</p>
	<p>Axial SCX6 Jeep JLU Wrangler 1/6th Scale Ready-to-Run RC Vehicle Instruction Manual</p> <p>Comprehensive instruction manual for the Axial SCX6 Jeep JLU Wrangler 1/6th scale ready-to-run radio-controlled vehicle. Covers setup, operation, maintenance, safety, and technical specifications.</p>

Documents - Axial – AXI03003T2



[\[pdf\]](#)

AXI03003T2 INFO D Axial SCX10 III Jeep JLU Wrangler 1 10 RTR Orange CHF 659 00 09 rc3d ch
mediafiles Downloads AXIAL |||

AXIAL SCX10TM III JEEP JL WRANGLER 4WD RTR AXI03003T1 GRAY
AXI03003T2 RED BEST BRANDS IN RC LEGT DIE ROCK CRAWLER LATTE
NOCH HHER RAISES THE BAR IN ROCK CRAWLING REALISM Axial erklimmt mit
dem ready-to-run SCX10 III Jeep JL Wrangler den Gipfel der Crawler Performance.
Mit der neuesten SCX10T...

lang:en score:28 filesize: 3.06 M page_count: 7 document date: 2020-06-16

HORIZON HOBBY

TWO DAY FLASH SALE

LIMITED QUANTITIES



SAVE UP TO \$140!

Available March 24th and March 25th ONLY!

AXIAL® SAVINGS WITH COUPON		
AXI90001T1	SC10 Deadbolt 1/24th 4WD RTR Red	SAVE \$25
AXI90001T2	SC10 Deadbolt 1/24th 4WD RTR Green	SAVE \$25
AXI03007	SC1000 Jeep JL Wrangler w/Portals 1/10th KIT	SAVE \$100
AXI000001T1	SC1000 Jeep JL Wrangler w/Portals 1/10th RTR Gray	SAVE \$140
AXI000001T2	SC1000 Jeep JL Wrangler w/Portals 1/10th RTR Orange	SAVE \$140
AXI00014T1	SC1000 Early Ford Bronco 1/10th 4wd RTR Red	SAVE \$100
AXI00014T2	SC1000 Early Ford Bronco 1/10th 4wd RTR White	SAVE \$100

FLASH

VALID: 3/24 - 3/25, 2022

This offer expires March 25, 2022 at 11:59 PM CST. Coupon is valid only in the United States. Coupon can be used once at a participating Horizon Hobby store or on demandware static Sites horizon master default Manuals |||

[\[pdf\]](#)

Coupon Code For Horizon Hobby Flash Sale Coupons hh1up 03252022 horizonhobby on demandware static Sites horizon master default Manuals |||

TWO DAY SAVE UP TO 140 Available March 24th and March 25th ONLY AXIAL SAVINGS WITH COUPON AXI9 ... tals 1/10th KIT SAVE 100 AXI03003T1 SCX10III Jeep JL Wrangler w/Portals 1/10 RTR Gray SAVE 140 **AXI03003T2** SCX10III Jeep JL Wrangler w/Portals 1/10 RTR Orange SAVE 140 AXI03014T1 SCX10 III Earl... lang:en **score:24** filesize: 568.43 K page_count: 1 document date: 2022-03-18

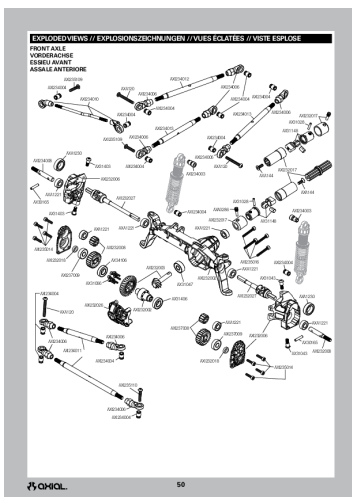

[\[pdf\]](#) User Manual

57023 AXI SCX 10 III Jeep Wrangler Manual MULTI indb garyhunt AXI03003T2 PARTS M Axial SCX10 JLW 1 RTR Orange CHF 659 00 09 rc3d ch mediafiles Downloads AXIAL |||

EXPLODED VIEWS // EXPLOSIONSZEICHNUNGEN // VUES CLATES // VISTE ESPLOSE FRONT AXLE VORDERACHSE ESSIEU AVANT ASSALE ANTERIORE AXI235109 AXI234004 AXI234010 AXA120 AXI234006 AXI234012 AXI234006 AXI234004 AXI234004 AXI234004 AXI234004 AXI235109 AXI234006 AXI234013 AXI234013 AXI234004 AXI234...

lang:i-klngon **score:19** filesize: 17.4 M page_count: 11 document date: 2020-08-06

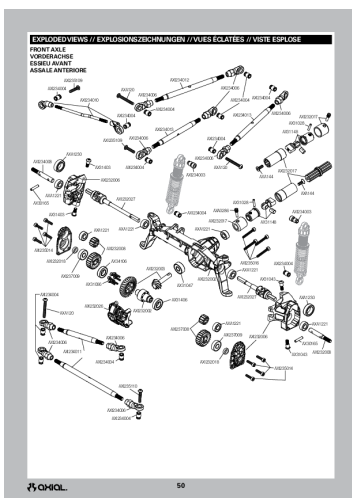

[\[pdf\]](#) User Manual

57023 AXI SCX 10 III Jeep Wrangler Manual MULTI indb garyhunt AXI03003T2 VIEW M Axial SCX10 JLW 1 RTR Orange CHF 659 00 09 rc3d ch mediafiles Downloads AXIAL |||

EXPLODED VIEWS // EXPLOSIONSZEICHNUNGEN // VUES CLATES // VISTE ESPLOSE FRONT AXLE VORDERACHSE ESSIEU AVANT ASSALE ANTERIORE AXI235109 AXI234004 AXI234010 AXA120 AXI234006 AXI234012 AXI234006 AXI234004 AXI234004 AXI234004 AXI234004 AXI235109 AXI234006 AXI234013 AXI234013 AXI234004 AXI234...

lang:i-klngon **score:19** filesize: 17.4 M page_count: 11 document date: 2020-06-16