

DELTA GR250

Delta Chrome Metal Glass Rinser (Model GR250) Instruction Manual

1. INTRODUCTION

This manual provides comprehensive instructions for the installation, operation, and maintenance of your Delta Chrome Metal Glass Rinser, Model GR250. Please read this manual thoroughly before installation and use to ensure proper function and longevity of the product.

2. SAFETY INFORMATION

Always follow basic safety precautions when installing or using this product to reduce the risk of injury or property damage.

- Ensure water supply is turned off before beginning installation.
- Wear appropriate personal protective equipment, such as safety glasses and gloves, during installation.
- Do not use abrasive cleaners or harsh chemicals on the product finish.
- This product is designed for rinsing drinkware. Do not use for purposes other than its intended use.
- Keep children away from the installation area.

3. PACKAGE CONTENTS

Verify that all components are present before beginning installation:

- Metal Glass Rinser Unit
- Supply Line
- Tee Adapter
- Installation Hardware



Image: The Delta Chrome Metal Glass Rinser unit, showing its sleek design and chrome finish.

4. INSTALLATION INSTRUCTIONS

The Delta Glass Rinser is designed for a simple DIY installation, typically replacing an existing soap dispenser, kitchen sprayer, or sink hole cover.

4.1 Pre-Installation Requirements

- **Countertop Hole:** Requires an empty countertop hole.
- **Clearance:**
 - At least 2 inches between faucet and installation hole.
 - At least 4 inches between sink and backsplash.
 - No more than 2 1/4 inches from installation hole to sink.
- **Deck Thickness:** Maximum 2.5 inches.
- **Water Supply:** Connects to either hot or cold water using the included supply line and tee adapter.

HOLES FOR INSTALLATION

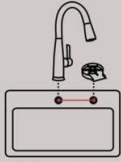

At least 2" between faucet and installation hole

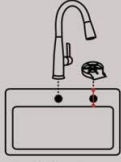

At least 4" between sink and backsplash

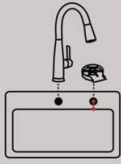

No more than 2 1/4" from installation hole to sink

DIMENSIONS

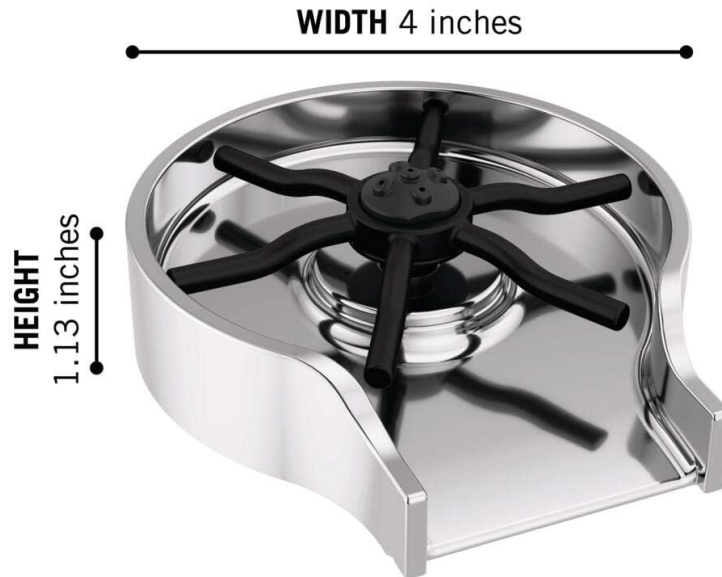

ADDITIONAL INFORMATION

MAXIMUM DECK THICKNESS
2.5 inches

SUPPLY LINE
Included

WATER SUPPLY
Connect to hot or cold



Image: Diagram illustrating the required clearances and dimensions for installing the glass rinser, including distance from faucet, backsplash, and sink edge, as well as maximum deck thickness.

4.2 Installation Steps

- 1. Prepare the Hole:** If replacing an existing fixture (soap dispenser, sprayer, or hole cover), remove it. Ensure the countertop hole is clean and clear.
- 2. Mount the Rinser:** Insert the glass rinser unit into the prepared hole. Secure it from underneath the countertop using the provided hardware.
- 3. Connect Water Supply:**
 - Turn off the main water supply to your sink.
 - Locate the hot or cold water supply line under your sink.
 - Install the included tee adapter onto the chosen water supply line.
 - Connect the included supply line from the glass rinser to the tee adapter.
 - Ensure all connections are tight to prevent leaks.
- 4. Test for Leaks:** Slowly turn the main water supply back on and check all connections for any leaks. Tighten if necessary.

A SIMPLE SWAP TO TRANSFORM YOUR KITCHEN



see what Delta can do™



SIMPLY REMOVE EXISTING SOAP DISPENSER, SIDE SPRAYER OR SINK HOLE COVER FROM STANDARD COUNTERTOP OR SINK HOLE



EASILY INSTALL GLASS RINSER USING INCLUDED SUPPLY LINE THAT CAN BE CONNECTED TO EITHER HOT OR COLD WATER SUPPLY



WATCH AS POWERFUL WATER JETS RINSE STUBBORN RESIDUE IN SECONDS

Image: Visual guide showing the three main steps for installation: removing an old fixture, installing the rinser base, and demonstrating its function.

5. OPERATING INSTRUCTIONS

The Delta Glass Rinser is designed for efficient and thorough rinsing of various drinkware.

1. **Position Drinkware:** Place the mouth of the glass, bottle, or cup face down over the rinser's star-shaped base.
2. **Activate Rinser:** Gently press down on the drinkware. This action activates powerful water jets that spray upwards, thoroughly rinsing the interior of the item.
3. **Rinse Residue:** The high-pressure water jets effectively remove residue from hard-to-reach areas. The subtle overhang of the rinser directs the water flow directly into the kitchen sink for easy cleanup.
4. **Release:** Lift the drinkware off the rinser to stop the water flow.



FORGET SOAKING AND SCRUBBING

POWERFUL WATER JETS THOROUGHLY
RINSE RESIDUE IN SECONDS

SUBTLE OVERHANG DIRECTS WATER
FLOW INTO SINK FOR EASY CLEANUP



see what Delta can do™

Image: A person demonstrating the use of the Delta Glass Rinser, cleaning a blender cup with powerful water jets, highlighting the efficient residue removal.

THE POWER OF CONVENIENCE



Image: A row of different drinkware items, including baby bottles, wine glasses, and travel cups, being rinsed simultaneously by multiple Delta Glass Rinsers, showcasing its versatility.



Image: A close-up view of the Delta Glass Rinser in action, effectively cleaning the inside of a tall glass, demonstrating its ability to reach difficult areas.

5.1 Product Video Overview

Watch this video for a visual demonstration of the Delta Glass Rinser's features and operation.

Your browser does not support the video tag.

Video: An official product video demonstrating the installation and various uses of the Delta Glass Rinser, including cleaning different types of drinkware.

6. CARE AND MAINTENANCE

Proper care and maintenance will ensure the longevity and optimal performance of your Delta Glass Rinser.

- **Cleaning the Finish:** Clean the chrome finish with a soft, damp cloth. Avoid using abrasive cleaners, harsh chemicals, or scouring pads, as these can damage the finish.
- **Cleaning the Sprayer:** Periodically remove any debris that may accumulate around the sprayer nozzles to maintain optimal water pressure.
- **Corrosion Resistance:** The Brilliance finish is engineered for durability and tested for corrosion resistance to at least 2 times industry standards.

7. TROUBLESHOOTING

If you encounter issues with your Delta Glass Rinser, refer to the following common problems and solutions:

Problem	Possible Cause	Solution
No water flow or weak spray.	Water supply is off, supply line kinked, or nozzles are clogged.	Ensure water supply is on. Check for kinks in the supply line. Clean any debris from the sprayer nozzles.
Leaks at connections.	Loose connections or damaged seals.	Turn off water supply. Tighten all connections. Inspect and replace seals if damaged.
Water does not drain properly into the sink.	Rinser not positioned correctly or drain path is obstructed.	Ensure the rinser's overhang is correctly positioned over the sink. Check for any obstructions in the drain path.

8. SPECIFICATIONS

Feature	Detail
Model Number	GR250
Brand	DELTA
Color	Chrome
Material	Brass
Installation Type	Countertop
Product Dimensions	4.5 x 4 x 1.5 inches
Item Weight	2.32 pounds
UPC	034449964081

9. WARRANTY AND SUPPORT

Your Delta Glass Rinser is backed by a Limited Lifetime Warranty, ensuring quality and durability.

- **Warranty Description:** Limited Lifetime Warranty.
- **Manufacturer:** Delta Faucet Company.



Image: The official Delta Lifetime Limited Warranty logo, signifying product quality and manufacturer support. For technical assistance, warranty claims, or any questions regarding your product, please contact Delta Faucet Company customer support.



Image: A Delta Faucet Company customer service representative, indicating available support. Contact information may be found on the official Delta website or product packaging.