

CATCHFACE FBA-G01

CATCHFACE TTLock Smart Lock User Manual

Model: FBA-G01

1. PRODUCT OVERVIEW

The CATCHFACE TTLock Smart Lock offers advanced 4-in-1 keyless entry for enhanced security and convenience. It integrates fingerprint recognition, anti-peep virtual password entry, smartphone access via the TT Lock app, and traditional physical keys. This smart lock is designed for easy DIY installation and is suitable for various applications including homes, apartments, and co-working spaces.

Key features include:

- **Advanced 4-in-1 Keyless Entry:** Fingerprint recognition, anti-peep virtual password entry, smartphone access, and physical keys (2 included).
- **USB + Backup Key:** Low battery alarms via the TT Lock app and a micro USB port for temporary power supply in emergencies. Physical keys provide a fail-safe option.
- **Wide Compatibility:** Fits door thicknesses from 1.38 to 1.97 inches (35 to 50mm) with an adjustable deadbolt size of 2.36 to 2.76 inches (60 to 70mm). Replaces standard single-cylinder U.S. door locks and fits both left and right-handed doors.
- **Remote Control & Management:** Ideal for rental hosts and homeowners, allowing creation and sharing of virtual keys (permanent or scheduled), monitoring access, and remote lock/unlock via the TT Lock App. Optional CATCHFACE WiFi Gateway (sold separately) enables Amazon Alexa and Google Home integration.
- **Intelligent Management:** Supports fingerprints and multiple user codes, with options for one-time, permanent, scheduled, and recurring codes.
- **App & Web Portal Control:** Manage the smart lock via smartphone, generate eKeys, manage users, and view access records using the free app and website management system.

2. PACKAGE CONTENTS

Your CATCHFACE Smart Lock package includes all necessary components for installation and operation:

Accessories

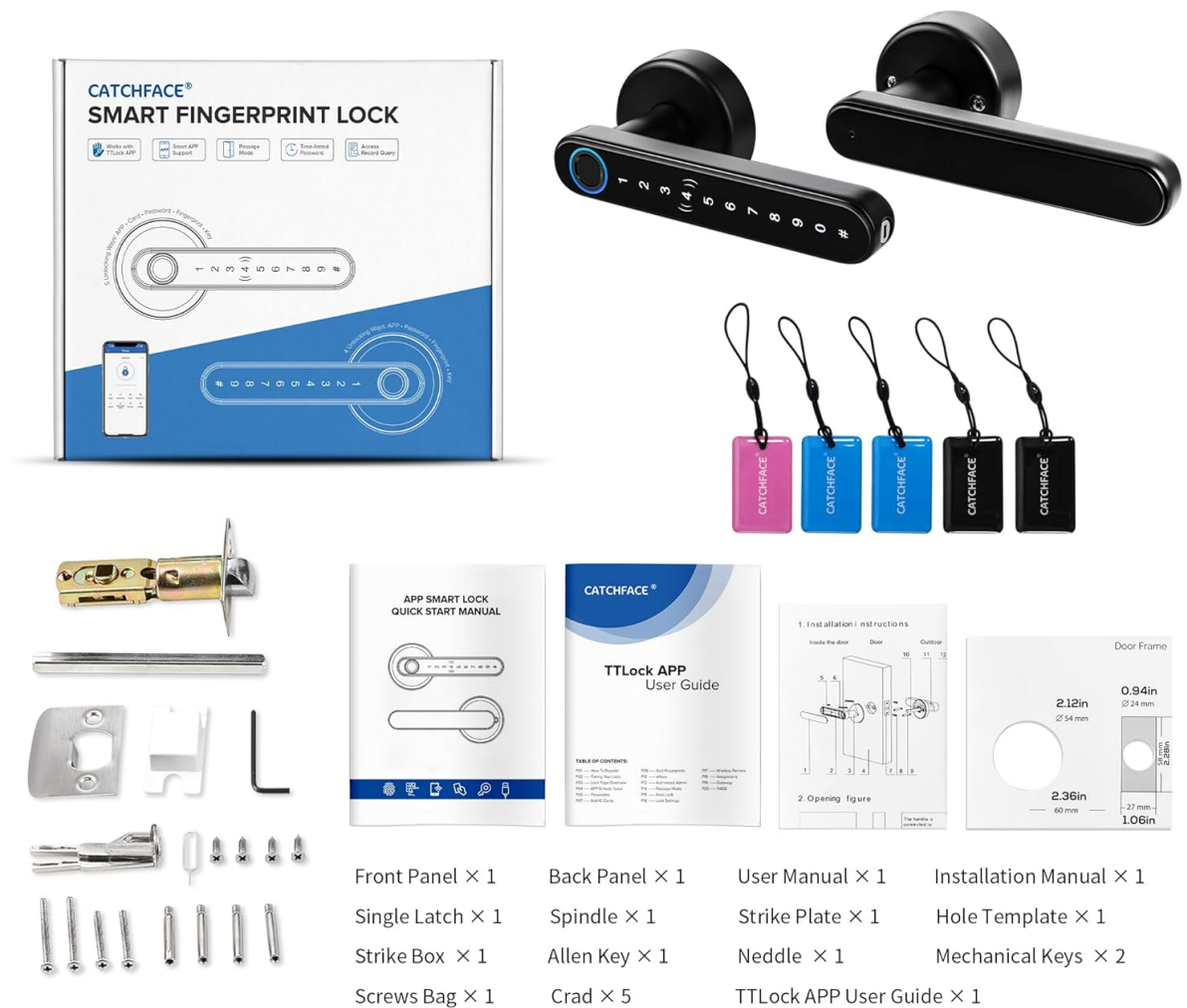

Figure 2.1: All components included in the CATCHFACE Smart Lock package.

- 1 x Smart Lock (Front Panel with keypad and fingerprint sensor)
- 1 x Back Panel (Interior handle with battery compartment)
- 1 x 60/70mm Adjustable Backset Latch
- 1 x Latch Box and Strike Plate
- 1 x Spindle
- 1 x Allen Key
- 1 x Installation Screws Bag
- 2 x Mechanical Keys
- IC Cards (quantity may vary based on package)
- 1 x User Manual (physical copy)
- 1 x Installation Manual (physical copy)
- 1 x Hole Template

3. INSTALLATION GUIDE

The CATCHFACE Smart Lock is designed for easy DIY installation. A physical installation pamphlet and a

hole template are included in the box. For a visual step-by-step guide, please refer to the official installation video provided by the seller.

Your browser does not support the video tag. This video demonstrates the unboxing and initial setup of the CATCHFACE Smart Lock, including a look at the included components and the various manuals. It highlights the ease of use of the TT Lock app for remote control and password sharing. The video also briefly touches on the physical installation process and the different unlocking methods.

Video 3.1: CATCHFACE Smart Lock Unboxing and Overview

The lock is compatible with most standard U.S. door sizes. Ensure your door thickness and backset size match the product specifications for proper fit.

Compatible with old mortise size

- Easy to replace original lock without any damage -

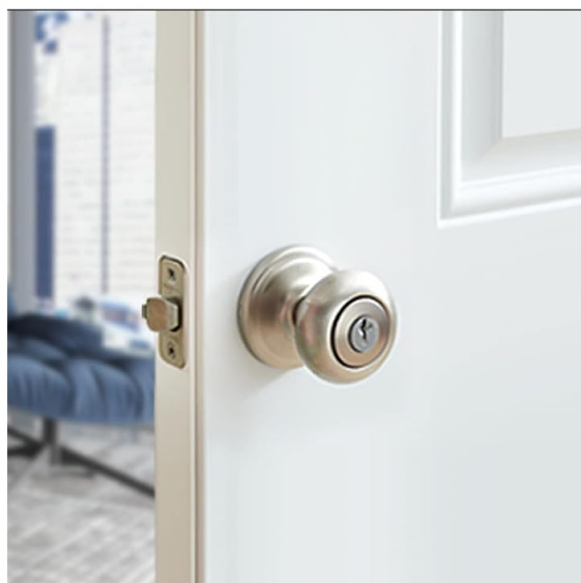

Original



Replace

Figure 3.1: The CATCHFACE Smart Lock is designed to easily replace existing mortise locks without damage.



Figure 3.2: The smart lock is compatible with various door types and includes adjustable latch for easy installation. For detailed installation steps, refer to the User Manual (PDF) provided with your product or available online: [User Guide \(PDF\)](#) and [User Manual \(PDF\)](#).

4. OPERATING YOUR SMART LOCK

The CATCHFACE Smart Lock offers multiple convenient ways to unlock your door:

4.1 Fingerprint Unlock

The biometric fingerprint sensor provides quick and secure access. Simply place your registered finger on the sensor for instant unlocking.



Figure 4.1: The fingerprint sensor offers sensitive recognition and fast unlocking in 0.3 seconds, with 360° fingerprint recognition and storage for up to 100 fingerprints.

Figure 4.2: Biometric fingerprint quick unlock with a low false recognition rate, suitable for all ages.

4.2 Passcode Unlock

Enter your unique numerical code on the backlit touch keypad. The anti-peep virtual password feature allows you to enter random numbers before or after your actual code to prevent others from guessing your password.

Requires CATCHFACE Gateway (Sold Separately)



Figure 4.3: Anti-peeping password allows adding random numbers before or after your real password. The keypad is backlit for easy use at night.

4.3 IC Card Unlock

For users who prefer not to use a smartphone, IC cards provide a convenient and secure unlocking method. Simply tap the card on the lock to gain entry.



Figure 4.4: Smart Card Unlock is perfect for individuals who prefer not to use a smartphone, such as children and the elderly.

4.4 Physical Key Unlock

Two mechanical keys are included as a traditional backup method for unlocking the door.

4.5 Auto-Lock Function

The smart lock features an auto-lock function for added security. It will automatically lock after a set period of time.

5. ADVANCED FEATURES & MANAGEMENT

5.1 TT Lock App Control

The TT Lock app allows comprehensive control over your smart lock from your smartphone. You can

monitor lock status, send eKeys, manage users, and check operation logs.



Figure 5.1: The TTLock Smart APP allows you to manage your lock anywhere, anytime.

5.2 Multiple Passcode Types

Generate various types of passcodes to suit different needs:

- **Permanent Passcode:** For long-term access.
- **Timed Passcode:** Valid for a specific duration, ideal for guests or service providers.
- **One-Time Passcode:** For single-use access.
- **Recurring Passcode:** For regular, repeated access on specific days/times.
- **Custom Passcode:** Create personalized codes.

Multiple Passcode Types Available



Figure 5.2: The TT Lock app supports multiple passcode types for flexible access management.

5.3 Access Logs

Keep track of who enters and exits your property with real-time access logs available in the app.

View Unlock Record anywhere anytime

Monitor who has accessed the door lock in real time

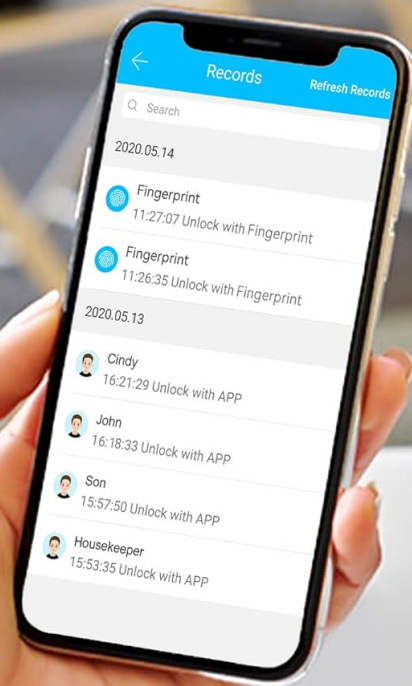
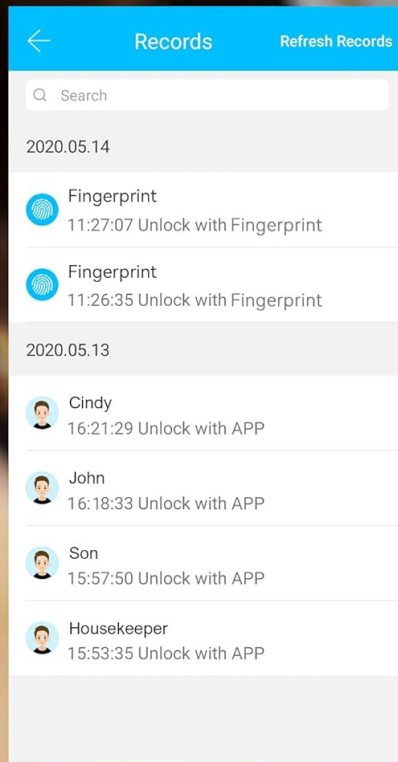

Figure 5.3: Monitor who has accessed the door lock in real time with detailed unlock records.

5.4 Remote Control (Requires Gateway)

For remote lock/unlock functionality and integration with smart home systems like Amazon Alexa and Google Home, the optional CATCHFACE WiFi Gateway (ASIN: B085HFFF9T) is required.

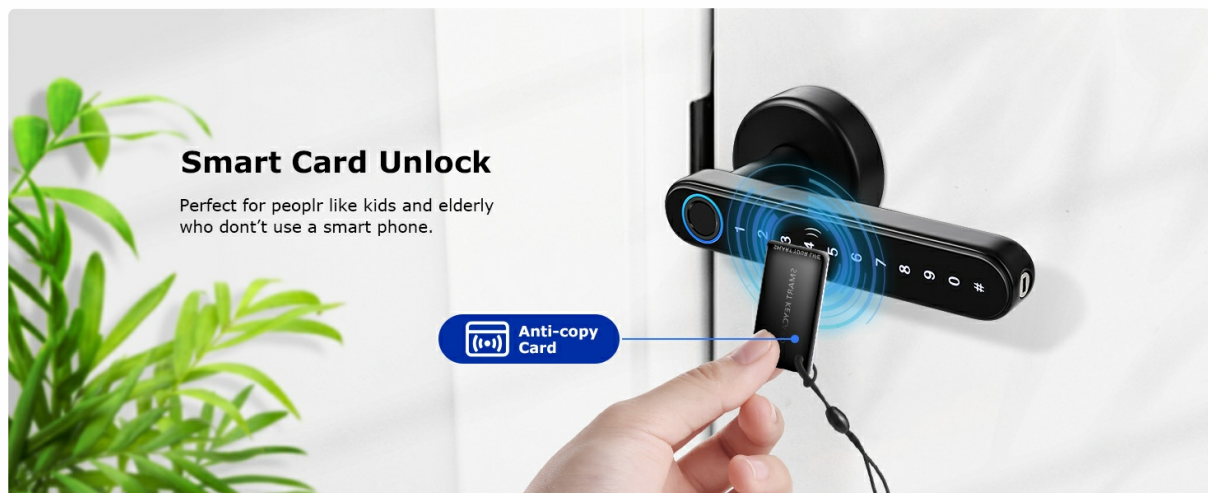

Figure 5.4: The CATCHFACE WiFi Gateway (sold separately) enables remote control and voice commands via smart assistants.

5.5 Versatile Applications

The smart lock's management features make it suitable for various environments, including Airbnb, homes, offices, and schools.

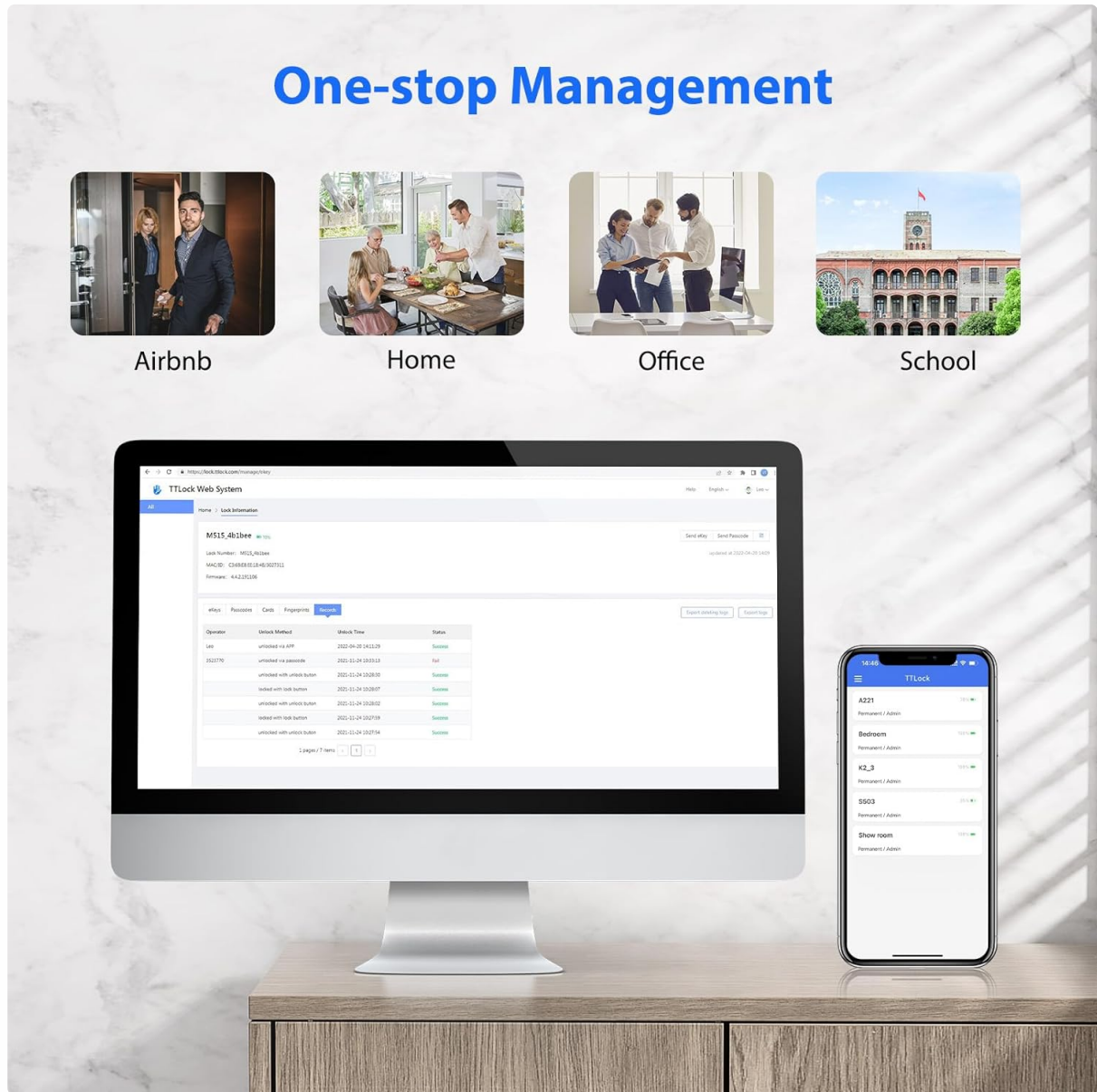

Figure 5.5: One-stop management for various applications.

6. PRODUCT SPECIFICATIONS

Feature	Detail
Brand	CATCHFACE
Model Name	FBA-G01
Color	Black
Material	Zinc
Item Weight	2 Pounds

Product Dimensions	5.8 x 2.5 x 2.8 inches
Lock Type	App control smart door lock, Biometric door lock with fingerprint, Digital touch screen door lock, Smart door lock with key
Special Features	Anti-Peeping Password, Auto-Lock, Back-Lit Keypad, One-Touch Lock, Passcode Unlock
Included Components	1 x smart lock, 1x 60/70mm adjustable backset latch, 1x installation crews bag, 1x latch box and strike plate, 2 x mechanical keys
Controller Type	Amazon Alexa, Android, Google Assistant, iOS
Connectivity Protocol	Bluetooth, Wi-Fi (with optional Gateway)



Adjustable Single Latch

Center distance can be adjusted to 70mm

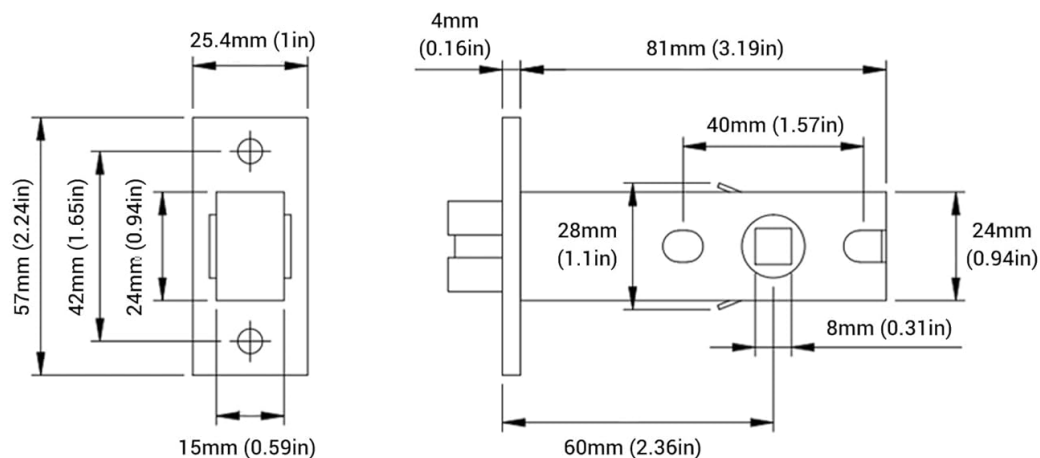

Figure 6.1: Detailed dimensions and adjustable single latch mechanism.

7. MAINTENANCE

To ensure optimal performance and longevity of your CATCHFACE Smart Lock, regular maintenance is recommended:

- **Battery Replacement:** The lock is powered by 4 AAA alkaline batteries. The TT Lock app will provide low battery alerts. Replace batteries promptly when indicated.
- **Emergency Power:** In case of complete battery drain, use a micro USB power bank to temporarily power the lock via the port located on the handle.
- **Cleaning:** Wipe the lock surface with a soft, dry cloth. Avoid using abrasive cleaners or solvents that could damage the finish or electronic components.



Figure 7.1: The smart lock is powered by 4 AAA batteries and features a micro USB port for emergency charging.

8. TROUBLESHOOTING

If you encounter any issues with your CATCHFACE Smart Lock, consider the following general troubleshooting tips:

- **Lock Not Responding:** Check battery levels in the TT Lock app. If batteries are low, replace them or use the micro USB port for temporary power.
- **Fingerprint Not Recognized:** Ensure your finger is clean and dry. Try re-registering your fingerprint in the app if the issue persists.
- **Passcode Issues:** Verify the correct passcode. Utilize the anti-peep virtual password feature correctly. If you suspect the passcode has been compromised, change it immediately via the app.
- **App Connectivity Problems:** Ensure Bluetooth is enabled on your smartphone and you are within range of the lock. If using a Gateway, ensure it is properly connected to Wi-Fi and powered on.
- **Physical Key Not Working:** Ensure the key is fully inserted and turned correctly. If the lock is jammed, do not force it.
- **Resetting the Lock:** If persistent issues occur, you may need to perform a factory reset. Refer to the user manual for specific instructions on how to reset the device.

For further assistance, please consult the detailed user manual or contact CATCHFACE customer support.



9. WARRANTY & SUPPORT

For information regarding product warranty, please refer to the warranty section within the comprehensive User Manual (PDF) provided with your purchase. This document outlines the terms and conditions of the product warranty.

For technical support and customer service inquiries, please refer to the contact information provided in your User Manual or visit the CATCHFACE official website.

User Manual (PDF): [User Guide \(PDF\)](#) and [User Manual \(PDF\)](#)

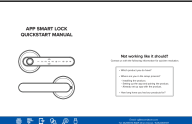
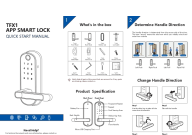
Related Documents - FBA-G01

	<p>TTLock APP User Guide - CATCHFACE Smart Lock Instructions</p> <p>Comprehensive user guide for the TTLock App, detailing how to register, pair, and operate CATCHFACE smart locks, including features like passcodes, eKeys, fingerprints, and remote access.</p>
	<p>CATCHFACE APP Smart Lock Quickstart Manual - Installation, Features, and FAQs</p> <p>Comprehensive quickstart guide for the CATCHFACE APP Smart Lock. Learn about installation, safety warnings, accessories, product specifications, operation videos, and frequently asked questions for keyless entry and smart home security.</p>
	<p>TFX1 Smart Lock Quick Start Manual: Installation and Operation Guide</p> <p>Comprehensive quick start guide for the TFX1 Smart Lock by CATCHFACE, covering unboxing, handle direction, installation, TTLock app operation, and frequently asked questions. Learn how to install and use your keyless entry smart lock.</p>
	<p>CATCHFACE APP Smart Lock Quickstart Manual and Installation Guide</p> <p>Comprehensive guide to installing and operating the CATCHFACE APP Smart Lock, including safety warnings, troubleshooting, and FAQs. Learn how to set up your keyless entry door lock.</p>