

**IKTCH IKP04-36**

# IKTCH 36-inch Wall Mount Range Hood User Manual

Model: IKP04-36"

Brand: IKTCH

## 1. INTRODUCTION

Thank you for choosing the IKTCH 36-inch Wall Mount Range Hood. This manual provides essential information for the safe and efficient operation, installation, and maintenance of your new appliance. Please read this manual thoroughly before installation and use, and keep it for future reference.

This range hood is designed to effectively remove smoke, grease, and cooking odors from your kitchen, ensuring a cleaner and more comfortable cooking environment. It features a powerful 900 CFM motor, versatile ducted/ductless conversion options, intuitive gesture sensing and touch controls, and adjustable LED lighting.



Image: Front view of the iKTCH 36-inch Wall Mount Range Hood.

## 2. SAFETY INFORMATION

Always adhere to basic safety precautions when using electrical appliances to reduce the risk of fire, electric shock, or injury to persons.

### General Safety Warnings:

- Ensure the power supply matches the voltage specified on the rating label.
- Installation must be performed by a qualified technician in accordance with all local codes and standards.
- Do not operate the range hood if the power cord or plug is damaged.
- Regularly clean grease filters to prevent grease buildup, which can be a fire hazard.
- Never leave cooking unattended, especially when using high heat.

- Do not flambé under the range hood.
- Ensure adequate ventilation in the room when the range hood is used simultaneously with gas or other fuel-burning appliances.
- This appliance is not intended for use by persons (including children) with reduced physical, sensory or mental capabilities, or lack of experience and knowledge, unless they have been given supervision or instruction concerning use of the appliance by a person responsible for their safety.

### 3. COMPONENTS AND WHAT'S IN THE BOX

Your IKTCH Range Hood package includes the following items:

- Range Hood Unit
- Remote Control
- Charcoal Filter (for ductless operation)
- LED Lights (pre-installed)
- Mounting Hardware (screws, expansion bolts, brackets)
- Ducting (flexible aluminum duct)
- Vent Adapter
- Chimney Pieces (upper and lower)



Image: Detailed view highlighting key components of the range hood.

## 4. SETUP AND INSTALLATION

The IKTCH Wall Mount Range Hood can be installed in either ducted or ductless (recirculating) configurations. Ensure you have the necessary tools and follow all local building codes.

### Installation Overview:

1. **Preparation:** Measure and mark the installation location on the wall, ensuring it is centered above your cooking surface. Refer to the provided dimensions for proper placement.
2. **Mounting Bracket Installation:** Secure the main mounting bracket to the wall using appropriate fasteners for your wall type.
3. **Range Hood Mounting:** Carefully lift and hang the range hood onto the installed mounting bracket. Secure it firmly.

#### 4. Ducting/Recirculation Setup:

- **Ducted Mode:** Connect the flexible aluminum duct to the vent adapter on the hood and extend it to your external ventilation system. Ensure all connections are sealed to prevent air leaks.
- **Ductless Mode:** Install the charcoal filters (included) into the range hood. These filters purify the air before recirculating it back into the kitchen. Do not install charcoal filters if using ducted mode.

5. **Chimney Installation:** Attach the lower chimney piece to the hood, then slide the upper chimney piece into place, extending it to the ceiling. Secure both chimney pieces.

6. **Electrical Connection:** Connect the range hood to a grounded electrical outlet.

## SIZE:

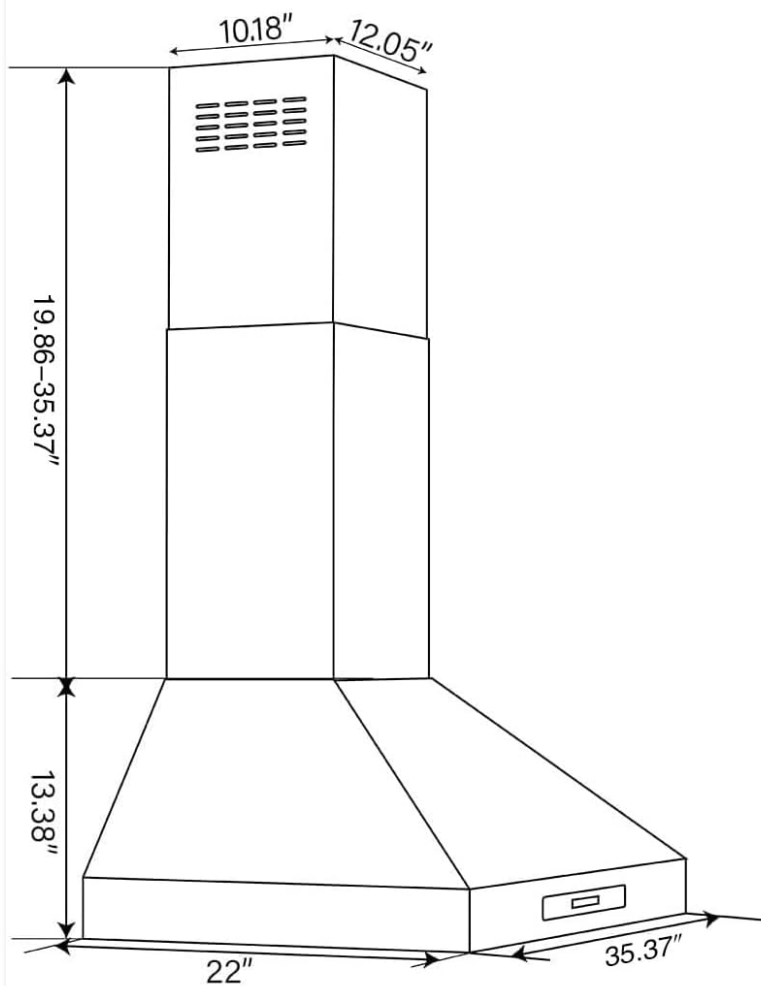

**Maximum Ceiling Height: 9.6ft.**  
**NOTE: Additional chimney extension pieces are not within our sales scope.**

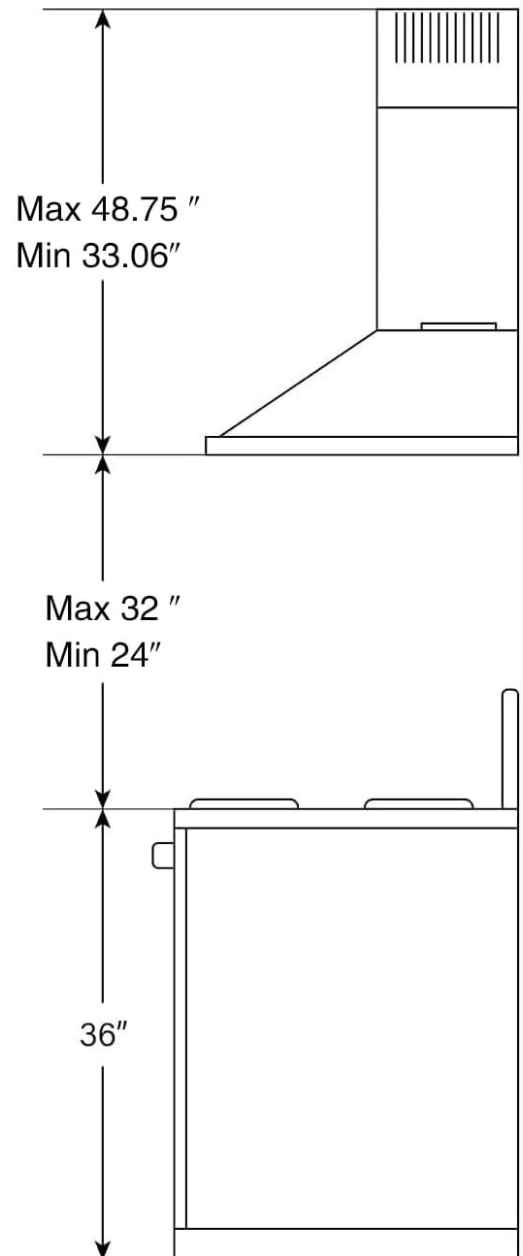
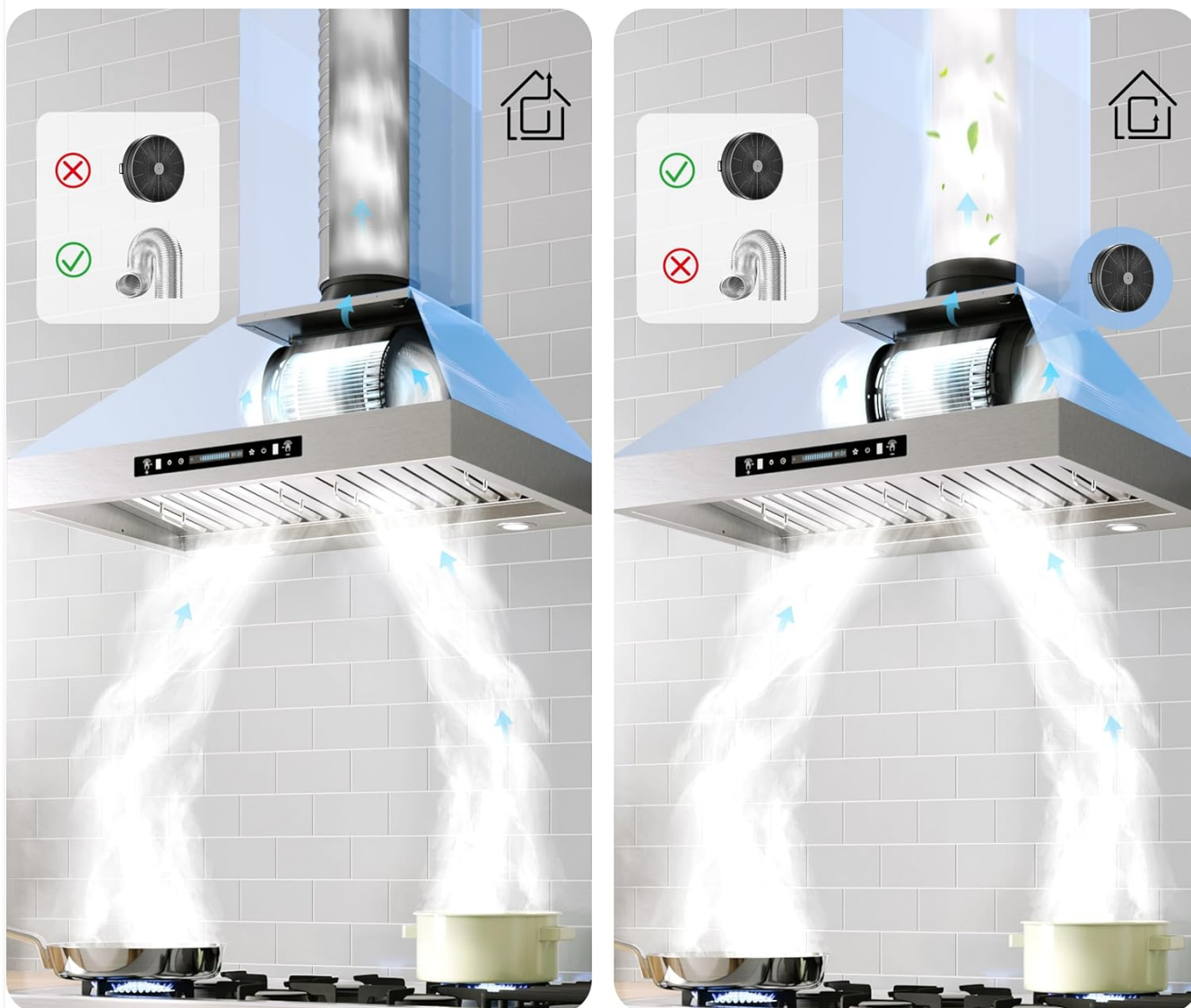

Image: Dimensional drawing of the range hood for installation planning.

# Ducted or Ductless – Install Your Way



Included: Duct / Charcoal Filter / Adapter

Note: Please do not install Charcoal Filter when installing the Duct Mode otherwise it will affect the suction and increase the noise

Image: Visual representation of ducted versus ductless setup.

## Installation Video Guide:

For a detailed visual guide on the installation process, please refer to the official IKTCH installation video:

Video: IKTCH Wall Mount Range Hood Installation Guide. This video demonstrates the step-by-step process of installing the range hood, including mounting, ducting, and chimney assembly.

## 5. OPERATING INSTRUCTIONS

Your IKTCH range hood is equipped with advanced controls for ease of use.

### Control Panel:

The range hood features a touch control switch panel and gesture sensing for convenient operation.



- **Power On/Off:** Use the power button on the touch panel or the gesture sensing feature to turn the unit on or off.
- **Fan Speed Adjustment:** The hood offers 4-speed settings (1-4) to accommodate various cooking needs, from light simmering to heavy frying. Adjust the speed using the touch buttons or by waving your hand across the gesture sensors.
- **Adjustable LED Lights:** The 4pcs 3W LED lights provide ample illumination for your cooking surface. Press the light button on the control panel to turn them on/off or adjust brightness.
- **Delay Off Timer:** Utilize the timer function to allow the hood to continue operating for a set period after cooking, ensuring all residual odors are cleared.

## Gesture Control

It doesn't matter if your hands are dirty, just wave the switch/adjust the fan.



Image: Demonstration of the gesture control feature.

### Performance:

- **Powerful Airflow:** With a maximum airflow of 900 CFM, the hood efficiently removes large amounts of smoke and cooking odors.
- **Ultra-Quiet Operation:** The 4-speed setting allows you to balance suction power with noise level. The noise level ranges from 40 decibels on the lowest setting to a maximum of 65dB.

# 900 CFM Powerful Suction

4 levels of wind speed to meet your different cooking environments.



Image: Visualizing the powerful 900 CFM suction.



# Low Noise Level

The noise of the range hood at the highest speed does not exceed 65 decibels.



Image: Illustrating the low noise level of the range hood.

## 6. MAINTENANCE

Regular maintenance ensures the longevity and optimal performance of your range hood.

### Cleaning Grease Filters:

The stainless steel baffle filters are dishwasher safe and easy to remove. It is recommended to clean them monthly, or more frequently depending on cooking habits, to maintain optimal airflow and prevent grease buildup.

1. To remove, locate the release latches on each filter and pull down.
2. Place filters in the dishwasher or wash by hand with hot, soapy water.
3. Ensure filters are completely dry before re-installing.

### Cleaning Exterior Surfaces:

Wipe the stainless steel surfaces with a soft cloth and a non-abrasive stainless steel cleaner. Avoid using abrasive pads or cleaners that could scratch the finish.

### Charcoal Filter Replacement (Ductless Mode Only):

If operating in ductless mode, the charcoal filters should be replaced every 3-6 months, depending on usage. Refer to the product manual or IKTCH website for compatible replacement filters.

## 7. TROUBLESHOOTING

If you encounter issues with your range hood, refer to the following common problems and solutions:

Problem	Possible Cause	Solution
Hood does not turn on	No power supply; circuit breaker tripped; loose connection	Check power plug, reset circuit breaker, ensure secure connections.
Poor suction	Clogged grease filters; improper ducting; charcoal filters saturated (ductless)	Clean or replace filters; check ducting for obstructions or leaks; replace charcoal filters.
Excessive noise	Loose fan components; improper installation; ducting issues	Check for loose parts; ensure proper installation; inspect ducting for kinks or restrictions.
Lights not working	Loose wiring; faulty LED module	Check electrical connections; contact customer support for replacement LED modules if necessary.

If the problem persists after attempting these solutions, please contact IKTCH customer support for assistance.

## 8. SPECIFICATIONS

Detailed technical specifications for the IKTCH 36-inch Wall Mount Range Hood (Model IKP04-36"):

- **Model:** IKP04-36
- **Brand:** IKTCH
- **Air Flow Capacity:** 900 Cubic Feet Per Minute (CFM)
- **Material:** Stainless Steel, Alloy Steel
- **Noise Level:** 65 dB (max)
- **Mounting Type:** Wall Mount
- **Controls Type:** Touch, Remote, Gesture Sensing
- **Voltage:** 128V
- **Number of Speeds:** 4
- **Item Weight:** 74 Pounds
- **Light Source Type:** LED (4pcs 3W adjustable brightness)
- **Filter Type:** Baffle (Dishwasher Safe Stainless Steel)
- **Product Dimensions:** 22.05"D x 35.75"W x 52.75"H
- **Country of Origin:** China
- **Certification:** ETL Certified

## 9. WARRANTY AND SUPPORT

IKTCH is committed to providing high-quality products and excellent customer service.

### Warranty:

Your IKTCH Range Hood comes with a 5-year protection plan, ensuring peace of mind regarding product quality and durability.

### Customer Support:

For any inquiries, technical assistance, or warranty claims, please contact IKTCH customer support. We strive to reply within 24 hours to address your concerns.

Visit the official IKTCH store on Amazon for more information and support resources: [IKTCH Store](#)