

[Manuals.plus](#) /

> [BAOSHISHAN](#) /

> BAOSHISHAN Electric Remote Control Rotating Turntable Display Table User Manual

BAOSHISHAN NJ-001

BAOSHISHAN Electric Remote Control Rotating Turntable Display Table User Manual

Model: NJ-001

1. INTRODUCTION

Thank you for choosing the BAOSHISHAN Electric Remote Control Rotating Turntable Display Table. This device is designed to provide a smooth, controlled rotation for displaying products, photography, and video recording. It features remote control operation, adjustable speed, and various rotation modes to enhance your display needs. Please read this manual carefully before operation to ensure proper use and longevity of the product.

2. SAFETY INSTRUCTIONS

- Ensure the turntable is placed on a stable, level surface before use.
- Do not exceed the maximum weight capacity of 40 kg (88 lbs).
- Keep the device away from water or other liquids to prevent electric shock.
- Do not attempt to disassemble or repair the unit yourself. Contact qualified personnel for service.
- Keep out of reach of children.
- Use only the provided power adapter.

3. PACKAGE CONTENTS

Please check the package for the following items:

- Electric Rotating Turntable

- Remote Control
- Power Adapter (220V Power Cord)
- ABS Plastic Background Plates (various colors)



Image: Included ABS plastic background plates in various colors, including black with matte and glossy sides.

4. SETUP

1. Place the turntable on a flat, stable surface.
2. Connect the power adapter to the power socket on the side of the turntable.
3. Plug the power adapter into a suitable 220V power outlet.
4. Turn on the main power switch located next to the power socket on the turntable.
5. Place the item you wish to display on the center of the turntable. Ensure the item's diameter does not significantly exceed the turntable's diameter (40cm) for optimal stability, especially for heavier objects. Lighter objects may extend slightly beyond the edge.



Image: Diagram showing the turntable dimensions (40cm diameter) and the recommended maximum item diameter, along with the 40kg weight capacity.

EASY OPERATION



Voltage: 220V

Diameter: 40cm

Max load: 40kg

Material: ABS plastic

Speed: 24-68s/r

Remote control: ≤5m

Image: Close-up of the turntable's power socket and switch, along with the remote control and key specifications.

5. OPERATING INSTRUCTIONS

5.1 Remote Control Functions

KEY SEDCRIPTION

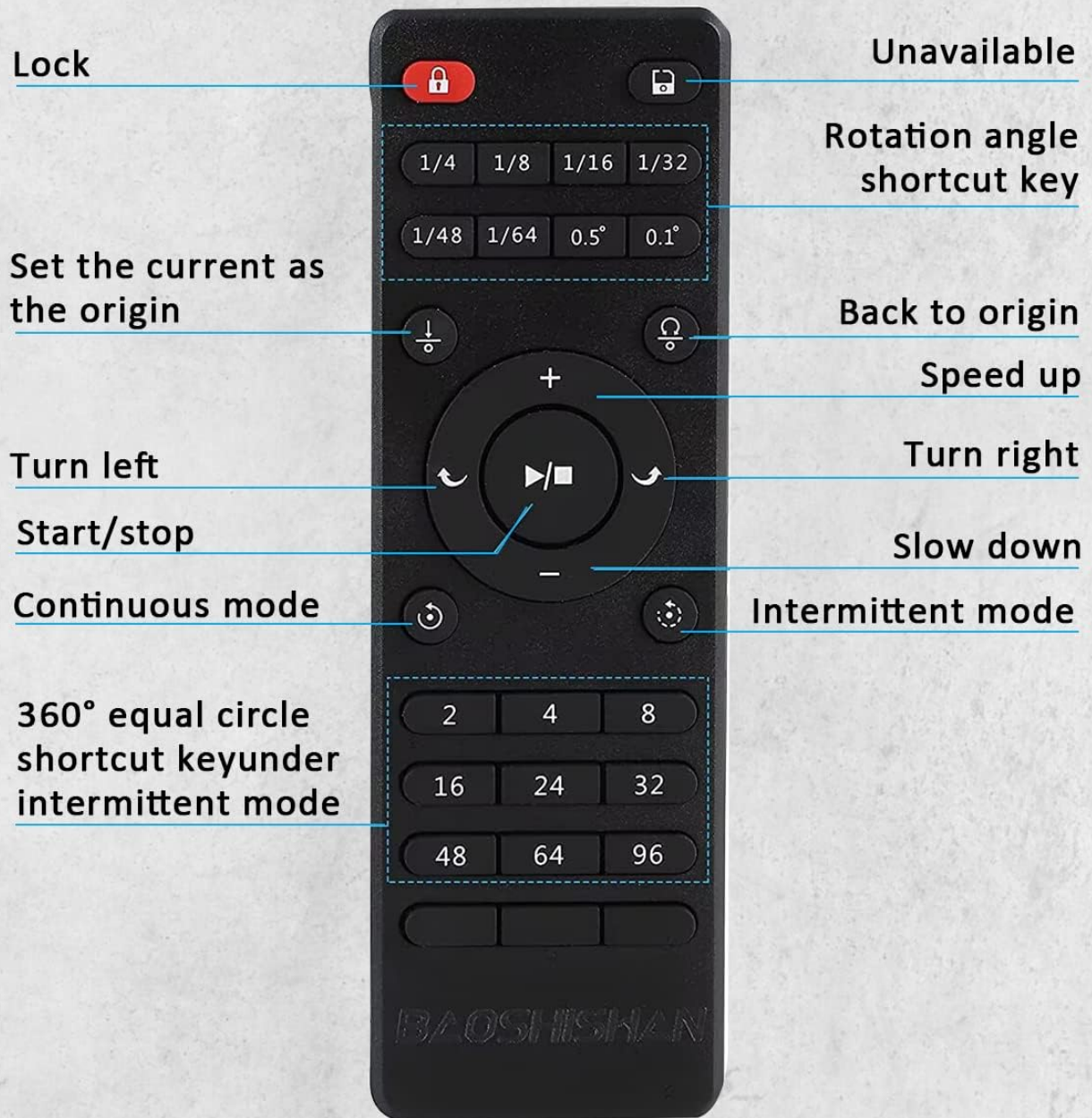

Image: Detailed diagram of the remote control with labels for each button's function.

- **Lock ()**: Locks the remote control to prevent accidental presses.
- **Rotation Angle Shortcut Keys (1/4, 1/8, 1/16, 1/32, 1/48, 1/64, 0.5°, 0.1°)**: These buttons allow for precise, incremental rotation. For example, 1/4 rotates the turntable by 90 degrees (360/4).
- **Set Current as Origin ()**: Sets the current position of the turntable as the starting point for subsequent operations.
- **Back to Origin ()**: Returns the turntable to the previously set origin point.
- **Speed Up (+)**: Increases the rotation speed.
- **Slow Down (-)**: Decreases the rotation speed.

- **Turn Left (◀):** Rotates the turntable counter-clockwise.
- **Turn Right (▶):** Rotates the turntable clockwise.
- **Start/Stop (▶■):** Starts or stops the rotation.
- **Continuous Mode (∞):** Activates continuous rotation.
- **Intermittent Mode ():** Activates intermittent rotation, where the turntable rotates, pauses, and then rotates again.
- **360° Equal Circle Shortcut Keys (2, 4, 8, 16, 24, 32, 48, 64, 96):** These keys are used in intermittent mode to divide a full 360-degree rotation into equal segments. For example, pressing '8' will make the turntable rotate in 45-degree increments (360/8) with pauses in between.

5.2 Rotation Direction

The turntable supports both clockwise and counter-clockwise rotation. Use the 'Turn Left' (◀) or 'Turn Right' (▶) buttons on the remote control to select the desired direction.

SUPPORT CLOCKWISE & COUNTERCLOCKWISE ROTATION

Rotate back and forth, stop and start is really easy to do as you just push a button.



Image: Illustration showing the turntable rotating both clockwise and counter-clockwise, controlled by the remote.

5.3 Intermittent Rotation with Multiple Angles

The intermittent mode allows you to rotate the turntable to fixed points for photography or detailed viewing. Press the 'Intermittent Mode' button (), then select one of the 360° Equal Circle Shortcut Keys (e.g., 2, 4, 8, 16, etc.). The turntable will rotate by the corresponding angle, pause for approximately three seconds, and then continue to the next segment if no further operations are performed.

PARTIAL ROTATION WITH MULTIPLE ANGLES

There are buttons that will spin the turntable to fixed points and you just take a shot. Move different increments so that you can take photos of the subject from every angle.

For example, if you press the "8" key, the turntable will pause for three seconds every 45 ° rotation. If there are no other operations, the turntable will continue to rotate at this pace.



Image: Examples of intermittent rotation, showing how pressing '48' results in 7.5° increments and '8' results in 45° increments.

6. MAINTENANCE

- Clean the turntable surface with a soft, dry cloth. Do not use abrasive cleaners or solvents.
- Ensure the power is disconnected before cleaning.
- Store the turntable in a dry, dust-free environment when not in use.

7. TROUBLESHOOTING

- **Turntable does not rotate:**

- Check if the power adapter is securely connected and plugged into a live outlet.
- Ensure the main power switch on the turntable is in the 'ON' position.
- Verify the remote control batteries are not depleted.
- Ensure no objects are obstructing the turntable's movement.

- **Rotation is uneven or jerky:**

- Ensure the item placed on the turntable is centered and its weight does not exceed the maximum capacity.
- Check if the turntable is on a stable and level surface.

- **Remote control not responding:**

- Replace the remote control batteries.
- Ensure there are no obstructions between the remote control and the turntable's receiver.
- Check if the 'Lock' button on the remote is disengaged.

8. SPECIFICATIONS

Brand	BAOSHISHAN
Model Number	NJ-001
Material	Metal (internal components), ABS Plastic (housing)
Color	White
Diameter	40 cm
Maximum Load Capacity	40 kg
Voltage	220V
Rotation Speed	24-68 seconds per revolution (adjustable)
Remote Control Range	Up to 5 meters

9. WARRANTY AND SUPPORT

BAOSHISHAN products are designed for quality and reliability. For warranty information or technical support, please refer to the purchase documentation or contact your retailer. Keep your purchase receipt as proof of purchase.

