

Insta360 GPS Smart Remote

Insta360 GPS Smart Remote User Manual

Model: GPS Smart Remote

INTRODUCTION

The Insta360 GPS Smart Remote is designed to provide seamless remote control for your Insta360 ONE R, ONE RS, ONE X, and ONE X2 cameras. Beyond basic camera control, it records and tracks essential GPS data, including speed, altitude, and direction, enhancing your captured footage with valuable telemetry. This manual provides detailed instructions for setup, operation, maintenance, and troubleshooting to ensure optimal performance of your device.

WHAT'S IN THE BOX

Verify that all the following items are included in your package:

- 1x GPS Smart Remote
- 1x Wrist Strap
- 1x Silicone Case
- 1x USB Charge Cable
- 1x User Manual
- 1x EVO Gimbals cleaning cloth

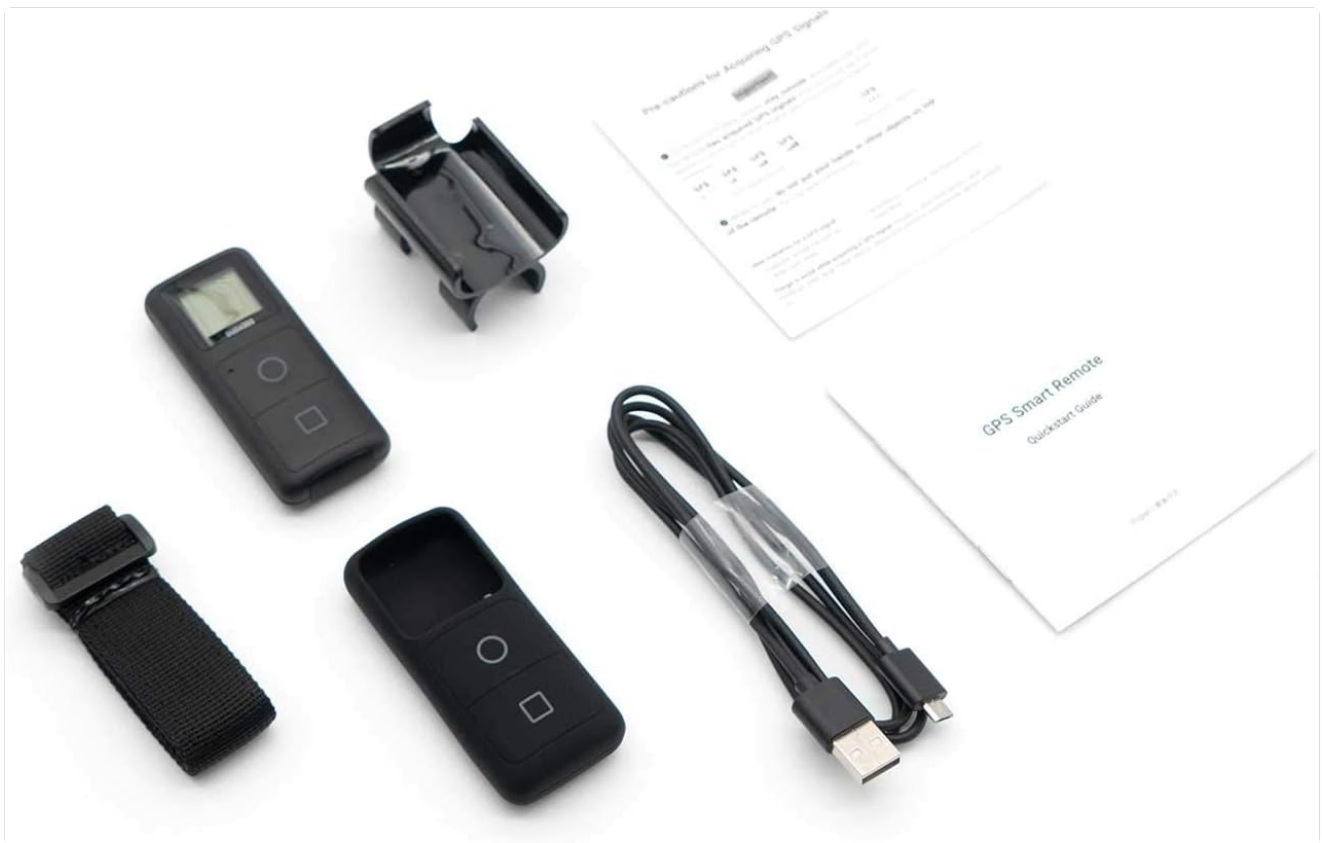

Image: All components included in the Insta360 GPS Smart Remote package.

SETUP

1. Charging the Remote

Before first use, fully charge the GPS Smart Remote. Connect the included USB Charge Cable to the Micro USB port on the remote and to a 5V/1A charging station. A full charge typically takes approximately 2 hours. The display will indicate charging status.

2. Pairing with Your Camera

To pair the remote with your Insta360 camera (ONE R/RS or ONE X/X2):

1. Ensure your camera is powered on and in pairing mode.
2. Power on the GPS Smart Remote.
3. Navigate to the Bluetooth pairing settings on both devices and initiate the connection.
4. **Important Note:** If you experience difficulty pairing, ensure that your camera is *not* simultaneously connected to the Insta360 mobile application. Disconnect from the app before attempting to pair with the remote.

3. Acquiring GPS Signal

For accurate GPS data recording, the remote needs to acquire a satellite signal. For best performance:

- Operate in an open outdoor area with a clear view of the sky.
- Keep the GPS Smart Remote away from significant electrical interference, large buildings, and tall objects.
- Remain stationary for a short period until the GPS icon on the remote's display indicates a stable signal.

OPERATING THE REMOTE

Basic Controls

The remote features a simple interface for controlling your camera:

- **Record Button:** Press to start/stop video recording.
- **Shutter Button:** Press to capture a photo.
- The 1-inch display provides real-time information such as recording status, battery level, and GPS signal strength.

GPS Data Tracking

Once connected and a GPS signal is acquired, the remote will automatically record GPS data during your video recordings. This data can be overlaid onto your footage using the Insta360 mobile app or desktop software, displaying metrics like speed, altitude, and direction.

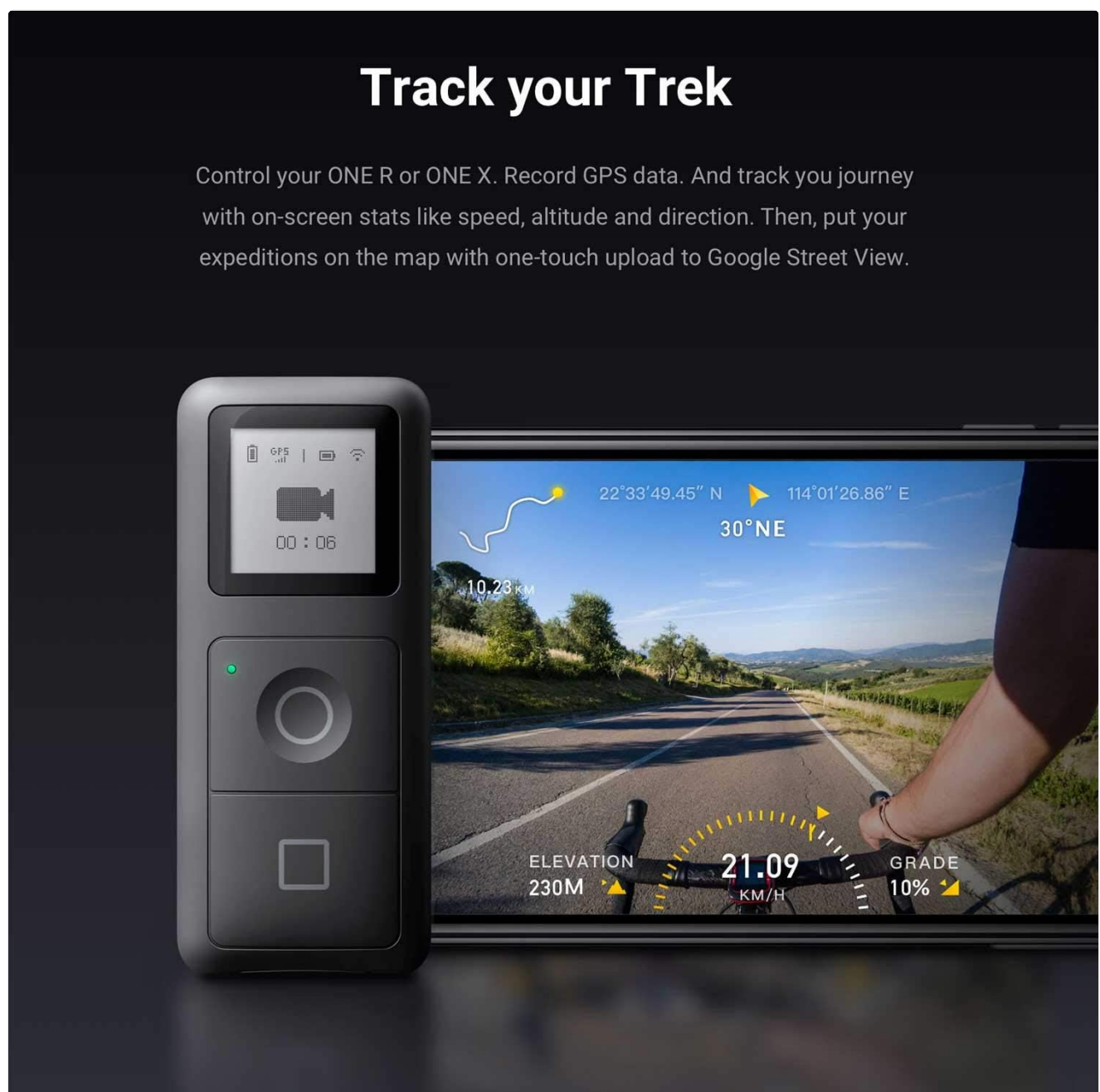

Image: The remote's display showing recording time and GPS status, with a visual representation of GPS data overlay on a map.

Google Street View Integration

The GPS Smart Remote integrates with Google Street View, allowing for one-touch uploads of your expeditions. This functionality is primarily accessed and managed within the Insta360 mobile application.

Mounting Options

The GPS Smart Remote offers versatile mounting options:

- **Selfie Stick Mount:** Use the included 25mm mounting clip to secure the remote onto an invisible selfie stick (sold separately).
- **Wrist Strap & Silicone Case:** For on-the-go action sports use, the included wrist strap and silicone case allow you to secure the remote to your wrist, backpack straps, ski poles, bike frames, and more.

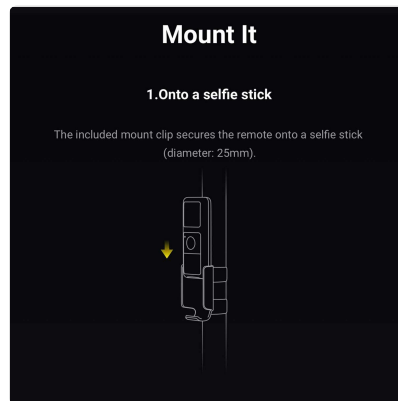

Image: Diagram for selfie stick mounting.



Image: Remote mounted on a selfie stick.



Image: Diagram for wrist strap mounting.

MAINTENANCE

Cleaning

Wipe the remote with a soft, dry cloth. For stubborn dirt, a slightly damp cloth can be used, ensuring no moisture enters the charging port or buttons. Do not use harsh chemicals or abrasive cleaners.

Battery Care

To prolong battery life:

- Avoid fully discharging the battery frequently.
- Store the remote in a cool, dry place when not in use for extended periods.
- Charge the device periodically if stored for a long time to prevent deep discharge.

Environmental Considerations

The operating temperature range for the remote is -10°C to 40°C. Avoid exposing the device to extreme temperatures,

direct sunlight for prolonged periods, or high humidity.

TROUBLESHOOTING

Problem	Solution
Remote won't pair with camera.	Ensure the camera is not connected to the Insta360 app. Disconnect from the app, then attempt pairing. Power cycle both devices if necessary.
Poor or no GPS signal.	Move to an open outdoor area. Avoid tall buildings or dense foliage. Ensure no strong electrical interference nearby. Remain stationary for a few minutes to allow signal acquisition.
Battery drains quickly or doesn't hold charge.	Ensure the remote is fully charged (approx. 2 hours). If issues persist, contact Insta360 support. Avoid leaving the remote in extreme temperatures.
Camera locks up when taking pictures via remote.	Ensure both the camera and remote have the latest firmware updates. If the issue persists, try restarting both devices.
Display text is difficult to read.	The display is a 1-inch monochrome screen. Ensure adequate lighting for readability. There are no user-adjustable font size settings.
Remote does not power on/off with camera.	The remote is designed to power off when the camera powers down, but it does not automatically power on the camera or vice-versa. Manual power on/off is required for the remote.

SPECIFICATIONS

Feature	Detail
Weight	43g
Display Size	1 inch
Charging Connector	Micro USB
Battery Type	Lithium Ion (non-removable)
Battery Capacity	800mAh
Run-Time	Approximately 16 hours
Charging Period	Approximately 2 hours (with 5V/1A charging station)
Operating Temperature	-10°C to 40°C
Wireless Control Range	Approximately 10 meters (without interference or obstructions)
Connectivity Technology	Bluetooth

Feature	Detail
Compatible Devices	Insta360 ONE R/RS, ONE X/X2 Cameras
Max Supported Devices	1 (one camera at a time)

WARRANTY AND SUPPORT

Warranty Information

For detailed warranty information regarding your Insta360 GPS Smart Remote, please refer to the official Insta360 website or the warranty card included with your product. Warranty terms and conditions may vary by region.

Customer Support

If you encounter any issues not covered in this manual or require further assistance, please contact Insta360 customer support through their official website. You can find contact details and additional resources at www.insta360.com/support.