

Manuals.plus /

› iKanzi /

› iKanzi Digital Instant Read Meat Thermometer User Manual

iKanzi iKanzi

iKanzi Digital Instant Read Meat Thermometer

Model: iKanzi

INTRODUCTION

Thank you for choosing the iKanzi Digital Instant Read Meat Thermometer. This manual provides essential information for the safe and effective use of your new thermometer. Please read these instructions carefully before use and retain them for future reference.

PRODUCT FEATURES

- **Fast and Accurate Readings:** Provides temperature readings within 2-3 seconds with an accuracy of $\pm 2^{\circ}\text{F}$ ($\pm 1^{\circ}\text{C}$). Temperature range: -4°F to 302°F (-20°C to 150°C). Features a large, backlit LCD for clear visibility.
- **Durable and Waterproof Design:** Constructed from FDA-certified, high heat-resistant materials. IP67 waterproof rating allows for washing under running water. Ensure the device is dry before storage.
- **Simple Operation and Power Saving:** Activate by flipping out the probe. Switch between $^{\circ}\text{F}$ and $^{\circ}\text{C}$ with a dedicated button. The 'HOLD' button locks the temperature reading. Automatic shut-off after 10 minutes of inactivity conserves battery life.
- **Versatile Use:** Suitable for various cooking applications including grilling, baking, deep frying, candy making, brewing, and more. Ideal for measuring temperatures of meats, liquids, and other foods.
- **Convenient Storage:** Features a built-in magnet for attachment to metal surfaces and a hanging loop for easy storage. Includes a meat temperature guide for reference.

PRODUCT DIAGRAM

Familiarize yourself with the components of your iKanzi Meat Thermometer.

Structure Diagram

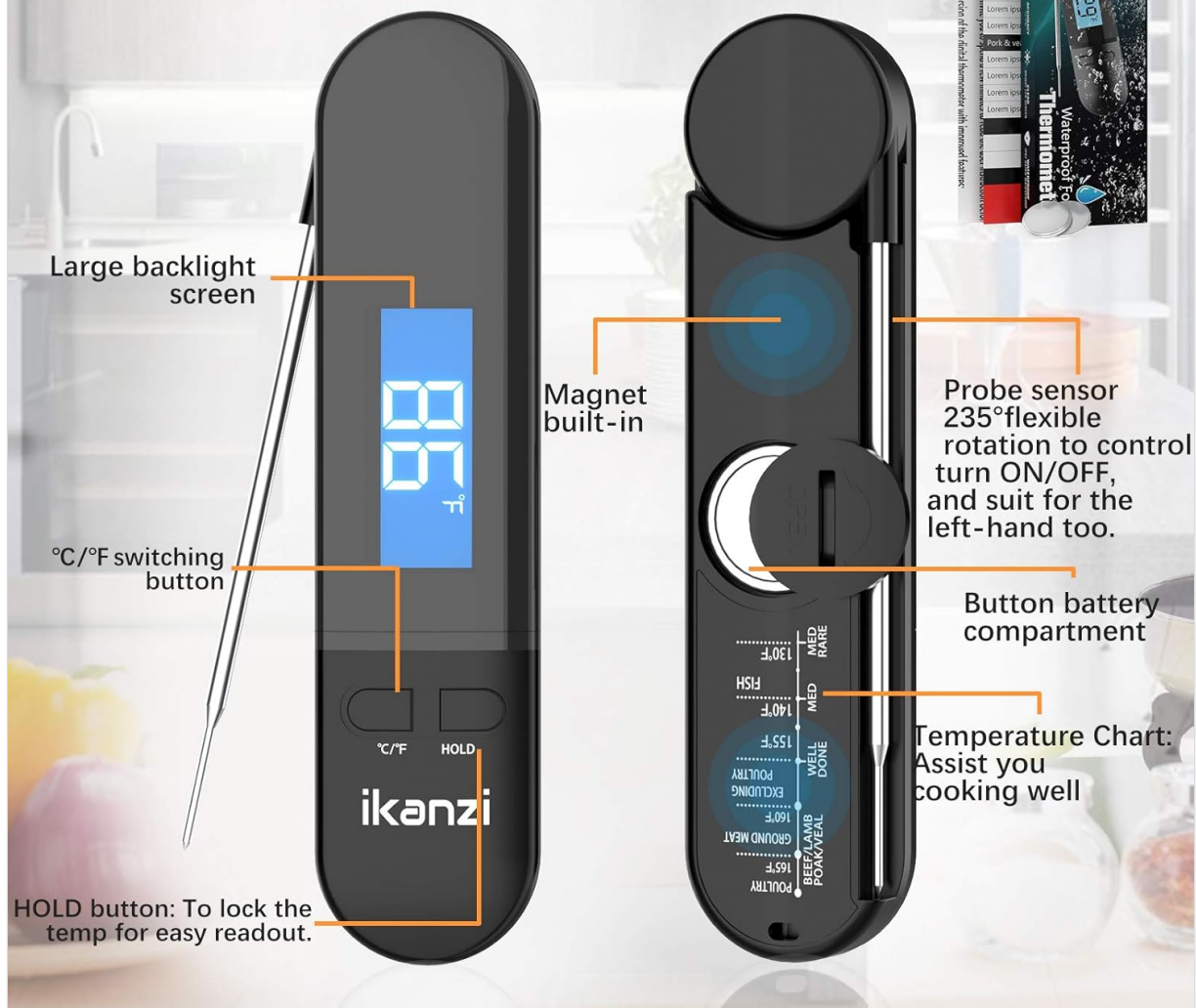

Image Description: A detailed diagram of the iKanzi Digital Instant Read Meat Thermometer. Labels point to the large backlit screen, °C/°F switching button, HOLD button, built-in magnet, 235° flexible rotation probe sensor, button battery compartment, and an integrated temperature chart.

- **Probe Sensor:** Stainless steel probe for temperature measurement.
- **LCD Display:** Shows temperature readings and unit.
- **°C/°F Button:** Toggles between Celsius and Fahrenheit.
- **HOLD Button:** Locks the current temperature reading on the display.
- **Battery Compartment:** Houses the button cell battery.
- **Magnet:** For convenient storage on metal surfaces.
- **Hanging Loop:** For alternative storage options.

SETUP

1. **Battery Installation:** The thermometer typically comes with a pre-installed battery. If the display does not turn on, open the battery compartment (refer to the product diagram) and insert a new button cell battery (e.g., CR2032) with the positive (+) side facing up.
2. **Initial Cleaning:** Before first use, clean the stainless steel probe with a damp cloth or mild soapy water. Do not immerse the entire unit in water. Dry thoroughly.

OPERATING INSTRUCTIONS

1. **Power On/Off:** To turn on the thermometer, simply unfold the probe. The display will illuminate. To turn off, fold the probe back into the unit. The thermometer will also automatically shut off after 10 minutes of inactivity.
2. **Select Temperature Unit:** Press the "°C/°F" button located on the front of the unit to switch between Celsius and Fahrenheit.
3. **Measure Temperature:** Insert the stainless steel probe into the thickest part of the food, avoiding bone or gristle. Ensure the probe tip is fully submerged in the food for an accurate reading.
4. **Read Temperature:** The temperature reading will appear on the LCD display within 2-3 seconds.
5. **Use HOLD Function:** While the probe is in the food, press the "HOLD" button to lock the current temperature reading on the display. This is useful when removing the probe from hot food to read the temperature more comfortably. Press "HOLD" again to release and resume live temperature measurement.

FAST & ACCURATE READOUT

- ✓ Respond in 2-3s
- ✓ $\pm 2^{\circ}\text{F}$ (1°C) accuracy



Image Description: The iKanzi Digital Instant Read Meat Thermometer displaying a temperature of 86°F, with its probe inserted into grilled meat. The image highlights the fast and accurate readout feature.



Image Description: Two hands holding the iKanzi Digital Instant Read Meat Thermometer, demonstrating its large, bright LED screen. One side shows the screen in a darker setting, emphasizing its readability, while the other side illustrates the 'HOLD' button function.

MAINTENANCE

1. **Cleaning:** After each use, clean the stainless steel probe with a damp cloth or mild soapy water. The unit has an IP67 waterproof rating, allowing it to be washed under running water. However, avoid prolonged submersion.
2. **Drying:** Always ensure the thermometer is completely dry before folding the probe and storing it.
3. **Storage:** Store the thermometer in a clean, dry place. Utilize the built-in magnet to attach it to a refrigerator or oven, or hang it using the integrated loop.
4. **Battery Replacement:** If the display becomes dim or the unit fails to power on, replace the battery. Refer to the "Setup" section for battery installation instructions.

IP67 WATERPROOF

wash under the running water. (note: keep it dry and clean when not using it.)



IP67 WATERPROOF



LARGE READING LED
SCREENS



"HOLD" TO LOCK THE TEMP



SUPPORT °F/°C
CONVERT

Image Description: The iKanzi Digital Instant Read Meat Thermometer being held under a running faucet, illustrating its IP67 waterproof capability for easy cleaning.

KITCHEN HOOK HANGING



MAGNET ATTACHMENT

Image Description: The iKanzi Digital Instant Read Meat Thermometer demonstrating its versatile storage options: attached to a refrigerator via its built-in magnet and hanging from a kitchen hook using its loop.

TROUBLESHOOTING

Problem	Possible Cause	Solution
Thermometer does not turn on.	Battery is dead or incorrectly installed.	Replace the battery, ensuring correct polarity.
Inaccurate temperature readings.	Probe not inserted deep enough; probe tip touching bone/gristle; temperature range exceeded.	Ensure probe is inserted into the thickest part of the food, avoiding bone. Verify temperature is within the specified range.
Display is dim or flickering.	Low battery.	Replace the battery.
Unit does not turn off automatically.	Malfunction.	Fold the probe to manually turn off. If issue persists, contact support.

SPECIFICATIONS

- **Model:** iKanzi
- **Temperature Range:** -4°F to 302°F (-20°C to 150°C)
- **Accuracy:** ±2°F (±1°C)
- **Response Time:** 2-3 seconds
- **Waterproof Rating:** IP67
- **Power Source:** 1 x CR2032 Button Cell Battery (included)
- **Auto-Off:** 10 minutes of inactivity
- **Display Type:** Backlit LCD
- **Material:** FDA-certified, high heat-resistance plastic and stainless steel probe
- **Color:** Black
- **Dimensions:** Approximately 17.4 x 5.79 x 2.59 cm (folded)
- **Weight:** Approximately 110 g

WARRANTY AND SUPPORT

This product is designed for reliability and durability. For any questions or assistance, please refer to the retailer's return policy or contact the manufacturer directly through their official support channels. Please retain your proof of purchase for warranty claims, if applicable.