

Manuals+

[Q & A](#) | [Deep Search](#) | [Upload](#)

[manuals.plus](#) /

› [Idatalink](#) /

› [Idatalink Maestro ADS-MRR2 Universal Interface Module: Installation and Operation Manual](#)

Idatalink ADS-MRR2



Idatalink Maestro ADS-MRR2 Universal Interface Module

Installation and Operation Manual

1. INTRODUCTION

The Idatalink Maestro ADS-MRR2 module is designed to facilitate the installation of an aftermarket car stereo in compatible vehicles. It allows for the retention of various factory features, including steering wheel audio controls, and integrates vehicle data with the new head unit. This manual provides instructions for the proper setup, programming, and operation of your ADS-MRR2 module.

2. PRODUCT OVERVIEW

The ADS-MRR2 module acts as an interface between your vehicle's factory systems and an aftermarket car stereo. It is a compact device that connects to your vehicle's wiring harness and your new stereo.



Image 2.1: Idatalink Maestro ADS-MRR2 module and its retail packaging.



Image 2.2: A detailed view of the ADS-MRR2 module, highlighting its connectors.



Image 2.3: The ADS-MRR2 module shown with the assortment of wiring harnesses and USB cables typically used for installation and programming.

3. KEY FEATURES

The ADS-MRR2 module offers several functionalities to enhance your aftermarket stereo installation:

- **Factory Feature Retention:** Retains original vehicle features such as steering wheel audio controls, OnStar, SYNC, and Uconnect in compatible vehicles.
- **Vehicle Data Integration:** Displays vehicle information like performance gauges, climate controls, and parking assistance on the new receiver's touchscreen.
- **Wide Vehicle Compatibility:** Supports a broad range of vehicles from manufacturers including Chrysler, Fiat, Ford, General Motors, Honda/Acura, Subaru, Toyota/Scion, and Volkswagen (model years 2002 and newer).
- **Wireless Programming:** Initial setup and firmware updates can be performed wirelessly via Bluetooth using a smartphone or other device, or via USB connection to a computer.
- **Customizable Steering Wheel Controls:** Allows assignment of primary and secondary 'press and hold' functions to each factory steering wheel button.

4. COMPATIBILITY REQUIREMENTS

Successful installation and operation of the ADS-MRR2 module depend on specific compatibility requirements:

- **Vehicle-Specific T-Harness:** A vehicle-specific iDatalink Maestro "HRN-HRR" Series Plug & Play T-Harness is required for connection to your vehicle's wiring. This harness is sold separately.
- **Head-Unit Specific Harness:** A brand-specific head-unit harness from the "ACC-HU" series is necessary to connect the module to your aftermarket stereo. These harnesses are also sold separately.
- **Compatible Aftermarket Receiver:** The module is designed to work with iDatalink Maestro-compatible receivers from brands such as Alpine, Boss, Kenwood, JVC, Pioneer, and Sony.

Examples of head-unit harnesses include:

- Alpine: ACC-HU-ALP1
- Boss: ACC-HU-BOS1
- Kenwood/JVC (22-Pin Connector): ACC-HU-KEN1
- Kenwood/JVC (16-Pin Connector): ACC-HU-KEN2
- Kenwood/JVC (22-Pin Connector 2024 & Newer): ACC-HU-KEN3
- Pioneer: ACC-HU-PIO1
- Sony: ACC-HU-SON1



Alpine Harness



Kenwood 22-Pin Harness



Kenwood 16-Pin Harness



Pioneer Harness



Sony Harness



Boss Harness

5. SETUP AND PROGRAMMING

The ADS-MRR2 module requires initial programming to match your specific vehicle and aftermarket stereo. This process can be done via USB or Bluetooth.

5.1. Firmware Flashing

1. **Connect the Module:** Connect the ADS-MRR2 module to your computer using the included USB cable, or to a smartphone/device via Bluetooth.
2. **Access Programming Website:** Visit the official [idatalink/maestro website](https://idatalink.com/maestro).
3. **Follow On-Screen Instructions:** The website will guide you through selecting your vehicle make, model, year, and the aftermarket stereo you are installing. It will then provide specific firmware for your configuration.
4. **Flash the Unit:** Follow the prompts to flash the firmware onto the ADS-MRR2 module. Ensure a stable connection during this process.

Once the unit has been successfully flashed, it is ready for physical installation.



Image 5.1: The ADS-MRR2 module connected to a laptop via USB for firmware programming.

5.2. Physical Installation

After firmware flashing, the next step is to connect the module to your vehicle and new stereo.

1. **Prepare Harnesses:** Connect the vehicle-specific Maestro harness (HRN-HRR series) and the head-unit specific harness (ACC-HU series) to the ADS-MRR2 module.
2. **Wire to Receiver:** Solder or crimp the wires from the vehicle-specific Maestro harness to the corresponding wires of your new aftermarket receiver. Refer to the detailed wiring diagrams provided on the [idatalink/maestro](https://www.idatalink.com/maestro) website after flashing for precise connections.
3. **Connect to Vehicle:** Plug the vehicle-specific harness into your vehicle's factory wiring.
4. **Mount Module:** Securely mount the ADS-MRR2 module in a suitable location behind the dashboard, ensuring it is not exposed to excessive heat or moisture.

6. OPERATING INSTRUCTIONS

Once installed and programmed, the ADS-MRR2 module enables seamless integration of your vehicle's features with your new stereo.

6.1. Steering Wheel Control Customization

The module allows you to customize the functions of your factory steering wheel audio controls:

- Access the web programming interface (as used for flashing).
- Each factory button can be assigned a specific radio function (e.g., volume up, track skip).
- Additionally, a secondary 'press and hold' function can be assigned to each button, effectively doubling the control options.

6.2. Accessing Vehicle Data

With most iDataLink-compatible car stereos, you can access additional vehicle features and data directly on your new receiver's touchscreen. These may include:

- Performance gauges (e.g., RPM, speed, engine temperature).
- Climate controls.
- Parking assistance information.



Image 6.1: An aftermarket car stereo displaying vehicle performance gauges, enabled by the ADS-MRR2 module.

7. MAINTENANCE

Maintaining your ADS-MRR2 module primarily involves keeping its firmware up-to-date.

7.1. Firmware Updates

iDataLink periodically releases firmware updates to improve compatibility, add features, or address issues. It is recommended to check for updates regularly:

- Connect the module to your computer via USB or to a smartphone/device via Bluetooth.
- Visit the [idatalink/maestro website](https://www.idatalink.com/maestro) and follow the instructions for firmware updates.
- Ensure your device has sufficient power and a stable connection during the update process to prevent interruption.

8. TROUBLESHOOTING

If you encounter issues with your ADS-MRR2 module, consider the following:

- **No Functionality:** Verify that the module has been correctly flashed with the appropriate firmware for your vehicle and stereo. Double-check all wiring connections.
- **Intermittent Operation:** Ensure all connections are secure and free from corrosion. Check for any loose wires.
- **Steering Wheel Controls Not Working:** Re-verify the programming of the steering wheel controls via

the web interface. Ensure the head-unit specific harness is correctly installed.

- **Vehicle Data Not Displaying:** Confirm that your aftermarket stereo is fully compatible with iDatalink Maestro features and that the module is correctly configured for data display.
- **Firmware Update Issues:** Ensure a stable internet connection and power source during updates. If issues persist, try a different USB port or device.

For persistent issues, refer to the detailed troubleshooting guides available on the official Idatalink Maestro website or contact their technical support.

9. SPECIFICATIONS

Feature	Detail
Model Number	ADS-MRR2
Product Dimensions	10 x 6 x 3 inches
Item Weight	7.8 ounces
Manufacturer	Idatalink
Connectivity	USB, Bluetooth

10. WARRANTY AND SUPPORT

For information regarding product warranty, please refer to the documentation included with your purchase or visit the official Idatalink Maestro website. Technical support and additional resources, including detailed wiring diagrams and vehicle compatibility lists, are available on their website:





www.idatalinkmaestro.com

It is recommended to consult the website for the most up-to-date information and support options.

© 2025 Idatalink. All rights reserved.

Related Documents - ADS-MRR2

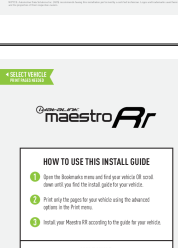
	<p>iDatalink Maestro RR Install Guide for Volkswagen Arteon</p> <p>Comprehensive installation guide for the iDatalink Maestro RR and HRN-HRR-VW2 harness in 2019-2023 Volkswagen Arteon vehicles without an amplifier. This guide details wiring, connections, and troubleshooting for retaining steering wheel controls, factory amplifier, and analog outputs.</p>
---	--

	<p>iDatalink Maestro RR Install Guide for Ford Edge with MyFord Touch</p> <p>Comprehensive installation guide for the iDatalink Maestro RR and RR2 radio replacement interfaces in Ford Edge vehicles equipped with MyFord Touch (2011-2019). Includes step-by-step instructions, wiring diagrams, and troubleshooting tips.</p>
	<p>iDatalink Maestro RR Install Guide for Buick Enclave</p> <p>Comprehensive installation guide for the iDatalink Maestro RR and RR2 modules in 2008-2017 Buick Enclave vehicles. Learn how to retain steering wheel controls, OnStar, Bluetooth, and more.</p>
	<p>iDatalink Maestro RR Installation Guide for 2013-2014 Ford F-150 with MyFord 4-Inch Screen</p> <p>This guide provides detailed instructions for installing the iDatalink Maestro RR Radio Replacement Interface and K150 Dash Kit in a 2013-2014 Ford F-150 equipped with the MyFord 4-inch screen. It covers vehicle dash disassembly, wiring connections, module diagnostics, and troubleshooting steps to retain steering wheel controls and other factory features.</p>
	<p>iDatalink Maestro RR Install Guide for Chevrolet Camaro (2010-2015)</p> <p>Comprehensive installation guide for the iDatalink Maestro RR and CAM1 Dash Kit in 2010-2015 Chevrolet Camaros, detailing dash disassembly, wiring, and module diagnostics.</p>
	<p>iDatalink Maestro RR & KIT-VW1 Installation Guide for Volkswagen Vehicles</p> <p>This guide provides comprehensive installation instructions for the iDatalink Maestro RR and KIT-VW1 dash kit, enabling seamless integration of aftermarket car stereos into various Volkswagen models while retaining essential factory features like steering wheel controls, MFD, and backup camera.</p>

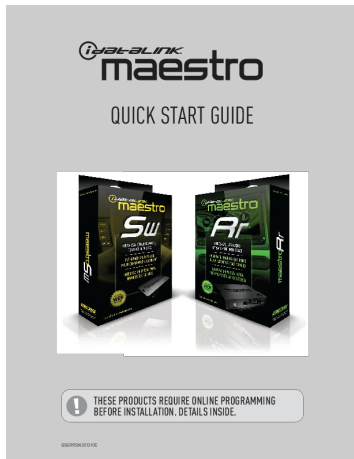

[\[pdf\]](#) Quick Start Guide Installation Guide Guide Warranty

794ADSMRR2 iDatalink ADS MRR2 Radio Replacement Module CRUTCHFIELD COM HNEWBERRY
crutchfieldonline ImageBank v20220118113500 Manuals 794 |||

QUICK START GUIDE THESE PRODUCTS REQUIRE ONLINE PROGRAMMING BEFORE INSTALLATION. DETAILS INSIDE. QSGRRSW201310E 6 STEPS TO GET STARTED 1 INSTALL THE WEBLINK PLUG-IN Go to:

idatalinkmaestro.com/plugin and follow the installation steps. Review the System Requirements before installing. 2 REGISTER A ...

lang:en score:33 filesize: 1.83 M page_count: 3 document date: 2022-01-18

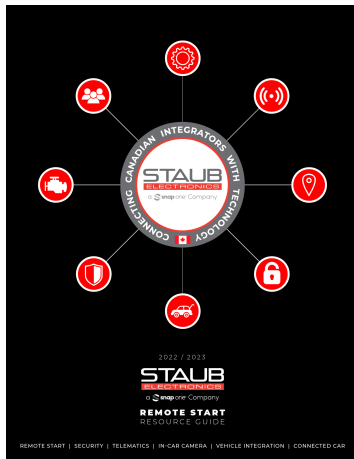

[Staub Electronics 2022-2023 Remote Start Resource Guide](#)

Comprehensive resource guide from Staub Electronics for 2022-2023, featuring Compustar, Drone, Firstech, Momento, iDatalink, and Maestro products including remote start systems, security controllers, telematics, in-car cameras, audio integration, and vehicle-specific integration kits.

lang:en score:31 filesize: 14.43 M page_count: 21 document date: 2022-09-26

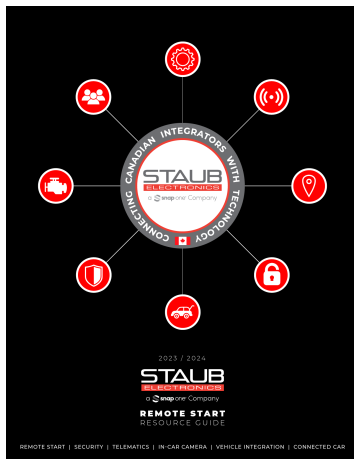

[Staub Electronics 2023/2024 Remote Start Resource Guide - Compustar, DroneMobile, Firstech](#)

Explore the Staub Electronics 2023/2024 Remote Start Resource Guide, featuring Compustar, DroneMobile, and Firstech products. Discover remote start systems, security, telematics, in-car cameras, and vehicle integration solutions.

lang:en score:31 filesize: 13.74 M page_count: 21 document date: 2023-11-07

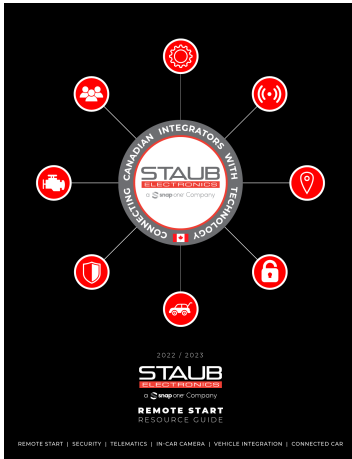

[Staub Electronics 2022-2023 Remote Start Resource Guide | Compustar, Drone, iDatalink, Maestro](#)

Comprehensive resource guide from Staub Electronics for 2022-2023, featuring Compustar, Drone, iDatalink, and Maestro remote start systems, security, telematics, in-car cameras, and audio integration solutions.

lang:en score:31 filesize: 10.37 M page_count: 21 document date: 2022-08-17

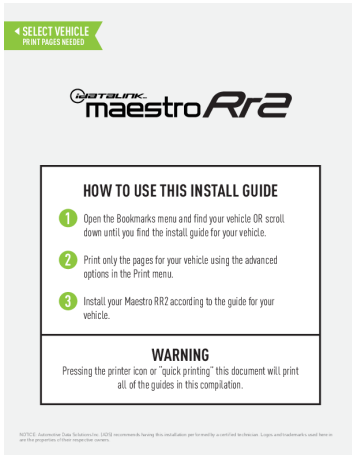

[\[pdf\] User Manual Owner's Manual Installation Guide Guide](#)

iDatalink HRN HRR HK2 Vehicle specific Harness owner s manual ADS MRR2 module also required Connect a new car stereo and retain steering wheel controls factory amp in select 2010 18 Hyundai Kia vehicles at Crutchfield 794HRRHK2C crutchfieldonline ImageBank v20240815151000 Manuals 794 ||| **SELECT VEHICLE PRINT PAGES NEEDED HOW TO USE THIS INSTALL GUIDE 1** Open the Bookmarks menu and find your vehicle OR scroll down until you find the install guide for your vehicle. 2 Print only the pages for your vehicle using the advanced options in the Print menu. 3 Install your Maestro RR2 according...

lang:en score:31 filesize: 3.63 M page_count: 239 document date: 2024-08-15

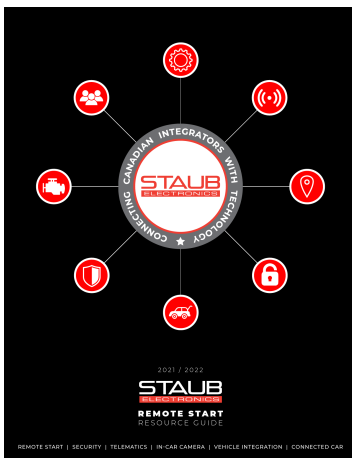

[Staub Electronics 2021/2022 Remote Start & Security Resource Guide](#)

A comprehensive resource guide from Staub Electronics detailing their 2021/2022 product line for automotive remote start, security, telematics, in-car cameras, and vehicle integration systems, featuring brands like Compustar, iDatalink, and DroneMobile.

lang:en score:30 filesize: 14.61 M page_count: 21 document date: 2021-12-08

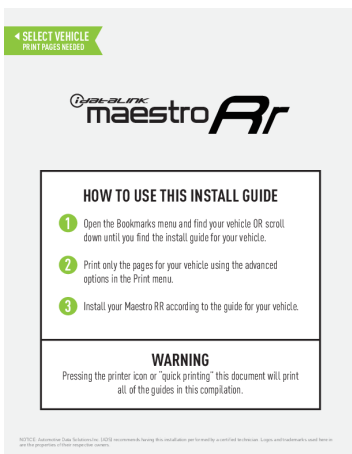

[\[pdf\] User Manual Owner's Manual Installation Guide Guide Diagram](#)

794HRRHK3C iDatalink HRN HRR HK3 hrHK3 Hyundai Kia Harness for Maestro RR2 only CRUTCHFIELD COM HNEWBERRY owner s manual ADS MRR2 module also required Connect a new compatible car stereo and retain steering wheel controls in select 2016 up vehicles at Crutchfield crutchfieldonline ImageBank v20240819173100 Manuals 794 ||| **SELECT VEHICLE PRINT PAGES NEEDED HOW TO USE THIS INSTALL GUIDE 1** Open the Bookmarks menu and find your vehicle OR scroll down until you find the install guide for your vehicle. 2 Print only the pages for your vehicle using the advanced options in the Print menu. 3 Install your Maestro RR according ...

lang:en score:30 filesize: 3.34 M page_count: 239 document date: 2024-08-19



[\[pdf\]](#) User Manual Owner's Manual Installation Guide Guide Accessories

794HRRHK3 iDataLink HRN RR HK3 rHK3 install harness for select Hyundai Kia CRUTCHFIELD COM HNEWBERRY Factory Integration Adapter owner s manual ADS MRR2 module also required Connect a new compatible car stereo and retain steering wheel controls in 2016 up vehicles at Crutchfield crutchfieldonline ImageBank v20210825175700 Manuals 794 |||

SELECT VEHICLE PRINT PAGES NEEDED HOW TO USE THIS INSTALL GUIDE 1

Open the Bookmarks menu and find your vehicle OR scroll down until you find the install guide for your vehicle. 2 Print only the pages for your vehicle using the advanced options in the Print menu. 3 Install your Maestro RR according ...

lang:en **score:30** filesize: 5.11 M page_count: 205 document date: 2021-08-25

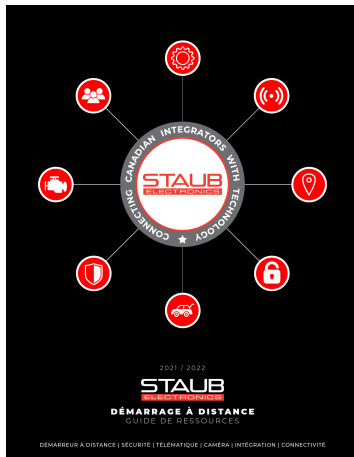

[\[pdf\]](#) Guide

French 15mb Remote Start Resource Guide 2021 RS staub ca medias |||

2021 / 2022 DMARRAGE DISTANCE GUIDE DE RESSOURCES DMARREUR

DISTANCE SCURIT TLMATIQUE CAMRA ... urd hui. Compatible avec tous les vhicules avec boutons de volant base de rsistances. MAESTRO RR2 **ADS-MRR2** Interface avance de remplacement de la radio compatible avec plus de 3 000 vhicules de 2003...

lang:fr **score:29** filesize: 14.62 M page_count: 21 document date: 2021-12-08



[\[pdf\]](#) Quick Start Guide Installation Guide Guide Warranty

794ADSMRR2 iDataLink ADS MRR2 Radio Replacement Module CRUTCHFIELD COM HNEWBERRY QUICK START GUIDE NETQUICK THESE PRODUCTS REQUIRE ONLINE PROGRAMMING BEFORE INSTALLATION DETAILS INSIDE Page 2 1 3 877 212 6169 4 5 6 STEPS TO GET A1VU4zNmMrLm media amazon images | A1VU4zNmMrL |||

QUICK START GUIDE THESE PRODUCTS REQUIRE ONLINE PROGRAMMING BEFORE INSTALLATION. DETAILS INSIDE. QSGRRSW201310E 6 STEPS TO GET STARTED 1 INSTALL THE WEBLINK PLUG-IN Go to:

idatalinkmaestro.com/plugin and follow the installation steps. Review the System Requirements before installing. 2 REGISTER A ...

lang:en **score:28** filesize: 1.83 M page_count: 3 document date: 2022-01-18

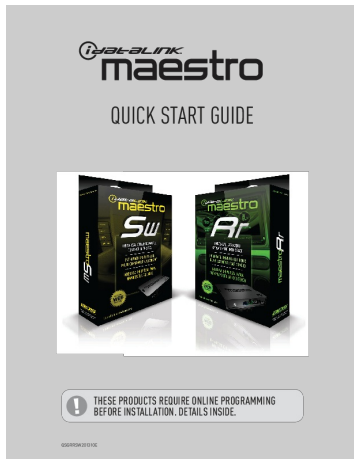

[\[pdf\]](#) Quick Start Guide Installation Guide Guide Warranty

794ADSMRR2 iDatalink ADS MRR2 Radio Replacement Module CRUTCHFIELD COM HNEWBERRY

onlinecarstereo blob core windows net www cms 2024 JL Audio |||

QUICK START GUIDE THESE PRODUCTS REQUIRE ONLINE PROGRAMMING BEFORE INSTALLATION. DETAILS INSIDE. QSGRRSW201310E 6 STEPS TO GET STARTED 1 INSTALL THE WEBLINK PLUG-IN Go to:

idatalinkmaestro.com/plugin and follow the installation steps. Review the System Requirements before installing. 2 REGISTER A ...

lang:en score:22 filesize: 1.83 M page_count: 3 document date: 2022-01-18



[Firstech 2022 Company Catalog: Remote Start, Security, and Vehicle Integration Solutions](#)

Explore the comprehensive 2022 Company Catalog from Firstech, featuring innovative remote start systems, advanced vehicle security, telematics, in-car cameras, and seamless integration solutions from brands like Compustar, DroneMobile, and iDataStart.

lang:en score:13 filesize: 7.41 M page_count: 56 document date: 2022-09-29