

manuals.plus /

› [smartmi](#) /

› [Smartmi Outdoor Pedestal Fan 2S User Manual](#)

smartmi ZLBPLDS03ZM

Smartmi Outdoor Pedestal Fan 2S User Manual

Model: ZLBPLDS03ZM | Brand: Smartmi

INTRODUCTION

The Smartmi Outdoor Pedestal Fan 2S is designed to provide a natural and comfortable breeze for both indoor and outdoor environments. Featuring a premium DC inverter motor, this fan offers quiet operation, energy efficiency, and a long lifespan. Its cordless design and smart control options enhance user convenience and portability.



Figure 1: Smartmi Pedestal Fan 2S highlighting key features.

SETUP AND ASSEMBLY

The Smartmi Pedestal Fan 2S is designed for quick and easy assembly, typically taking about 5 minutes. Follow these steps to set

up your fan:

1. Unpack all components from the packaging. Ensure you have the base, fan assembly, motor+support pole, power cord, Allen wrench, and fan blades.
2. Attach the motor+support pole to the base.
3. Secure the fan blades to the motor shaft.
4. Attach the fan assembly (grille) to the motor+support pole, ensuring it is securely fastened.
5. Connect the power cord to the fan and a suitable power outlet for charging or wired operation.

ONLY 5 MIN TO GET COOL

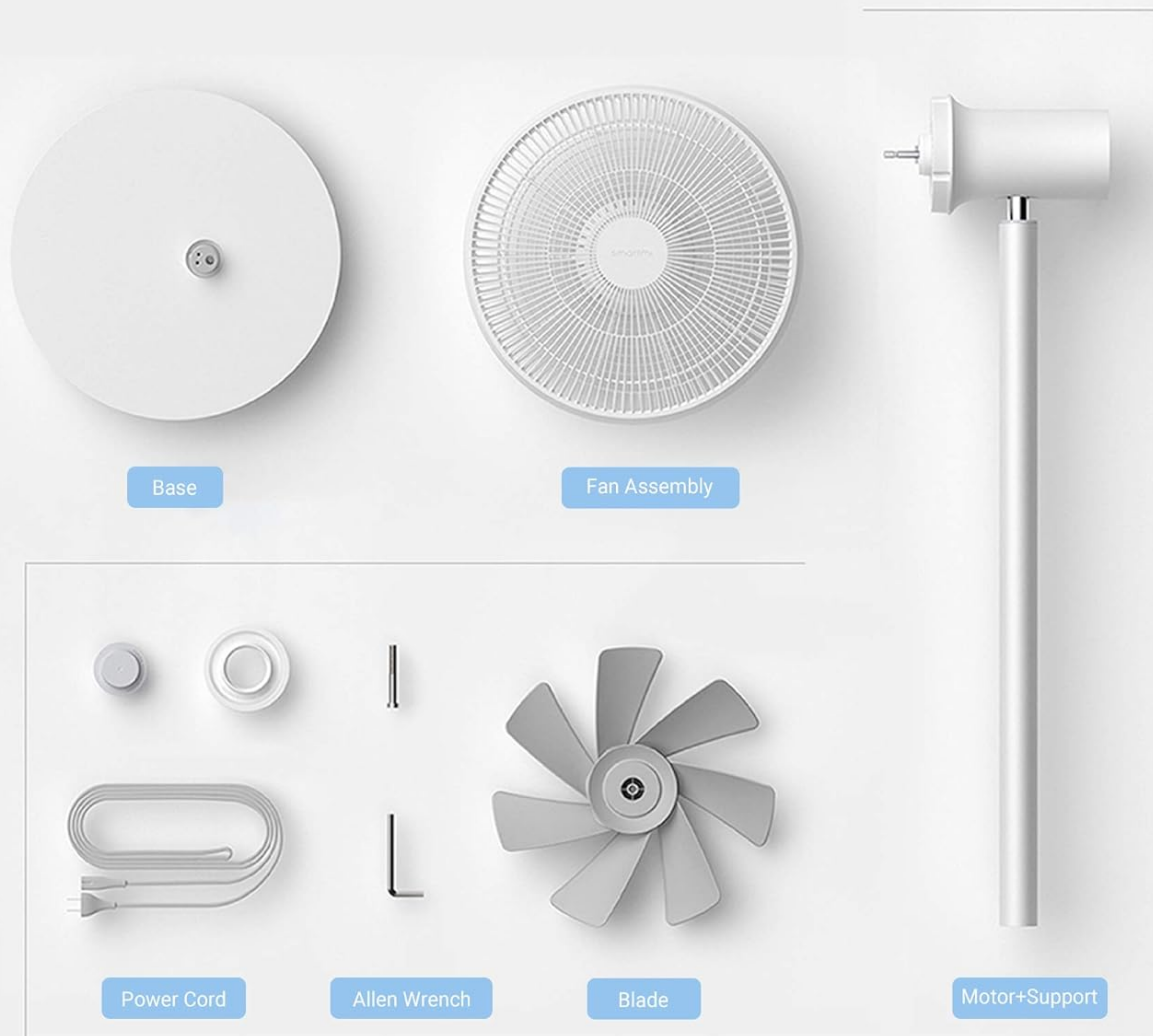

Figure 2: Fan components for easy 5-minute assembly.

OPERATING INSTRUCTIONS

Powering On/Off and Speed Control

The fan can be controlled via physical buttons on the unit or through the Mi Home APP for smart features. It offers 100 stepless speed settings for precise airflow adjustment.

- **Physical Controls:** Use the buttons on the fan unit to power on/off and adjust basic speed settings.
- **Mi Home APP Control:** For full functionality, including 100 speed settings, natural breeze mode, oscillation control, and timer functions, connect the fan to the Mi Home APP.



Figure 3: Controlling the fan via the Mi Home App.

Modes and Features

- **Natural Breeze Mode:** Replicates the irregular patterns of natural wind for a more comfortable experience.
- **Standard Mode:** Provides a consistent airflow.
- **Oscillation:** The fan supports a 120° wide oscillation angle and a 40° tilt angle to cool a larger area. These can be adjusted via the app.
- **Timer Function:** Set a shut-off timer through the Mi Home APP for automated operation.
- **Cordless Operation:** Equipped with a built-in lithium-ion battery, the fan can operate wirelessly for 3 to 20 hours depending on the speed setting.

EFFICIENT USE WIDE ANGLE OSCILLATION

120° Oscillation Angle

40° Tilt Angle

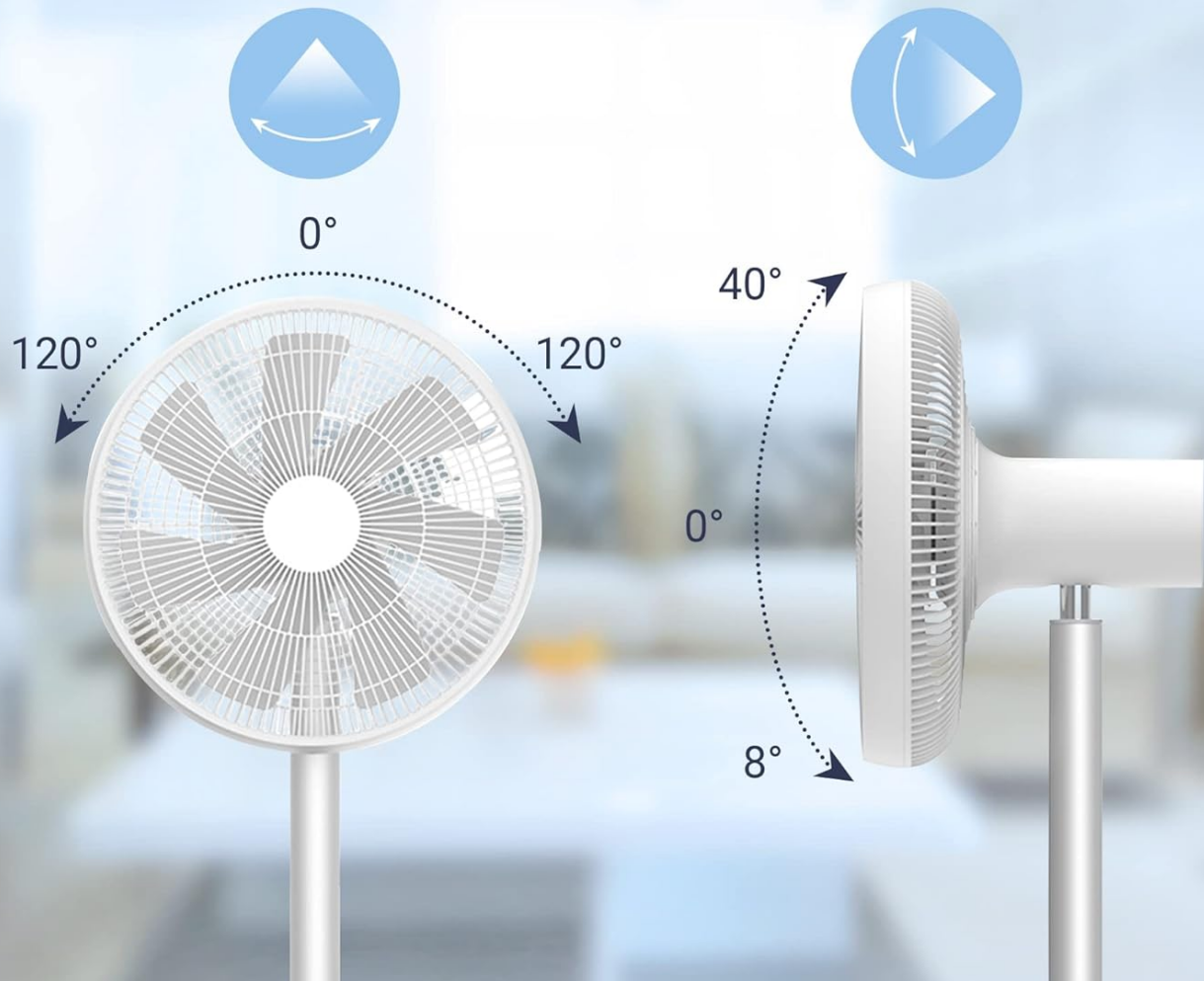

Figure 4: Fan oscillation and tilt capabilities.

PORTABLE BREEZE

Cordless Use
for 3-20 Hours



Figure 5: The fan's portable design for cordless use.

Video Demonstrations

Your browser does not support the video tag.

Video 1: Smartmi Outdoor Fan 2S Creative - Demonstrates the fan's quiet operation and natural breeze feature in various settings.

Your browser does not support the video tag.

Video 2: Smartmi Outdoor Fan 2S - Showcases the fan's features and quiet performance.

MAINTENANCE

Regular maintenance ensures optimal performance and longevity of your Smartmi Pedestal Fan 2S.

- **Cleaning:** Periodically wipe down the exterior of the fan with a soft, damp cloth. Ensure the fan is unplugged before cleaning.
- **Blade Cleaning:** While the fan is designed for easy assembly, some users have noted difficulty in removing the front grille for deep cleaning of the blades. Refer to the detailed user manual (PDF link provided in product documents) for specific instructions on disassembling the fan for thorough cleaning, if required.

- **Storage:** When not in use for extended periods, store the fan in a cool, dry place. Its compact design allows for easy storage.

TROUBLESHOOTING

If you encounter issues with your Smartmi Pedestal Fan 2S, refer to the common problems and solutions below:

Problem	Possible Cause	Solution
Fan does not turn on.	Not plugged in, battery depleted, or power switch off.	Ensure the power cord is securely plugged in. Charge the battery if operating wirelessly. Check the power button on the unit or in the app.
Cannot connect to Mi Home APP.	Incorrect Wi-Fi band (only 2.4GHz supported), app issues, or fan not in pairing mode.	Ensure your Wi-Fi is 2.4GHz. Restart the app and the fan. Follow the app's pairing instructions carefully.
Fan is noisy.	Obstruction in blades, loose parts, or fan not on a stable surface.	Check for any foreign objects near the blades. Ensure all parts are securely assembled. Place the fan on a flat, stable surface.
Battery life is shorter than expected.	Operating at high speeds, aging battery, or frequent charging/discharging.	Battery life varies significantly with speed settings. Lower speeds extend battery life. Ensure proper charging practices.

SPECIFICATIONS

Feature	Detail
Brand	smartmi
Model Name	ZLBPLDS03ZM
Color	White
Power Source	Electric
Product Dimensions	12.99"D x 15.38"W x 37.8"H
Special Features	7 Blades, Natural Wind, 4 Oscillation Angles, Auto-off Timer, 29dB Quiet Operation, 100 Stepless Speeds, Cordless, Portable
Noise Level	60 dB (Max), as low as 28.6dB
Wattage	25 watts
Voltage	220 Volts (DC)
Item Weight	7.72 Pounds
Battery	1 Lithium Ion battery (included)
Cordless Operation Time	3h (highest speed) to 20h (lowest speed)
Control Method	Remote (via Mi Home App)

WARRANTY AND SUPPORT

For warranty information and customer support, please refer to the official Smartmi website or contact their customer service directly. A detailed user manual in PDF format is also available for download from the product's Amazon page for further reference.

Link to official user manual (PDF):[Smartmi Outdoor Pedestal Fan 2S User Manual PDF](#)

Related Documents - ZLBPLDS03ZM

<div><div>Smartmi Standing Fan 3 Instruction Manual</div><div>Smartmi Standing Fan 3 Instruction Manual</div><div>Manual d'installation Smartmi Standing Fan 3</div></div>	<p>Smartmi Standing Fan 3 Instruction Manual</p> <p>Comprehensive guide for the Smartmi Standing Fan 3, covering setup, operation, safety precautions, maintenance, and troubleshooting. Learn how to use your Smartmi fan efficiently and safely.</p>
<div><div>Smartmi Standing Fan 3 Instruction Manual</div><div>Smartmi Standing Fan 3 Instruction Manual</div><div>Manual d'installation Smartmi Standing Fan 3</div></div>	<p>Smartmi Standing Fan 3: Instruction Manual & Smart Home Integration</p> <p>Comprehensive instruction manual for the Smartmi Standing Fan 3 (Model ZLBPLDS05ZM), covering safety, assembly, operation, smart home app integration with Mi Home/Xiaomi Home, troubleshooting, and maintenance for optimal performance.</p>
<div><div>Smartmi Air Purifier 2 User Manual</div><div>Smartmi Air Purifier 2 User Manual</div><div>Manual d'installation Smartmi Air Purifier 2</div></div>	<p>Smartmi Air Purifier 2 - Instrukcja Obsługi i Przewodnik</p> <p>Szczegółowa instrukcja obsługi dla oczyszczacza powietrza Smartmi 2 (model KQJHQ02ZM), zawierająca informacje o instalacji, użytkowaniu, konserwacji, wymianie filtra oraz integracji z aplikacjami Smartmi Link i Apple HomeKit.</p>
<div><div>Smartmi Air Purifier 2 User Manual</div><div>Smartmi Air Purifier 2 User Manual</div><div>Manual d'installation Smartmi Air Purifier 2</div></div>	<p>Smartmi Air Purifier 2 User Manual - Comprehensive Guide</p> <p>User manual for the Smartmi Air Purifier 2. Learn about installation, operation, maintenance, safety precautions, and troubleshooting for your Smartmi air purifier. Includes product overview and specifications.</p>
<div><div>Smartmi Smart Convective Heater 1S</div><div>Smartmi Smart Convective Heater 1S</div><div>Manual d'installation Smartmi Smart Convective Heater 1S</div></div>	<p>Smartmi Smart Convective Heater 1S User Manual and Safety Guide</p> <p>Learn how to safely install, operate, and maintain your Smartmi Smart Convective Heater 1S. This comprehensive guide covers all essential information for optimal use.</p>
<div><div>Smartmi Evaporative Humidifier 2 User Manual</div><div>Smartmi Evaporative Humidifier 2 User Manual</div><div>Manual d'installation Smartmi Evaporative Humidifier 2</div></div>	<p>Smartmi Evaporative Humidifier 2 User Manual - Setup, Operation, and Maintenance Guide</p> <p>This comprehensive user manual provides detailed instructions for the Smartmi Evaporative Humidifier 2, covering safety warnings, precautions, product overview, usage, maintenance, and technical specifications. Learn how to set up, operate, and care for your humidifier.</p>