

## Eogiffee 750466180678

# Eogiffee Universal 53T Ceiling Fan Remote Control Kit User Manual

Model: 750466180678

## INTRODUCTION

This manual provides detailed instructions for the installation, operation, and maintenance of your Eogiffee Universal 53T Ceiling Fan Remote Control Kit. This kit is designed to provide convenient control over your ceiling fan's speed and light functions. Please read this manual thoroughly before installation and use to ensure proper functionality and safety. The kit includes a remote control transmitter and a receiver unit, compatible with most regular ceiling fans, including those from Hampton Bay, Harbor Breeze, and Hunter.

## IMPORTANT SAFETY INFORMATION

- **Electrical Hazard:** Installation should only be performed by a qualified electrician or a person with experience in electrical wiring. Always turn off power at the circuit breaker before beginning installation.
- Ensure all wiring connections are secure and comply with local electrical codes.
- Do not use this product with wall-mounted fans or exhaust-type fans. It is designed for downrod style ceiling fans.
- This remote control kit is compatible with incandescent light bulbs and dimmable LED/CFL lamps. Other LED/CFL lamps only support ON/OFF function.
- Keep the remote control away from water and excessive humidity.

## PACKAGE CONTENTS

Verify that all components are present before proceeding with installation:

- Remote Control Transmitter
- Receiver Unit
- Wall Mount Holder for Remote Control
- Wire Nuts (typically 5-6 pieces)
- User Manual (this document)



Image: Eogiffee Universal Ceiling Fan Remote Control Kit showing the remote transmitter, receiver unit, and wire nuts.

SPECIFICATIONS

Feature	Detail
Model Number	750466180678
Product Dimensions	12.7 x 7.62 x 3.81 cm (Receiver)
Item Weight	190 Grams
Connectivity Technology	Radio Frequency (RF)
Number of Buttons	5 (HI, MED, LOW, OFF, Light ON/OFF)
Maximum Range	10 Meters

Compatible Devices	Ceiling Fans (downrod style)
Light Compatibility	Incandescent, Dimmable LED/CFL (ON/OFF only for non-dimmable LED/CFL)

# How To Use Wire Nuts?

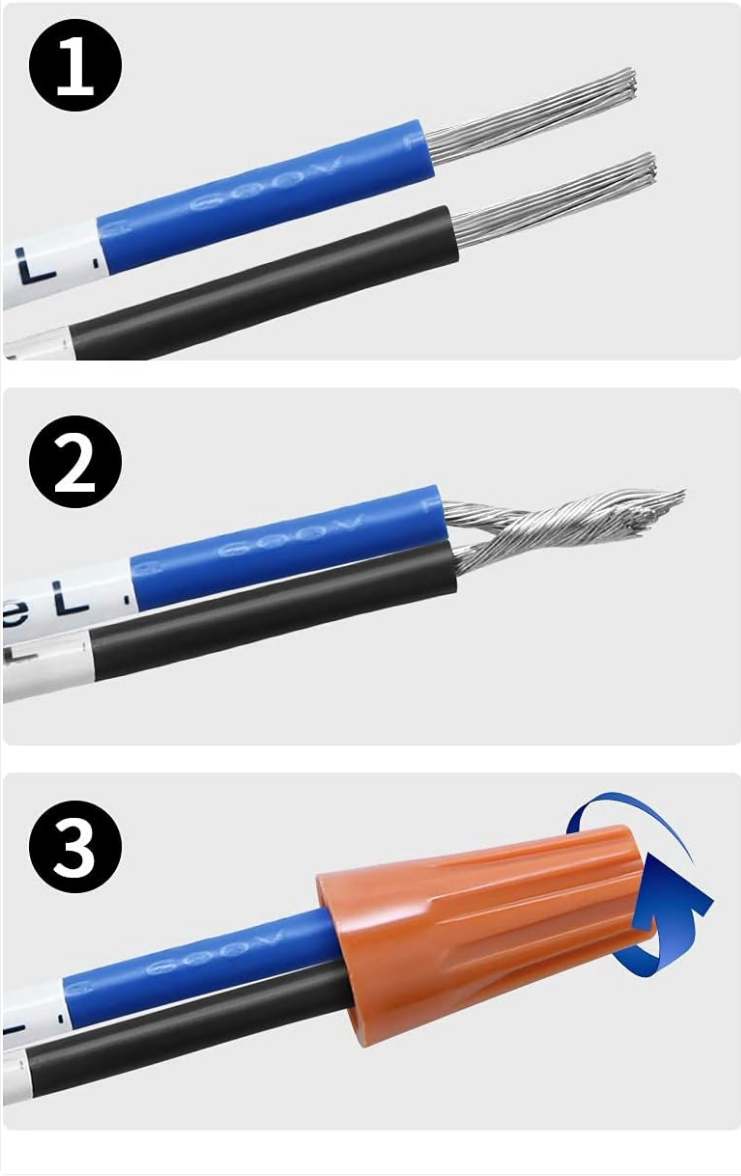

Image: Compatibility chart illustrating suitable fan types (downrod style) and light bulb types (incandescent, dimmable LED/CFL) for the remote control kit.

# SUPER SMALL SIZE

## OURS

L\*W\*D: 3.88\*2.05\*0.95 inch



Image: Diagram showing the compact dimensions of the Eogiffee receiver unit, measuring approximately 3.88 inches in length, 2.05 inches in width, and 0.95 inches in depth.

## SETUP AND INSTALLATION

### 1. Power Disconnection

Before starting any electrical work, ensure the power supply to the ceiling fan is completely turned off at the circuit breaker. Verify power is off using a voltage tester.

### 2. Accessing Fan Wiring

Carefully lower the ceiling fan canopy to expose the wiring connections. Note the existing wiring configuration, especially the connections to the fan motor and light kit.

### 3. Setting Dip Switches (Frequency Matching)

Both the remote control transmitter and the receiver unit have a set of DIP switches. These switches must be set to the



exact same pattern for the remote and receiver to communicate. If replacing an existing remote, match the new remote's DIP switches to the pattern of your old remote or the existing receiver.

If installing a new system or if you have multiple ceiling fans in your house, set a unique DIP switch pattern for each fan to prevent interference. Ensure the pattern is different from any neighboring fan's remote to avoid unintended operation.

## SETTING THE CODES

Note: Slide the switches in the new remote to match the same pattern as the original remote.



### Product Features



#### 3-Speed Control:

HIGH/MED/LOW/FAN OFF



#### Turn On/Off The Light:

ON/OFF

Image: Illustration demonstrating how to set the DIP switches on both the remote control and the receiver unit to match for proper communication.

## SET DIFFERENT PIN CODE IF CONTROL MULTIPLE CEILING FANS

NOTE: If you control multiple ceiling fans in the house, please check the PIN code settings are different between these, or it may let transmitter next door or your neighbourhood's remote activates this ceiling fan in your other rooms. This may cause the fan turning on strangely while you are not at home.



Image: Diagram showing the importance of setting different DIP switch patterns for multiple ceiling fans in close proximity to prevent cross-interference.

### 4. Wiring the Receiver

Connect the receiver unit into the ceiling fan's wiring. The receiver is typically installed inside the fan's canopy. Follow the wiring diagram below:

- **Black Wire (AC IN L):** Connect to the live (hot) wire from the ceiling junction box.
- **White Wire (AC IN N):** Connect to the neutral wire from the ceiling junction box.
- **Blue Wire (TO LIGHT):** Connect to the light kit's live wire.
- **Black Wire (TO FAN):** Connect to the fan motor's live wire.
- **White Wire (COMMON):** Connect to the neutral wire of both the fan motor and the light kit.

Use the provided wire nuts to secure all connections. Ensure each connection is tight and insulated.



Compatible with most downrod style fans



Halogen & Incandescent Lamps



Please don't use with wall mounted fans or exhaust-type fans



Dimmable LED Lamps



Dimmable CFL Lamps



Compatible with incandescent light bulbs and dimmable LED/CFL lamps, other LED/CFL lamps only support ON/OFF function.

Image: Detailed wiring diagram showing how to connect the Eogifree receiver unit to the household wiring and the ceiling fan's motor and light kit using color-coded wires and wire nuts.

## How to Use Wire Nuts

1. Strip approximately 1/2 inch of insulation from the ends of the wires to be connected.
2. Twist the bare ends of the wires together clockwise.
3. Place a wire nut over the twisted wires and twist clockwise until secure. Ensure no bare wire is exposed.



Please check the part number on the back of your original remote control or the original model, it needs to have one of the numbers listed above.

## COMPATIBILITY

- Compatible with **FAN30R**, **FAN28R**, **FAN18R** and **UC7067FMRX** Receiver.
- Replacement of these Remotes.  
**FCC ID/ Model:**

2AAZPFAN53T/FAN-53T/  
L3HFANI1T/FAN-11T/  
KUJCE9103/E08BT/  
CHQ7030T/UC7030T(53T)



2AAZPFAN35T1/L3HFAN35T/  
L3HFAN35T1/KUJCE9603/  
CHQ7202T(35T)



L3H2010FANHD/FAN-HD/  
L3H2014FANHD/FAN-HD/  
FAN-HD5(HD5)



UC-9050T/CHQ9051T/  
UC7067(9050T)



Image: Step-by-step visual guide on properly using wire nuts to secure electrical connections, showing stripping, twisting, and capping wires.

### 5. Securing the Receiver and Canopy

Carefully tuck the wired receiver into the ceiling fan canopy. Ensure it fits without pinching any wires. Reattach the canopy to the ceiling fan mounting bracket.

### 6. Install Battery in Remote

Open the battery compartment on the back of the remote control transmitter and insert a 9-volt battery (not included), observing the correct polarity.

### 7. Power Restoration

Restore power to the ceiling fan at the circuit breaker.

## OPERATING INSTRUCTIONS



The Eogiffee remote control provides intuitive operation for your ceiling fan and light.



Image: The Eogiffee remote control, highlighting its five distinct buttons for fan speed and light control.

- **HI:** Press to set the fan speed to High.
- **MED:** Press to set the fan speed to Medium.
- **LOW:** Press to set the fan speed to Low.
- **OFF:** Press to turn the fan off.
- **Green Light Button:** Press to turn the fan light ON or OFF. This button does not control dimming.

# SETTING THE CODES

Note: Slide the switches in the new remote to match the same pattern as the original remote.



## Product Features



### 3-Speed Control:

HIGH/MED/LOW/FAN OFF



### Turn On/Off The Light:

ON/OFF

Image: A hand holding the Eogiffee remote control, demonstrating its use to operate a ceiling fan with light, showing the fan speed and light on/off functions.

## MAINTENANCE

- **Battery Replacement:** Replace the 9-volt battery in the remote control when its range decreases or if the remote becomes unresponsive.
- **Cleaning:** Wipe the remote control and receiver with a soft, dry cloth. Do not use abrasive cleaners or solvents.
- **Environmental Conditions:** Avoid exposing the remote and receiver to extreme temperatures, direct sunlight, or high humidity.

## TROUBLESHOOTING

Problem	Possible Cause	Solution
---------	----------------	----------

Fan or light does not respond to remote.	<ul style="list-style-type: none"><li>◦ No power to the fan.</li><li>◦ Incorrect DIP switch settings.</li><li>◦ Dead or low battery in remote.</li><li>◦ Loose wiring connections.</li><li>◦ Receiver malfunction.</li></ul>	<ul style="list-style-type: none"><li>◦ Check circuit breaker and wall switch.</li><li>◦ Verify DIP switches on both remote and receiver match.</li><li>◦ Replace the 9-volt battery in the remote.</li><li>◦ Turn off power, recheck all wiring connections.</li><li>◦ Contact customer support if other solutions fail.</li></ul>
Remote range is poor.	<ul style="list-style-type: none"><li>◦ Low battery.</li><li>◦ Obstructions between remote and receiver.</li></ul>	<ul style="list-style-type: none"><li>◦ Replace the 9-volt battery.</li><li>◦ Ensure clear line of sight or reduce distance.</li></ul>
Fan operates unexpectedly (e.g., turns on by itself).	<ul style="list-style-type: none"><li>◦ DIP switch interference from another remote.</li></ul>	<ul style="list-style-type: none"><li>◦ Change the DIP switch pattern on both your remote and receiver to a unique combination.</li></ul>

WARRANTY AND SUPPORT

For warranty information or technical support, please refer to the product packaging or contact the seller directly. Keep your purchase receipt as proof of purchase.

**Contact Information:** Please refer to your purchase platform or product packaging for the most current customer service contact details.



Related Documents - 750466180678

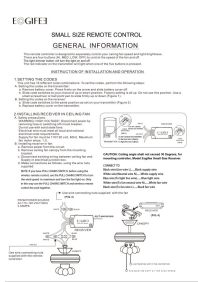

[Eogiffee Small Size Remote Control for Ceiling Fans - User Manual](#)

Comprehensive guide for installing and operating the Eogiffee Small Size Universal Ceiling Fan Remote Control and Receiver. Learn how to set codes, wire the receiver, operate the transmitter, and troubleshoot common issues.



## [Eogifree Small Size Remote Control for Ceiling Fans - User Manual](#)

Comprehensive guide for installing and operating the Eogifree Small Size Universal Ceiling Fan Remote Control and Receiver. Learn how to set codes, wire the receiver, operate the transmitter, and troubleshoot common issues.