

## EAW RS121

# EAW RS121 2-Way Self Powered Loudspeaker User Manual

Model: RS121

## 1. INTRODUCTION

---

Thank you for choosing the EAW RS121 2-Way Self Powered Loudspeaker. This manual provides essential information for the safe and efficient operation of your new audio equipment. The RS121 is a high-performance, self-powered loudspeaker designed for professional sound reinforcement applications, featuring touring-grade transducers for exceptional audio clarity and power.

Please read this manual thoroughly before operating the loudspeaker and retain it for future reference.

## 2. SAFETY INFORMATION

---

Always observe the following safety precautions to prevent electric shock, fire, or injury:

- **Power Source:** Connect the loudspeaker only to a power supply of the type described in this manual and marked on the unit.
- **Grounding:** Ensure the power cord is properly grounded to prevent electrical shock.
- **Ventilation:** Do not block any ventilation openings. Ensure adequate airflow around the unit to prevent overheating.
- **Water and Moisture:** This product is *not waterproof*. Do not expose the loudspeaker to rain, moisture, or excessive humidity. Do not place objects filled with liquids on or near the unit.
- **Cleaning:** Unplug the unit from the power outlet before cleaning. Use a dry cloth only.
- **Servicing:** Do not attempt to service this product yourself. Refer all servicing to qualified service personnel.
- **Placement:** Place the loudspeaker on a stable, level surface or mount it securely using appropriate hardware. Avoid placing it in direct sunlight or near heat sources.
- **Hearing Protection:** Prolonged exposure to high sound pressure levels can cause permanent hearing damage. Use appropriate hearing protection when operating the loudspeaker at high volumes.

## 3. PRODUCT OVERVIEW

---



### 3.1 Key Features

- 2-Way Self-Powered Design
- 12-inch Woofer for powerful bass response
- Integrated Power Amplifier with 1200 Watts maximum output
- Touring-Grade Transducers for high fidelity audio
- Multiple Connectivity Options: RCA, Coaxial, XLR
- Durable enclosure suitable for professional use

### 3.2 Components and Controls

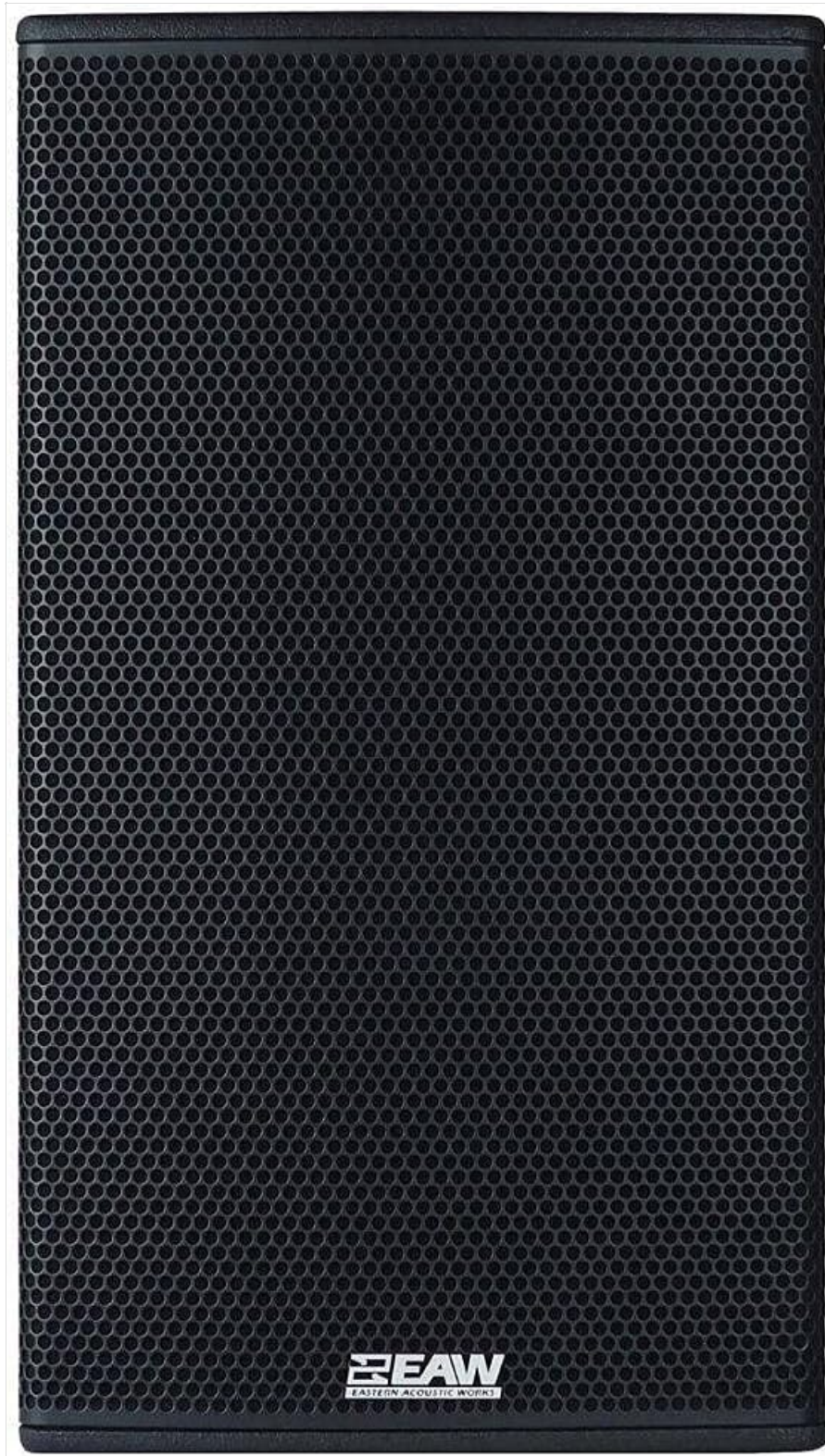

**Figure 3.2.1:** Front view of the EAW RS121 loudspeaker, showcasing the protective grille and the EAW logo at the



bottom.

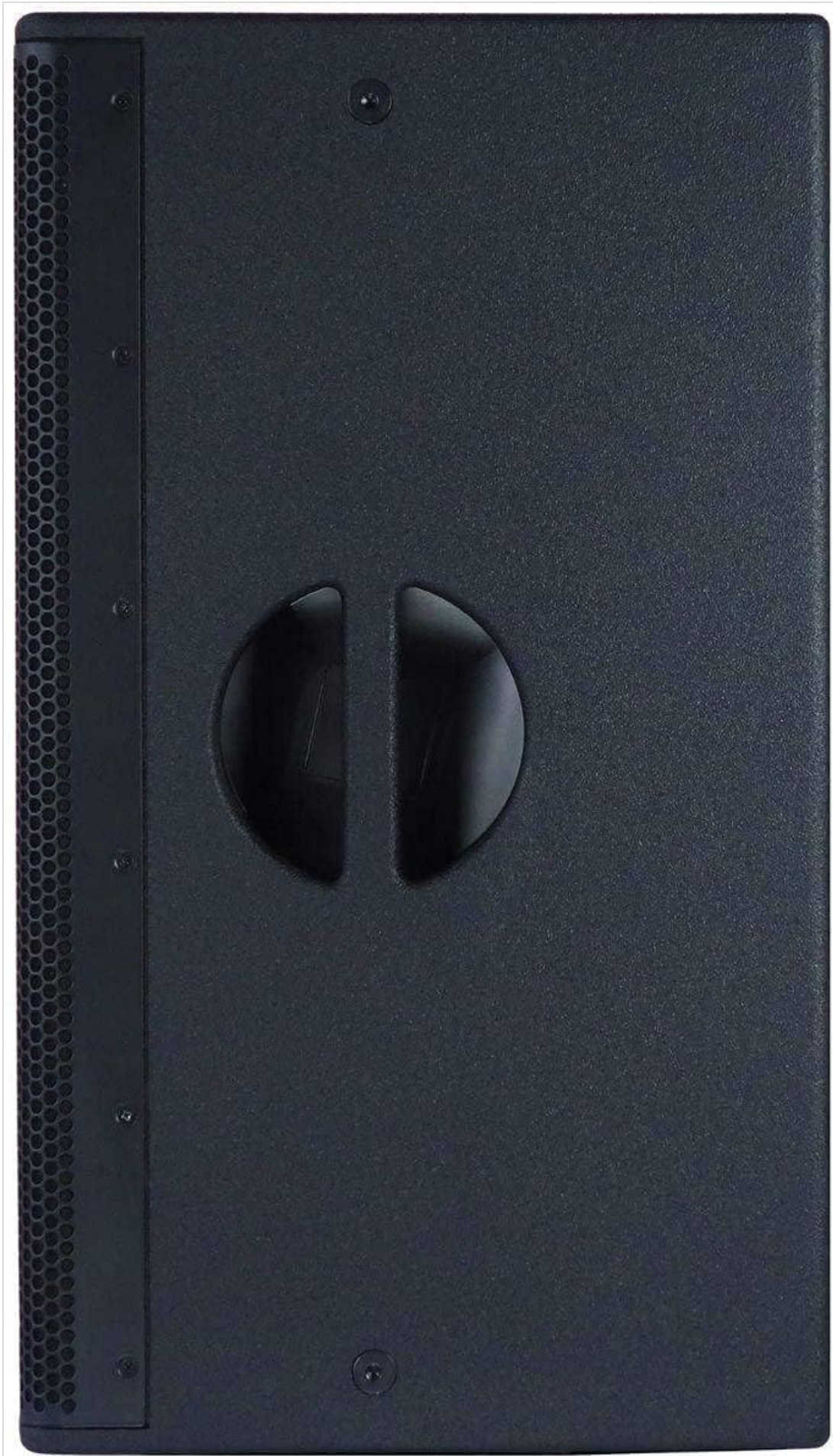

**Figure 3.2.2:** Side view of the EAW RS121 loudspeaker, showing the robust enclosure and integrated handles for easy transport.





**Figure 3.2.3:** Another side view of the EAW RS121 loudspeaker, highlighting the durable construction and potential mounting points or additional handles.





**Figure 3.2.4:** Rear view of the EAW RS121 loudspeaker, detailing the control panel with input/output connections (XLR, RCA, Coaxial), level controls, and power switch.

The rear panel (Figure 3.2.4) houses all essential controls and connections:



- **Input Section:** Includes XLR, RCA, and Coaxial inputs for versatile connectivity with various audio sources.
- **Level Control:** Adjusts the overall output volume of the loudspeaker.
- **Limit/Status Indicators:** LEDs to monitor operational status and signal limiting.
- **Power Switch:** Toggles the unit on and off.
- **AC Power Inlet:** For connecting the main power cable.
- **Thru Output:** Allows for daisy-chaining audio signals to other loudspeakers or devices.

## 4. WHAT'S IN THE BOX

---

Upon unpacking your EAW RS121 loudspeaker, please ensure all listed items are present:

- 1 x EAW RS121 Self Powered Loudspeaker (includes integrated power amplifier and transducers)
- 1 x AC Power Cable
- 1 x User Manual (this document)

*Note: The "Number of Items: 2" listed in some product specifications refers to the primary components within the loudspeaker system (power amplifier and transducers), not two separate loudspeaker units.*

## 5. SETUP

---

### 5.1 Placement

The EAW RS121 is designed for floor standing applications. Place the loudspeaker on a stable, flat surface. Ensure there is adequate space around the unit for ventilation, especially at the rear where the amplifier is located.

### 5.2 Connections

1. **Power Connection:** Connect the supplied AC power cable to the AC power inlet on the rear panel of the loudspeaker and then to a grounded electrical outlet.
2. **Audio Input:** Connect your audio source (e.g., mixer, audio interface, television) to the desired input on the rear panel (XLR, RCA, or Coaxial). Use high-quality shielded cables for optimal performance.
3. **Daisy-Chaining (Optional):** If connecting multiple loudspeakers, use the "Thru" output to send the audio signal to the input of another loudspeaker.

Ensure all connections are secure before powering on the unit.

## 6. OPERATING INSTRUCTIONS

---

1. **Initial Power On:** Before turning on the loudspeaker, ensure the Level control is set to its minimum position.
2. **Power On:** Flip the Power Switch on the rear panel to the "ON" position. The power indicator LED should illuminate.
3. **Adjusting Volume:** Start playing audio from your source. Slowly increase the Level control on the loudspeaker until the desired volume is achieved. Monitor the Limit/Status indicators; if the Limit LED flashes frequently, reduce the volume to prevent distortion and potential damage.
4. **Remote Control (if applicable):** The loudspeaker supports remote control. Refer to the remote control's specific instructions for pairing and operation.
5. **Power Off:** Before powering off, reduce the Level control to its minimum. Then, flip the Power Switch to the "OFF" position.



## 7. MAINTENANCE

Proper maintenance ensures the longevity and optimal performance of your EAW RS121 loudspeaker.

- **Cleaning:** Disconnect the power before cleaning. Use a soft, dry cloth to wipe the exterior surfaces. Do not use abrasive cleaners, waxes, or solvents.
- **Ventilation:** Regularly check that the ventilation openings are clear of dust and debris. Use a soft brush or compressed air to clean them if necessary.
- **Storage:** If storing the loudspeaker for an extended period, keep it in a dry, cool environment, away from direct sunlight and extreme temperatures.
- **Inspection:** Periodically inspect power cables and audio cables for any signs of damage. Replace damaged cables immediately.

## 8. TROUBLESHOOTING

If you encounter issues with your EAW RS121 loudspeaker, refer to the following common problems and solutions:

Problem	Possible Cause	Solution
No Power	Power cable not connected; Power outlet faulty; Power switch off.	Ensure power cable is securely connected; Test outlet with another device; Turn power switch ON.
No Sound Output	Input cable not connected; Level control too low; Audio source issue; Incorrect input selected (if applicable).	Check audio input cable connections; Increase Level control; Verify audio source is playing; Ensure correct input is used.
Distorted Sound	Input signal too high (clipping); Loudspeaker volume too high; Damaged cable.	Reduce input signal level from source; Decrease loudspeaker Level control; Replace audio cable.
Hum or Buzz	Ground loop; Faulty cable; Interference from other electronics.	Ensure proper grounding; Try different cables; Move loudspeaker away from interfering devices.

If the problem persists after trying these solutions, please contact EAW customer support or a qualified service technician.

## 9. SPECIFICATIONS

Feature	Detail
Model Name	RS121
Speaker Type	Tower
Recommended Uses	For Sound Reinforcement
Compatible Devices	Laptop, Television, Home Theater



Feature	Detail
Included Components	Power amplifier, Transducers
Waterproof	No
Number of Items	1 (Loudspeaker unit)
Control Method	Remote
Speaker Size	12 Inches
Power Source	Corded Electric
Woofer Diameter	12 Inches
Audio Driver Type	Dynamic Driver
Audio Driver Size	12 Inches
UPC	810014770291
ASIN	B086VPDDQP
Date First Available	March 19, 2020
Brand	EAW
Speaker Maximum Output Power	1200 Watts
Connectivity Technology	RCA, Coaxial, XLR
Audio Output Mode	Mono
Mounting Type	Floor Standing

## 10. WARRANTY AND SUPPORT

### 10.1 Limited Warranty

The EAW RS121 loudspeaker comes with a Limited Warranty. For specific terms, conditions, and duration of the warranty, please refer to the official EAW website or contact EAW customer support directly. This warranty typically covers defects in materials and workmanship under normal use.

### 10.2 Customer Support





For technical assistance, troubleshooting beyond this manual, or warranty claims, please contact EAW customer support. You can typically find contact information, including phone numbers and email addresses, on the official EAW website:

[Visit EAW Support Website](#)

When contacting support, please have your product model (RS121) and serial number (if applicable) ready.

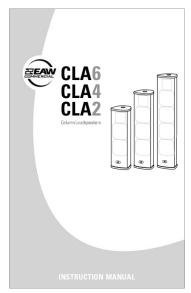

Related Documents - RS121

 <p>RS &amp; LA User Manual</p>	<p><a href="#">EAW RS &amp; LA Series Loudspeaker User Manual</a></p> <p>Comprehensive user manual for Eastern Acoustic Works (EAW) RS and LA Series loudspeakers, covering safety, specifications, operation, connections, troubleshooting, and warranty information.</p>
 <p>MKC120 2-Way Coaxial Loudspeaker</p>	<p><a href="#">EAW MKC120 2-Way Coaxial Loudspeaker: Specifications and Mounting</a></p> <p>Detailed specifications, technologies, ordering information, and mounting options for the EAW MKC120 2-Way Coaxial Loudspeaker. Includes performance graphs, technical data, and mechanical drawings.</p>
 <p>MKC80 2-Way Coaxial Loudspeaker</p>	<p><a href="#">EAW MKC80 2-Way Coaxial Loudspeaker - Technical Specifications and Mounting Options</a></p> <p>Explore the EAW MKC80, a high-output, compact 2-way coaxial loudspeaker. This document details its technical specifications, including performance metrics, configuration, and physical attributes. It also covers various mounting options such as U-brackets, ceiling mounts, and wall mounts, along with their respective part numbers and installation diagrams. Discover the advanced technologies like Beamwidth Matched Crossovers, Focusing™, and Dyno™ that enhance audio fidelity.</p>
 <p>MKC60 2-Way Coaxial Loudspeaker</p>	<p><a href="#">EAW MKC60 2-Way Coaxial Loudspeaker: Specifications and Mounting Options</a></p> <p>Detailed technical specifications, technologies, ordering information, and mounting options for the EAW MKC60 2-Way Coaxial Loudspeaker. Includes performance data, physical dimensions, rigging configurations, and accessory details.</p>
 <p>CLA6 CLA4 CLA2 Commercial</p> <p>INSTRUCTION MANUAL</p>	<p><a href="#">EAW Commercial CLA Series Column Loudspeakers Instruction Manual</a></p> <p>Comprehensive instruction manual for EAW Commercial CLA Series column loudspeakers (CLA2, CLA4, CLA6), covering safety, installation, connections, specifications, service, and warranty.</p>



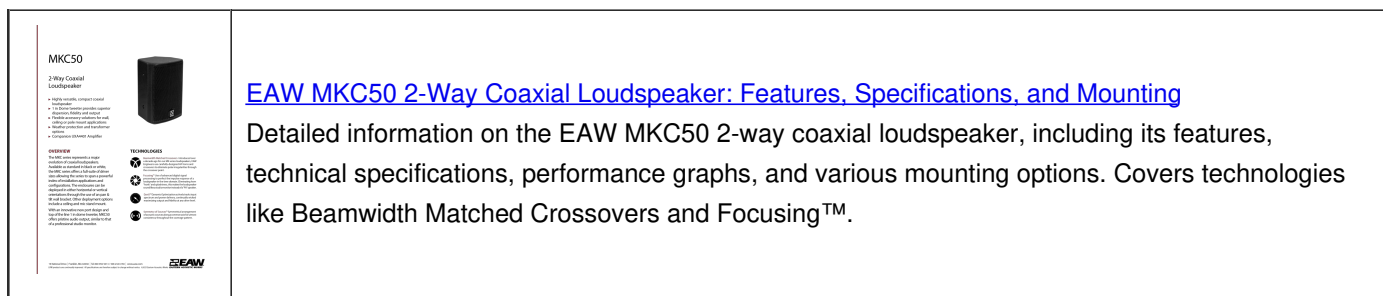

## Documents - EAW – RS121



[\[pdf\]](#) User Manual Installation Guide Instructions

RS Series User Manual > eaw 1 IMPORTANT SAFETY INSTRUCTIONS READ THIS FIRST Safety Instructions Read and heed all warnings safety instructions in this manual before using product Failure to follow these precautions may result damage injury or death 1) RD3004\_C\_MNL\_Owners\_RS\_Series uploads 2021 01 User Manual Eastern Acoustic Works 9) Do not defeat the purpose of polarized grounding-type plug A has two blades with one wider than other soundpro content product-documents RS Series User Manual IMPORTANT SAFETY INSTRUCTIONS - READ THIS FIRST Safety Instructions Read and ... te AV, rental staging, and installation. RS Series consists of four two-way, point source models **RS121**, RS123, RS151, RS153 and two subwoofers RS115 RS118 . SPECIFICATIONS RS Two-Way Point So...  
lang:en score:40 filesize: 3.66 M page count: 28 document date: 2021-01-11

[\[pdf\]](#) Datasheet

||| 10 2023 proavl net Data Sheet Eaw Proavl RS121 مدل کلیات فنی دستگاه اسپیکر

RS Series 2-Way Self-Powered Loudspeakers **RS121/123** RS151/153 1500 watts of Class-D Amplification High quality transducers for best-in-class acoustic performance. EAW Focusing™ for unmatched clarity accuracy Rotatable MK inspired horn for EAW signature pattern control Lightweight durable...

lang:en score:37 filesize: 2.87 M page count: 4 document date: 2023-10-30



### RS Series

#### 2-Way Self-Powered Loudspeakers

RS 121/123 & RS 151/153

- 1500 watts of Class-D Amplification
- Leading-edge housing grade transducers
- EAW Focusing™ for unmatched clarity & accuracy
- Rotatable MK inspired horn for EAW signature pattern control
- Lightweight & durable wooden enclosure with M10 threaded suspension points



#### OVERVIEW

The RS Series delivers EAW signature performance in a meticulously designed portable, lightweight and durable enclosure. Each loudspeaker in the series is designed around the horn housing grade and transducers. Pattern control of the RS Series is further enhanced by the unique internal, constant directivity M10 horn, first proven in the legendary MK Series. This horn design was born from the audio performance needs of demanding performance venues throughout the world.

RS loudspeakers house on-board hi-amplified electronics (D2000) featuring signature EAW DSP, Focusing™ and Dyno™ to deliver unmatched musical clarity and total accuracy throughout the listening area and at high site levels. Advanced port design utilizes asymmetric geometry to control reflections and resonance.

EAW Revolution™ software platform is a powerful and easy-to-use simulation software that accurately predicts the performance of one or multiple RS Series enclosures within a venue or performance space.

#### INSIDE EAW TECHNOLOGIES

Durable Wood Enclosure  
Lightweight and designed to minimize resonance

Amplifier with EAW DSP, Focusing™ and Dyno™ on-board hi-amplified electronics

Large MK Horn (constant directivity)

Asymmetric Asymmetrical Port Design (controls reflections)

#### COMPANION PRODUCTS

RS Subwoofer Series

- 1500 watts of Class-D Amplification
- Real-time signal processing for unmatched clarity & accuracy
- Powerful transducers and signature EAW DSP™ dynamic optimization processing
- Ergonomic handles, rugged grille, Road-Cut enclosure, pole cap and optional casters

One Stop Shop | Milwaukee, WI 53208 | Tel: 414-962-1001 | Fax: 414-962-1002 | [www.eaw.com](http://www.eaw.com)  
EAW products are trademarks registered. All product names are trademarks of EAW Audio Systems. ©2019 EAW Audio Systems. EAW



[pdf] Specifications

RS Series Heliart The delivers EAW signature performance in 121 123 151 153 RS153 Frequency

Response ▫ LF HF Overall RS121 SPECS 1 3 heliart ee static custom File Tooteinfo eaw 2020 04

RS Series 2-Way Self-Powered Loudspeakers RS 121/123 RS 151/153 1500 watts of

Class-D Amplificat ... readed Pole Multiple M10 Mounting Points\* PERFORMANCE

GRAPHS Frequency Response =LF =HF =Overall **RS121** RS151 ACCESSORIES

DESCRIPTION **RS121**/123 RS151/153 Transport Cover not shown M20 Positiv...

lang:en score:33 filesize: 662.1 K page\_count: 4 document date: 2019-11-15

### RS Series

#### 2-Way Self-Powered Loudspeakers

RS121/123 & RS151/153

- 1500 watts of Class-D Amplification
- High quality transducers for best-in-class acoustic performance
- EAW Focusing™ for unmatched clarity & accuracy
- Rotatable MK inspired horn for EAW signature pattern control
- Lightweight & durable wooden enclosure with M10 threaded suspension points



#### OVERVIEW

The RS Series delivers EAW signature performance in a meticulously designed portable, lightweight and durable enclosure. Each loudspeaker in the series is designed around the horn housing grade and transducers. Pattern control of the RS Series is further enhanced by the unique internal, constant directivity M10 horn, first proven in the legendary MK Series. This horn design was born from the audio performance needs of demanding performance venues throughout the world.

RS loudspeakers house on-board hi-amplified electronics (D2000) featuring signature EAW DSP, Focusing™ and Dyno™ to deliver unmatched musical clarity and total accuracy throughout the listening area and at high site levels. Advanced port design utilizes asymmetric geometry to control reflections and resonance.

EAW Revolution™ software platform is a powerful and easy-to-use simulation software that accurately predicts the performance of one or multiple RS Series enclosures within a venue or performance space.

#### INSIDE EAW TECHNOLOGIES

Durable Wood Enclosure  
Lightweight and designed to minimize resonance

Amplifier with EAW DSP, Focusing™ and Dyno™ on-board hi-amplified electronics

Large MK Horn (constant directivity)

Asymmetric Asymmetrical Port Design (controls reflections)

#### COMPANION PRODUCTS

RS Subwoofer Series

- 1500 watts of Class-D Amplification
- Real-time signal processing for unmatched clarity & accuracy
- Powerful transducers and signature EAW DSP™ dynamic optimization processing
- Ergonomic handles, rugged grille, Road-Cut enclosure, pole cap and optional casters

One Stop Shop | Milwaukee, WI 53208 | Tel: 414-962-1001 | Fax: 414-962-1002 | [www.eaw.com](http://www.eaw.com)  
EAW products are trademarks registered. All product names are trademarks of EAW Audio Systems. ©2019 EAW Audio Systems. EAW



[pdf] Datasheet

اسپیکر EAW کلیات فنی دستگاه اسپیکر RS123 Proavl Eaw Data Sheet proavl net 2023 10 |||

RS Series 2-Way Self-Powered Loudspeakers**RS121**/123 RS151/153 1500 watts of

Class-D Amplification High quality transducers for best-in-class acoustic performance.

EAW Focusing™ for unmatched clarity accuracy Rotatable MK inspired horn for

EAW signature pattern control Lightweight durable...

lang:en score:28 filesize: 2.87 M page\_count: 4 document date: 2023-10-31

### RS Series

#### 2-Way Self-Powered Loudspeakers

RS121/123 & RS151/153

- 1500 watts of Class-D Amplification
- High quality transducers for best-in-class acoustic performance
- EAW Focusing™ for unmatched clarity & accuracy
- Rotatable MK inspired horn for EAW signature pattern control
- Lightweight & durable wooden enclosure with M10 threaded suspension points



#### OVERVIEW

The RS Series delivers EAW signature performance in a meticulously designed portable, lightweight and durable enclosure. Each loudspeaker in the series is designed around the horn housing grade and transducers. Pattern control of the RS Series is further enhanced by the unique internal, constant directivity M10 horn, first proven in the legendary MK Series. This horn design was born from the audio performance needs of demanding performance venues throughout the world.

RS loudspeakers house on-board hi-amplified electronics (D2000) featuring signature EAW DSP, Focusing™ and Dyno™ to deliver unmatched musical clarity and total accuracy throughout the listening area and at high site levels. Advanced port design utilizes asymmetric geometry to control reflections and resonance.

EAW Revolution™ software platform is a powerful and easy-to-use simulation software that accurately predicts the performance of one or multiple RS Series enclosures within a venue or performance space.

#### INSIDE EAW TECHNOLOGIES

Durable Wood Enclosure  
Lightweight and designed to minimize resonance

Amplifier with EAW DSP, Focusing™ and Dyno™ on-board hi-amplified electronics

Large MK Horn (constant directivity)

Asymmetric Asymmetrical Port Design (controls reflections)

#### COMPANION PRODUCTS

RS Subwoofer Series

- 1500 watts of Class-D Amplification
- Real-time signal processing for unmatched clarity & accuracy
- Powerful transducers and signature EAW DSP™ dynamic optimization processing
- Ergonomic handles, rugged grille, Road-Cut enclosure, pole cap and optional casters

One Stop Shop | Milwaukee, WI 53208 | Tel: 414-962-1001 | Fax: 414-962-1002 | [www.eaw.com](http://www.eaw.com)  
EAW products are trademarks registered. All product names are trademarks of EAW Audio Systems. ©2019 EAW Audio Systems. EAW



[pdf] Datasheet

اسپیکر EAW کلیات فنی دستگاه اسپیکر RS153 Proavl Eaw Data Sheet proavl net 2023 10 |||

RS Series 2-Way Self-Powered Loudspeakers**RS121**/123 RS151/153 1500 watts of

Class-D Amplification High quality transducers for best-in-class acoustic performance.

EAW Focusing™ for unmatched clarity accuracy Rotatable MK inspired horn for

EAW signature pattern control Lightweight durable...

lang:en score:28 filesize: 2.87 M page\_count: 4 document date: 2023-10-31

### RS Series

#### 2-Way Self-Powered Loudspeakers

RS121/123 & RS151/153

- 1500 watts of Class-D Amplification
- High quality transducers for best-in-class acoustic performance
- EAW Focusing™ for unmatched clarity & accuracy
- Rotatable MK inspired horn for EAW signature pattern control
- Lightweight & durable wooden enclosure with M10 threaded suspension points



#### OVERVIEW

The RS Series delivers EAW signature performance in a meticulously designed portable, lightweight and durable enclosure. Each loudspeaker in the series is designed around the horn housing grade and transducers. Pattern control of the RS Series is further enhanced by the unique internal, constant directivity M10 horn, first proven in the legendary MK Series. This horn design was born from the audio performance needs of demanding performance venues throughout the world.

RS loudspeakers house on-board hi-amplified electronics (D2000) featuring signature EAW DSP, Focusing™ and Dyno™ to deliver unmatched musical clarity and total accuracy throughout the listening area and at high site levels. Advanced port design utilizes asymmetric geometry to control reflections and resonance.

EAW Revolution™ software platform is a powerful and easy-to-use simulation software that accurately predicts the performance of one or multiple RS Series enclosures within a venue or performance space.

#### INSIDE EAW TECHNOLOGIES

Durable Wood Enclosure  
Lightweight and designed to minimize resonance

Amplifier with EAW DSP, Focusing™ and Dyno™ on-board hi-amplified electronics

Large MK Horn (constant directivity)

Asymmetric Asymmetrical Port Design (controls reflections)

#### COMPANION PRODUCTS

RS Subwoofer Series

- 1500 watts of Class-D Amplification
- Real-time signal processing for unmatched clarity & accuracy
- Powerful transducers and signature EAW DSP™ dynamic optimization processing
- Ergonomic handles, rugged grille, Road-Cut enclosure, pole cap and optional casters

One Stop Shop | Milwaukee, WI 53208 | Tel: 414-962-1001 | Fax: 414-962-1002 | [www.eaw.com](http://www.eaw.com)  
EAW products are trademarks registered. All product names are trademarks of EAW Audio Systems. ©2019 EAW Audio Systems. EAW



[pdf] Datasheet

اسپیکر EAW کلیات فنی دستگاه اسپیکر RS151 Proavl Eaw Data Sheet proavl net 2023 10 |||

RS Series 2-Way Self-Powered Loudspeakers**RS121**/123 RS151/153 1500 watts of

Class-D Amplification High quality transducers for best-in-class acoustic performance.

EAW Focusing™ for unmatched clarity accuracy Rotatable MK inspired horn for

EAW signature pattern control Lightweight durable...

lang:en score:28 filesize: 2.87 M page\_count: 4 document date: 2023-10-31



### RS Series

#### 2-Way Self-Powered Loudspeakers

##### RS121/123 & RS151/153

- 1500 watts of Class-D Amplification
- High quality transducers for best-in-class acoustic performance
- EAW Focusing™ for unmatched clarity & accuracy
- Rotatable M6 inspired horn for EAW signature pattern control
- Lightweight & durable wooden enclosure with M10 threaded suspension points



#### OVERVIEW

The RS Series delivers EAW signature performance in a meticulously designed portable, lightweight and durable wooden enclosure. Each loudspeaker in the series is designed around the three basic goals of EAW: Focusing™ and Dyna™ to deliver unmatched musical clarity and total accuracy throughout the listening area and at high line levels. Awarded patent designations for the RS Series have been granted for the RS Series, this horn design has been born from the audio performance needs of demanding performance venues throughout the world.

RS loudspeakers house on-board amplified electronics (DSD) featuring signature EAW DSP, Focusing™ and Dyna™ to deliver unmatched musical clarity and total accuracy throughout the listening area and at high line levels. Awarded patent designations for the RS Series have been granted for the RS Series, this horn design has been born from the audio performance needs of demanding performance venues throughout the world.

EAW Revolution™ software platform is a powerful and easy-to-use simulation software that accurately predicts the performance of one or multiple RS Series enclosures within a venue or performance space.



#### COMPARISON PRODUCTS

RS 1500W Series

- 1500 watts of Class-D Amplification
- Lead-edge touring grade transducers
- EAW Focusing™ for unmatched clarity & accuracy
- Rotatable M6 inspired horn for EAW signature pattern control
- Lightweight & durable wooden enclosure with M10 threaded suspension points



One State Street • Middlebury, NH 05750 • Tel: 800-962-1011 / 800-224-2148 • [www.eaw.com](http://www.eaw.com)

EAW products are not to be copied. All product names and features subject to change without notice. ©2013 Eastern Acoustic Works. EAW is a registered trademark.



### RS Series

#### 2-Way Self-Powered Loudspeakers

##### RS 121/123 & RS 151/153

- 1500 watts of Class-D Amplification
- Lead-edge touring grade transducers
- EAW Focusing™ for unmatched clarity & accuracy
- Rotatable M6 inspired horn for EAW signature pattern control
- Lightweight & durable wooden enclosure with M10 threaded suspension points



#### OVERVIEW

The RS Series delivers EAW signature performance in a meticulously designed portable, lightweight and durable wooden enclosure. Each loudspeaker in the series is designed around the three basic goals of EAW: Focusing™ and Dyna™ to deliver unmatched musical clarity and total accuracy throughout the listening area and at high line levels. Awarded patent designations for the RS Series have been granted for the RS Series, this horn design has been born from the audio performance needs of demanding performance venues throughout the world.

RS loudspeakers house on-board amplified electronics (DSD) featuring signature EAW DSP, Focusing™ and Dyna™ to deliver unmatched musical clarity and total accuracy throughout the listening area and at high line levels. Awarded patent designations for the RS Series have been granted for the RS Series, this horn design has been born from the audio performance needs of demanding performance venues throughout the world.

EAW Revolution™ software platform is a powerful and easy-to-use simulation software that accurately predicts the performance of one or multiple RS Series enclosures within a venue or performance space.



#### COMPARISON PRODUCTS

RS 1500W Series

- 1500 watts of Class-D Amplification
- Lead-edge touring grade transducers
- EAW Focusing™ for unmatched clarity & accuracy
- Rotatable M6 inspired horn for EAW signature pattern control
- Lightweight & durable wooden enclosure with M10 threaded suspension points



One State Street • Middlebury, NH 05750 • Tel: 800-962-1011 / 800-224-2148 • [www.eaw.com](http://www.eaw.com)

EAW products are not to be copied. All product names and features subject to change without notice. ©2013 Eastern Acoustic Works. EAW is a registered trademark.



## EAW RS123

### 2ウェイセルフパワーードスピーカー

本シリーズは、EAWのサウンドテクノロジーを駆使した、音質に優れ、軽量で持ち運びやすい、最新のデジタルDSP（デジタル信号処理）と、手動で調節可能なEAWのサウンドテクノロジーを搭載しています。また、本シリーズは、音質に優れ、軽量で持ち運びやすい、最新のデジタルDSP（デジタル信号処理）と、手動で調節可能なEAWのサウンドテクノロジーを搭載しています。

#### 仕様

最大出力	1500 W
最大出力周波数	45 Hz - 20 kHz
最大出力レベル	80 dB, 85 dB, 90 dB, 95 dB, 100 dB, 105 dB, 110 dB, 115 dB, 120 dB, 125 dB, 130 dB, 135 dB, 140 dB, 145 dB, 150 dB, 155 dB, 160 dB, 165 dB, 170 dB, 175 dB, 180 dB, 185 dB, 190 dB, 195 dB, 200 dB, 205 dB, 210 dB, 215 dB, 220 dB, 225 dB, 230 dB, 235 dB, 240 dB, 245 dB, 250 dB, 255 dB, 260 dB, 265 dB, 270 dB, 275 dB, 280 dB, 285 dB, 290 dB, 295 dB, 300 dB, 305 dB, 310 dB, 315 dB, 320 dB, 325 dB, 330 dB, 335 dB, 340 dB, 345 dB, 350 dB, 355 dB, 360 dB, 365 dB, 370 dB, 375 dB, 380 dB, 385 dB, 390 dB, 395 dB, 400 dB, 405 dB, 410 dB, 415 dB, 420 dB, 425 dB, 430 dB, 435 dB, 440 dB, 445 dB, 450 dB, 455 dB, 460 dB, 465 dB, 470 dB, 475 dB, 480 dB, 485 dB, 490 dB, 495 dB, 500 dB, 505 dB, 510 dB, 515 dB, 520 dB, 525 dB, 530 dB, 535 dB, 540 dB, 545 dB, 550 dB, 555 dB, 560 dB, 565 dB, 570 dB, 575 dB, 580 dB, 585 dB, 590 dB, 595 dB, 600 dB, 605 dB, 610 dB, 615 dB, 620 dB, 625 dB, 630 dB, 635 dB, 640 dB, 645 dB, 650 dB, 655 dB, 660 dB, 665 dB, 670 dB, 675 dB, 680 dB, 685 dB, 690 dB, 695 dB, 700 dB, 705 dB, 710 dB, 715 dB, 720 dB, 725 dB, 730 dB, 735 dB, 740 dB, 745 dB, 750 dB, 755 dB, 760 dB, 765 dB, 770 dB, 775 dB, 780 dB, 785 dB, 790 dB, 795 dB, 800 dB, 805 dB, 810 dB, 815 dB, 820 dB, 825 dB, 830 dB, 835 dB, 840 dB, 845 dB, 850 dB, 855 dB, 860 dB, 865 dB, 870 dB, 875 dB, 880 dB, 885 dB, 890 dB, 895 dB, 900 dB, 905 dB, 910 dB, 915 dB, 920 dB, 925 dB, 930 dB, 935 dB, 940 dB, 945 dB, 950 dB, 955 dB, 960 dB, 965 dB, 970 dB, 975 dB, 980 dB, 985 dB, 990 dB, 995 dB, 1000 dB, 1005 dB, 1010 dB, 1015 dB, 1020 dB, 1025 dB, 1030 dB, 1035 dB, 1040 dB, 1045 dB, 1050 dB, 1055 dB, 1060 dB, 1065 dB, 1070 dB, 1075 dB, 1080 dB, 1085 dB, 1090 dB, 1095 dB, 1100 dB, 1105 dB, 1110 dB, 1115 dB, 1120 dB, 1125 dB, 1130 dB, 1135 dB, 1140 dB, 1145 dB, 1150 dB, 1155 dB, 1160 dB, 1165 dB, 1170 dB, 1175 dB, 1180 dB, 1185 dB, 1190 dB, 1195 dB, 1200 dB, 1205 dB, 1210 dB, 1215 dB, 1220 dB, 1225 dB, 1230 dB, 1235 dB, 1240 dB, 1245 dB, 1250 dB, 1255 dB, 1260 dB, 1265 dB, 1270 dB, 1275 dB, 1280 dB, 1285 dB, 1290 dB, 1295 dB, 1300 dB, 1305 dB, 1310 dB, 1315 dB, 1320 dB, 1325 dB, 1330 dB, 1335 dB, 1340 dB, 1345 dB, 1350 dB, 1355 dB, 1360 dB, 1365 dB, 1370 dB, 1375 dB, 1380 dB, 1385 dB, 1390 dB, 1395 dB, 1400 dB, 1405 dB, 1410 dB, 1415 dB, 1420 dB, 1425 dB, 1430 dB, 1435 dB, 1440 dB, 1445 dB, 1450 dB, 1455 dB, 1460 dB, 1465 dB, 1470 dB, 1475 dB, 1480 dB, 1485 dB, 1490 dB, 1495 dB, 1500 dB, 1505 dB, 1510 dB, 1515 dB, 1520 dB, 1525 dB, 1530 dB, 1535 dB, 1540 dB, 1545 dB, 1550 dB, 1555 dB, 1560 dB, 1565 dB, 1570 dB, 1575 dB, 1580 dB, 1585 dB, 1590 dB, 1595 dB, 1600 dB, 1605 dB, 1610 dB, 1615 dB, 1620 dB, 1625 dB, 1630 dB, 1635 dB, 1640 dB, 1645 dB, 1650 dB, 1655 dB, 1660 dB, 1665 dB, 1670 dB, 1675 dB, 1680 dB, 1685 dB, 1690 dB, 1695 dB, 1700 dB, 1705 dB, 1710 dB, 1715 dB, 1720 dB, 1725 dB, 1730 dB, 1735 dB, 1740 dB, 1745 dB, 1750 dB, 1755 dB, 1760 dB, 1765 dB, 1770 dB, 1775 dB, 1780 dB, 1785 dB, 1790 dB, 1795 dB, 1800 dB, 1805 dB, 1810 dB, 1815 dB, 1820 dB, 1825 dB, 1830 dB, 1835 dB, 1840 dB, 1845 dB, 1850 dB, 1855 dB, 1860 dB, 1865 dB, 1870 dB, 1875 dB, 1880 dB, 1885 dB, 1890 dB, 1895 dB, 1900 dB, 1905 dB, 1910 dB, 1915 dB, 1920 dB, 1925 dB, 1930 dB, 1935 dB, 1940 dB, 1945 dB, 1950 dB, 1955 dB, 1960 dB, 1965 dB, 1970 dB, 1975 dB, 1980 dB, 1985 dB, 1990 dB, 1995 dB, 2000 dB, 2005 dB, 2010 dB, 2015 dB, 2020 dB, 2025 dB, 2030 dB, 2035 dB, 2040 dB, 2045 dB, 2050 dB, 2055 dB, 2060 dB, 2065 dB, 2070 dB, 2075 dB, 2080 dB, 2085 dB, 2090 dB, 2095 dB, 2100 dB, 2105 dB, 2110 dB, 2115 dB, 2120 dB, 2125 dB, 2130 dB, 2135 dB, 2140 dB, 2145 dB, 2150 dB, 2155 dB, 2160 dB, 2165 dB, 2170 dB, 2175 dB, 2180 dB, 2185 dB, 2190 dB, 2195 dB, 2200 dB, 2205 dB, 2210 dB, 2215 dB, 2220 dB, 2225 dB, 2230 dB, 2235 dB, 2240 dB, 2245 dB, 2250 dB, 2255 dB, 2260 dB, 2265 dB, 2270 dB, 2275 dB, 2280 dB, 2285 dB, 2290 dB, 2295 dB, 2300 dB, 2305 dB, 2310 dB, 2315 dB, 2320 dB, 2325 dB, 2330 dB, 2335 dB, 2340 dB, 2345 dB, 2350 dB, 2355 dB, 2360 dB, 2365 dB, 2370 dB, 2375 dB, 2380 dB, 2385 dB, 2390 dB, 2395 dB, 2400 dB, 2405 dB, 2410 dB, 2415 dB, 2420 dB, 2425 dB, 2430 dB, 2435 dB, 2440 dB, 2445 dB, 2450 dB, 2455 dB, 2460 dB, 2465 dB, 2470 dB, 2475 dB, 2480 dB, 2485 dB, 2490 dB, 2495 dB, 2500 dB, 2505 dB, 2510 dB, 2515 dB, 2520 dB, 2525 dB, 2530 dB, 2535 dB, 2540 dB, 2545 dB, 2550 dB, 2555 dB, 2560 dB, 2565 dB, 2570 dB, 2575 dB, 2580 dB, 2585 dB, 2590 dB, 2595 dB, 2600 dB, 2605 dB, 2610 dB, 2615 dB, 2620 dB, 2625 dB, 2630 dB, 2635 dB, 2640 dB, 2645 dB, 2650 dB, 2655 dB, 2660 dB, 2665 dB, 2670 dB, 2675 dB, 2680 dB, 2685 dB, 2690 dB, 2695 dB, 2700 dB, 2705 dB, 2710 dB, 2715 dB, 2720 dB, 2725 dB, 2730 dB, 2735 dB, 2740 dB, 2745 dB, 2750 dB, 2755 dB, 2760 dB, 2765 dB, 2770 dB, 2775 dB, 2780 dB, 2785 dB, 2790 dB, 2795 dB, 2800 dB, 2805 dB, 2810 dB, 2815 dB, 2820 dB, 2825 dB, 2830 dB, 2835 dB, 2840 dB, 2845 dB, 2850 dB, 2855 dB, 2860 dB, 2865 dB, 2870 dB, 2875 dB, 2880 dB, 2885 dB, 2890 dB, 2895 dB, 2900 dB, 2905 dB, 2910 dB, 2915 dB, 2920 dB, 2925 dB, 2930 dB, 2935 dB, 2940 dB, 2945 dB, 2950 dB, 2955 dB, 2960 dB, 2965 dB, 2970 dB, 2975 dB, 2980 dB, 2985 dB, 2990 dB, 2995 dB, 3000 dB, 3005 dB, 3010 dB, 3015 dB, 3020 dB, 3025 dB, 3030 dB, 3035 dB, 3040 dB, 3045 dB, 3050 dB, 3055 dB, 3060 dB, 3065 dB, 3070 dB, 3075 dB, 3080 dB, 3085 dB, 3090 dB, 3095 dB, 3100 dB, 3105 dB, 3110 dB, 3115 dB, 3120 dB, 3125 dB, 3130 dB, 3135 dB, 3140 dB, 3145 dB, 3150 dB, 3155 dB, 3160 dB, 3165 dB, 3170 dB, 3175 dB, 3180 dB, 3185 dB, 3190 dB, 3195 dB, 3200 dB, 3205 dB, 3210 dB, 3215 dB, 3220 dB, 3225 dB, 3230 dB, 3235 dB, 3240 dB, 3245 dB, 3250 dB, 3255 dB, 3260 dB, 3265 dB, 3270 dB, 3275 dB, 3280 dB, 3285 dB, 3290 dB, 3295 dB, 3300 dB, 3305 dB, 3310 dB, 3315 dB, 3320 dB, 3325 dB, 3330 dB, 3335 dB, 3340 dB, 3345 dB, 3350 dB, 3355 dB, 3360 dB, 3365 dB, 3370 dB, 3375 dB, 3380 dB, 3385 dB, 3390 dB, 3395 dB, 3400 dB, 3405 dB, 3410 dB, 3415 dB, 3420 dB, 3425 dB, 3430 dB, 3435 dB, 3440 dB, 3445 dB, 3450 dB, 3455 dB, 3460 dB, 3465 dB, 3470 dB, 3475 dB, 3480 dB, 3485 dB, 3490 dB, 3495 dB, 3500 dB, 3505 dB, 3510 dB, 3515 dB, 3520 dB, 3525 dB, 3530 dB, 3535 dB, 3540 dB, 3545 dB, 3550 dB, 3555 dB, 3560 dB, 3565 dB, 3570 dB, 3575 dB, 3580 dB, 3585 dB, 3590 dB, 3595 dB, 3600 dB, 3605 dB, 3610 dB, 3615 dB, 3620 dB, 3625 dB, 3630 dB, 3635 dB, 3640 dB, 3645 dB, 3650 dB, 3655 dB, 3660 dB, 3665 dB, 3670 dB, 3675 dB, 3680 dB, 3685 dB, 3690 dB, 3695 dB, 3700 dB, 3705 dB, 3710 dB, 3715 dB, 3720 dB, 3725 dB, 3730 dB, 3735 dB, 3740 dB, 3745 dB, 3750 dB, 3755 dB, 3760 dB, 3765 dB, 3770 dB, 3775 dB, 3780 dB, 3785 dB, 3790 dB, 3795 dB, 3800 dB, 3805 dB, 3810 dB, 3815 dB, 3820 dB, 3825 dB, 3830 dB, 3835 dB, 3840 dB, 3845 dB, 3850 dB, 3855 dB, 3860 dB, 3865 dB, 3870 dB, 3875 dB, 3880 dB, 3885 dB, 3890 dB, 3895 dB, 3900 dB, 3905 dB, 3910 dB, 3915 dB, 3920 dB, 3925 dB, 3930 dB, 3935 dB, 3940 dB, 3945 dB, 3950 dB, 3955 dB, 3960 dB, 3965 dB, 3970 dB, 3975 dB, 3980 dB, 3985 dB, 3990 dB, 3995 dB, 4000 dB, 4005 dB, 4010 dB, 4015 dB, 4020 dB, 4025 dB, 4030 dB, 4035 dB, 4040 dB, 4045 dB, 4050 dB, 4055 dB, 4060 dB, 4065 dB, 4070 dB, 4075 dB, 4080 dB, 4085 dB, 4090 dB, 4095 dB, 4100 dB, 4105 dB, 4110 dB, 4115 dB, 4120 dB, 4125 dB, 4130 dB, 4135 dB, 4140 dB, 4145 dB, 4150 dB, 4155 dB, 4160 dB, 4165 dB, 4170 dB, 4175 dB, 4180 dB, 4185 dB, 4190 dB, 4195 dB, 4200 dB, 4205 dB, 4210 dB, 4215 dB, 4220 dB, 4225 dB, 4230 dB, 4235 dB, 4240 dB, 4245 dB, 4250 dB, 4255 dB, 4260 dB, 4265 dB, 4270 dB, 4275 dB, 4280 dB, 4285 dB, 4290 dB, 4295 dB, 4300 dB, 4305 dB, 4310 dB, 4315 dB, 4320 dB, 4325 dB, 4330 dB, 4335 dB, 4340 dB, 4345 dB, 4350 dB, 4355 dB, 4360 dB, 4365 dB, 4370 dB, 4375 dB, 4380 dB, 4385 dB, 4390 dB, 4395 dB, 4400 dB, 4405 dB, 4410 dB, 4415 dB, 4420 dB, 4425 dB, 4430 dB, 4435 dB, 4440 dB, 4445 dB, 4450 dB, 4455 dB, 4460 dB, 4465 dB, 4470 dB, 4475 dB, 4480 dB, 4485 dB, 4490 dB, 4495 dB, 4500 dB, 4505 dB, 4510 dB, 4515 dB, 4520 dB, 4525 dB, 4530 dB, 4535 dB, 4540 dB, 4545 dB, 4550 dB, 4555 dB, 4560 dB, 4565 dB, 4570 dB, 4575 dB, 4580 dB, 4585 dB, 4590 dB, 4595 dB, 4600 dB, 4605 dB, 4610 dB, 4615 dB, 4620 dB, 4625 dB, 4630 dB, 4635 dB, 4640 dB, 4645 dB, 4650 dB, 4655 dB, 4660 dB, 4665 dB, 4670 dB, 4675 dB, 4680 dB, 4685 dB, 4690 dB, 4695 dB, 4700 dB, 4705 dB, 4710 dB, 4715 dB, 4720 dB, 4725 dB, 4730 dB, 4735 dB, 4740 dB, 4745 dB, 4750 dB, 4755 dB, 4760 dB, 4765 dB, 4770 dB, 4775 dB, 4780 dB, 4785 dB, 4790 dB, 4795 dB, 4800 dB, 4805 dB, 4810 dB, 4815 dB, 4820 dB, 4825 dB, 4830 dB, 4835 dB, 4840 dB, 4845 dB, 4850 dB, 4855 dB, 4860 dB, 4865 dB, 4870 dB, 4875 dB, 4880 dB, 4885 dB, 4890 dB, 4895 dB, 4900 dB, 4905 dB, 4910 dB, 4915 dB, 4920 dB, 4925 dB, 4930 dB, 4935 dB, 4940 dB, 4945 dB, 4950 dB, 4955 dB, 4960 dB, 4965 dB, 4970 dB, 4975 dB, 4980 dB, 4985 dB, 4990 dB, 4995 dB, 5000 dB, 5005 dB, 5010 dB, 5015 dB, 5020 dB, 5025 dB, 5030 dB, 5035 dB, 5040 dB, 5045 dB, 5050 dB, 5055 dB, 5060 dB, 5065 dB, 5070 dB, 5075 dB, 5080 dB, 5085 dB, 5090 dB, 5095 dB, 5100 dB, 5105 dB, 5110 dB, 5115 dB, 5120 dB, 5125 dB, 5130 dB, 5135 dB, 5140 dB, 5145 dB, 5150 dB, 5155 dB, 5160 dB, 5165 dB, 5170 dB, 5175 dB, 5180 dB, 5185 dB, 5190 dB, 5195 dB, 5200 dB, 5205 dB, 5210 dB, 5215 dB, 5220 dB, 5225 dB, 5230 dB, 5235 dB, 5240 dB, 5245 dB, 5250 dB, 5255 dB, 5260 dB, 5265 dB, 5270 dB, 5275 dB, 5280 dB, 5285 dB, 5290 dB, 5295 dB, 5300 dB, 5305 dB, 5310 dB, 5315 dB, 5320 dB, 5325 dB, 5330 dB, 5335 dB, 5340 dB, 5345 dB, 5350 dB, 5355 dB, 5360 dB, 5365 dB, 5370 dB, 5375 dB, 5380 dB, 5385 dB, 5390 dB, 5395 dB, 5400 dB, 5405 dB, 5410 dB, 5415 dB, 5420 dB, 5425 dB, 5430 dB, 5435 dB, 5440 dB, 5445 dB, 5450 dB, 5455 dB, 5460 dB, 5465 dB, 5470 dB, 5475 dB, 5480 dB, 5485 dB, 5490 dB, 5495 dB, 5500 dB, 5505 dB, 5510 dB, 5515 dB, 5520 dB, 5525 dB, 5530 dB, 5535 dB, 5540 dB, 5545 dB, 5550 dB, 5555 dB, 5560 dB, 5565 dB, 5570 dB, 5575 dB, 5580 dB, 5585 dB, 5590 dB, 5595 dB, 5600 dB, 5605 dB, 5610 dB, 5615 dB, 5620 dB, 5625 dB, 5630 dB, 5635 dB, 5640 dB, 5645 dB, 5650 dB, 5655 dB, 5660 dB, 5665 dB, 5670 dB, 5675 dB, 5680 dB, 5685 dB, 5690 dB, 5695 dB, 5700 dB, 5705 dB, 5710 dB, 5715 dB, 5720 dB, 5725 dB, 5730 dB, 5735 dB, 5740 dB, 5745 dB, 5750 dB, 5755 dB, 5760 dB, 5765 dB, 5770 dB, 5775 dB, 5780 dB, 5785 dB, 5790 dB, 5795 dB, 5800 dB, 5805 dB, 5810 dB, 5815 dB, 5820 dB, 5825 dB, 5830 dB, 5835 dB, 5840 dB, 5845 dB, 5850 dB, 5855 dB, 5860 dB, 5865 dB, 5870 dB, 5875 dB, 5880 dB, 5885 dB, 5890 dB, 5895 dB, 5900 dB, 5905 dB, 5910 dB, 5915 dB, 5920 dB, 5925 dB, 5930 dB, 5935 dB, 5940 dB, 5945 dB, 5950 dB, 5955 dB, 5960 dB, 5965 dB, 5970 dB, 5975 dB, 5980 dB, 5985 dB, 5990 dB, 5995 dB, 6000 dB, 6005 dB, 6010 dB, 6015 dB, 6020 dB, 6025 dB, 6030 dB, 6035 dB, 6040 dB, 6045 dB, 6050 dB, 6055 dB, 6060 dB, 6065 dB, 6070 dB, 6075 dB, 6080 dB, 6085 dB, 6090 dB, 6095 dB, 6100 dB, 6105 dB, 6110 dB, 6115 dB, 6120 dB, 6125 dB, 6130 dB, 6135 dB, 6140 dB, 6145 dB, 6150 dB, 6155 dB, 6160 dB, 6165 dB, 6170 dB, 6175 dB, 6180 dB, 6185 dB, 6190 dB, 6195 dB, 6200 dB, 6205 dB, 6210 dB, 6215 dB, 6220 dB, 6225 dB, 6230 dB, 6235 dB, 6240 dB, 6245 dB, 6250 dB, 6255 dB, 6260 dB, 6265 dB, 6270 dB, 6275 dB, 6280 dB, 6285 dB, 6290 dB, 6295 dB, 6300 dB, 6305 dB, 6310 dB, 6315 dB, 6320 dB, 6325 dB, 6330 dB, 6335 dB, 6340 dB, 6345 dB, 6350 dB, 6355 dB, 6360 dB, 6365 dB, 6370 dB, 6375 dB, 6380 dB, 6385 dB, 6390 dB, 6395 dB, 6400 dB, 6405 dB, 6410 dB, 6415 dB, 6420 dB, 6425 dB, 6430 dB, 6435 dB, 6440 dB, 6445 dB, 6450 dB, 6455 dB, 6460 dB, 6465 dB, 6470 dB, 6475 dB, 6480 dB, 6485 dB, 6490 dB, 6495 dB, 6500 dB, 6505 dB, 6510 dB, 6515 dB, 6520 dB, 6525 dB, 6530 dB, 6535 dB, 6540 dB, 6545 dB, 6550 dB, 6555 dB, 6560 dB, 6565 dB, 6570 dB, 6575 dB, 6580 dB, 6585 dB, 6590 dB, 6595 dB, 6600 dB, 6605 dB, 6610 dB, 6615 dB, 6620 dB, 6625 dB, 6630 dB, 6635 dB, 6640 dB, 6645 dB, 6650 dB, 6655 dB, 6660 dB, 6665 dB, 6670 dB, 6675 dB, 6680 dB, 6685 dB, 6690 dB, 6695 dB, 6700 dB, 6705 dB, 6710 dB, 6715 dB, 6720 dB, 6725 dB, 6730 dB, 6735 dB, 6740 dB, 6745 dB, 6750 dB, 6755 dB, 6760 dB, 6765 dB, 6770 dB, 6775 dB, 6780 dB, 6785 dB, 6790 dB, 6795 dB, 6800 dB, 6805 dB, 6810 dB, 6815 dB, 6820 dB, 6825 dB, 6830 dB, 6835 dB, 6840 dB, 6845 dB, 6850 dB, 6855 dB, 6860 dB, 6865 dB, 6870 dB, 6875 dB, 6880 dB, 6885 dB, 6890 dB, 6895 dB, 6900 dB, 6905 dB, 6910 dB, 6915 dB, 6920 dB, 6925 dB, 6930 dB, 6935 dB, 6940 dB, 6945 dB, 6950 dB, 6955 dB, 6960 dB, 6965 dB, 6970 dB, 6975 dB, 6980 dB, 6985 dB, 6990 dB, 6995 dB, 7000 dB, 7005 dB, 7010 dB, 7015 dB, 7020 dB, 7025 dB, 7030 dB, 7035 dB, 7040 dB, 7045 dB, 7050 dB, 7055 dB, 7060 dB, 7065 dB, 7070 dB, 7075 dB, 7080 dB, 7085 dB, 7090 dB, 7095 dB, 7100 dB, 7105 dB, 7110 dB, 7115 dB, 7120 dB, 7125 dB, 7130 dB, 7135 dB, 7140 dB, 7145 dB, 7150 dB, 7155 dB, 7160 dB, 7165 dB, 7170 dB, 7175 dB, 7180 dB, 7185 dB, 7190 dB, 7195 dB, 7200 dB, 7205 dB, 7210 dB, 7215 dB, 7220 dB, 7225 dB, 7230 dB, 7235 dB, 7240 dB, 7245 dB, 7250 dB, 7255 dB, 7260 dB, 7265 dB, 7270 dB, 7275 dB, 7280 dB, 7285 dB, 7290 dB, 7295 dB, 7300 dB, 7305 dB, 7310 dB, 7315 dB, 7320 dB, 7325 dB, 7330 dB, 7335 dB, 7340 dB, 7345 dB, 7350 dB, 7355 dB, 7360 dB, 7365 dB, 7370 dB, 7375 dB, 7380 dB, 7385 dB, 7390 dB, 7395 dB, 7400 dB, 7405 dB, 7410 dB, 7415 dB, 7420 dB, 7425 dB, 7430 dB, 7435 dB, 7440 dB, 7445 dB, 7450 dB, 7455 dB, 7460 dB, 7465 dB, 7470 dB, 7475 dB, 7480 dB, 7485 dB, 7490 dB, 7495 dB, 7500 dB, 7505 dB, 7510 dB, 7515 dB, 7520 dB, 7525 dB, 7530 dB, 7535 dB, 7540 dB, 7545 dB, 7550 dB, 7555 dB, 7560 dB, 7565 dB, 7570 dB, 7575 dB, 7580 dB, 7585 dB, 7590 dB, 7595 dB, 7600 dB, 7605 dB, 7610 dB, 7615 dB, 7620 dB, 7625 dB, 7630 dB, 7635 dB, 7640 dB, 7645 dB, 7650 dB, 7655 dB, 7660 dB, 7665 dB, 7670 dB, 7675 dB, 7680 dB, 7685 dB, 7690 dB, 7695 dB, 7







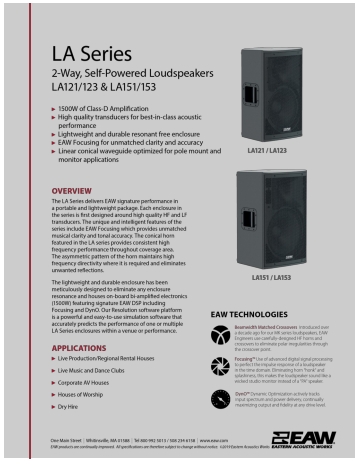

## [pdf] Dimension Guide Guide

LA Series 16 ore fa — 100 120V or 200 240V 50 60Hz PHYSICAL LA121 LA123 LA151 LA153 Material

Acoustically Enhanced Polypropylene Dimensions H x W D 25 2 x 15 14 4in Spec Sheet 230816 eaw

2023 10 4 days ago |||

LA Series 2-Way, Self-Powered Loudspeakers LA121/123 LA151/153 1500W of

Class-D Amplification Hi ... A153 20000 20000 20000 20000 ACCESSORIES

DESCRIPTION Transport Cover M20 Positive Thread Pole **RS121**/123 RS151/153

2070538 2070539 2047634 Tel 800 992 5013 / 1 508 234 6158 www.eaw.com 3 ...

lang:en **score:21** filesize: 2.54 M page\_count: 4 document date: 2023-08-16

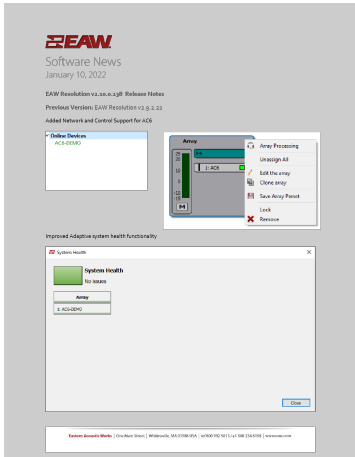

## [pdf] Release Notes

John Holden EAW Resolution v2 10 138 Releasev1eaw 2022 03 2 Release Notes |||

EAW Resolution v2.10.0.138 Release Notes Previous Version: EAW Resolution

v2.9.2.22 Added Network an ... nd communications. Additional support for: MKD864

MKD986 MKD826 MKD1064 MKD1096 MKD1026 SB825 SB828 **RS121** RS151

RS115 RS123 RS153 RS118HP EAW Resolution v2.7.0.8 Release Notes Previous

Version: EAW Re...

lang:en **score:19** filesize: 3.75 M page\_count: 51 document date: 2022-03-09

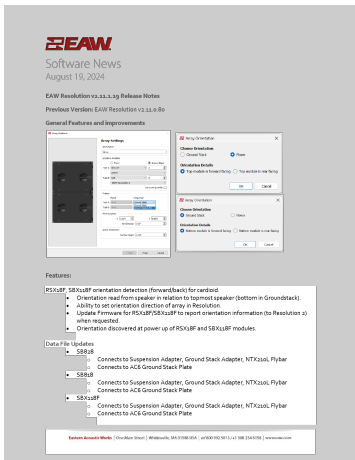

## [pdf] Release Notes

John Holden EAW Resolution v2 11 1 19 Release Notes Previous Version Aug 2024 — Data File

Updates SB828 o Connects to Suspension Adapter Ground Stack NTX210L Flybar AC6 Plate 2 eaw 08 |||

EAW Resolution v2.11.1.19 Release Notes Previous Version: EAW Resolution

v2.11.0.80 General Features ... nd communications. Additional support for: MKD864

MKD986 MKD826 MKD1064 MKD1096 MKD1026 SB825 SB828 **RS121** RS151

RS115 RS123 RS153 RS118HP EAW Resolution v2.7.0.8 Release Notes Previous

Version: EAW Re...

lang:en **score:19** filesize: 4.41 M page\_count: 58 document date: 2024-08-19

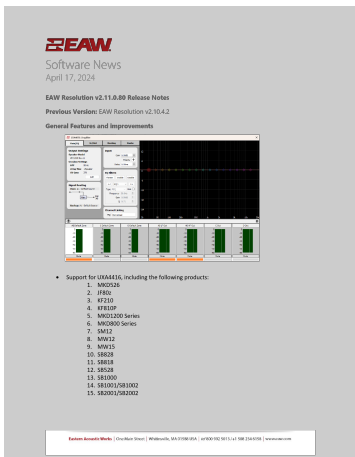

## [pdf] Release Notes

John Holden EAW Resolution v2 11 0 80 Release Notes Previous Version 17 apr 2024 — One 10 modula

Anna array aimed down a typical venue In this next figure the coverage is set to Narrow Immediate user

action recommended Once 2 eaw 04 |||

EAW Resolution v2.11.0.80 Release Notes Previous Version: EAW Resolution

v2.10.4.2 General Features ... nd communications. Additional support for: MKD864

MKD986 MKD826 MKD1064 MKD1096 MKD1026 SB825 SB828 **RS121** RS151

RS115 RS123 RS153 RS118HP EAW Resolution v2.7.0.8 Release Notes Previous

Version: EAW Re...

lang:en **score:18** filesize: 4.18 M page\_count: 62 document date: 2024-04-17



