



[Manuals.plus](#) /

› [EGO Power+](#) /

› EGO Power+ MHC1502 Multi Combo Kit User Manual

## EGO Power+ MHC1502

# EGO Power+ MHC1502 Multi Combo Kit User Manual

Model: MHC1502

## INTRODUCTION

---

This manual provides essential instructions for the safe and effective use of your EGO Power+ MHC1502 Multi Combo Kit. This comprehensive kit includes a Power Head, a 15-inch String Trimmer Attachment, an 8-inch Edger Attachment, a 5.0Ah battery, and a standard charger. Designed for various lawn care tasks, this system offers versatility and performance for trimming and edging needs.

The EGO Power+ Multi Combo Kit is built with a high-efficiency brushless motor for extended runtimes and reduced vibration, ensuring a durable and reliable tool. Its IPX4-rated weather-resistant construction provides protection against various environmental conditions.



Figure 1: EGO Power+ MHC1502 Multi Combo Kit, showcasing the Power Head, String Trimmer, and Edger attachments.

## SAFETY INFORMATION

---

**WARNING:** Always use safety gear, including eye protection and gloves, when operating this equipment. Keep bystanders at a safe distance to avoid injury from flying debris. Always use the lock-off switch to prevent accidental operation. Read and understand all safety warnings and instructions before operating the product.

## COMPONENTS OVERVIEW

---

The EGO Power+ MHC1502 Multi Combo Kit includes the following main components:

- **Power Head (PH1400):** The core unit that powers all attachments.
- **15-inch String Trimmer Attachment (STA1500):** For cutting grass and weeds.
- **8-inch Edger Attachment (EA0800):** For creating clean edges along sidewalks and driveways.
- **56V 5.0Ah ARC Lithium Battery:** Provides power to the unit.

- **Standard Charger:** For recharging the battery.



Figure 2: The EGO Power+ Power Head, the central unit for all attachments.



Figure 3: The 15-inch String Trimmer Attachment, featuring a Rapid Reload head.



Figure 4: The 8-inch Edger Attachment, equipped with a guide wheel.

## SETUP AND ASSEMBLY

---

### 1. Charging the Battery

Before initial use, fully charge the 56V 5.0Ah ARC Lithium battery using the provided standard charger. Refer to the charger's specific instructions for charging times and indicators.

### 2. Attaching Components

The EGO Power+ Multi-Head System is designed for easy attachment changes. To connect an attachment to the Power Head:

1. Align the shaft of the desired attachment (String Trimmer or Edger) with the coupling on the Power Head.
2. Push the attachment shaft into the Power Head coupling until it clicks into place.
3. Ensure the attachment is securely locked before operation. To remove, press the release button and pull the attachment away.

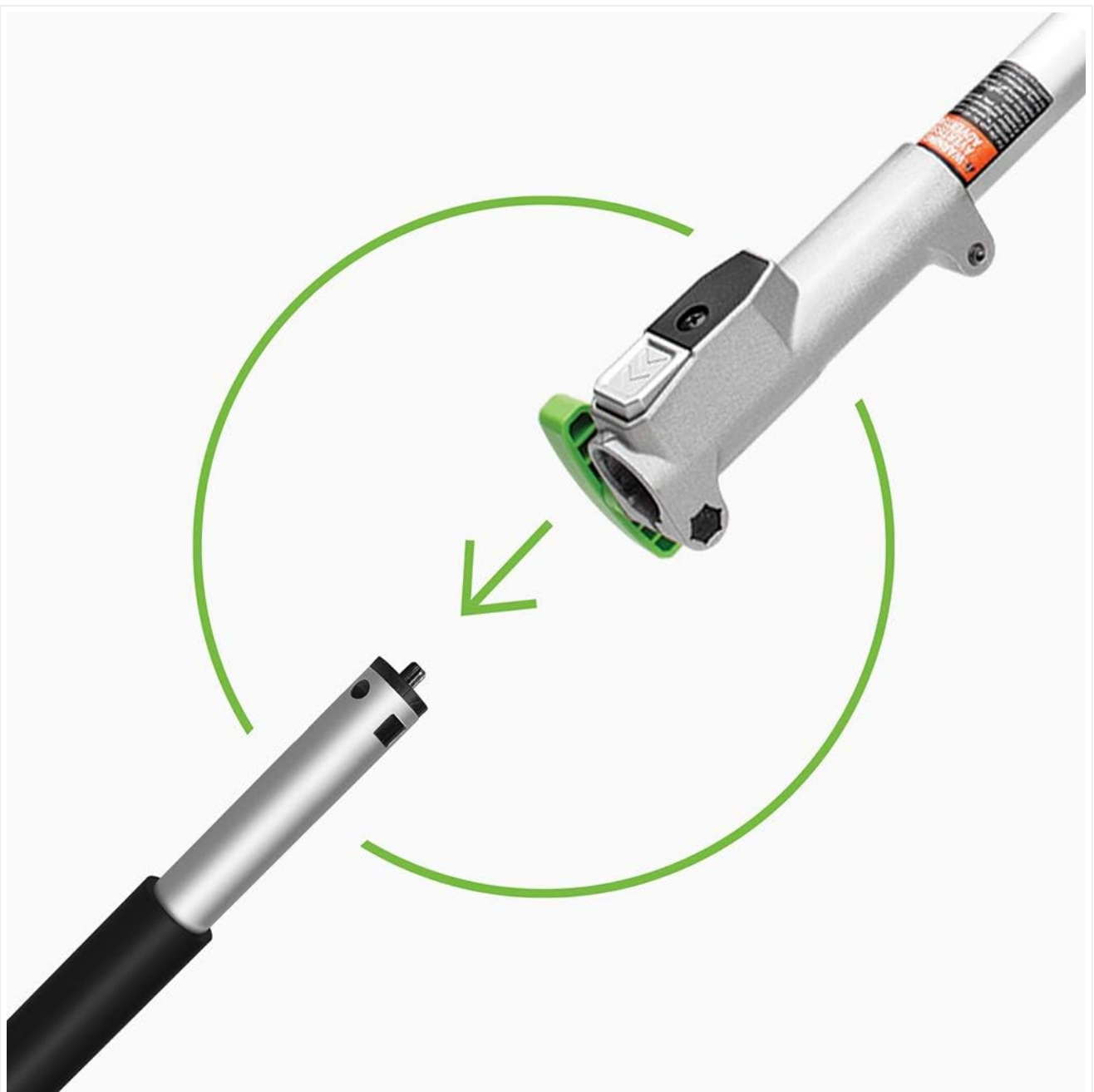

Figure 5: Illustration of connecting an attachment to the Power Head, highlighting the secure locking mechanism.

### 3. Installing the Battery

Slide the charged battery into the battery port on the Power Head until it locks securely. Ensure it is fully seated before starting the tool.

## OPERATION

---

### Power Head Controls

The Power Head features a variable speed trigger for precise control and a hi-low speed selector to adjust power output based on the task. A lock-off switch is integrated for safety, preventing accidental starts.



# 2 SPEED TRIGGER

Figure 6: Detail of the Power Head's 2-speed trigger, offering variable speed control.



Figure 7: The high-efficiency brushless motor, designed for long runtimes and low vibration.

### **String Trimmer Operation (STA1500)**

The 15-inch String Trimmer Attachment is equipped with a Rapid Reload head and professional-grade .095-inch dual-twist line. To operate, hold the trimmer firmly with both hands, maintaining a comfortable and balanced stance. Use a sweeping motion to cut grass and weeds.



# DUAL TWIST LINE

Figure 8: The dual-twist line provides efficient cutting performance.

## Edger Operation (EA0800)

The 8-inch Edger Attachment features an 8-inch edger blade and a guide wheel with a depth adjustment knob. To achieve a clean edge, position the guide wheel along the edge of your sidewalk or driveway. Adjust the depth knob to your desired cutting depth, up to 3 inches. Maintain a steady pace, allowing the blade to cut through the soil and grass.



Figure 9: The edger attachment is capable of a maximum 3-inch cutting depth.

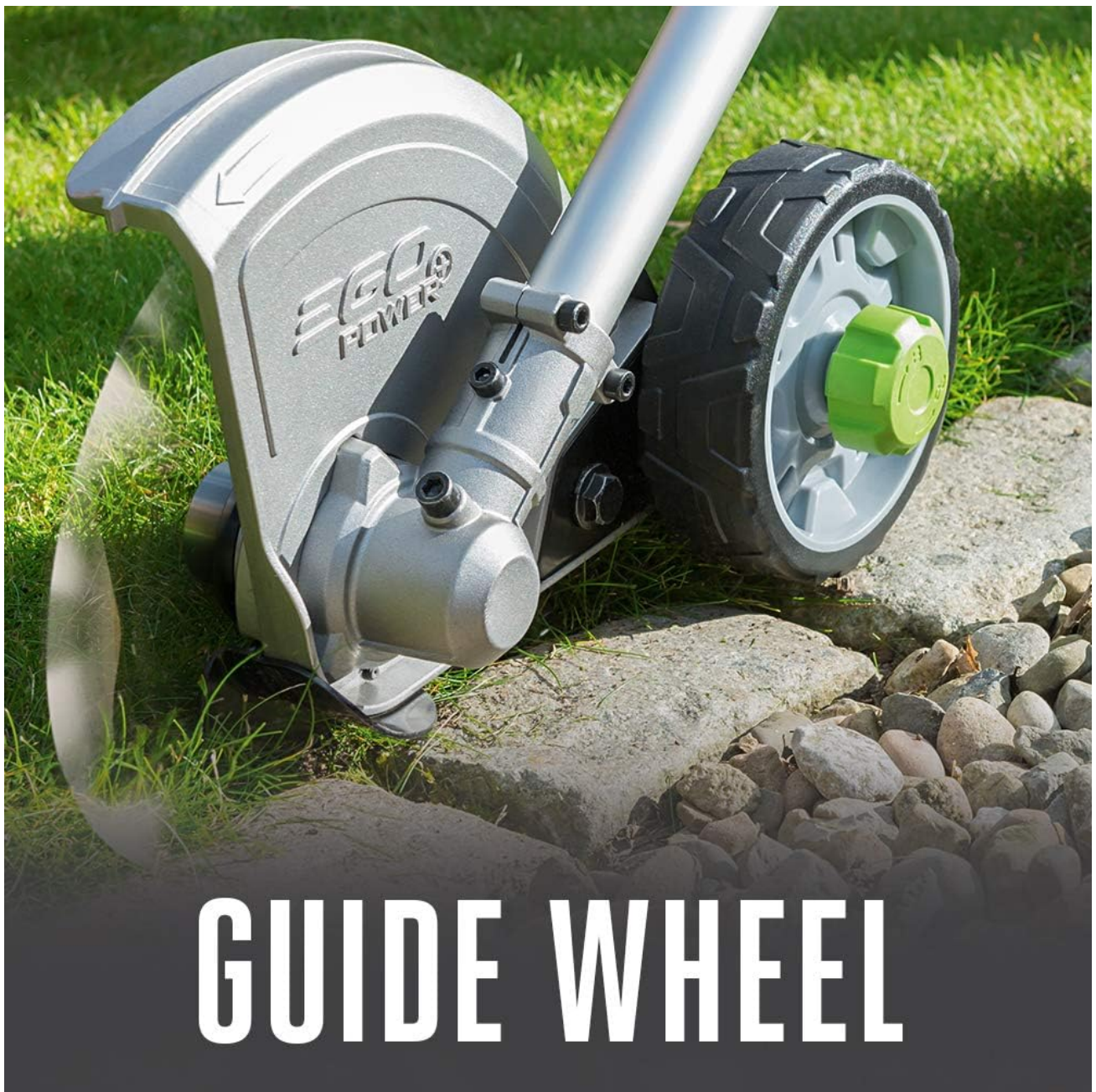

# GUIDE WHEEL

Figure 10: The guide wheel assists in maintaining a straight and consistent edge.

## MAINTENANCE

---

### General Cleaning

After each use, disconnect the battery and clean the tool. Remove any grass, dirt, or debris from the Power Head, trimmer head, and edger blade using a dry cloth or soft brush. Do not use water or cleaning solutions directly on electrical components.

### String Trimmer Line Replacement

The Rapid Reload head allows for quick and easy line replacement:

1. Ensure the tool is off and the battery is removed.
2. Align the arrows on the trimmer head with the eyelets.
3. Insert new trimmer line through the eyelets until an equal length protrudes from both sides.
4. Twist the trimmer head knob to wind the line into the spool.

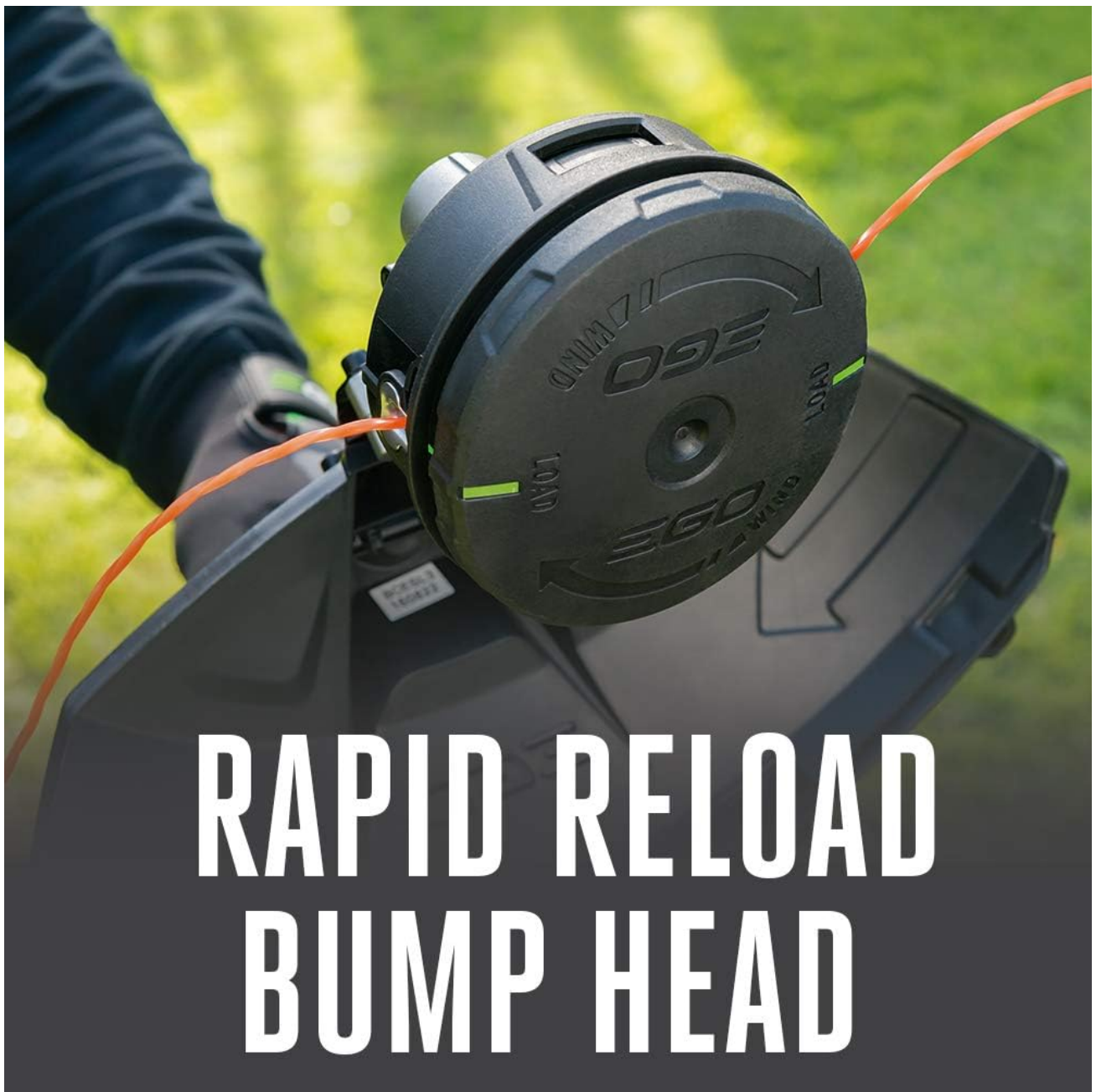

# RAPID RELOAD BUMP HEAD

Figure 11: The Rapid Reload Bump Head simplifies string trimmer line replacement.

## Edger Blade Inspection

Regularly inspect the edger blade for wear, damage, or dullness. A dull or damaged blade can reduce cutting performance and increase strain on the motor. Replace the blade as needed, following the instructions in the full user manual.

## Battery Care

Store the battery in a cool, dry place away from direct sunlight and extreme temperatures. Do not store the battery in a discharged state for extended periods. Always charge the battery before storing for long durations.

## TROUBLESHOOTING

---

If you encounter issues with your EGO Power+ Multi Combo Kit, consider the following common troubleshooting steps:

- **Tool Not Starting:** Ensure the battery is fully charged and properly seated in the Power Head. Check that the lock-off switch is disengaged before pressing the trigger.
- **Reduced Performance:** Inspect the trimmer line for wear or breakage, and replace if necessary. For the edger,

check the blade for dullness or damage. Ensure the tool is not being overloaded by attempting to cut excessively thick material.

- **Excessive Vibration:** Check that all attachments are securely fastened. Inspect the trimmer head or edger blade for any damage or imbalance.

For more detailed troubleshooting or persistent issues, refer to the comprehensive user guide available from EGO Power+ or contact customer support.

## SPECIFICATIONS

Feature	Specification
Brand	EGO Power+
Model Number	MHC1502
Power Source	Battery Powered (56V ARC Lithium)
Item Weight	25.6 pounds (approximate, with battery and attachment)
String Trimmer Cutting Width	15 Inches
String Trimmer Line Type	.095-inch professional grade dual-twist line
Edger Blade Diameter	8 Inches
Edger Max Cutting Depth	3 Inches
Product Dimensions	59.65"L x 11.22"W (approximate, assembled)
Battery Included	1 Lithium Ion (5.0Ah)
Weather Resistance	IPX4-rated
Motor Type	High-efficiency brushless motor
UPC	692042005190

## WARRANTY INFORMATION

The EGO Power+ MHC1502 Multi Combo Kit comes with a comprehensive warranty to ensure your satisfaction and product longevity:

- **Tool Warranty:** 5 years
- **Battery Warranty:** 3 years

Please retain your proof of purchase for warranty claims. For full terms and conditions, refer to the official EGO Power+ warranty documentation or visit their website.



Figure 12: EGO Power+ warranty badges indicating 5-year tool and 3-year battery coverage.

## CUSTOMER SUPPORT

---

For further assistance, technical support, or to inquire about replacement parts, please contact EGO Power+ customer service. Refer to the contact information provided in the packaging or on the official EGO Power+ website.