

Manuals.plus /

- › Bosch /
- › Bosch Dishwasher Machine Care User Manual

Bosch 311993

Bosch Dishwasher Machine Care User Manual

Model: 311993

1. INTRODUCTION

The Bosch Dishwasher Machine Care product is specifically formulated to maintain the cleanliness and efficiency of your dishwasher. Regular use helps to remove grease and limescale deposits that can accumulate over time, ensuring flawless washing results and extending the service life of your appliance. This manual provides detailed instructions for the proper and safe use of this product.

2. SAFETY INFORMATION

Always observe the following safety precautions when handling cleaning products:

- Keep out of reach of children.
- Avoid contact with eyes and skin. In case of contact, rinse immediately with plenty of water.
- Do not ingest. If swallowed, seek medical advice immediately and show this container or label.
- Wear protective gloves during handling, especially when applying manually.
- Ensure adequate ventilation during use.

3. PRODUCT OVERVIEW





Image: Front view of the Bosch Dishwasher Machine Care bottle, showing the label with 'Dishwasher care' and 'Made in





Image: Angled view of the Bosch Dishwasher Machine Care bottle, highlighting the cap and the product's design.

4. PREPARATION FOR USE

1. **Empty Dishwasher:** Ensure your dishwasher is completely empty of dishes, cutlery, and any other items before starting the cleaning process.

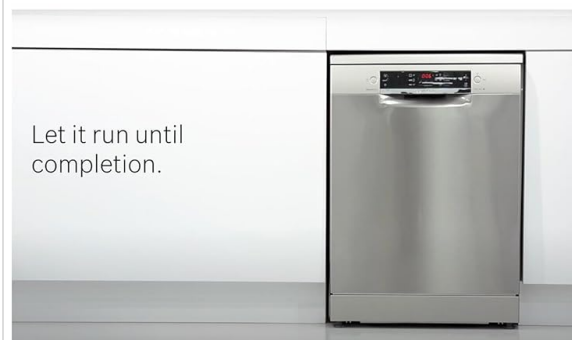
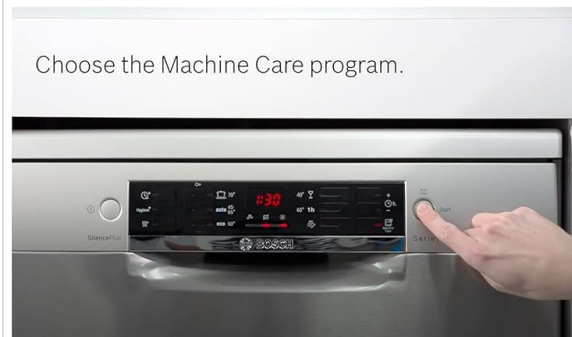
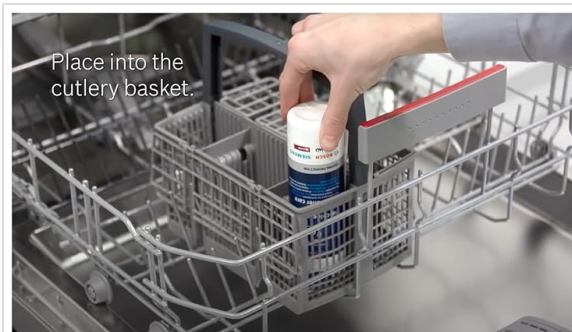

Image: A clean, empty dishwasher with racks pulled out, ready for maintenance.

2. **Unscrew Cap:** Unscrew the cap from the Bosch Dishwasher Machine Care bottle.

How to Clean the Dishwasher Regularly? (Cleaning and Care Advice)

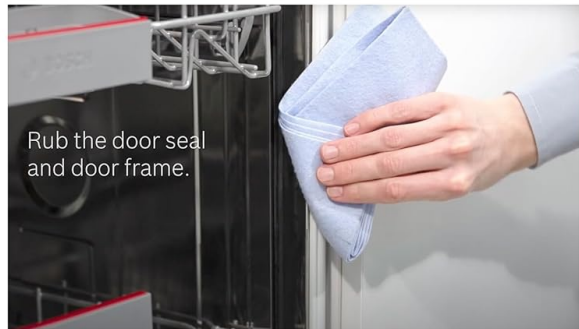

Image: A gloved hand unscrewing the cap from the product bottle.

- 3. Remove Protective Film:** Locate and remove the special metal protective film from the top of the bottle's opening.



Image: A gloved hand peeling off the protective film from the bottle's opening.

- 4. Wear Protective Gloves:** It is recommended to wear protective gloves during the entire process, especially if you will be handling the liquid directly or cleaning surfaces manually.

How to Clean the Dishwasher Regularly? (Cleaning and Care Advice)

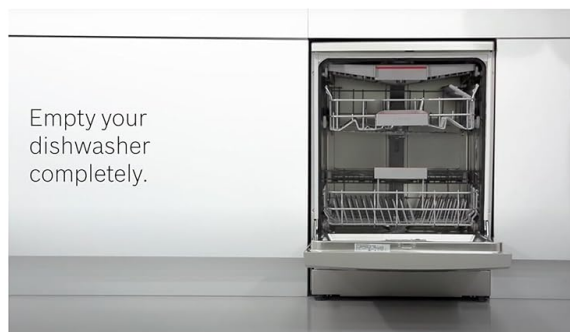
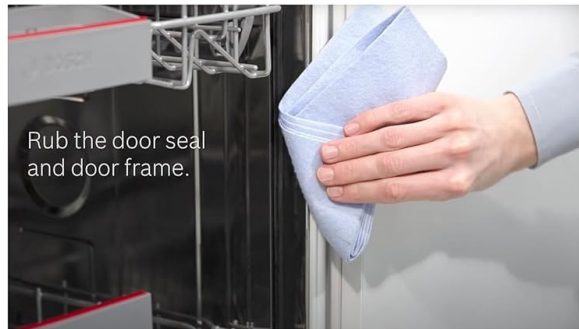

Image: A person wearing white protective gloves, indicating the recommendation for safe handling.

5. USAGE INSTRUCTIONS

5.1. Method 1: Intensive Cleaning Cycle (for internal cleaning)

This method is for a thorough cleaning of the dishwasher's interior, removing grease and limescale from internal components.

1. **Position the Bottle:** Place the bottle upside down in the cutlery basket or attach it securely to the spikes in the lower rack, ensuring the opening faces downwards and the liquid can drain during the cycle.



Image: Two panels showing the bottle placed upside down in a dishwasher's cutlery basket and attached to the spikes of a lower rack.

- 2. Select Program:** Close the dishwasher door. Choose the 'Machine Care' program if your dishwasher has one. If not, select a program with a temperature of at least 65°C (149°F) for optimal cleaning results.



Image: Two panels showing a hand selecting the 'Machine Care' program on a dishwasher control panel, and another hand selecting a program with a temperature setting of 65°C.

- 3. Run Cycle:** Start the selected program and allow it to run until completion. The product will be dispensed and circulated throughout the dishwasher during the cycle.



Image: A modern dishwasher with its door closed, indicating that a cleaning cycle is in progress.

5.2. Method 2: Manual Cleaning of Door Seal (for specific areas)

This method is suitable for cleaning the door seal and door frame, which can accumulate grime and residue.

1. **Apply to Cloth:** Pour a small amount of the Bosch Dishwasher Machine Care liquid onto a clean cloth.

How to Clean the Dishwasher Regularly? (Cleaning and Care Advice)

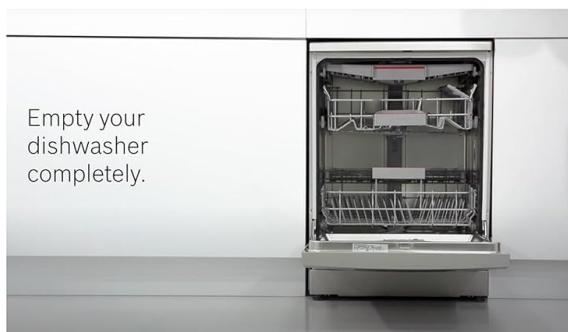
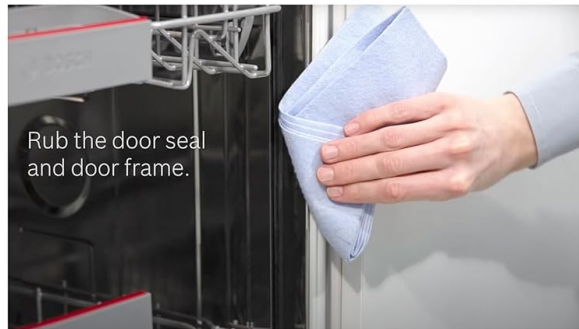

Image: A gloved hand pouring a small amount of the cleaning liquid onto a blue cloth.

- 2. Rub Surfaces:** Gently rub the door seal and the surrounding door frame with the moistened cloth. This will help remove any visible grease or limescale buildup in these areas.

How to Clean the Dishwasher Regularly? (Cleaning and Care Advice)

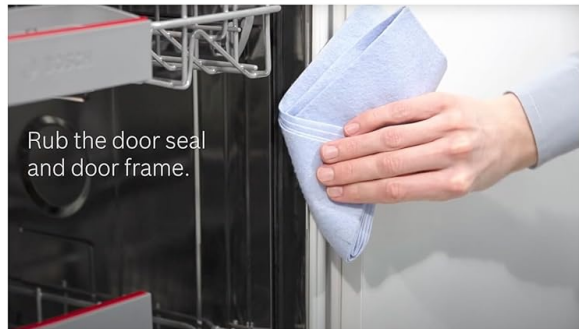
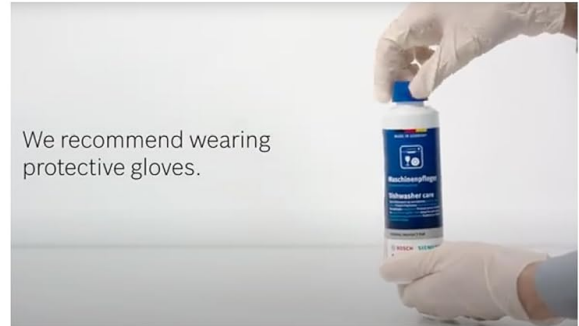

Image: A gloved hand using a blue cloth to wipe and clean the rubber door seal and frame of a dishwasher.

6. RECOMMENDED USAGE FREQUENCY

For optimal performance and to ensure the longevity of your dishwasher, it is recommended to use Bosch Dishwasher Machine Care every 1 to 2 months. Regular application prevents heavy buildup and maintains cleaning efficiency.



Image: The Bosch Dishwasher Machine Care bottle positioned next to a dishwasher, with text indicating a recommended usage frequency of every 1 or 2 months.

7. SPECIFICATIONS

Feature	Detail
Brand	Bosch
Model Number	311993
Item Form	Liquid
Scent	Lime
Material Feature	Residue Free
Item Volume	250 Milliliters
Product Dimensions	1.57 x 7.87 x 1.57 inches
Item Weight	9.88 ounces
Manufacturer	BOSCH SIEMENS

8. TROUBLESHOOTING

If you encounter issues after using the product, consider the following:

- **Residue Remaining:** Ensure the dishwasher was completely empty before running the cycle. Verify that the bottle was placed correctly to allow full drainage. Consider running a second cycle if buildup was severe.
- **Odor Persists:** Ensure the door seal and filter are clean. Regular manual cleaning of these areas in addition to the machine care cycle can help.
- **Product Not Dispensed:** Check if the protective film was fully removed from the bottle's opening. Ensure the bottle was placed upside down.

For persistent issues, consult your dishwasher's user manual or contact Bosch customer support.

9. WARRANTY AND SUPPORT

For information regarding product warranty or technical support, please refer to the official Bosch website or contact Bosch customer service directly. Keep your purchase receipt as proof of purchase.

For further assistance, visit the official Bosch website: www.bosch-home.com/us/