



[Manuals.plus](#) /

> [Dripex](#) /

> Dripex Folding Desk User Manual

Dripex B085DL958C

Dripex Folding Desk User Manual

Model: B085DL958C

PRODUCT OVERVIEW

The Dripex Folding Desk is designed for versatility and space-saving convenience. It features a robust construction with high-quality materials, making it suitable for various uses in home and office environments.



Image: The Dripex Folding Desk shown in its fully unfolded state on the left, and its compact, folded state on the right, highlighting its space-saving design.

Key Features:

- **High-Quality Materials:** Constructed with waterproof and scratch-resistant MDF panels for the desktop, and a stable, robust metallic steel frame.
- **Compact Design:** Unfolded dimensions of 80 x 45 x 74 cm (L x W x H) and a folded dimension of 80 x 8 x 74 cm, weighing 7.5 kg, designed for efficient space utilization.
- **Versatile Use:** Ideal for use as a computer desk, study desk, workstation, or gaming table in various settings such as offices, living rooms, and bedrooms.
- **Easy to Use:** Pre-installed and requires no assembly. It can be opened and folded in seconds, perfect for quick setup and storage.
- **Anti-Skid Protection:** Equipped with anti-skid and anti-scratch pads under the feet to protect your floor from damage and reduce noise during movement.

SETUP INSTRUCTIONS

The Dripex Folding Desk is designed for immediate use with no assembly required. Follow these simple steps to unfold and set up your desk.

NO ASSEMBLY REQUIRED

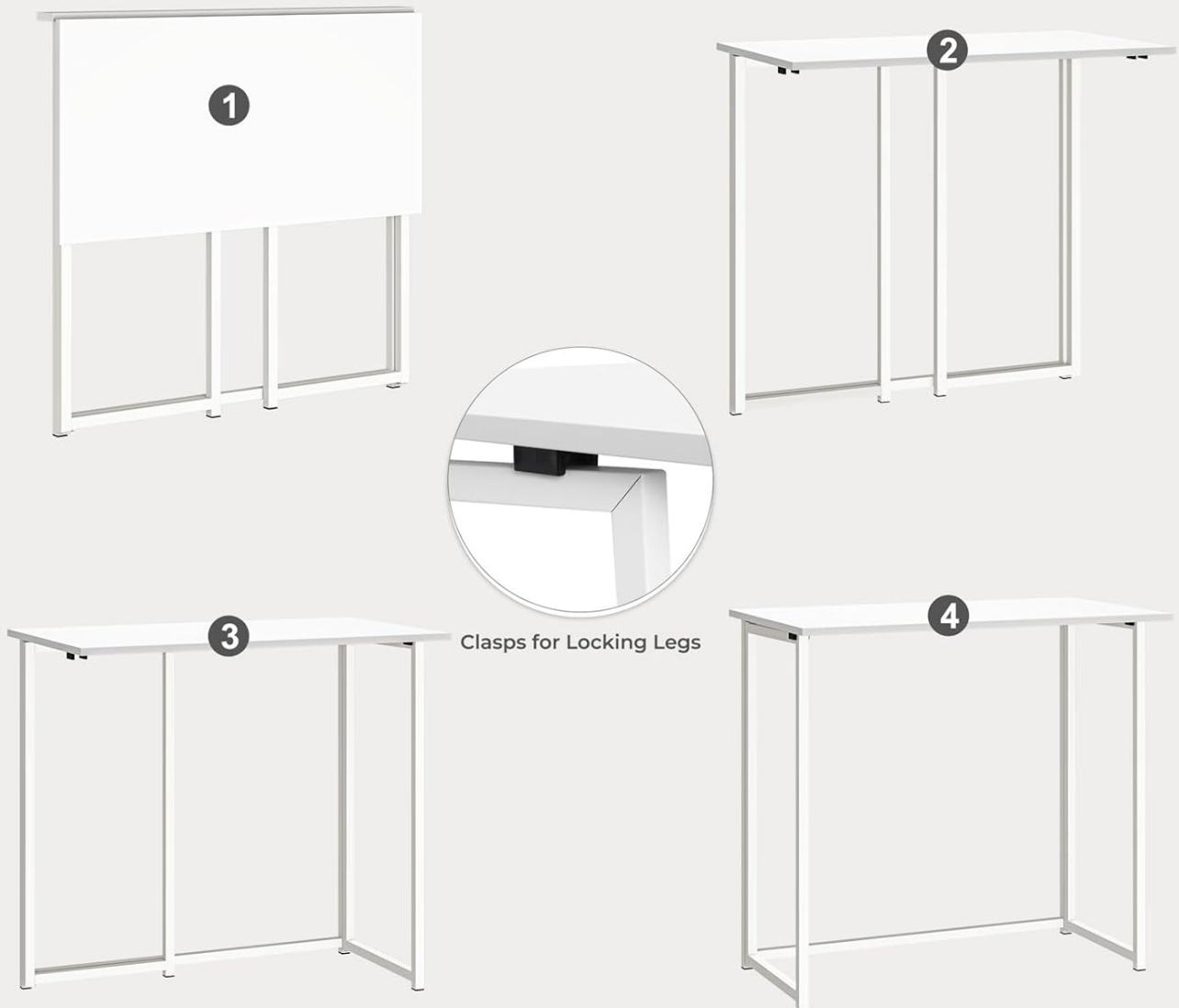

Image: A visual guide demonstrating the four simple steps to unfold the desk from its compact, folded state to a fully functional workstation. This includes a close-up of the leg locking mechanism.

1. **Step 1: Unpack the Desk.** Carefully remove the desk from its packaging. The desk will be in its folded position.
2. **Step 2: Partially Unfold the Legs.** Gently pull the two sets of legs outwards from the main desktop. They will begin to pivot.
3. **Step 3: Extend the Legs.** Continue to extend each set of legs until they are fully upright and perpendicular to the desktop.
4. **Step 4: Lock the Legs.** Ensure the locking clasps (located near the top of each leg frame, where it meets the desktop) engage securely. You may hear a click. Verify that all four legs are stable and locked into place before use.

To fold the desk for storage, reverse these steps, disengaging the locking clasps first.

OPERATING INSTRUCTIONS

Once unfolded and securely locked, the Dripex Folding Desk is ready for immediate use. Its stable design supports various activities.



Image: The Dripex Folding Desk set up in a home office, demonstrating its use with a laptop, mouse, and a desk chair, showcasing its functional size.

Usage Guidelines:

- **Placement:** Position the desk on a flat, stable surface to ensure maximum stability. The anti-skid pads will help prevent movement and protect your flooring.
- **Weight Capacity:** The desk has a maximum weight capacity of 15 kg (approximately 33 lbs). Do not exceed this limit to prevent damage or instability.
- **Versatility:** Use the desk for computing, writing, crafting, or as a temporary surface for various tasks. Its compact size makes it ideal for small spaces.

Product Size



Max Weight Capacity

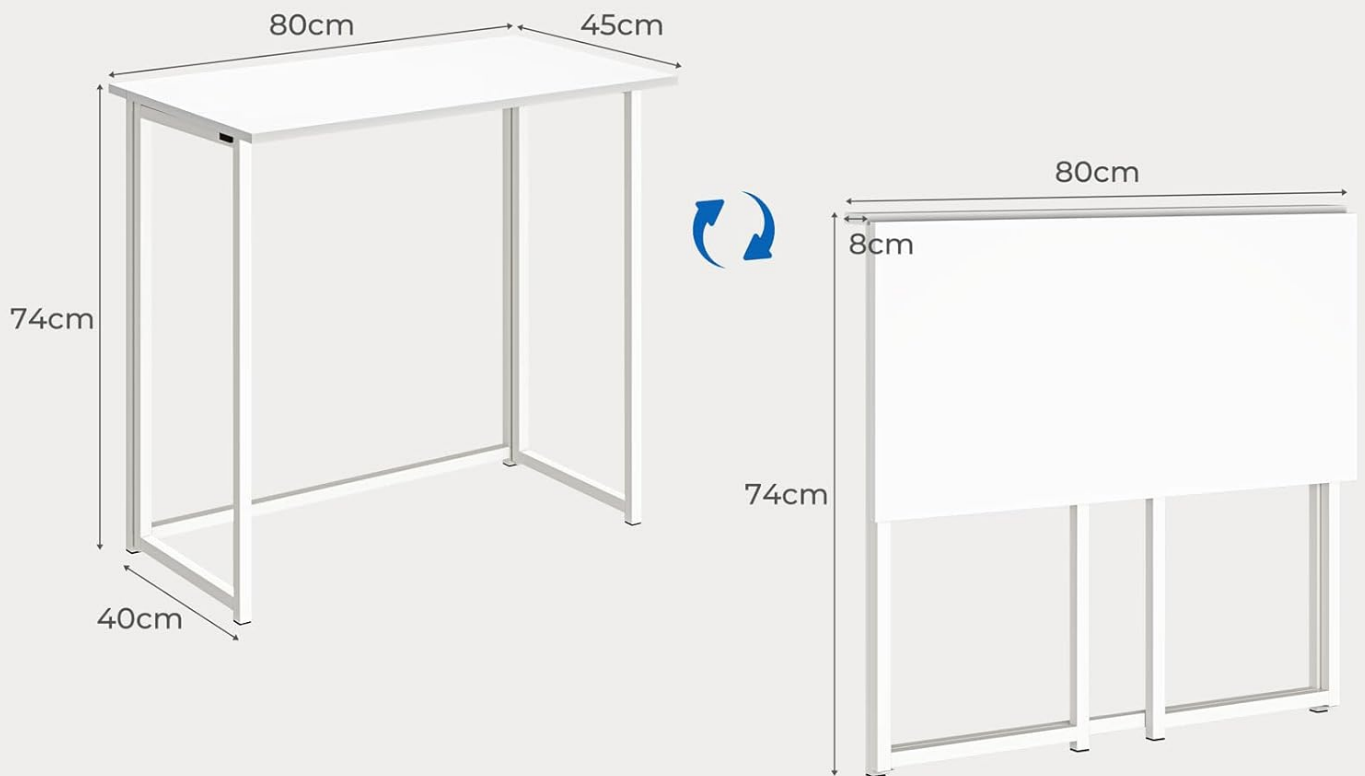

Image: A diagram illustrating the precise dimensions of the unfolded desk (80cm L x 45cm W x 74cm H) and its folded dimensions (80cm L x 8cm W x 74cm H), along with a clear indication of its 15kg maximum weight capacity.

Folding for Storage:

To fold the desk for compact storage, simply reverse the setup process:

1. Clear the desktop of all items.
2. Locate the locking clasps on the underside of the desktop where the legs connect.
3. Disengage the clasps to unlock the legs.
4. Gently push the legs inwards until they fold flat against the desktop.
5. The desk can then be stored upright against a wall, under a bed, or in a closet.

SPACE-SAVING & EASILY STORED



Image: A collage demonstrating various space-saving storage options for the folded desk, including under a bed, behind a door, and upright against a wall or inside a closet, highlighting its compact profile.

MAINTENANCE AND CARE

Proper care will ensure the longevity and appearance of your Dripex Folding Desk.

Cleaning:

- **Desktop:** The MDF desktop is waterproof and scratch-resistant. Wipe clean with a soft, damp cloth. For stubborn marks, a mild, non-abrasive cleaner can be used. Dry immediately with a clean cloth.
- **Frame:** The metallic steel frame can be wiped clean with a damp cloth. Avoid harsh chemicals that may damage the finish.
- **Avoid:** Do not use abrasive cleaners, scouring pads, or solvents, as these can damage the surface finishes.

General Care:

- Regularly check that the leg locking mechanisms are functioning correctly and securely engaged when the desk is in use.

- Ensure the anti-skid pads on the feet are intact to protect your floor and maintain stability.
- Avoid placing extremely hot or cold items directly on the desktop without protective coasters.
- Do not drag the desk across floors; lift it when moving to prevent damage to the desk or floor.

TROUBLESHOOTING

If you encounter any issues with your Dripex Folding Desk, refer to the following common problems and solutions.

Problem	Possible Cause	Solution
Desk feels wobbly or unstable.	Legs not fully extended or locked. Uneven floor surface.	Ensure all legs are fully extended and the locking clasps are securely engaged. Move the desk to a flat, even surface.
Difficulty folding or unfolding the desk.	Locking clasps are stuck or not disengaged.	Ensure the locking clasps are fully disengaged before attempting to fold. Apply gentle, even pressure. Do not force.
Scratches on the floor.	Anti-skid pads are missing or damaged. Desk was dragged.	Check if all anti-skid pads are present and intact. Always lift the desk when moving it, rather than dragging.

If the problem persists or is not listed here, please contact Dripex customer support for further assistance.

SPECIFICATIONS

Detailed specifications for the Dripex Folding Desk.

Attribute	Detail
Brand	Dripex
Model Number	B085DL958C
Color	White
Material	MDF (Medium-Density Fiberboard) Desktop, Metallic Steel Frame
Unfolded Dimensions (L x W x H)	80 x 45 x 74 cm (31.5 x 17.7 x 29.1 inches)
Folded Dimensions (L x W x H)	80 x 8 x 74 cm (31.5 x 3.1 x 29.1 inches)
Item Weight	7.5 kg (16.5 lbs)
Maximum Weight Capacity	15 kg (33 lbs)
Special Feature	Foldable, No Assembly Required, Anti-Skid Pads

CUSTOMER SUPPORT

For any questions, concerns, or assistance with your Dripex Folding Desk, please contact Dripex customer support through your purchase platform or the official Dripex website.

Please have your model number (B085DL958C) and purchase date ready when contacting support.

