

Manuals+

[Q & A](#) | [Deep Search](#) | [Upload](#)

[manuals.plus](#) /

› [XZENT](#) /

› [XZENT X-MAP27-MH1 Micro SD Card User Manual](#)

XZENT X-MAP27-MH1

XZENT X-MAP27-MH1 Micro SD Card User Manual

Motorhome Navigation for XZENT X-427 and X-F270

INTRODUCTION

This manual provides essential information for the proper use, installation, and maintenance of your XZENT X-MAP27-MH1 Micro SD Card. This product is designed to enhance your XZENT X-427 and X-F270 navigation systems with dedicated motorhome navigation features, comprehensive European maps, and a specialized Camping P.O.I. (Points of Interest) package.

Please read this manual thoroughly before using the product to ensure safe and optimal performance.

IMPORTANT SAFETY INFORMATION

WARNING!

- This product is exclusively intended for fixed installation and use in vehicles. Incorrect use may lead to hazardous situations.
- Always refer to the enclosed operating manual and vehicle-specific installation instructions for safe and proper setup.
- Ensure the product is used strictly as described in this manual and the product description regarding its intended purpose.
- The packaging may contain polybutyl. Keep it away from children.
- Small parts may be present in the packaging. Keep them away from children to prevent choking hazards.
- Loose ceramic-magnet systems on loudspeakers can be damaged by mechanical stress (e.g., dropping, impact). Splinters may cause eye injury.
- Strong magnets can attract objects made of steel or iron. Keep tools, knives, and other sharp or pointed objects away from loudspeakers.
- Neodymium magnets are not nickel-coated. Nickel is a strong allergen; avoid skin contact.
- Prolonged and loud listening to audio playback can cause hearing damage and/or tinnitus. Set the volume to a normal, comfortable level.
- This product complies with applicable EU regulations and harmonized standards for its product category.

WHAT'S INCLUDED

The XZENT X-MAP27-MH1 package includes:

- X-MAP27-MH1 Micro SD Card with pre-loaded motorhome navigation software, European maps, and Camping P.O.I. package.
- Quick Start Guide.



Image: The XZENT X-MAP27-MH1 Micro SD card and its Quick Start Guide, shown within their sealed packaging. The packaging displays the product's UPC (7612309406433) and manufacturer details.



Image: The cover of the "NAVIGATION QUICK START GUIDE" for the XZENT X-MAP27 SERIES, indicating multi-language support including English, German, French, Italian, and Dutch.

SETUP AND INSTALLATION

The X-MAP27-MH1 Micro SD card is designed for use with specific XZENT infotainment systems. Follow these general steps for installation:

1. **Identify Compatible Unit:** Ensure your XZENT unit is either an X-427 or X-F270 model.

2. **Locate SD Card Slot:** Refer to your XZENT infotainment system's manual to locate the Micro SD card slot. This is typically found on the front panel or behind a removable cover.
3. **Insert Micro SD Card:** Carefully insert the X-MAP27-MH1 Micro SD card into the designated slot until it clicks into place. Do not force the card.
4. **System Recognition:** Power on your XZENT unit. The system should automatically detect the new navigation data. Follow any on-screen prompts to activate or configure the navigation software.



ALLGEMEINE
NAVIFUNKTIONEN



Hochauflösende 3-D Karten

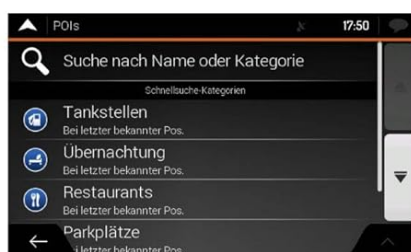

6,5 Millionen Premium P.O.I.



Schnelle Routenberechnung

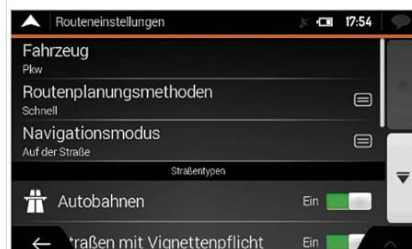

Routenplanungsmethoden



Übersichtliche Darstellung



Eindeutige Routenführung

Image: The XZENT X-MAP27-MH1 Micro SD card shown alongside compatible XZENT infotainment systems: XZENT X-427, XZENT X-F285, and XZENT X-F270, illustrating the card's integration with these units.

OPERATING THE NAVIGATION SYSTEM

Once the Micro SD card is installed and recognized, you can access the navigation features through your XZENT unit's interface. The X-MAP27-MH1 provides both general navigation functions and specialized motorhome features.

General Navigation Functions

- **Route Calculation:** Enter your destination to calculate routes. The system supports various routing options.
- **Lane Assist:** Provides visual guidance for lane changes and complex intersections.
- **POI Search:** Search for points of interest such as fuel stations, restaurants, parking, and accommodation.
- **Map Views:** Switch between 2D and 3D map views for better orientation.
- **Traffic Information:** Access real-time traffic data to avoid congestion (if supported by your XZENT unit and service).

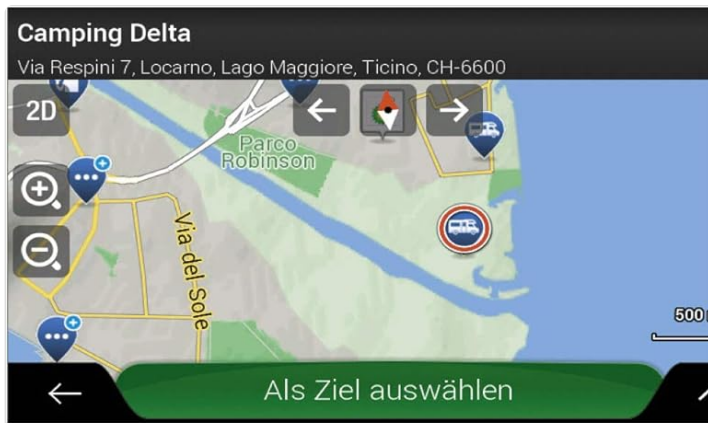

SPEZIELLE REISEMOBILFUNKTIONEN



Einstellung Fahrzeugprofil



Routenplanung Reisemobil



Camping P.O.I.



Auswahl P.O.I.



Anzeige Camping P.O.I.



Anzeige Camping P.O.I.

Image: Displays various general navigation features, including a detailed 3D map view, a comprehensive POI search interface (for fuel, accommodation, restaurants, parking), and the main navigation menu with options for new routes, intermediate points, traffic, and useful information.

Specialized Motorhome Navigation

The X-MAP27-MH1 is optimized for motorhome travel, offering features to ensure safe and efficient routing for larger vehicles.

- **Vehicle Profile Settings:** Configure your motorhome's dimensions (height, width, length), weight, and axle load to ensure routes are calculated to avoid unsuitable roads, low bridges, or weight-restricted areas.
- **Camping P.O.I. Database:** Access a dedicated database of camping sites, motorhome parking areas, and other relevant points of interest for motorhome travelers.
- **Route Planning for Motorhomes:** The system considers your vehicle's profile when calculating routes, providing safer and more appropriate directions.

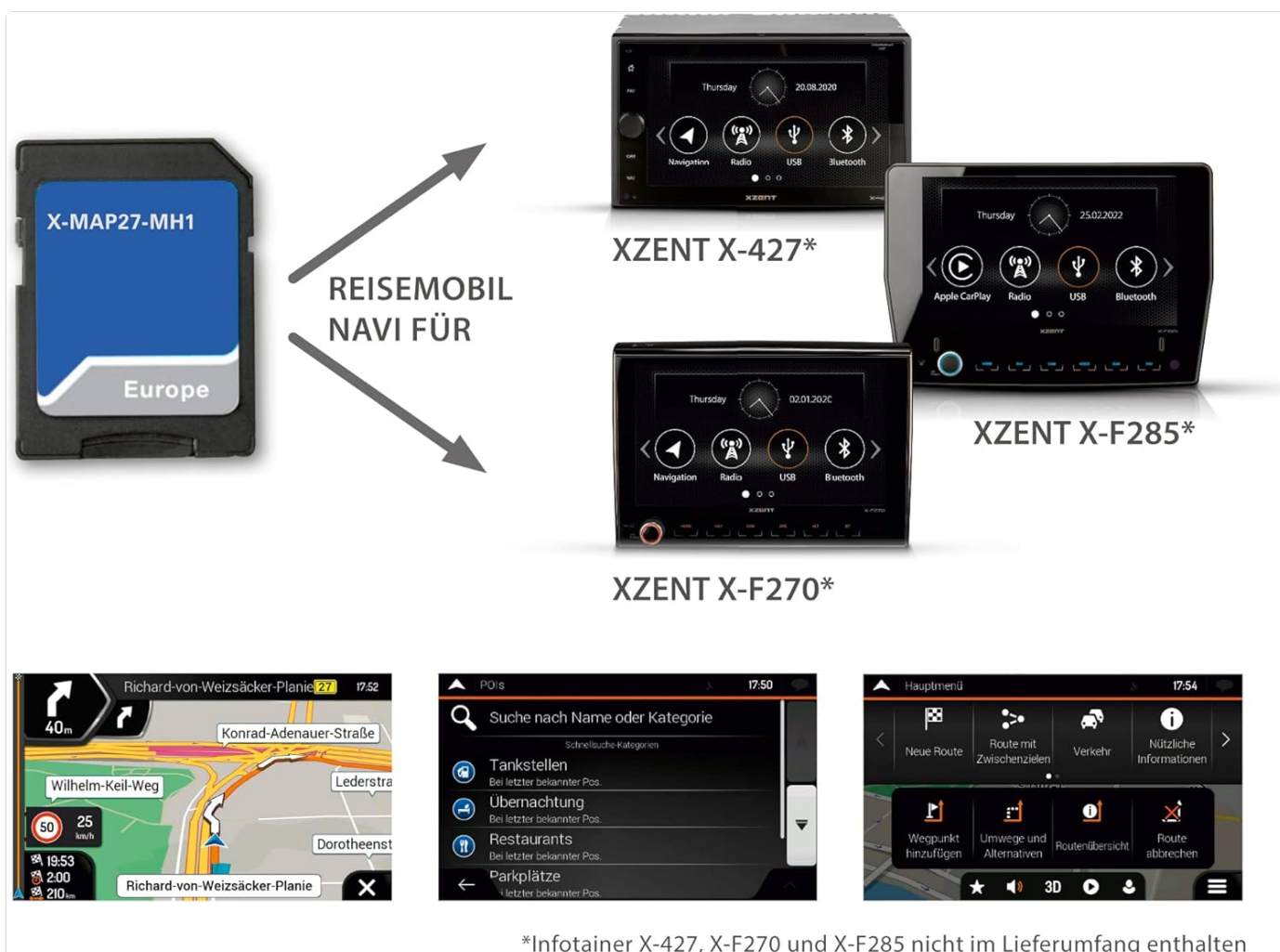

Image: Illustrates specialized motorhome navigation features, including a map view with navigation instructions, a search function for "Camping Delta" POIs, and a vehicle selection screen allowing users to specify vehicle type (e.g., small motorhome, medium motorhome) for tailored routing.

MAINTENANCE AND MAP UPDATES

The X-MAP27-MH1 Micro SD card requires minimal maintenance. Keep the card clean and free from dust or moisture. Avoid touching the gold contacts.

Map Updates: The product includes 1 year of free map updates. To ensure your navigation system has the latest maps and P.O.I. data, regularly check for updates. Instructions for downloading and installing updates are typically provided on the XZENT support website or through the navigation software's update utility.

For detailed instructions on map updates, please refer to the official XZENT support resources.

TROUBLESHOOTING

If you encounter issues with your X-MAP27-MH1 Micro SD card or navigation system, consider the following troubleshooting steps:

- **Card Not Recognized:**

- Ensure the Micro SD card is fully and correctly inserted into the slot.
- Power cycle your XZENT unit (turn off and on again).
- Check if the card's contacts are clean. Gently wipe with a soft, dry cloth if necessary.
- Verify that your XZENT unit (X-427 or X-F270) is compatible with the X-MAP27-MH1.

- **Navigation Software Not Starting:**

- Ensure the Micro SD card is inserted before powering on the unit.

- Check for any error messages on the screen.
- If a software update was interrupted, try re-downloading and installing it.

- **Incorrect Route Calculation:**

- Verify that your motorhome's dimensions and weight are correctly entered in the vehicle profile settings.
- Ensure you have the latest map updates installed.

- **Slow Performance:**

- Ensure the Micro SD card is genuine and not corrupted.
- Close any unnecessary applications running on your XZENT unit (if applicable).

If these steps do not resolve the issue, please contact XZENT customer support for further assistance.

SPECIFICATIONS

Feature	Detail
Model Name	X-MAP27-MH1
Product Type	Micro SD Card with Navigation Software
Compatibility	XZENT X-427, XZENT X-F270 (and X-F285 as shown in image)
Map Coverage	Europe
Special Features	Motorhome Navigation, Camping POI database, Lane Assist
Connectivity	USB (for updates via compatible device)
Included Components	X-MAP27-MH1 Micro SD card, Quick Start Guide
Item Weight	6.3 ounces (approx. 178 grams)
Package Dimensions	9.29 x 8.46 x 1.85 inches
Manufacturer	XZENT
First Available Date	April 16, 2025

WARRANTY AND SUPPORT

For warranty information and technical support, please contact the manufacturer or authorized service centers. The product includes 1 year of free map updates from the date of activation.

Manufacturer & EU Importer:

ACR Brändli + Vögeli AG

Bohrturmweg 1

5330 Bad Zurzach

Switzerland

E-Mail: info@acr.eu

Website: <https://www.acr.eu>

Support Inquiries: <https://www.acr.eu/support/>

EU Representative for Product Compliance:



ACR S + V GmbH

Industriestr. 35
79787 Lauchringen
Germany
E-Mail for Product Compliance: compliance@acr.eu

For the most current support information and resources, always refer to the official XZENT or ACR Brändli + Vögeli AG websites.

© 2025 XZENT. All rights reserved. Information subject to change without notice.

Related Documents - X-MAP27-MH1

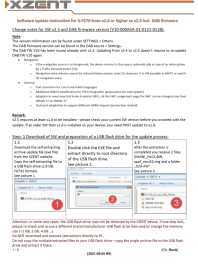
 <p>The image shows the cover of the XZENT X-427 User Manual. It features the XZENT logo at the bottom and the text 'USER MANUAL', 'BENUTZERHANDBUCH', 'MANUEL DE L'UTILISATEUR', and 'MANUALE D'USO' at the top. The central image is a black infotainment screen with various icons on the display.</p>	<p>XZENT Navitainer X-427 User Manual</p> <p>Comprehensive user manual for the XZENT Navitainer X-427, covering installation, operation, features like navigation, Bluetooth, USB, radio, and safety information. Includes technical specifications and warranty details.</p>
 <p>The image shows the cover of the XZENT X-F270 Infotainer Installation Guide for Fiat Ducato Series 8. It features the XZENT logo at the bottom and the text 'MOUNTING INSTRUCTION' and 'MONTAGEANLEITUNG' at the top. The central image is a black infotainment screen with various icons on the display.</p>	<p>XZENT X-F270 Infotainer Installation Guide for Fiat Ducato Series 8</p> <p>Comprehensive installation instructions for the XZENT X-F270 Infotainer and N-XFDUC8 mounting frame, specifically designed for the Fiat Ducato Series 8. This guide covers unboxing, tools required, step-by-step installation, connections, and commissioning.</p>
 <p>The image shows the cover of the XZENT X-F270 Software Update Instructions (v1.6 to v2.5 incl. DAB). It features the XZENT logo at the top and the text 'Software update instructions for X-F270 from v1.6 to v2.5 incl. DAB' at the bottom. The central image is a screenshot of the software update process on a screen.</p>	<p>XZENT X-F270 Software Update Instructions (v1.6 to v2.5 incl. DAB)</p> <p>Detailed guide for updating the XZENT X-F270 infotainment system to version 2.5, including DAB firmware. Covers download, preparation, APP/MCU update, DAB firmware update, and factory settings.</p>

[illegible]

Service bulletin detailing the installation and configuration of the XZENT X-F270 infotainment system for FIAT Ducato III, Series 8 vehicles (from Q3 2021). Covers mounting frame requirements, steering wheel button integration via analog signals and LIN bus, software version prerequisites, and mode switching for SWC assignment.

xzent

Release: 4.0.0 (beta)

Windows 64-bit (x64) (beta)



The XZent 4.0.0 (beta) Windows 64-bit (x64) (beta) is a new release of the XZent 4.0.0 (beta) Windows 64-bit (x64) (beta) software. This release includes several new features and improvements, including:

- New Features:**
 - Added support for Windows 64-bit (x64) (beta) architecture.
 - Added support for Windows 64-bit (x64) (beta) architecture.
 - Added support for Windows 64-bit (x64) (beta) architecture.
- Improvements:**
 - Improved performance and stability.
 - Improved user interface and experience.
 - Improved security and privacy.

For more information about the XZent 4.0.0 (beta) Windows 64-bit (x64) (beta) software, please visit the XZent website at www.xzent.com.

Troubleshooting guide for XZENT X-F285 and X-F280 infotainment systems experiencing poor GPS reception. Covers common causes, antenna cable routing, and optimal antenna placement for Ford Transit vehicles.