

Manuals+

[Q & A](#) | [Deep Search](#) | [Upload](#)

[manuals.plus](#) /

› [ACEGMET](#) /

› [ACEGMET X20-60m Green Beam Laser Measure User Manual](#)

ACEGMET X20-60m

ACEGMET X20-60m Green Beam Laser Measure User Manual

Model: X20-60m | Brand: ACEGMET

1. INTRODUCTION

The ACEGMET X20-60m is a portable and user-friendly green beam laser measuring device designed for high-precision distance measurements. It features a bright green laser for enhanced visibility, an electronic angle sensor for advanced measurements, and multiple calculation modes including area, volume, and Pythagorean functions. This manual provides essential information for the safe and effective operation of your device.



Image: The ACEGMET X20-60m Green Beam Laser Measure device.

2. SAFETY INFORMATION

This device uses a Class 2 laser. Observe the following safety precautions:

- Do not stare directly into the laser beam.
- Do not aim the laser beam at people or animals.
- Avoid direct eye exposure.
- Do not disassemble the device; repairs should only be performed by authorized personnel.
- Keep the device out of reach of children.
- Use the device only for its intended purpose as described in this manual.

Laser Class: Class 2

Laser Type: 490-560nm, <1mW

3. PACKAGE CONTENTS

Verify that all items are present in the package:

- 1x ACEGMET Laser Measure Device
- 3x 1.5V Rechargeable Batteries
- 1x Hand Strap
- 1x Storage Bag



Image: The ACEGMET X20-60m laser measure, rechargeable batteries, hand strap, and storage bag.

4. SETUP

4.1 Battery Installation

1. Locate the battery compartment on the device.
2. Open the battery compartment cover.
3. Insert the three 1.5V rechargeable batteries, ensuring correct polarity (+/-).
4. Close the battery compartment cover securely.

4.2 Charging the Device

The device is equipped with rechargeable batteries and supports USB charging.

1. Connect the provided USB cable to the charging port on the device.
2. Connect the other end of the USB cable to a compatible USB power adapter (not included) or a computer

USB port.

3. The device's display will indicate charging status.
4. Once fully charged, disconnect the USB cable.



Image: The laser measure connected for USB charging, highlighting its waterproof design.

5. OPERATING INSTRUCTIONS

5.1 Power On/Off

- To power on: Press the **MEAS** button.
- To power off: Press and hold the **CLEAR/OFF** button. The device will automatically shut down after 180 seconds of inactivity to save power.

5.2 Unit Switching

Press the **UNIT** button to cycle through measurement units: Meters (M), Inches (In), Feet (Ft), and Feet+Inches (Ft+In).

5.3 Reference Point Switching

The device can measure from its front or rear edge. Press the reference point button (often indicated by an icon with an arrow pointing from the front or back of the device) to switch between reference points as needed for different measurement scenarios.

5.4 Measurement Modes

Press the **Function** button (often indicated by a square icon or 'M' for Mode) to cycle through the available measurement modes.



Image: Visual representation of the eight measurement modes and four unit modes available on the device.

1. Single Distance Measurement:

Point the laser at the target and press **MEAS**. The distance will be displayed instantly.

2. Continuous Measurement (Tracking):

Activate this mode, then move the device. The display will continuously update with the current distance, showing maximum and minimum values.

3. Area Measurement:

Select area mode. Measure the length, then measure the width. The device will automatically calculate and display the area.

4. Volume Measurement:

Select volume mode. Measure length, width, and height. The device will automatically calculate and display the volume.

5. Pythagorean Measurement (2-point, 3-point):

Used for indirect height or distance measurements. Follow the on-screen prompts to measure the required sides of a right-angled triangle. The device will calculate the unknown side.

6. Electronic Angle Sensor / Auto Level / Auto Height Measurement:

The integrated angle sensor allows for electronic level measurements, auto-level, and auto-height functions. For example, measure the distance between two points in the horizontal direction or determine the height of a window from the ground with a single measurement.

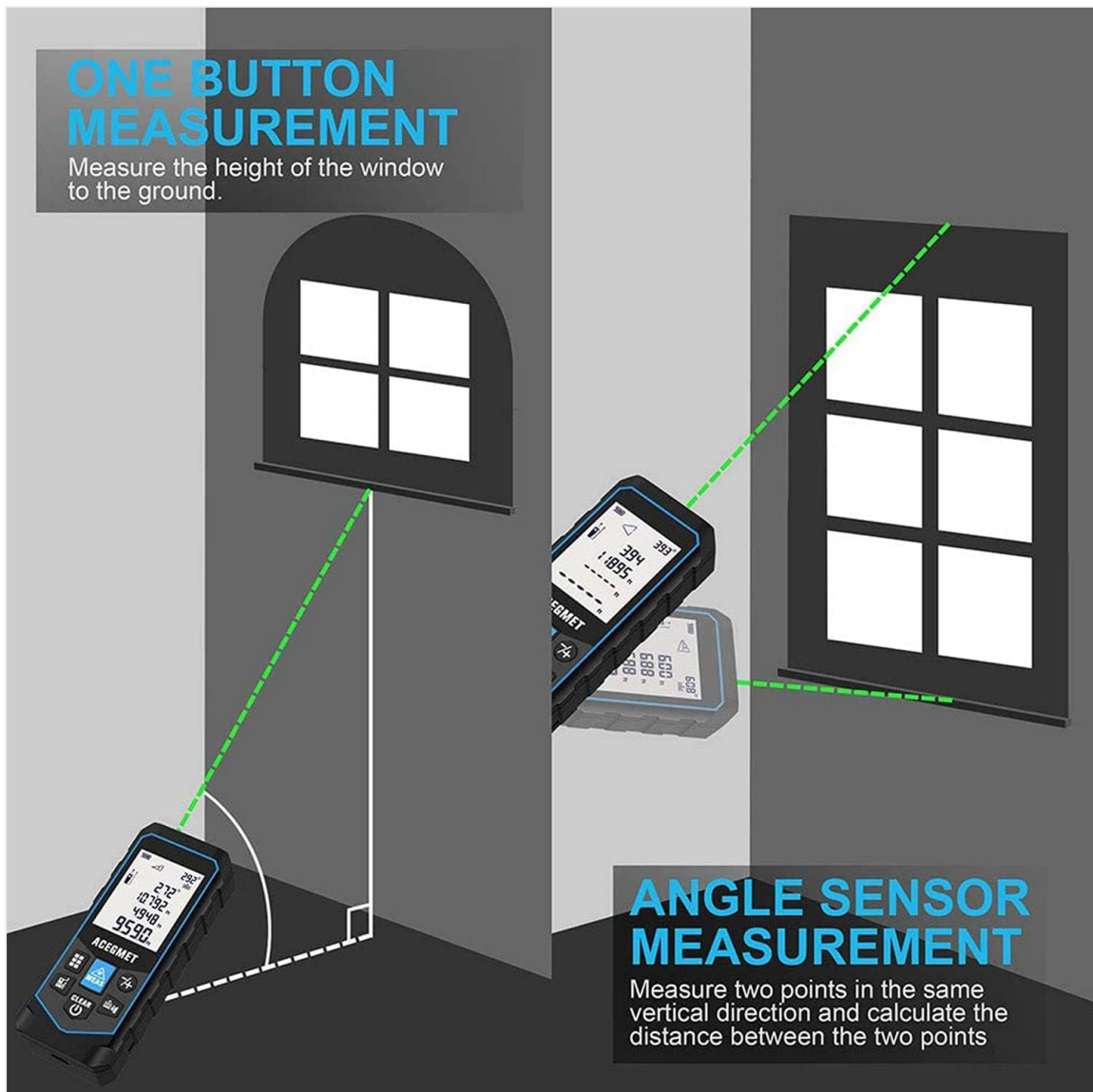

Image: Demonstrating the angle sensor measurement feature to calculate the height of a window.

5.5 Data Storage and Retrieval

The device can store up to 20 sets of measurement data. Use the appropriate buttons (refer to device interface) to save and retrieve historical data.

20 GROUPS OF DATA RECORDS

20 groups of measuring data records, convenient to check at any time.



Image: The device display showing multiple stored measurement data records.

5.6 Addition and Subtraction

The device supports addition and subtraction of measurement values. Enter the first value, select the addition/subtraction function, then enter the second value. The result will be displayed.

5.7 Mute Function

For use in quiet environments, activate the mute function to disable audible feedback.

5.8 Backlit LCD Display

The 2-inch backlit LCD display provides clear visibility in low light conditions.

6. MAINTENANCE

6.1 Cleaning

- Wipe the device with a soft, damp cloth. Do not use abrasive cleaners or solvents.
- Ensure the laser lens and display are clean for accurate readings.

6.2 Storage

- Store the device in its storage bag when not in use.
- Keep the device in a cool, dry place, away from direct sunlight and extreme temperatures.

6.3 Self-Calibration

The device supports self-calibration to maintain measurement accuracy. Refer to the on-screen menu or specific button combinations for initiating the self-calibration process.

7. TROUBLESHOOTING

- **Device not powering on:** Check battery charge level. Ensure batteries are inserted correctly.
- **Inaccurate measurements:** Ensure the laser lens is clean. Verify the correct reference point is selected. Perform self-calibration if necessary.
- **Laser beam not visible:** The green beam is designed for better visibility, but in very bright conditions or over long distances, it may be less apparent. Ensure the target surface is suitable for reflection.
- **Error messages:** Consult the device's display for specific error codes and refer to the full product manual (if available) for detailed explanations.

8. SPECIFICATIONS

Measuring Accuracy	±1/16 inch
Measuring Units	Ft/Ft+In/M/In
Laser Class	Class 2
Laser Type	490-560nm, <1mW
Data Storage	20 Groups
Operation Temperature	0°C - 40°C (32°F - 104°F)
Dimension	115 x 49 x 26mm
Measuring Range	Up to 196 Ft
International Protection Rating	IP54 (Waterproof)
Batteries	3x 1.5V Rechargeable NiMH (included)
Item Weight	222 g
Material	Plastic

9. WARRANTY AND SUPPORT

ACEGMET provides an 18-month worry-free warranty and lifetime technical support for this product. If you have any questions or require assistance, please contact ACEGMET customer service. Our technical and after-sales teams are available to assist you.

