

## Manuals+

[Q & A](#) | [Deep Search](#) | [Upload](#)

manuals.plus /

- › [Zyyini](#) /
- › [Zyyini USB LED Clip Desk Lamp Instruction Manual](#)

Zyyini Zyyiniyw3xkg7u6h

# Zyyini USB LED Clip Desk Lamp Instruction Manual

Model: Zyyiniyw3xkg7u6h

## INTRODUCTION

Thank you for choosing the Zyyini USB LED Clip Desk Lamp. This versatile lamp is designed to provide bright, eye-friendly illumination for a variety of tasks, including reading, studying, working, tattooing, and beauty applications. Its flexible gooseneck and sturdy clip offer convenient positioning and portability. Please read this manual carefully before use to ensure proper operation and longevity of your product.

## PACKAGE CONTENTS

Please check the package for the following items:

- 1 x LED Lamp Head with Flexible Gooseneck
- 1 x Adjustable Clamp/Support
- 1 x USB Power Cable

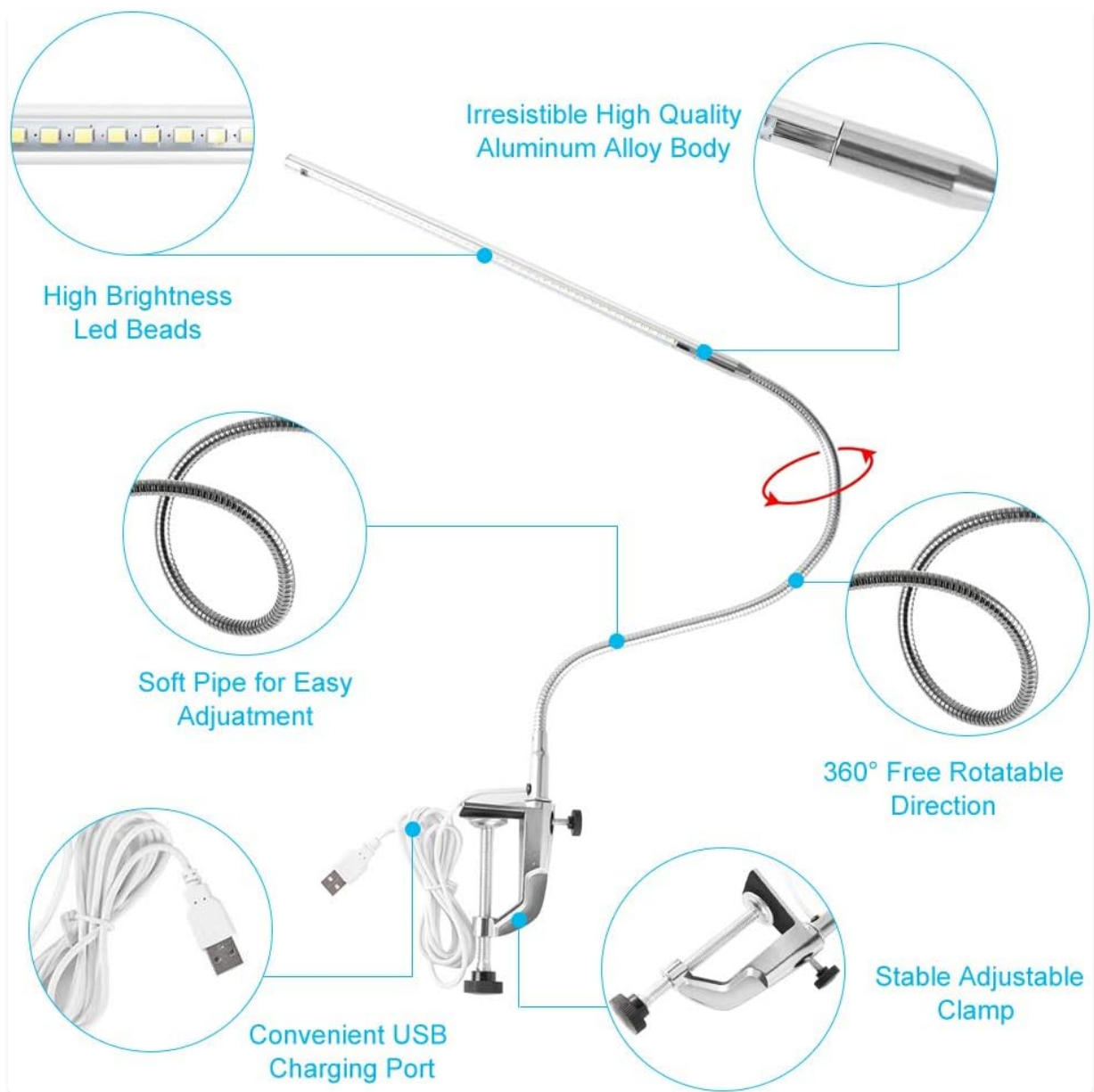

**Image:** Overview of the lamp's components, highlighting the high brightness LED beads, aluminum alloy body, soft pipe for adjustment, 360° free rotatable direction, stable adjustable clamp, and convenient USB charging port.

## SPECIFICATIONS

<b>Brand</b>	Zyyini
<b>Model Number</b>	Zyyiniyw3xkg7u6h
<b>Product Dimensions</b>	40 x 38 x 5.5 cm
<b>Item Weight</b>	410 grams
<b>Material</b>	Acrylonitrile Butadiene Styrene (ABS)
<b>Finish Type</b>	Polished
<b>Number of LED Beads</b>	48
<b>Light Source Type</b>	LED
<b>Power</b>	18 Watts

<b>Power Supply</b>	USB Cable
<b>Voltage</b>	≤36V
<b>Special Feature</b>	Flexible Gooseneck, Clip-on Design, Eye Protection

## SETUP INSTRUCTIONS

1. **Attach the Clamp:** Securely attach the adjustable clamp to a stable surface such as a desk, headboard, or workbench. Ensure the surface thickness is compatible with the clamp's opening.
2. **Insert the Lamp:** Insert the base of the flexible gooseneck into the designated slot on the clamp. Tighten any securing screws or knobs on the clamp to hold the lamp firmly in place.
3. **Connect Power:** Plug the USB power cable into the lamp's USB port. Connect the other end of the USB cable to a compatible USB power source (e.g., computer, laptop, power bank, or USB wall adapter).

## Multi-Choice To Charge



**Image:** Illustration of various power sources that can be used to charge or power the lamp, such as a PC, USB power adapter, power bank, and laptop, demonstrating its versatility.

## OPERATING INSTRUCTIONS

1. **Power On/Off:** Once connected to a power source, locate the power switch (often integrated into the USB cable or lamp base). Press or rotate the switch to turn the lamp on or off.
2. **Adjust Light Direction:** Utilize the 360° flexible gooseneck to position the light exactly where needed. Gently bend and twist the gooseneck to achieve the desired angle and height.
3. **Brightness Adjustment:** If your lamp features brightness control (e.g., a rotary switch or touch sensor), adjust it to your preferred illumination level.

## 360° Flexible Gooseneck Allows You to Direct the Light Exactly Where You Need It to



**Image:** The lamp's flexible gooseneck shown in multiple configurations, illustrating how it can be bent and twisted to direct light to any desired area.

# Easily Meet The Needs of All The Lights In Life

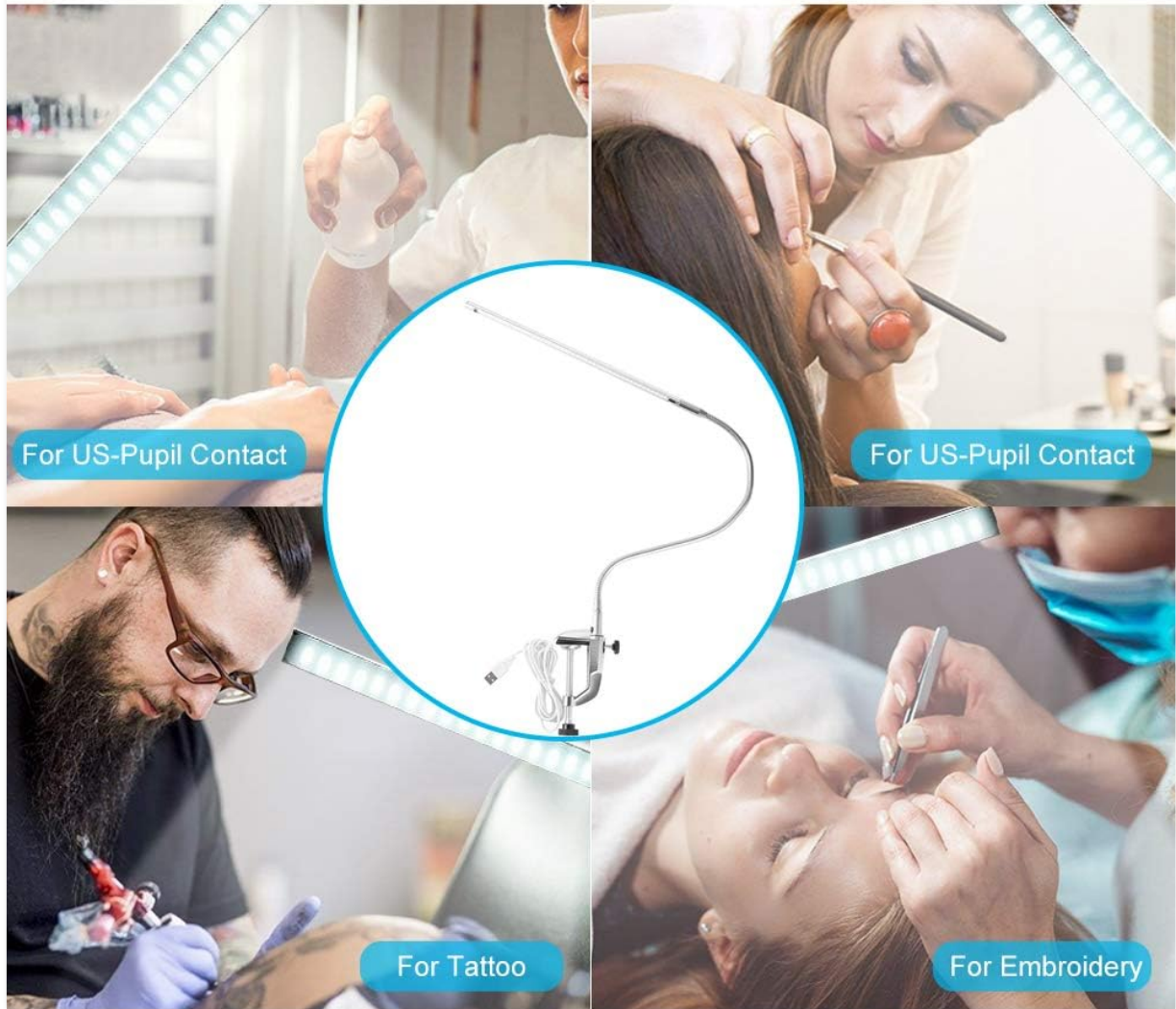

**Image:** Examples of the lamp's versatile applications, including detailed work like tattooing, embroidery, and tasks requiring precise illumination.

## MAINTENANCE

- **Cleaning:** Disconnect the lamp from the power source before cleaning. Use a soft, dry cloth to wipe the lamp head, gooseneck, and clamp. Do not use abrasive cleaners or solvents, as they may damage the finish.
- **Storage:** When not in use for extended periods, store the lamp in a clean, dry place away from direct sunlight and extreme temperatures.
- **Handling:** Avoid excessive force when adjusting the gooseneck to prevent damage. Do not attempt to disassemble the lamp head or electrical components.

## TROUBLESHOOTING

**Problem: The lamp does not turn on.**

**Solution:**

- Ensure the USB cable is securely plugged into both the lamp and the power source.
- Verify that the USB power source is functional (e.g., try plugging another device into the same

port).

- Check the power switch on the lamp or cable to ensure it is in the "On" position.

**Problem: The light flickers or is dim.**

**Solution:**

- Ensure the power source provides sufficient power (e.g., a weak USB port or power bank might not provide enough current).
- Check for any damage to the USB cable. Try using a different USB cable if available.
- If the lamp has brightness control, ensure it is set to the desired level.

## WARRANTY INFORMATION

---

Specific warranty information for this product is not provided in the available data. Please refer to the retailer or manufacturer's website for details regarding warranty coverage and terms.

## CUSTOMER SUPPORT

---

For further assistance or inquiries, please contact your point of purchase or visit the Zyyini official website. Please have your model number (Zyyiniw3xkg7u6h) ready when contacting support.