

**Teleco TXP-868-A02**

# Teleco TXP-868-A02 Remote Control User Manual

Model: TXP-868-A02 | Brand: Teleco

## 1. INTRODUCTION

This user manual provides comprehensive instructions for the Teleco TXP-868-A02 2-channel rolling code remote control. This device is designed for controlling compatible automated systems, such as garage doors, gates, or other access control systems, operating on the 868 MHz frequency.

Key features include:

- 2 independent channels for controlling different functions.
- Rolling code technology for enhanced security.
- Operates on the 868 MHz frequency.
- Powered by a single CR2032 battery (included).



Figure 1: Front view of the Teleco TXP-868-A02 remote control, showing the two distinct buttons for channel

operation.

## 2. PRODUCT OVERVIEW AND COMPONENTS

---

The Teleco TXP-868-A02 remote control features a compact design with two primary buttons for operation. The device is designed for easy handling and portability.



Figure 2: Detailed front view highlighting the two operational buttons.



Figure 3: Back view of the remote control, showing the battery compartment cover and product identification label.





Figure 4: The remote control with its back cover removed, illustrating the internal structure and battery housing area.

### 3. SPECIFICATIONS

Feature	Detail
Model	TXP-868-A02
Brand	Teleco
Channels	2
Frequency	868 MHz
Battery Type	1 x CR2032 (included)
Weight	30 grams
Technology	Rolling Code

## 4. SETUP

---

### 4.1. Battery Installation

The Teleco TXP-868-A02 remote control comes with a CR2032 battery pre-installed. If replacement is needed, follow these steps:

1. Carefully open the remote control casing. Refer to Figure 3 for the battery compartment location on the back.
2. Remove the old CR2032 battery.
3. Insert a new CR2032 battery, ensuring the positive (+) side is facing upwards.
4. Close the remote control casing securely.

### 4.2. Programming the Remote Control

The Teleco TXP-868-A02 uses rolling code technology, which requires pairing with a compatible receiver unit. Specific programming procedures vary depending on the receiver model you are using. Always refer to the instruction manual provided with your receiver unit for detailed programming steps.

*General Programming Steps (may vary):*

1. Locate the programming button or learn mode on your receiver unit (e.g., garage door opener, gate opener).
2. Activate the receiver's programming mode (often indicated by an LED light).
3. Within a few seconds, press and hold the desired button on your Teleco TXP-868-A02 remote control for 2-3 seconds.
4. Release the button. The receiver's LED may flash or change state to indicate successful pairing.
5. Test the remote control to ensure it operates the system correctly.

If you encounter difficulties, consult the receiver's manual or contact a qualified technician.

## 5. OPERATING INSTRUCTIONS

---

Once the Teleco TXP-868-A02 remote control is successfully programmed with your receiver, operation is straightforward:

- To activate Channel 1: Press the **left** button on the remote control.
- To activate Channel 2: Press the **right** button on the remote control.

Ensure you are within the operational range of your receiver unit for the remote control to function correctly. Obstructions and interference can affect the range.

## 6. MAINTENANCE

## 6.1. Battery Replacement

When the remote control's range decreases significantly or it stops responding, the battery may need replacement. Follow the steps outlined in Section 4.1. "Battery Installation". Dispose of old batteries responsibly according to local regulations.

## 6.2. Cleaning

Clean the remote control with a soft, dry cloth. Do not use abrasive cleaners, solvents, or immerse the device in water. Keep the buttons free from dirt and debris to ensure proper function.

## 6.3. Storage

Store the remote control in a dry place, away from direct sunlight, extreme temperatures, and high humidity. Avoid dropping the device or subjecting it to strong impacts.

# 7. TROUBLESHOOTING

Problem	Possible Cause	Solution
Remote control not working.	Dead or low battery. Not programmed correctly. Out of range. Receiver issue.	Replace the CR2032 battery. Re-program the remote control to the receiver (refer to Section 4.2). Move closer to the receiver unit. Check the receiver unit's power and status.
Reduced operating range.	Low battery. Radio interference. Obstructions.	Replace the CR2032 battery. Identify and remove sources of interference (e.g., other wireless devices). Ensure a clear line of sight if possible.
Buttons are sticky or unresponsive.	Dirt or debris under buttons.	Clean the remote control as described in Section 6.2.

# 8. COMPATIBILITY

The Teleco TXP-868-A02 remote control is designed to be compatible with specific Teleco rolling code remote controls and receivers operating on the 868 MHz frequency. It is **not** compatible with 433 MHz systems.

Compatible Teleco rolling code remote control models include:

- TVTXP-868-A01
- TVTXP-868-A02



- TVTXP-868-A04
- TVMIO-868-P02
- TVMIO-868-P04
- TVTXE-868-A04



Figure 5: Visual guide to compatible Teleco 868MHz rolling code remote controls. Note the explicit incompatibility with 433MHz models.

## 9. WARRANTY AND SUPPORT



For information regarding warranty coverage, returns, or technical support for your Teleco TXP-868-A02 remote control, please contact the retailer or authorized distributor from whom you purchased the product. Keep your proof of purchase for warranty claims.

Manufacturer: Teleco

© 2023 Teleco. All rights reserved.

This manual is for informational purposes only. Teleco reserves the right to make changes to its products without prior notice.

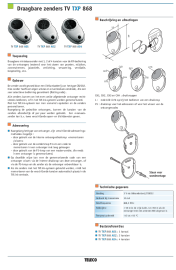
## Related Documents

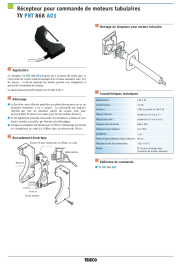
	<p><a href="#">Draagbare Zenders TV TXP 868: Handleiding en Specificaties</a></p> <p>Gedetailleerde informatie over de TELECO Draagbare Zenders TV TXP 868 serie (A01, A02, A04). Inclusief toepassingen, technische specificaties, installatie-instructies, veiligheidsvoorschriften en garantie.</p>
	<p><a href="#">Programming Notice for TELECO TXP 433 – TXP 868 Remote Control</a></p> <p>Instructions for programming the TELECO TXP 433 and TXP 868 remote controls using either an already programmed remote or directly via the receiver.</p>
	<p><a href="#">TELECO TV TXQ 868 Portable Transmitters - User Manual</a></p> <p>This document provides detailed information and usage instructions for the TELECO TV TXQ 868 series of portable transmitters, including models A03, A07, A18, and A42. It covers applications, technical specifications, usage recommendations, battery replacement, warranty, and EU conformity declarations.</p>
	<p><a href="#">Teleco TV PRT 868 A01 Tubular Motor Receiver Manual</a></p> <p>This document provides detailed instructions and technical specifications for the Teleco TV PRT 868 A01 tubular motor receiver, covering its application, addressing, electrical connections, technical characteristics, and programming procedures.</p>

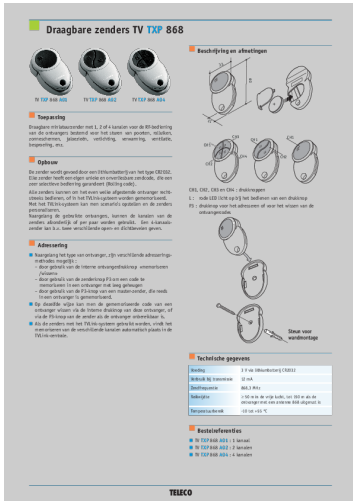

[Draagbare Zenders TV TXP 868: Handleiding en Specificaties](#)

Gedetailleerde informatie over de TELECO Draagbare Zenders TV TXP 868 serie (A01, A02, A04). Inclusief toepassingen, technische specificaties, installatie-instructies, veiligheidsvoorschriften en garantie.

lang:nl **score:28** filesize: 1.32 M page\_count: 2 document date: 2010-03-11

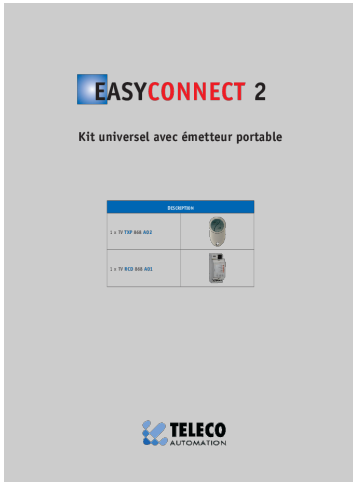

[\[pdf\]](#)

Page de garde ME vp pl Kit universel avec émetteur portable Cebeo e shop TELECO Emetteurs portables TV TXP 868 n Application Emetteur > A01 émet teur 1 ca 3720231 w3 cebeo eu fr |||

EASYCONNECT 2 Kit universel avec metteur portable DESCRIPTION 1 x TV TXP 868 A02 1 x TV RCD 868 A01 Emetteurs portables TV TXP 868 n Description et encombrement TV TXP 868 A02 TV TXP 868 A04 n Application Emetteur portable miniature 1, 2 ou 4 canaux pour commande par signal radio des rcepteur...

lang:fr **score:27** filesize: 1.46 M page\_count: 7 document date: 2006-11-20



### [\[pdf\]](#) Catalog

Catalogue général Tempolec 868 A télécommande installateur pour le réglage des paramètres Présence TELECO sans fil et programmation par PC 324 Tableau applications tempolec electricite domotique fr files uploaded Catalogues |||

Electricité industrielle et du bâtiment Automatisme industriel Domotique Catalogue gnral 60 ans d'expérience Qualité des produits et caractère innovant Garantie Expertise technique Solutions astucieuses, particulièrement en matière d'économie d'énergie Service Stock [www.tempolec.be](http://www.tempolec.be) 1 SOMMAIRE 1 Inter...

lang:fr score:12 filesize: 43.79 M page\_count: 426 document date: 2019-10-23