

Manuals.plus /

› H2O /

› H2O X5 5-in-1 Multi-Purpose Steam Mop Instruction Manual

H2O H2O X5 5 in 1

H2O X5 5-in-1 Multi-Purpose Steam Mop Instruction Manual

MODEL: H2O X5 5 IN 1

Brand: H2O

1. Safety Information

Please read all instructions carefully before using your H2O X5 Steam Mop. Failure to follow these instructions may result in electric shock, fire, or serious personal injury.

- Always use distilled or demineralized water to prevent mineral buildup and extend the life of your appliance.
- Do not add any cleaning solutions, perfumes, oils, or other chemicals to the water tank. This can damage the appliance and void the warranty.
- Keep the appliance away from children and pets. Steam is extremely hot and can cause severe burns.
- Always unplug the appliance from the power outlet when not in use, before cleaning, or when filling/emptying the water tank.
- Do not direct steam at people, animals, or electrical appliances.
- Ensure the power cord is not damaged or tangled during use.

2. Product Overview

The H2O X5 is a versatile 5-in-1 multi-purpose steam cleaning system designed for various cleaning tasks around your home, utilizing the power of steam for chemical-free cleaning.

WHAT IS INCLUDED?

H2O X5 STEAM MOP Multipurpose Floor Steam Mop and Accessories



Figure 2.2: All included accessories for the H2O X5 Steam Mop.

- **Main Steam Unit:** The core unit containing the water tank and heating element.
- **Extension Handle:** For upright floor cleaning.
- **Mop Head:** Triangular head for floor cleaning.
- **Microfiber Floor Pad:** Attaches to the mop head for cleaning hard floors.
- **Carpet Glider:** For refreshing carpets and rugs.
- **Extension Hose:** For handheld use in hard-to-reach areas.
- **Jet Nozzle:** Concentrates steam for targeted cleaning.
- **Round Brushes (Nylon & Metal):** For scrubbing tough grime.
- **Window Cleaning Tool with Squeegee:** For streak-free window and glass cleaning.
- **Microfiber Garment Cleaning Cloth:** For steaming clothes and upholstery.
- **Duster with Coral Cloth:** For dusting and cleaning various surfaces.
- **Measuring Cup:** For accurate water filling.

Video 2.1: Overview of the 5-in-1 Multifunctional Floor Steamer.

Video 2.2: Demonstration of the H2O MOP X5 Steam Mop features.

3. Setup

3.1 Assembly

1. Connect the two parts of the extension handle by aligning the button and hole until they click into place.
2. Attach the assembled extension handle to the main steam unit, ensuring the button aligns with the hole and clicks securely.
3. Attach the mop head to the main steam unit by inserting the connection point and swiveling until it locks.
4. Secure the microfiber floor pad to the bottom of the mop head using the velcro strips.

Video 3.1: Unboxing and assembly of the H2O X5 Steam Mop and its accessories.

3.2 Filling the Water Tank

1. Ensure the appliance is unplugged.
2. Turn the knob on the water tank counter-clockwise to open it.
3. Using the provided measuring cup, fill the water tank with distilled or demineralized water. Do not overfill (max 0.5 Liters).
4. Turn the knob clockwise to securely close the water tank, ensuring the blue dot aligns with the lock symbol.

LIGHTWEIGHT AND HANDHELD MODE

Easily switch to handheld mode



LIGHTWEIGHT
Weighs less than 5 lbs

Figure 3.1: Filling the water tank with water.

4. Operating Instructions

4.1 General Operation

1. Plug the power cord into a grounded electrical outlet. The power button will illuminate orange.
2. Wait for the appliance to heat up. The power button will turn green when the steam is ready (approximately 30 seconds).
3. Adjust the steam level using the steam dial (low, medium, high) according to the surface being cleaned.
4. Begin cleaning by moving the mop slowly over the surface.



A CLEANER HOME, A SAFER FAMILY

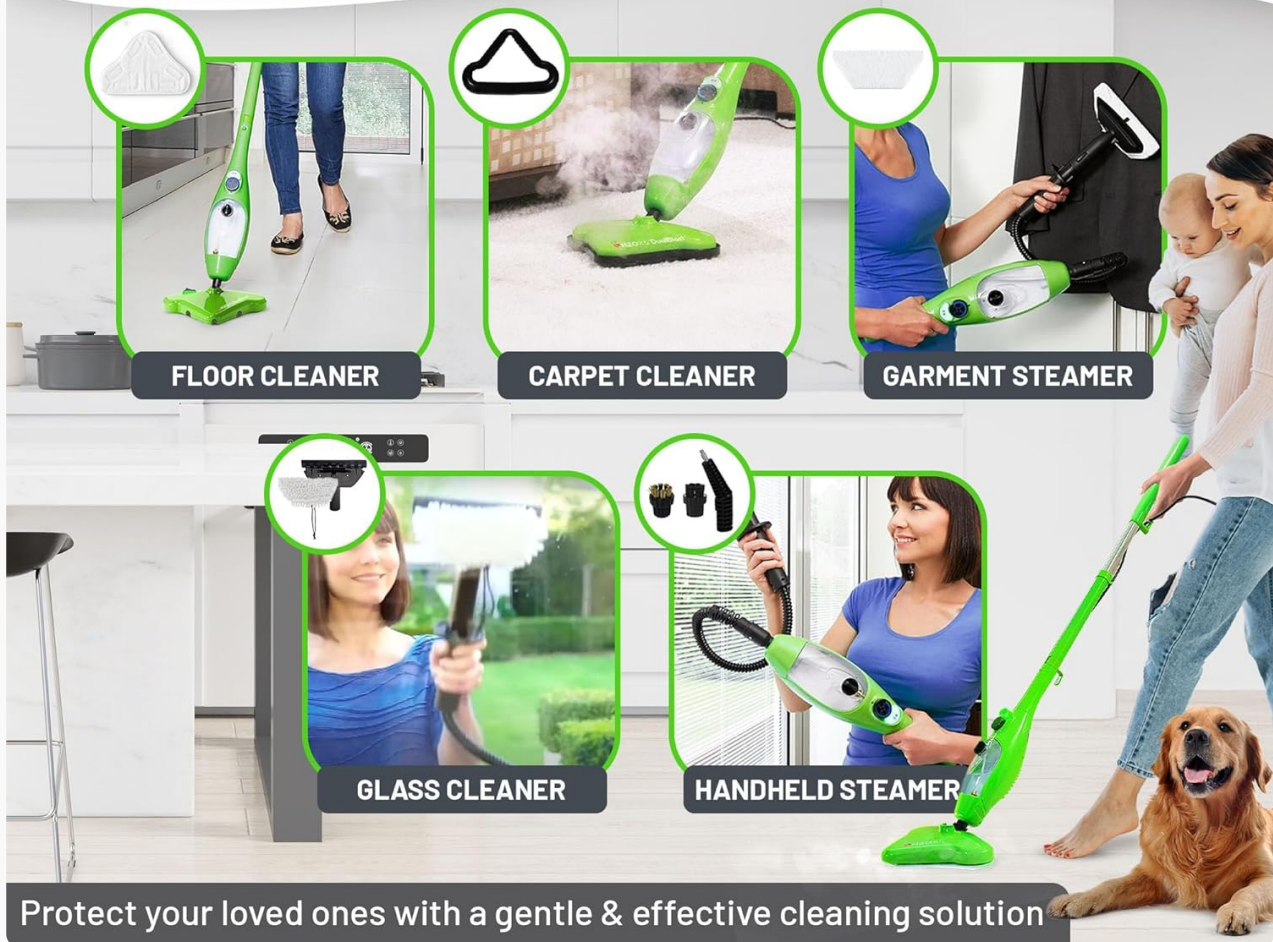

Figure 4.1: Steam regulator and water tank on the H2O X5 Steam Mop.

4.2 Using Different Modes (5-in-1 Functionality)

- **Floor Cleaner:** Use the main unit with the extension handle and microfiber floor pad for cleaning hardwood, tile, laminate, sealed stone, and marble floors.
- **Carpet Steamer:** Attach the carpet glider over the microfiber floor pad on the mop head. Glide over carpets and rugs to refresh and sanitize.
- **Handheld Steamer:** Detach the main steam unit from the extension handle. Attach the extension hose and desired nozzle (jet nozzle, round brushes) for cleaning kitchen and bathroom surfaces, grout, and tight spaces.
- **Window, Glass & Mirror Steamer:** Attach the window cleaning tool with squeegee and microfiber cloth to the extension hose. Steam and squeegee for streak-free results.
- **Garment & Upholstery Steamer:** Attach the garment cleaning cloth to the window cleaning tool (without squeegee) or directly to the extension hose. Use to remove wrinkles from clothes or refresh upholstery.



H2O X5™



JUST ADD WATER
Max 400ML capacity



**ONE TOUCH
VARIABLE STEAM**

KEY FEATURES

Designed for comfort and easy maneuverability



Figure 4.2: Visual representation of the H2O X5's 5-in-1 cleaning capabilities.

5. Maintenance

- **Cleaning Microfiber Pads:** After each use, remove and wash the microfiber pads. They are machine washable. Do not use bleach or fabric softeners. Air dry or tumble dry on low.
- **Emptying Water Tank:** Always empty any remaining water from the tank after use to prevent stagnant water and mineral buildup.
- **Descaling:** If you notice reduced steam output or mineral residue, descale the unit. Mix 1 part white vinegar with 2 parts water. Fill the tank with this solution and run the steamer until the tank is empty. Repeat if necessary, then rinse with clean water.
- **Storage:** Store the appliance in a cool, dry place, out of reach of children. Ensure the power cord is neatly wrapped.

6. Troubleshooting

| Problem | Possible Cause | Solution |
|-------------------------------|---|--|
| No steam or low steam output | Water tank empty; Mineral buildup; Unit not heated. | Refill water tank; Perform descaling; Wait for power button to turn green. |
| Water leaking from unit | Water tank cap not secured; Overfilled tank. | Ensure cap is tightly closed and locked; Do not overfill. |
| Mop head not gliding smoothly | Microfiber pad dirty or worn; Surface too dry. | Clean or replace microfiber pad; Ensure sufficient steam. |
| Streaks on floor/windows | Microfiber pad dirty; Too much steam; Residue from previous cleaners. | Use a clean pad; Reduce steam level; Clean surface thoroughly before steaming. |

7. Specifications

| Feature | Detail |
|------------------------|---|
| Model Name | H2O MOP X5 |
| Wattage | 1300 watts |
| Tank Volume | 0.5 Liters |
| Item Weight | 8.23 pounds |
| Power Source | Steam |
| Color | Green |
| Special Features | 5-in-1 Multi-Purpose, Handheld Steam Cleaner, Adjustable Height, Removable Tank, Large Capacity, Rapid Heat Up, Steam Control, Lightweight, High Pressure |
| Surface Recommendation | Hardwood, Tile, Laminate, Sealed Stone, Marble, Carpet and other floors; Kitchen, Windows, Furniture, BBQ Grills, Toys, Grout lines, Shower tracks, Sink, Toilet lid bolts, Ironing garment, etc. |

8. Warranty and Support

For warranty information or technical support, please refer to the contact details provided in your product packaging or visit the official H2O website. Keep your purchase receipt as proof of purchase.

