

PARTS 79866M

PARTS 79866M Main Drive Belt Instruction Manual for Zebra ZT410, ZT411, ZT420, ZT421 Printers (203 dpi)

1. INTRODUCTION

This manual provides essential information for the installation, maintenance, and troubleshooting of the PARTS 79866M Main Drive Belt. This drive belt is designed as a replacement part for specific Zebra thermal label printers.

1.1 Product Overview

The 79866M Main Drive Belt is a critical component for the proper functioning of compatible Zebra printers, ensuring the smooth transfer of thermal labels. It is a durable replacement part designed for longevity and reliable performance.



Image 1: The PARTS 79866M Main Drive Belt, showing its full circular form and ribbed surface.

1.2 Compatibility

This drive belt is compatible with the following Zebra thermal label printer models:

- Zebra ZT410 (203 dpi models)
- Zebra ZT411 (203 dpi models)
- Zebra ZT420 (203 dpi models)
- Zebra ZT421 (203 dpi models)

Important Note: This item is **not** compatible with Zebra ZT410 or ZT420 printers with 300 dpi resolution. Please verify your printer's resolution before installation.

2. SETUP AND INSTALLATION

Replacing the main drive belt requires careful handling and adherence to the following steps. It is recommended to consult your printer's service manual for detailed disassembly instructions if you are unfamiliar with internal printer components.

2.1 Safety Precautions

- Always power off and unplug the printer from the electrical outlet before beginning any maintenance or installation.
- Allow the printer to cool down if it has been recently in operation.
- Use appropriate tools and wear protective gear if necessary.
- Avoid touching sensitive electronic components.

2.2 Installation Steps

1. **Access the Drive Mechanism:** Carefully open the printer's casing to gain access to the main drive motor and belt assembly. Refer to your printer's specific service manual for instructions on how to safely open the unit.

2. **Locate the Motor Screws:** Identify the screws securing the drive motor. These screws typically allow the motor to be moved slightly to release tension on the belt.

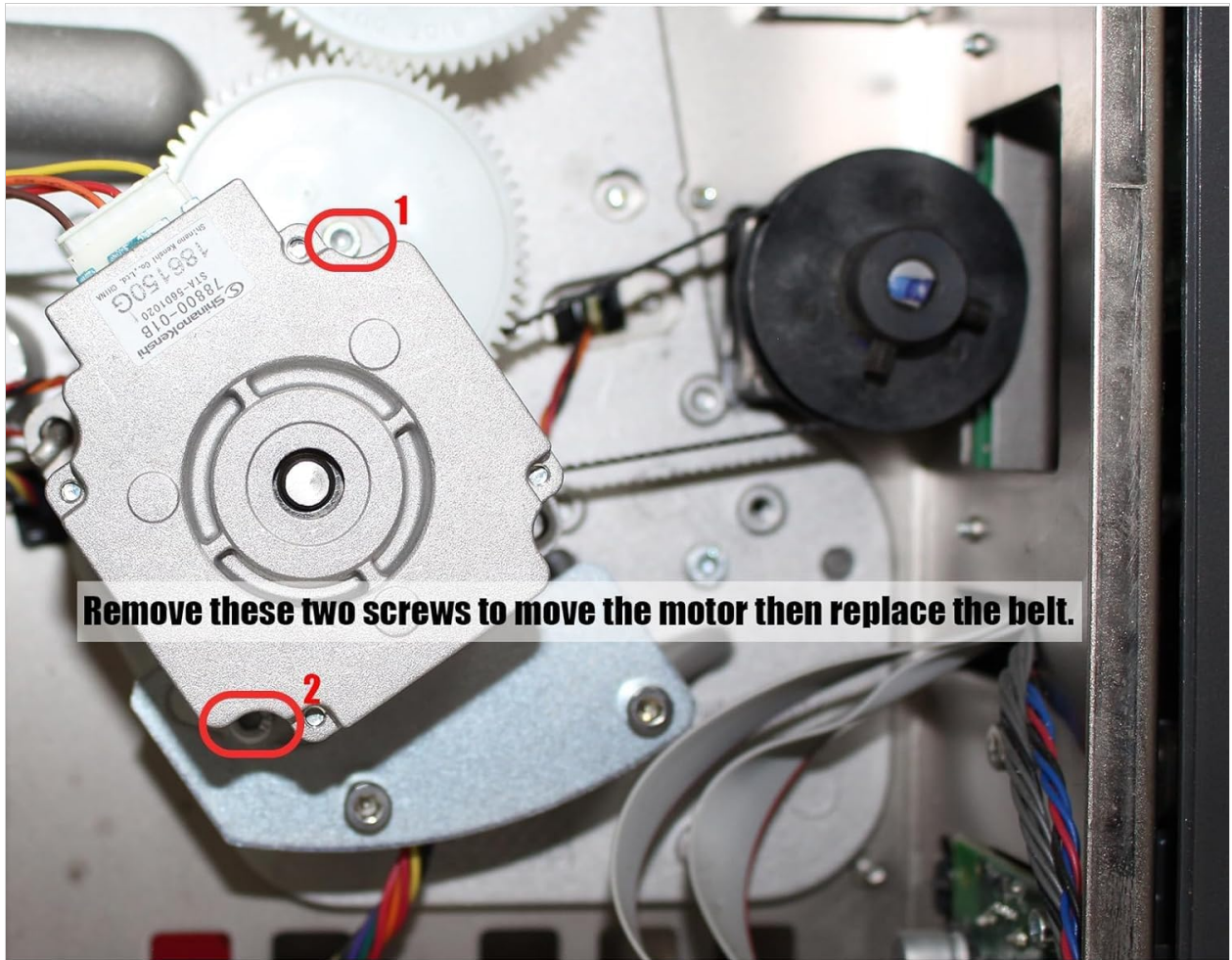

Image 2: View of the printer's internal drive mechanism. The two screws (circled in red and labeled 1 and 2) that need to be removed to adjust the motor position are highlighted. Removing these screws allows the motor to be moved, facilitating belt replacement.

3. **Remove Old Belt:** Loosen the identified screws to allow the motor to shift, reducing tension on the old belt. Carefully remove the worn or broken drive belt from the pulleys.
4. **Install New Belt:** Place the new PARTS 79866M drive belt onto the pulleys. Ensure it is seated correctly and evenly on both the motor pulley and the main drive pulley.

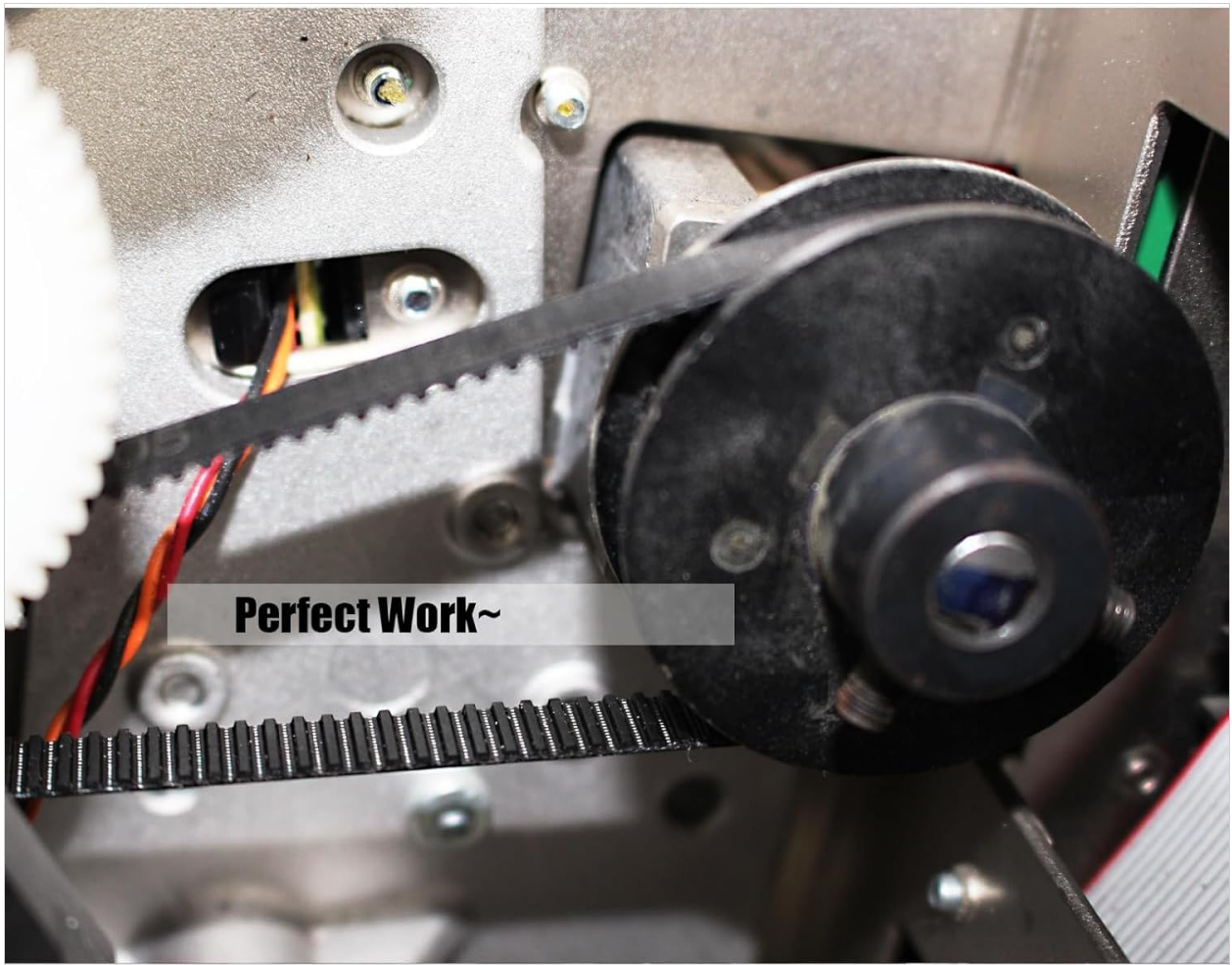

Image 3: The new drive belt correctly installed on the printer's pulleys, indicating proper tension and alignment for operation.

5. **Adjust Tension and Secure:** Once the new belt is in place, gently apply tension by adjusting the motor position. The belt should be taut but not overly tight. Tighten the motor screws securely.
6. **Reassemble Printer:** Carefully reassemble the printer casing, ensuring all connections are secure and no wires are pinched.
7. **Test Functionality:** Plug in and power on the printer. Perform a test print to confirm proper operation and label feeding.

3. OPERATING CONSIDERATIONS

The drive belt is an internal component that facilitates the movement of media within the printer. Once correctly installed, its operation is integral to the printer's normal function. No direct user interaction with the belt is required during printer operation.

3.1 Normal Operation

During printing, the drive belt transmits power from the motor to the print mechanism, ensuring consistent and accurate label feeding. A properly installed belt will operate quietly and without slippage.

4. MAINTENANCE

Regular maintenance of the drive belt is not typically required, as it is designed for long-term use. However, periodic inspection can help identify potential issues before they lead to printer malfunction.

4.1 Inspection

- **Visual Check:** Periodically, when the printer casing is open for other maintenance, visually inspect the drive belt for signs of wear, cracking, fraying, or stretching.
- **Tension Check:** Ensure the belt maintains appropriate tension. A loose belt can slip, while an overly tight belt can cause premature wear on the motor and pulleys.
- **Cleanliness:** Keep the area around the belt and pulleys free from dust, debris, or label adhesive residue, which can affect belt performance and lifespan.

4.2 Replacement

Replace the drive belt immediately if any signs of significant wear or damage are observed. Refer to the "Setup and Installation" section for replacement procedures.

5. TROUBLESHOOTING

If you experience issues with your printer's media feeding or printing quality, the drive belt could be a contributing factor. Here are some common troubleshooting steps related to the drive belt:

Problem	Possible Cause	Solution
Labels not feeding correctly or jamming	Loose or worn drive belt, debris on belt/pulleys	Inspect belt tension and condition. Clean belt and pulleys. Replace belt if worn.
Unusual noises from printer's drive area	Misaligned or damaged belt, foreign object interfering with belt	Power off and unplug. Inspect belt for damage or misalignment. Remove any obstructions.
Printer motor running but no media movement	Broken drive belt	Replace the drive belt.

If these steps do not resolve the issue, it may indicate a problem with other printer components or require professional service.

6. SPECIFICATIONS

Key specifications for the PARTS 79866M Main Drive Belt and its compatibility:

- **Part Number:** 79866M / 20006
- **Compatibility:** Zebra ZT410, ZT411, ZT420, ZT421 Thermal Label Printers (203 dpi models only)
- **Material:** Durable rubber composite
- **Color:** Black
- **GTIN (UPC):** 880670064379

Note: This belt is specifically designed for 203 dpi printer models and is not interchangeable with 300 dpi models.

7. WARRANTY AND SUPPORT

7.1 Product Warranty

This replacement belt comes with a 3-month warranty from the date of purchase, covering manufacturing defects. This warranty ensures that the product is free from defects in material and workmanship under normal use.

7.2 Return Policy

Customers may return the product within 30 days of purchase for a refund or replacement if the purchase is unsatisfactory for any reason. Please contact customer service for return authorization and instructions.

7.3 Customer Support

For any issues or questions regarding the PARTS 79866M Main Drive Belt, please contact the seller, getparts. They are committed to resolving any product-related concerns promptly.