

**Netac 788125333370**

# Netac 64 GB Micro SD Card User Manual

Model: 788125333370



## 1. INTRODUCTION

---

Thank you for choosing the Netac 64 GB Micro SD Card. This high-performance memory card is designed to provide reliable storage and fast data transfer for a wide range of digital devices. With A1, U3, C10, V30, and UHS-I speed ratings, it is ideal for 4K video recording, high-resolution photos, and quick application loading. This manual will guide you through the setup, operation, maintenance, and troubleshooting of your Micro SD card.



Image: The Netac 64 GB Micro SD Card, displaying its capacity and speed ratings (Micro SDXC I, A1, U3, V30).

## 2. SETUP

---

### 2.1 Initial Formatting

Upon first use, it is recommended to format the Micro SD card using your device's internal formatting function. This ensures optimal compatibility and performance. The card comes pre-formatted with exFAT for broad compatibility.

### 2.2 Inserting the Micro SD Card

Locate the Micro SD card slot on your device (smartphone, tablet, camera, drone, Nintendo Switch, etc.). Gently insert the card into the slot until it clicks into place. Ensure the card is inserted in the correct orientation to avoid damage.

# Ampliar la memoria

Con el lector de tarjetas USB, puede transferir datos en cualquier momento y lugar

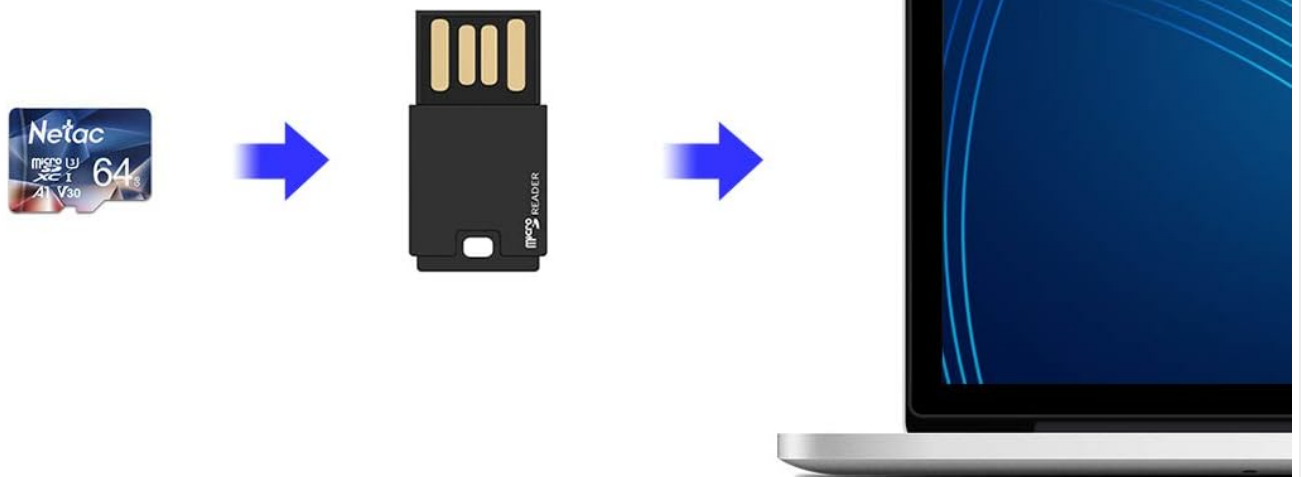

Con el adaptador, se puede utilizar como tarjeta de memoria SD

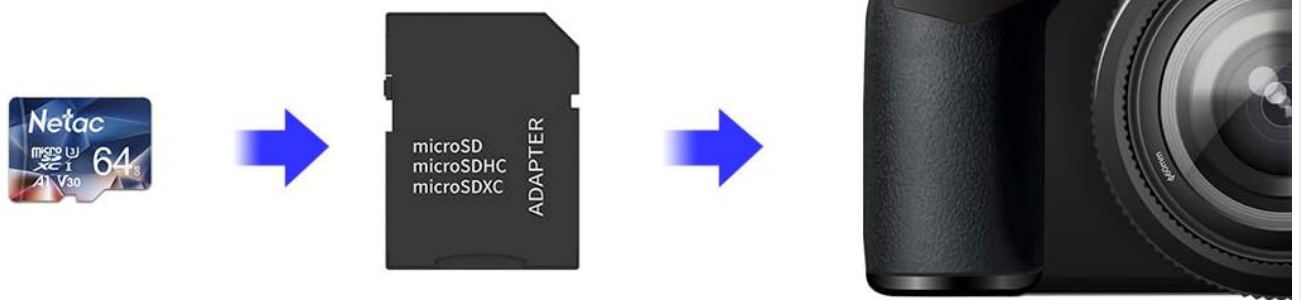

Image: The compact size of the Micro SD card, shown next to a laptop keyboard, illustrating its small form factor.

## 2.3 Using with an SD Adapter

Your Netac Micro SD card can be used with a standard SD card adapter (not included) to fit into devices with full-size SD card slots, such as DSLR cameras or laptops with SD card readers. Simply insert the Micro SD card into the adapter until it locks, then insert the adapter into your device.

# Compatible con dispositivo digital



Image: Diagrams showing how the Micro SD card can be used with a USB card reader for data transfer to a laptop, and with an SD adapter for use in a camera.

## 3. OPERATING THE MICRO SD CARD

### 3.1 Data Transfer Speeds

The Netac 64 GB Micro SD card features UHS-I interface with U3/V30 speed class, offering high-speed data transfer. Expect read speeds up to 100 MB/s and write speeds up to 30 MB/s. Actual performance may vary based on the host device, interface, usage conditions, and other factors.



Image: Visual representation of the card's read speeds up to 100MB/s and write speeds up to 30MB/s.

### 3.2 4K Video Recording

With its V30 speed class, this card is capable of recording Full HD and 4K Ultra HD video smoothly, ensuring no dropped frames during high-resolution video capture.

# Video 4K Ultra HD

Equipado con grados de velocidad de V30, puede grabar video full HD y video 4K ultra HD con fluidez

Velocidades de lectura de hasta **100 MB / s**  
Velocidades de escritura de hasta **30 MB / s**



Image: An illustration highlighting the card's capability to record Full HD and 4K Ultra HD video, with speed grades of V30.

## 3.3 A1-Rated Performance for Applications

The A1 performance rating ensures faster application loading. It provides a minimum random read performance of 1500 IOPS and random write performance of 500 IOPS, enhancing the experience when running apps directly from the card.

# Rendimiento de la APP de Clase 1

Para un rendimiento más rápido de la APP, el rendimiento mínimo de lectura/escritura aleatoria de hasta 1500/500 IOPS



Image: A visual demonstrating the A1 performance of the card, indicating faster application loading and smoother operation on compatible devices like tablets.

## 3.4 Wide Application Compatibility

This Micro SD card offers high compatibility with various digital devices, including:

- Smartphones and Android tablets
- Drones
- Action cameras and GoPro devices
- Nintendo Switch and other game consoles
- DSLR cameras and 4K/Full HD camcorders
- Laptops and desktop computers



Image: A collage of images showing the Micro SD card being used with various digital devices, including smartphones, car DVRs, cameras, surveillance systems, drones, and GoPro cameras, highlighting its broad compatibility.

### 3.5 Storage Capacity Overview

The 64GB capacity provides ample space for your digital content. Refer to the table below for estimated storage capacities for different media types:

# Capacidad súper grande

Proporciona una variedad de capacidades, elija la capacidad adecuada para cada demanda para memorizar lo que quiera.







	 Video Full HD 1080P	 Video HD 720P	 Fotos	 Música
16GB	2 hrs	3 hrs	3500	1500
32GB	4 hrs	6 hrs	7000	3000
64GB	8.5 hrs	11.5 hrs	14000	6000
128GB	17 hrs	23 hrs	27500	11500
256GB	34 hrs	46 hrs	55000	23000
512GB	68 hrs	92 hrs	110000	46000

Image: A table illustrating the estimated storage capacity for different Micro SD card sizes (16GB to 512GB) in terms of Full HD video (1080P), HD video (720P), photos, and music.

## 4. MAINTENANCE AND DURABILITY

The Netac Micro SD card is built for reliability and durability, designed to withstand various challenging environments. To ensure its longevity, handle the card with care, avoiding excessive force during insertion or removal.

### 4.1 Robust Design Features

The card is engineered with multiple protective features:

- **Waterproof:** Resistant to water immersion (IPX7 rated).
- **Temperature Proof:** Operates reliably in extreme temperatures, from -25°C to 85°C.
- **Shockproof:** Designed to withstand impacts and drops.
- **X-Ray Proof:** Safe from airport X-ray scanners, ensuring data integrity during travel.
- **Magnetic Proof:** Protected against magnetic fields.

## Se adapta a varios entornos

No se preocupe por no poder usarlo tras mojarlo o tras un control de seguridad



Resistencia al  
agua IPX7



A prueba de  
rayos X



A prueba de  
choques



Temperatura

Image: An illustration showing the Micro SD card's resilience in various environments, highlighting its waterproof, X-ray proof, shockproof, and temperature resistant properties.

## 5. TROUBLESHOOTING

## 5.1 Card Not Recognized

- Ensure the card is fully and correctly inserted into the device slot.
- Try inserting the card into another compatible device to check if the issue is with the card or the device.
- If using an adapter, ensure the Micro SD card is properly seated within the adapter and the adapter is not damaged.
- Reboot your device.

## 5.2 Slow Performance

- Ensure your device supports UHS-I speeds. Older devices may not utilize the full speed potential of the card.
- Check if the card is nearly full. Performance can degrade when storage is almost exhausted.
- Avoid running too many applications simultaneously from the card.
- Reformat the card (after backing up data) if performance issues persist.

## 5.3 Data Corruption

- Always safely eject or unmount the card from your device before physically removing it.
- Avoid removing the card during data transfer or recording.
- If data corruption occurs frequently, consider backing up your data and reformatting the card. If the issue persists, the card may be faulty.

# 6. SPECIFICATIONS

Feature	Description
Brand	Netac
Model Number	788125333370
Digital Storage Capacity	64 GB
Flash Memory Type	Micro SDXC
Hardware Interface	microSDXC
Read Speed	Up to 100 MB/s
Write Speed	Up to 30 MB/s
SD Transfer Speed Class	Class 10
Speed Class	U3, V30, A1
Special Features	Magnetic resistant, Waterproof, Drop resistant, Anti-magnetic, Shock resistant, Heat resistant, Extreme temperature resistant, X-ray resistant
Product Dimensions	12.3L x 9W cm (approximate packaging dimensions)
Item Weight	10 g

# 7. WARRANTY AND SUPPORT

---

Netac offers a 30-day money-back guarantee for this product. The product also comes with a limited warranty, ensuring its quality and performance. For any issues not covered in this manual or for warranty claims, please contact Netac customer support through the official channels where you purchased the product.

