

## FOXWELL NT624 Elite

# FOXWELL NT624 Elite OBD2 Scanner User Manual

Model: NT624 Elite

## 1. INTRODUCTION

The FOXWELL NT624 Elite OBD2 Scanner is a professional diagnostic tool designed to assist in identifying and resolving vehicle issues. This manual provides detailed instructions for the setup, operation, maintenance, and troubleshooting of your device.



Image 1.1: The FOXWELL NT624 Elite OBD2 Scanner main unit, showing its display and control buttons.

## 2. WHAT'S IN THE BOX

Upon opening the package, verify that all components are present:

- 1x NT624 Elite Tool
- 1x Diagnostic Cable
- 1x Carrying Case
- 1x Quick Start Guide
- 1x User Manual
- 1x 16G Memory Card (pre-installed or separate)
- 1x USB Mini Cable



Image 2.1: All items included in the FOXWELL NT624 Elite package, laid out for inspection.

## 3. SETUP

### 3.1 Initial Power-Up

1. Connect the diagnostic cable to the NT624 Elite tool.
2. Locate your vehicle's OBD2 port, typically under the dashboard on the driver's side.
3. Plug the diagnostic cable into the vehicle's OBD2 port.
4. Turn the vehicle's ignition to the 'ON' position (engine off). The scanner should power on automatically.

### 3.2 Software Update

The NT624 Elite supports lifetime free software updates via Wi-Fi. Regular updates ensure compatibility with new vehicle models and improved functionality.

1. From the main menu, navigate to the 'Update' option.
2. Select 'WiFi' and connect to an available wireless network.



3. The system will check for available updates. Select the software packages you wish to update.
4. Follow the on-screen prompts to download and install the updates. Ensure a stable internet connection throughout the process.

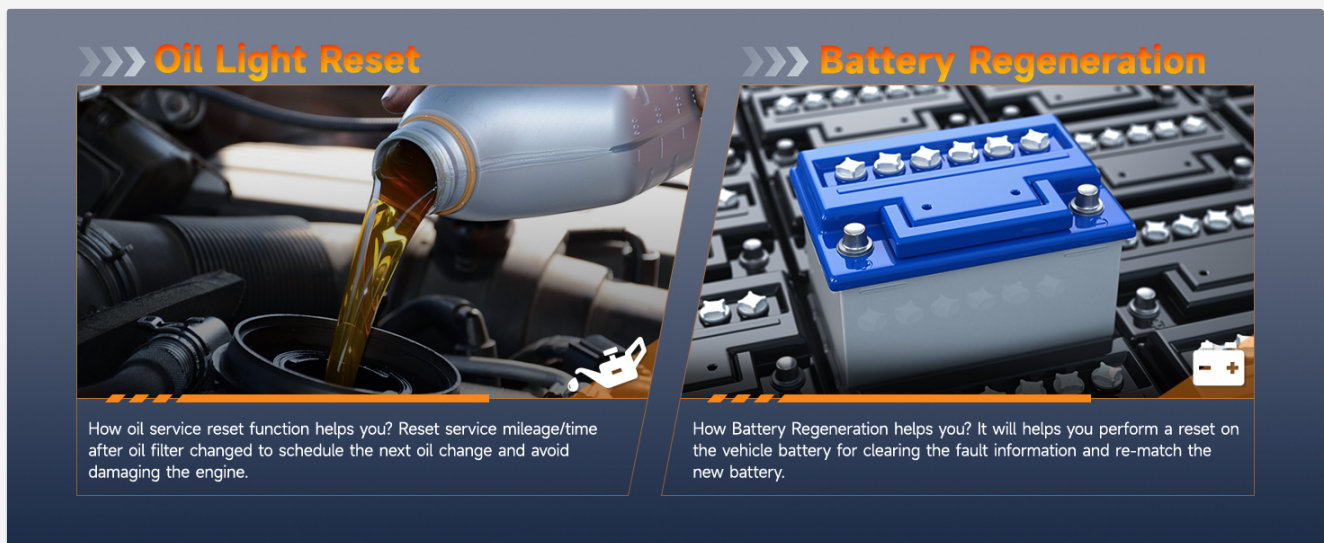

Image 3.1: Visual guide illustrating the Wi-Fi update process for the NT624 Elite scanner.

## 4. OPERATING INSTRUCTIONS

### 4.1 Vehicle Connection and Identification

1. Ensure the scanner is properly connected to the vehicle's OBD2 port and powered on.
2. From the main menu, select 'Diagnostic' or 'Auto Vin'.
3. The 'Auto Vin' function automatically identifies the vehicle's VIN (Vehicle Identification Number) for quick setup. If Auto Vin fails, you may need to manually select the vehicle make, model, and year.

### BATTERY HEALTH CHECK

Battery Test for checking your car battery's voltage in real time

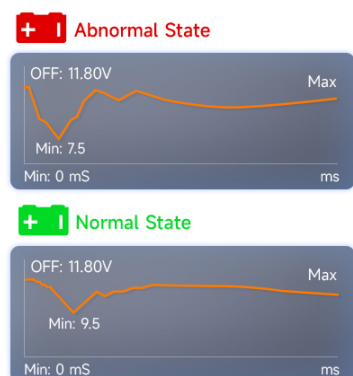
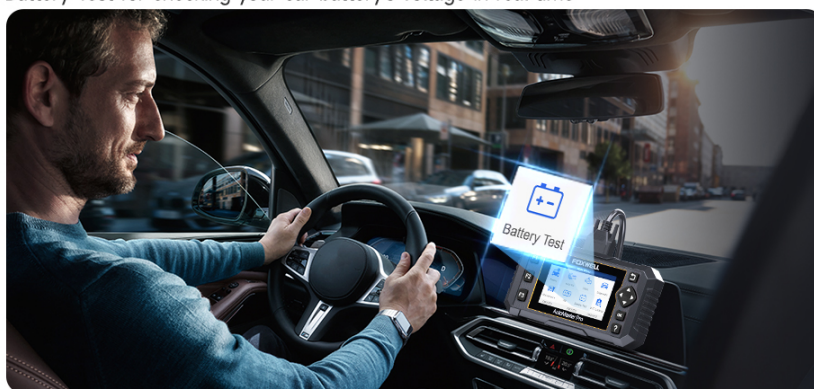

Image 4.1: The Auto VIN feature streamlines vehicle identification by automatically reading the VIN.

### 4.2 All System Diagnosis

The NT624 Elite can perform comprehensive diagnostics on all available electronic systems in your vehicle, including:

- Engine
- Transmission

- ABS (Anti-lock Braking System)
- SRS (Supplemental Restraint System/Airbag)
- EPB (Electronic Parking Brake)
- SAS (Steering Angle Sensor)
- ESP (Electronic Stability Program)
- Suspension
- Headlamp
- Car Radio
- Center Lock
- And more, depending on the vehicle model.

To perform an all-system scan, select 'Diagnostic' from the main menu and choose 'Auto Scan' or manually select the desired system.



Image 4.2: The NT624 Elite performing an all-system diagnostic scan on a vehicle.

### 4.3 Basic OBD2 Functions



The scanner supports all 10 OBD2 test modes for vehicles manufactured after 1996:

- **Read DTCs:** Retrieves generic (P0, P2, P3, and U0) and manufacturer specific (P1, P3, and U1) codes.
- **Clear DTCs:** Clears diagnostic trouble codes and resets monitors.
- **Live Data:** Displays real-time data stream from the vehicle's sensors.
- **Freeze Frame:** Stores a snapshot of operating conditions at the time of an emission-related fault.
- **I/M Readiness:** Checks the readiness of the emission monitoring system.
- **O2 Sensor Test:** Retrieves O2 sensor monitor test results.
- **On-Board Monitor Test:** Retrieves results for emission-related powertrain components and systems.
- **EVAP Test:** Initiates a test of the Evaporative Emission System.
- **Read VIN:** Retrieves vehicle identification information.
- **DTC Lookup:** Provides definitions for diagnostic trouble codes.



Image 4.3: Overview of enhanced full OBD2 functions, including reading and clearing DTCs, live data, and I/M readiness.

## 4.4 Special Functions (8 Reset Services)

The NT624 Elite offers 8 commonly used maintenance reset functions:

- **ABS Bleeding:** Bleeds air from the brake system after component replacement.
- **Oil Reset:** Resets the oil service light and calculates optimal oil life change interval.
- **Injector Coding:** Rewrites injector codes to the ECU after replacement for accurate fuel delivery.
- **Battery Registration (BRT):** Registers a new battery to the vehicle's ECU.
- **DPF Regeneration:** Performs the DPF cleaning process to clear blockages.
- **SAS Calibration:** Calibrates the steering angle sensor after steering component replacement.
- **Throttle Matching (TPS):** Initializes the throttle actuators to the default state.
- **EPB Reset:** Deactivates and reactivates the brake control system, bleeds brake fluid, opens and closes brake pads, and sets brakes after disc or pad replacement.

# 8 HOT SERVICES



**D-P-F  
Regeneration**



**Injector Coding**



**Battery  
Registration**



**ABS Bleeding**



**SAS Calibration**



**Throttle Matching**



**EPB Reset**

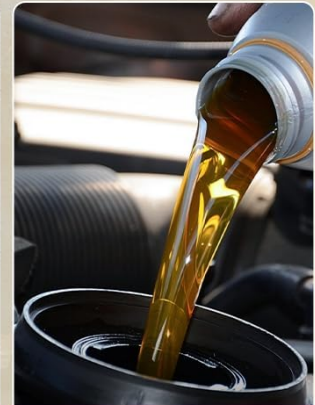

**Oil Reset**

Image 4.4: Visual representation of the 8 hot services available on the NT624 Elite.

## 4.5 Battery Health Check

The NT624 Elite includes a battery test function to check your car's battery voltage in real-time, helping to identify abnormal states.



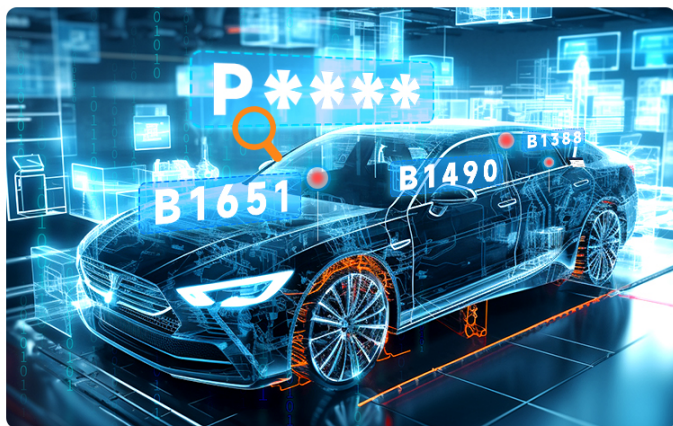

## Built-in DTC Library

Search fault codes and the definitions of them will be shown for you

Trouble Codes		
ID	Status	Description
B1651	Active	Crash recorded in driversideairbag (Replace SRS/SCM)
B1490	History	OCS(Occupantclassification system) defet
B1388	Active	STP5(Seat track positonsensor)-Driver open orshort to battery

Save(F1) Freeze Frame(F2)

Image 4.5: The battery health check feature displays real-time voltage readings to assess battery condition.

## 4.6 Data Display and Report Printing

The scanner provides an intuitive view of data streams in single, multi-graph, or merged two-graph formats. After diagnosis, a vehicle health report can be recorded, played back for analysis, and printed via a PC.

## OE-EMINENT-LEVEL ALL SYSTEM DIAGNOSIS



Image 4.6: The scanner's display showing comprehensive live data for vehicle conditions.

## 5. MAINTENANCE

### 5.1 Software Updates

As detailed in Section 3.2, regularly update your NT624 Elite software via Wi-Fi to ensure optimal performance and access to the latest vehicle data and functions. This process is free for the lifetime of the device.

### 5.2 Device Care

- Keep the device clean and free from dust and moisture.
- Store the scanner in its protective carrying case when not in use.
- Avoid extreme temperatures.
- Do not attempt to disassemble the device, as this will void the warranty.



## 6. TROUBLESHOOTING

If you encounter issues with your NT624 Elite, refer to the following common problems and solutions:

Problem	Possible Cause	Solution
Device does not power on.	Loose OBD2 connection, vehicle ignition off, faulty cable.	Ensure cable is securely connected. Turn ignition to 'ON'. Test with another vehicle if possible. Check cable for damage.
Cannot connect to vehicle ECU.	Incorrect vehicle protocol, damaged OBD2 port, software issue.	Verify vehicle compatibility. Ensure software is updated. Try manual vehicle selection.
Software update fails or device freezes during update.	Unstable Wi-Fi connection, insufficient storage, server issues.	Ensure strong, stable Wi-Fi. Check available memory. Try updating at a different time. Contact support if persistent.
Slow operation or delayed responses.	Large data processing, older software version.	Ensure software is up to date. Some complex operations may naturally take longer.

If the problem persists, please contact FOXWELL technical support.

## 7. SPECIFICATIONS

- **Model:** NT624 Elite
- **Manufacturer:** FOXWELL
- **Item Weight:** 1 pound
- **Product Dimensions:** 7.87 x 4.33 x 1.18 inches (L x W x H)
- **Operating System:** Windows 10 (internal software environment)
- **Display:** 4.3-inch Color Screen
- **Connectivity:** OBD2, USB, Wi-Fi (2.4G)
- **Supported Protocols:** All OBD2 protocols
- **Vehicle Coverage:** Supports 10,000+ cars worldwide, all OBD2 testing for cars after 1996. Compatible with major American, European, and Asian brands.

## FANTASTIC AUTO VIN



Image 7.1: Geographic representation of the FOXWELL NT624 Elite's wide vehicle compatibility.

## 8. WARRANTY AND SUPPORT

FOXWELL provides comprehensive support for the NT624 Elite OBD2 Scanner:

- **Warranty:** 2-Year Exchange policy.
- **Technical Support:** Lifetime technical support is available.
- **Software Updates:** Lifetime free Wi-Fi software updates.

For technical assistance or warranty claims, please refer to the contact information provided in your Quick Start Guide or visit the official FOXWELL website.

### ENHANCED FULL OBD2 FUNCTIONS FOR ALL CARS

Covering all functions of basic code reader with more advanced features



Read DTCs



Clear DTCs



Live Data



Freeze Frame



I/M Readiness



O2 Sensor Test



On-Board Monitor Test



Read VIN



Vehicle Data Record



Evap Test



Image 8.1: Overview of FOXWELL's customer support and warranty commitments.

© 2025 FOXWELL. All rights reserved.

FOXWELL is committed to innovation and technology in automotive diagnostics.

### Related Documents - NT624 Elite

<div><p><small>Trademarks: FOXWELL is a trademark of Foxwell Cloud Technology Co., Ltd. All other marks are the property of their respective owners. Copyright © 2025 Foxwell Cloud Technology Co., Ltd. All rights reserved. FOXWELL The information, specifications and features in this manual are subject to the description of the product. FOXWELL reserves the right to change the design of the product without notice. This user manual is for reference only. For technical assistance, please contact us at <a href="mailto:sales@foxwell.com">sales@foxwell.com</a>.</small></p></div>	<div><p><a href="#">FOXWELL NT650Elite Multi-Application Service Tool Manual - User Guide and Diagnostics</a></p><p>User manual for the FOXWELL NT650Elite Multi-Application Service Tool. This guide details safety, operation, diagnostics (ABS, SRS), maintenance (DPF, EPB, BRT), and update procedures for automotive professionals.</p></div>
--	---





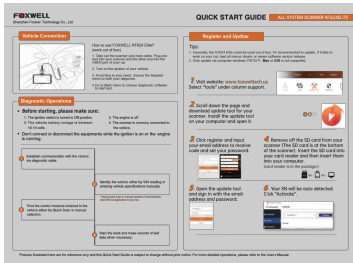

### [Foxwell NT624Elite All-System Scanner Quick Start Guide](#)

A concise guide to setting up, registering, and using the Foxwell NT624Elite all-system car diagnostic scanner, including troubleshooting tips and support information.

lang:en **score:47** filesize: 1.25 M page\_count: 2 document date: 2022-06-22

Product Comparison	FOXWELL	LAUNCH	PEAK	LAUNCH	LAUNCH	AUTEL
Model	NT624 Elite	CRP129X I/E	CRP129X I/E	CRP129X I/E	CRP129X I/E	CRP129X I/E
Release Date	2021.02	2021.02	2021.02	2021.02	2021.02	2021.02
Supported Data	All major car data	All major car data	All major car data	All major car data	All major car data	All major car data
Supported Diagnostic System	All Diagnostic System	All Diagnostic System	All Diagnostic System	All Diagnostic System	All Diagnostic System	All Diagnostic System
Support & Maintenance	24h Online Service	24h Online Service	24h Online Service	24h Online Service	24h Online Service	24h Online Service
Product Information	24h Online Service	24h Online Service	24h Online Service	24h Online Service	24h Online Service	24h Online Service
Product Features	24h Online Service	24h Online Service	24h Online Service	24h Online Service	24h Online Service	24h Online Service
Product Price	24h Online Service	24h Online Service	24h Online Service	24h Online Service	24h Online Service	24h Online Service

### [Car Diagnostic Scan Tool Comparison: FOXWELL, LAUNCH, AUTEL](#)

Compare key features, supported systems, and maintenance functions of automotive diagnostic scan tools from FOXWELL (NT624 Elite, NT726, NT809), LAUNCH (CRP129X I/E, CRP909/E/X), and AUTEL (MK808).

lang:it **score:43** filesize: 265.37 K page\_count: 1 document date: 2021-09-17



### [FOXWELL NT6X4Elite Series User Manual: Diagnostics & Maintenance Guide](#)

Comprehensive user manual for the FOXWELL NT6X4Elite Series diagnostic scanner. Covers safety instructions, setup, vehicle identification, diagnostic operations, maintenance procedures, system setup, and software updates for automotive technicians and enthusiasts.

lang:en **score:34** filesize: 4.81 M page\_count: 49 document date: 2022-09-07



### [\[pdf\] User Manual Specifications Warranty](#)

Trademarks Joe Young User Manual Amazon FOXWELL Car Scanner NT604 Elite OBD2 ABS SRS Transmission Check Engine Code Reader Diagnostic Scan Tool with Airbag for All Cars Automotive C1hVAPjZtjL m media amazon images I |||

Trademarks FOXWELL is the trademark of Shenzhen Foxwell Technology Co., Ltd. All other marks are tra ... ive Data Screen 26 NT6X4Elite Series User s Manual\_English\_V1.02 Maintenance NOTE NT614 Elite and NT624 Elite support Oil Light Reset and EPB Service; NT644 Elite supports all of the following servi...

lang:en **score:33** filesize: 5.27 M page\_count: 50 document date: 2019-10-09

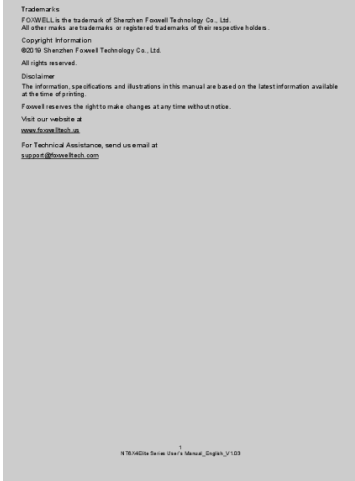

[\[pdf\] User Manual Specifications Warranty](#)

Trademarks Joe Young NT634 Series User s Manual English V1 03 processing contact your local FOXWELL distributor or visit our website foxwelltech us to get further information usa guigu public oss west 1 aliyuncs WEB article attach product 20200514171746 is the trademark of Shenzhen Foxwell Technology Co Ltd All other marks are trademarks registered tradem ||| Trademarks FOXWELL is the trademark of Shenzhen Foxwell Technology Co., Ltd. All other marks are tra ... ive Data Screen 26 NT6X4Elite Series User s Manual\_English\_V1.03 Maintenance NOTE NT614 Elite and NT624 Elite support Oil Light Reset and EPB Service; NT644 Elite and NT634 supports all of the follo... lang:en score:33 filesize: 6.06 M page\_count: 50 document date: 2019-11-19

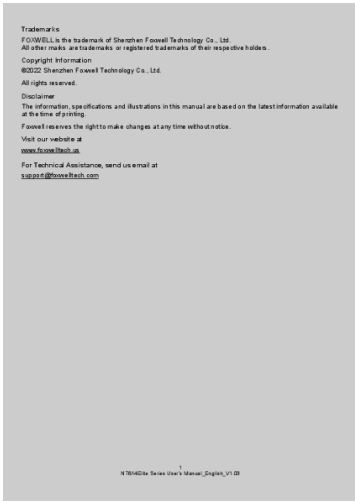

[FOXWELL NT6X4Elite Series User's Manual - Automotive Diagnostic Tool](#)

Comprehensive user manual for the FOXWELL NT6X4Elite Series automotive diagnostic scanner. Learn how to perform vehicle diagnostics, maintenance services, and software updates with detailed instructions and safety guidelines. lang:en score:32 filesize: 4.76 M page\_count: 48 document date: 2022-12-12



[Foxwell 4.3" Series User's Manual](#)

This user manual provides comprehensive instructions for the Foxwell 4.3" Series diagnostic tool, covering setup, operation, maintenance, and troubleshooting. Learn how to identify vehicles, perform diagnostic operations, and utilize various maintenance functions. lang:en score:30 filesize: 2.7 M page\_count: 40 document date: 2025-06-18



[pdf] User Manual Specifications Warranty

Trademarks Joe Young NT644Elite Series User s Manual English V1 02 usa guigu public oss us west 1 aliynuncs WEB article attach product 20220121152905 |||

Trademarks FOXWELL is the trademark of Shenzhen Foxwell Technology Co., Ltd. All other marks are tra ... ive Data Screen 27 NT6X4Elite Series User s Manual\_ English\_ V1.02 Maintenance NOTE NT614 Elite and NT624 Elite support Oil Light Reset and EPB Service; NT644 Elite supports all of the following servi... lang:en score:29 filesize: 2.78 M page\_count: 51 document date: 2022-01-19



[pdf] User Manual Specifications Warranty

Trademarks Joe Young user manual Shenzhen Foxwell Technology Co Ltd 2843L1123 AUTOMOTIVE DIAGNOSTIC PLATFORM 2AXCX 2AXCX2843L1123 2843I1123

Trademarks FOXWELL is the trademark of Shenzhen Foxwell Technology Co., Ltd. All other marks are tra ... I\_ English\_ V 1 . 0 3 Maintenance NOTE NT614 Elite support BLEEDING EPB OILRESET SAS TPS NT624 Elite support BLEEDING BRT DPF EPB INJECTOR OILRESET SAS TPS/TBA NT644 Elite and NT... lang:en score:29 filesize: 1.23 M page\_count: 45 document date: 2023-12-11

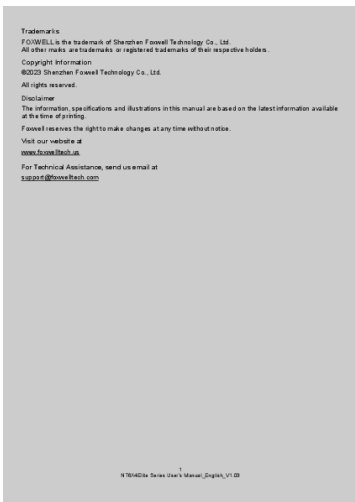

[pdf] User Manual Specifications Warranty

Trademarks Joe Young User manual FOXWELL NT650 PRO2025 PRO OBD2 Scanner 25 Reset Service Airbag OBDII VS EliteCode Reader Active Test Diagnostic Tool

PROS4ed96d5639dc44eea2b8c5054285a943Nae01 alicdn kf S4ed96d5639dc44eea2b8c5054285a943N |||

Trademarks FOXWELL is the trademark of Shenzhen Foxwell Technology Co., Ltd. All other marks are tra ... Manual\_English\_V1.03 Maintenance NOTE NT614 Elite support BLEEDING EPB OILRESET SAS TPS NT624 Elite support BLEEDING BRT DPF EPB INJECTOR OILRESET SAS TPS/TBA NT644 Elite and NT... lang:en score:29 filesize: 3.12 M page\_count: 44 document date: 2023-11-07





[Foxwell NT6X4Elite Series User's Manual: Operation and Maintenance Guide](#)

Comprehensive user manual for the Foxwell NT6X4Elite Series diagnostic scanner, covering setup, vehicle identification, diagnostic operations, maintenance procedures, system setup, updates, and uninstallation.

lang:en score:28 filesize: 3.03 M page\_count: 38 document date: 2024-11-11



[FOXWELL NT6X4Elite Series User Manual: Automotive Diagnostic Scan Tool Guide](#)

Comprehensive user manual for the FOXWELL NT6X4Elite Series automotive diagnostic scan tool. Learn about vehicle identification, DTC reading, live data, maintenance functions, and software updates. Get expert diagnostic capabilities.

lang:en score:27 filesize: 5.23 M page\_count: 47 document date: 2019-09-19

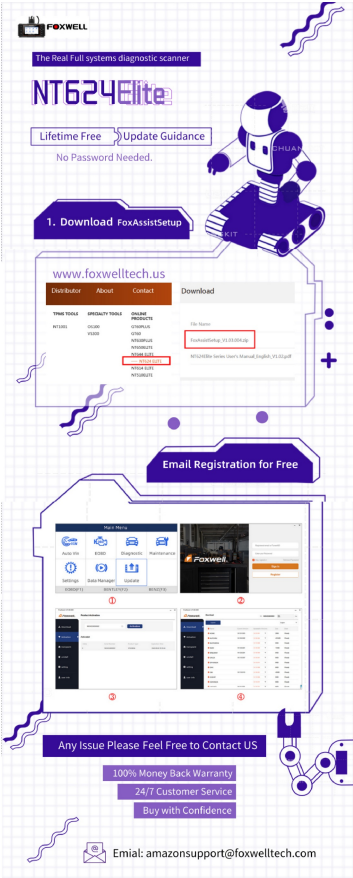

[\[pdf\] User Manual](#)

2022 Newest FOXWELL OBD2 Scanner NT624 Elite Car Diagnostic All Systems with ABS Bleeding SAS Calibration Throttle Reset Oil EPB Add New Features Via Software Update NT624 elite Installation Manual FOXWELL 91N2dVQI7QL m media amazon images I |||

lang:en score:26 filesize: 792.8 K page\_count: 1 document date: 2019-10-17

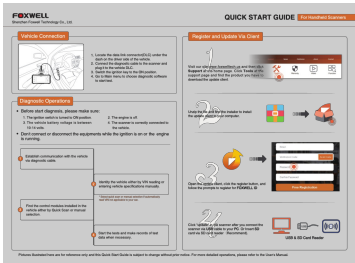

[pdf] Guide

NT624 elite 2022 Newest FOXWELL OBD2 Scanner Elite Car Diagnostic All Systems with ABS Bleeding  
SAS Calibration Throttle Reset Oil EPB Add New Features Via Software Update NT624 User Guide  
FOXWELL C1ELUf mydS m media amazon images I |||

...  
lang:en score:25 filesize: 4.87 M page\_count: 2 document date: 2021-08-24



[pdf] User Manual Specifications Warranty

Trademarks Joe Young NT634Elite Series User s Manual English V2 03 usa guigu public oss us west 1  
aliyuncs WEB article attach product 20230802174110 |||

Trademarks FOXWELL is the trademark of Shenzhen Foxwell Technology Co., Ltd.  
All other marks are tra ... Manual\_English\_V1.03 Maintenance NOTE NT614 Elite  
support BLEEDING EPB OILRESET SAS TPS NT624 Elite support BLEEDING BRT  
DPF EPB INJECTOR OILRESET SAS TPS/TBA NT644 Elite and NT...

lang:en score:24 filesize: 4 M page\_count: 48 document date: 2023-08-02

Model/Specification	FOXWELL	LAUNCH	FOXWELL	FOXWELL	LAUNCH	Autel
Model	NT624	CRP129X	NT624	NT624	CRP129X	Autel
Value	2022	2022	2022	2022	2022	2022
Supported Cars	All major European, American, Asian, and Australian cars	All major European, American, Asian, and Australian cars	All major European, American, Asian, and Australian cars	All major European, American, Asian, and Australian cars	All major European, American, Asian, and Australian cars	All major European, American, Asian, and Australian cars
Supported Systems	Engine, ABS, SRS, Transmission, Steering, Suspension, Brakes, etc.	Engine, ABS, SRS, Transmission, Steering, Suspension, Brakes, etc.	Engine, ABS, SRS, Transmission, Steering, Suspension, Brakes, etc.	Engine, ABS, SRS, Transmission, Steering, Suspension, Brakes, etc.	Engine, ABS, SRS, Transmission, Steering, Suspension, Brakes, etc.	Engine, ABS, SRS, Transmission, Steering, Suspension, Brakes, etc.
Services & Maintenance Functions (Exhausted)	Oil Reset, EPB, SAS, Throttle Reset, etc.	Oil Reset, EPB, SAS, Throttle Reset, etc.	Oil Reset, EPB, SAS, Throttle Reset, etc.	Oil Reset, EPB, SAS, Throttle Reset, etc.	Oil Reset, EPB, SAS, Throttle Reset, etc.	Oil Reset, EPB, SAS, Throttle Reset, etc.
Full OBD2 Functions	Y	Y	Y	Y	Y	Y
Bluetooth	Y	Y	Y	Y	Y	Y
One-Button EPC Reset	Y	Y	Y	Y	Y	Y
Vehicle Information	Y	Y	Y	Y	Y	Y
Power Operation	Y	Y	Y	Y	Y	Y
Screen Display	10.1 inch	10.1 inch	10.1 inch	10.1 inch	10.1 inch	10.1 inch

Automotive Diagnostic Tool Comparison: FOXWELL, LAUNCH, Autel Models

Compare key features, models, pricing, and supported systems of automotive diagnostic tools from FOXWELL, LAUNCH, and Autel, including NT614 Elite, CRP129X, NT634, NT624 Elite, CRP429, and MK808.

lang:en score:24 filesize: 289.96 K page\_count: 1 document date: 2020-03-20