

Contixo VD-1

XODO VD1 Smart Home Wireless Security Camera User Manual

Model: VD-1 | Brand: Contixo

PRODUCT OVERVIEW

The XODO VD1 Smart Home Wireless Security Camera is a versatile video doorbell designed to enhance your home security. It features 1080P Full HD video, a wide 166-degree viewing angle, and infrared night vision for clear monitoring day and night. Equipped with a PIR motion sensor, it detects activity up to 25 feet away, sending real-time alerts to your smartphone.

Key features include two-way audio with noise canceling, allowing seamless communication with visitors. The device is wire-free, powered by two 2600mAh rechargeable batteries (total 5200mAh), and connects via 2.4G WiFi. Its IP53 weather-resistant design ensures reliable performance in various outdoor conditions. Setup is straightforward using the free XODO Smart App, with no monthly fees for basic functionality.



Image: The XODO VD1 Smart Video Doorbell, accompanied by its wireless chime unit and a 32GB Contixo SD card, showcasing the complete product package.

WiFi 1080P Video Doorbell



WiFi
(2.4GHz)



Two-Way
Audio



PIR Motion
Detection



Night
Vision



Battery
Powered



Cloud
Storage



166°Wide
Angle



Real Time
Video



Image: The XODO VD1 Video Doorbell highlighting its main features: WiFi (2.4GHz), Two-Way Audio, PIR Motion Detection, Night Vision, Battery Powered, Cloud Storage, 166° Wide Angle, and Real-Time Video capabilities.

PACKAGE CONTENTS

- XODO VD1 Smart Video Doorbell
- Wireless Chime Unit
- Mounting Bracket
- Mounting Screws and Anchors
- USB Charging Cable
- User Manual (this document)
- (Optional) MicroSD Card (if included with purchase)

COMPONENT IDENTIFICATION

Ready For Any Weather



Image: Detailed front and back views of the XODO VD1 Smart Video Doorbell, labeling key components such as the Light Sensor, Infra-Red LED, Video Camera Lens, Reset Button, PIR Motion Detector, Microphone, Micro USB Port, SD Card Port, and Main Button.

- **Light Sensor:** Detects ambient light for automatic day/night mode switching.
- **Infra-Red LED:** Provides illumination for night vision.
- **Video Camera Lens:** Captures 1080P HD video with a 166° wide angle.
- **Reset Button:** Used to reset the device to factory settings.
- **PIR Motion Detector:** Passive Infrared sensor for detecting motion.
- **Microphone:** Captures audio for two-way communication.
- **Main Button:** The doorbell button pressed by visitors.
- **Micro USB Port:** For charging the doorbell's internal batteries.
- **SD Card Port:** Slot for inserting a MicroSD card for local video storage.

1. Initial Charging

Before first use, fully charge the doorbell. Connect the provided USB charging cable to the Micro USB port on the back of the doorbell and to a standard USB power adapter (not included). The charging indicator light will show charging status (refer to app for battery percentage).

2. App Download and Account Registration

Download the free **XODO Smart App** from the Apple App Store (for iOS devices) or Google Play Store (for Android devices). Once installed, open the app and follow the on-screen instructions to register a new account or log in if you already have one.

Note: The XODO Smart App is required for full functionality and setup.

3. Connecting to Wi-Fi

1. Ensure your smartphone is connected to a **2.4GHz Wi-Fi network**. The doorbell does not support 5GHz Wi-Fi.
2. In the XODO Smart App, select "Add Device" or the "+" icon to add a new device.
3. Choose "Video Doorbell" from the device list.
4. Follow the app's prompts to enter your Wi-Fi network name (SSID) and password.
5. The app will generate a QR code. Hold your doorbell camera lens approximately 4-8 inches (10-20 cm) in front of your phone's screen, allowing the doorbell to scan the QR code. You will hear a confirmation sound when the scan is successful.
6. The doorbell will then attempt to connect to your Wi-Fi network. Once connected, the app will confirm successful pairing.

4. Pairing the Wireless Chime

To pair the wireless chime with your doorbell:

1. Plug the chime unit into a power outlet.
2. Press and hold the pairing button on the chime unit for approximately 3 seconds until an indicator light flashes.
3. Immediately press the main button on the doorbell. The chime will ring, indicating successful pairing.
4. You can select different chime melodies and adjust volume through the chime unit's buttons.

5. Physical Installation



Image: A visual guide demonstrating the three easy steps for installing the XODO VD1 doorbell: 1) Install the Mounting Bracket, 2) Install the doorbell onto the bracket, and 3) Tighten the security screw at the bottom.

1. **Choose a Location:** Select a suitable location near your front door, ensuring good Wi-Fi signal strength.
2. **Install Mounting Bracket:** Use the provided screws and anchors to securely attach the mounting bracket to your wall or door frame.
3. **Attach Doorbell:** Slide the doorbell unit onto the installed mounting bracket from top to bottom until it clicks into place.
4. **Secure with Screw:** Tighten the small security screw located at the bottom of the doorbell to prevent easy removal.

OPERATING INSTRUCTIONS

Live View and Two-Way Audio

From the XODO Smart App, you can access a live video feed from your doorbell at any time. When a visitor presses the doorbell or motion is detected, you will receive a notification on your smartphone. Tap the notification to enter the live view.

VIDEO CALLS

You can check who is at your door anytime of the day or night with Audio and Video features.

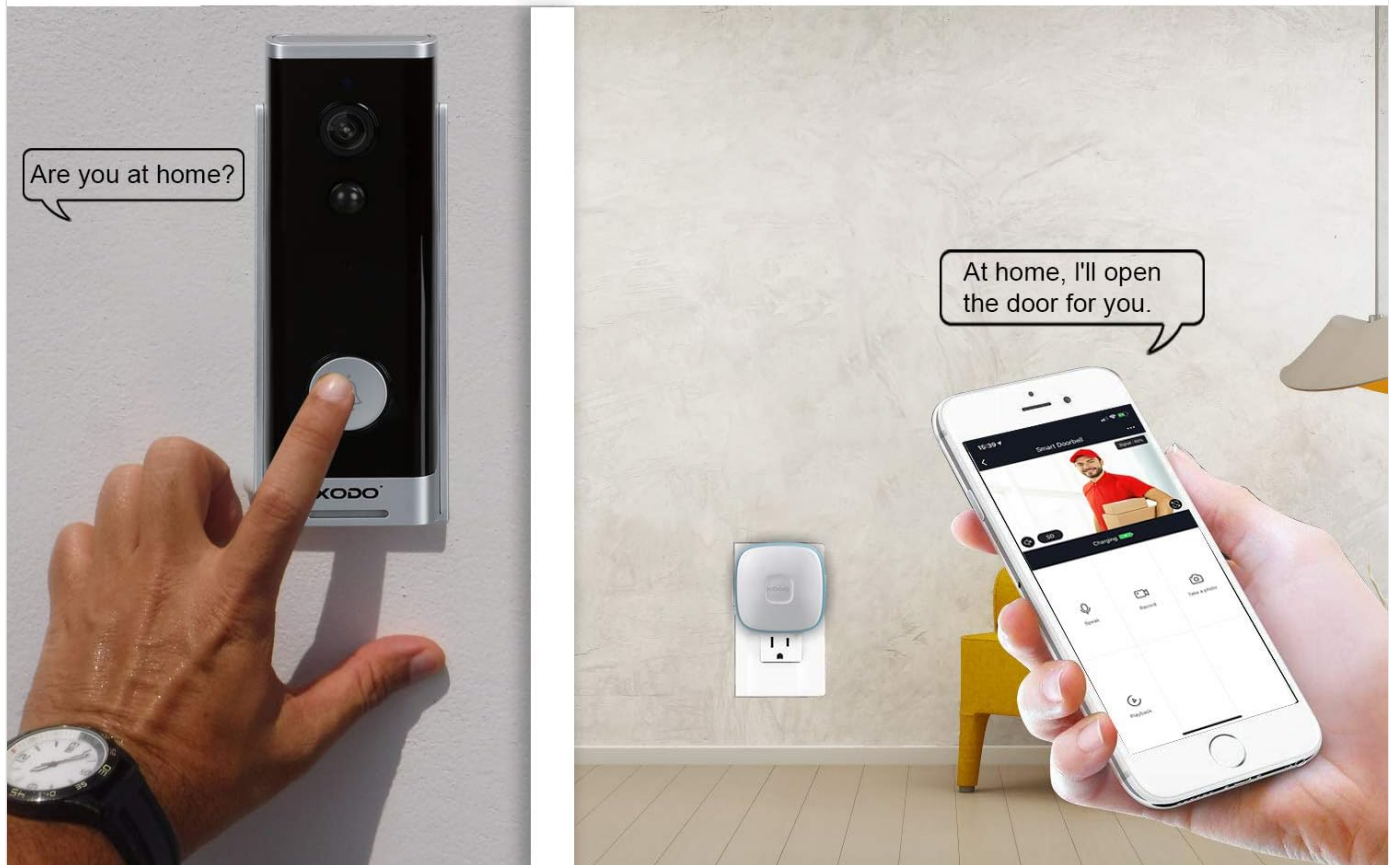

Image: A person pressing the XODO VD1 doorbell while another person views the live feed and communicates via the XODO Smart App on their smartphone, demonstrating the video call functionality.

Two-Way Audio Talk in Distance

Put it by the door, Thanks.

Hello, your package delivery.

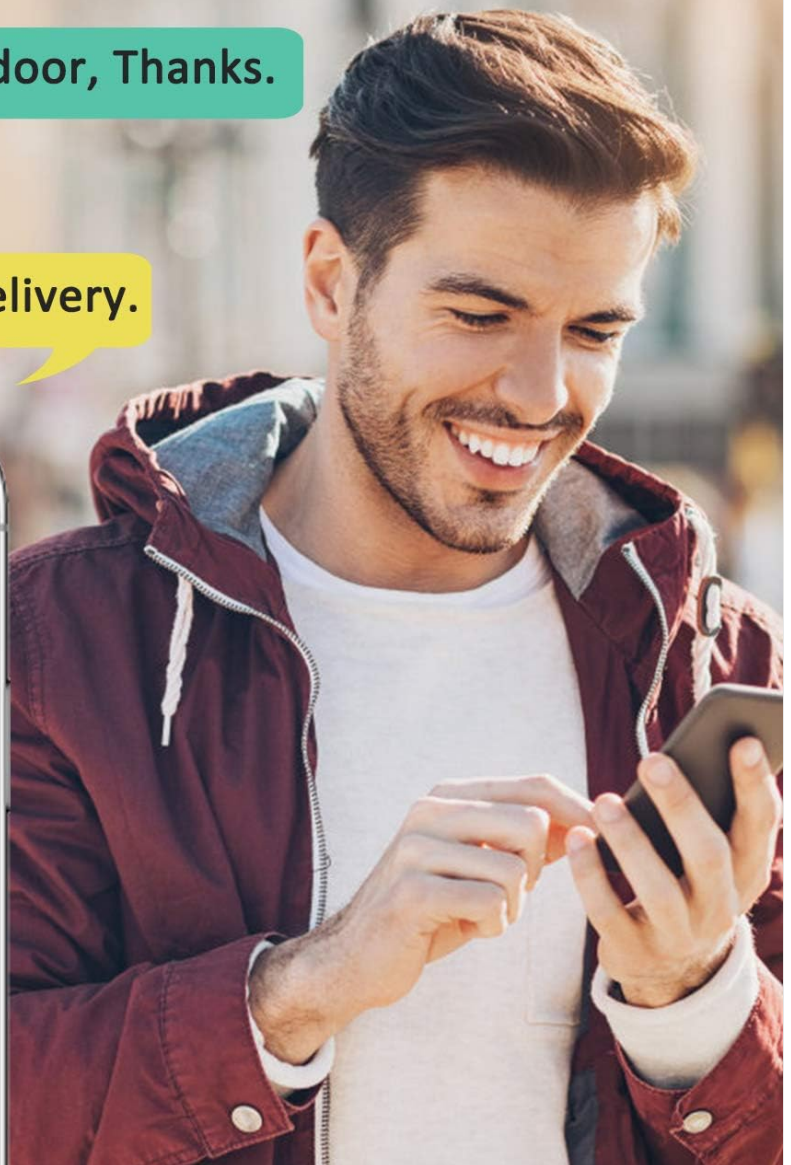
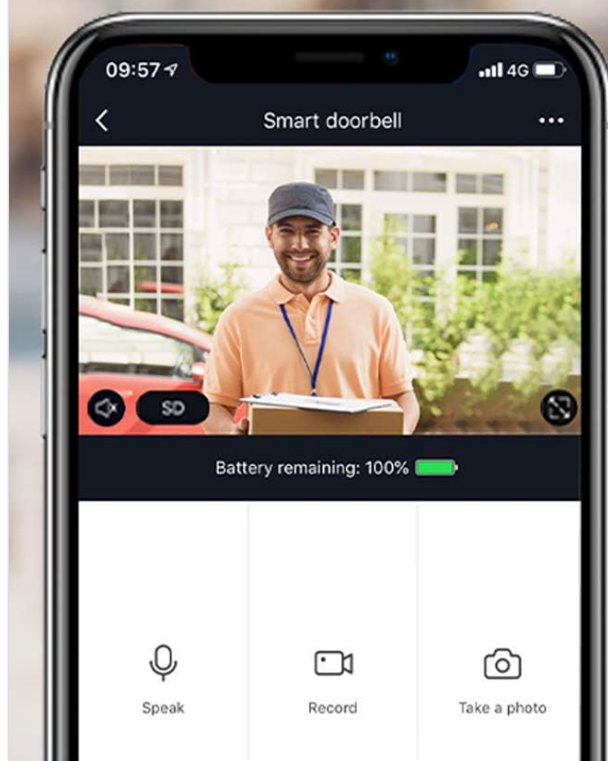

Image: A smartphone displaying the XODO Smart doorbell app interface, showing a live video feed of a person at the door and options for "Speak," "Record," and "Take a photo," illustrating the two-way audio and recording capabilities.

- **Speak:** Tap the microphone icon in the app to enable two-way audio and speak to your visitor. Tap again to mute.
- **Listen:** Audio from the doorbell is automatically streamed to your phone during live view.
- **Record:** Tap the record icon to manually start or stop video recording.
- **Screenshot:** Tap the camera icon to capture a still image from the live view.

Motion Detection (PIR)

The doorbell's Passive Infrared (PIR) sensor detects heat signatures of moving objects, such as people or large animals. When motion is detected, the doorbell will automatically begin recording and send an alert notification to your XODO Smart App.



Image: A smartphone displaying a "PIR MOTION DETECT" alert from the XODO Smart app, indicating that the doorbell has detected suspicious activity and activated from hibernation, with a live view of a person at the door.

- **Adjust Sensitivity:** Within the app settings for your doorbell, you can adjust the PIR motion detection sensitivity to reduce false alerts.
- **Activity Zones:** Some app versions may allow setting specific activity zones to monitor.

Video Storage

The XODO VD1 supports local storage via a MicroSD card (up to 128GB, not always included) and cloud storage options (check app for details on cloud service availability and fees).

- **MicroSD Card:** Insert a formatted MicroSD card into the SD Card Port on the back of the doorbell. Recordings will automatically save to the card.
- **Playback:** Access recorded videos through the "Playback" or "History" section in the XODO Smart App.

MAINTENANCE

Battery Management

The doorbell is powered by two 2600mAh rechargeable batteries. Battery life varies based on usage, motion detection frequency, and Wi-Fi signal strength. When the battery level is low, you will receive a notification via the app.

- **Recharging:** To recharge, remove the doorbell from its mounting bracket and connect it to a USB power source using the provided cable.
- **Battery Life:** To maximize battery life, consider adjusting PIR sensitivity and reducing the number of live view sessions.

Cleaning

Wipe the doorbell's exterior with a soft, damp cloth. Do not use harsh chemicals or abrasive cleaners. Ensure the camera lens is clean for optimal video quality.

Weather Resistance

1 Install Mounting Bracket



2 Install the doorbell



3 Tighten the security screw



Easy installation

Image: The XODO VD1 doorbell shown with water droplets, indicating its IP53 weather resistance, and icons for temperature range (-22 to 158°F), highlighting its durability in various weather conditions.

The XODO VD1 has an IP53 rating, meaning it is protected from limited dust ingress and from water spray less than 60 degrees from vertical. While it is weather-resistant, avoid submerging it in water or exposing it to extreme weather conditions beyond its specified operating temperature range (-22 to 158°F).

TROUBLESHOOTING

Problem	Possible Cause	Solution
Doorbell frequently disconnects from Wi-Fi.	Weak Wi-Fi signal; Interference; Incorrect Wi-Fi password.	Ensure the doorbell is within range of your 2.4GHz Wi-Fi router. Reduce interference from other devices. Re-enter Wi-Fi password in the app. Consider a Wi-Fi extender if necessary.
Poor video quality or blurry image.	Dirty camera lens; Low light conditions; Weak Wi-Fi signal.	Clean the camera lens with a soft cloth. Ensure sufficient lighting or rely on night vision. Improve Wi-Fi signal strength.

Problem	Possible Cause	Solution
Motion detection alerts are too frequent or not triggered.	PIR sensitivity setting is too high/low; Environmental factors (e.g., trees, traffic).	Adjust the PIR sensitivity settings in the XODO Smart App. Ensure the doorbell's view is clear of constantly moving objects.
Two-way audio is unclear or has echo.	Network latency; Microphone/speaker obstruction.	Ensure a stable internet connection. Check for any obstructions around the microphone or speaker on the doorbell.
Chime not ringing or connecting.	Chime not paired; Out of range; Power issue.	Re-pair the chime unit with the doorbell (refer to Setup Guide). Ensure the chime is plugged into a working power outlet and is within range of the doorbell.
Battery drains quickly.	Frequent motion alerts; Too many live view sessions; Cold weather.	Reduce PIR sensitivity. Limit live view sessions. In very cold temperatures, battery performance may be reduced.

SPECIFICATIONS

Feature	Detail
Model Number	VD-1
Video Resolution	1080P Full HD
Field of View	166 Degrees Wide Angle
Night Vision	Infrared Night Vision
Motion Detection	PIR Sensor (up to 25 feet)
Audio	Two-Way Audio with Noise Canceling
Connectivity	Wi-Fi (2.4GHz only)
Power Source	5200mAh (2 x 2600mAh) Rechargeable Batteries
Weather Resistance	IP53
Operating Temperature	-22 to 158°F (-30 to 70°C)
Storage	MicroSD Card (up to 128GB), Cloud Storage (optional)
Dimensions	9 x 7 x 1.8 inches
Item Weight	14.4 ounces
Compatible App	XODO Smart App (iOS/Android)

WARRANTY AND SUPPORT

This product is manufactured by Contixo. For warranty information, technical support, or customer service inquiries, please refer to the contact information provided with your product packaging or visit the official Contixo website.

You can also find helpful resources and FAQs within the XODO Smart App.

For the latest updates and support, please visit:[Contixo Official Store on Amazon](#)