

Manuals+

[Q & A](#) | [Deep Search](#) | [Upload](#)

[manuals.plus](#) /

› [Cloudray](#) /

› [Cloudray LCD Display Current Meter for MYJG 100W/150W Power Supplies Instruction Manual](#)

Cloudray PS06ZMLCD

Cloudray LCD Display Current Meter for MYJG 100W/150W Power Supplies

Model: PS06ZMLCD

INTRODUCTION

This manual provides instructions for the installation, operation, and maintenance of the Cloudray LCD Display Current Meter, model PS06ZMLCD. This device is designed to enhance the functionality of compatible MYJG series CO₂ laser power supplies by providing real-time current display and, for specific models, current adjustment capabilities. Please read this manual thoroughly before installation and operation to ensure proper use and optimal performance.

PRODUCT OVERVIEW

The Cloudray LCD Display Current Meter is an external module that connects to compatible MYJG laser power supplies. It features an LCD screen to show current output, water protection status, and laser signal status. For MYJG 100W and 150W power supplies, it also allows for current adjustment via an integrated potentiometer. For MYJG 50W, 60W, and 80W power supplies, it functions as a display-only unit.

Package Contents

- 1 x Cloudray LCD Display Current Meter
- 1 x Ethernet Cable (for connection)

Product Components



Image 1: The Cloudray LCD Display Current Meter and its included Ethernet cable. The meter features a display screen, a rotary knob for adjustment, and a test button.



Image 2: Detailed dimensions of the Cloudray LCD Display Current Meter, showing its length, width, and depth for installation planning.

SETUP INSTRUCTIONS

1. **Power Off:** Ensure the laser machine and its power supply are completely powered off and disconnected from the main power source before proceeding with installation.
2. **Locate Network Port:** Identify the network port (RJ45) on your MYJG series laser power supply. This port is typically labeled and located on the side or back of the power supply unit.
3. **Connect Ethernet Cable:** Connect one end of the provided Ethernet cable to the network port on the MYJG power supply.
4. **Connect Display Meter:** Connect the other end of the Ethernet cable to the corresponding network port on the back of the Cloudray LCD Display Current Meter.
5. **Mounting (Optional):** The display meter can be panel-mounted into a suitable enclosure or control panel. Refer to the product dimensions for precise cutout requirements.
6. **Power Supply Switch (for MYJG 100W/150W):** For MYJG 100W and 150W power supplies, locate the small switch or potentiometer on the power supply unit itself.
 - If this switch is turned to the **right**, the LCD screen's built-in trimmer potentiometer will be active, allowing you to adjust the current directly from the display.
 - If it is turned to the **left**, the LCD screen will display normally, but its potentiometer will not function for current adjustment.
7. **Power On:** Once all connections are secure, reconnect the laser machine to the main power source and power it on. The LCD display should illuminate and show current status.



Image 3: Illustration of the Ethernet cable connection between the Cloudray LCD Display Current Meter and a compatible MYJG series laser power supply.



After connecting the power supply, this switch is turned to the right, the LCD screen comes with a trimmer potentiometer to adjust the current; if it is turned to the left LCD screen to display normally, the potentiometer does not work.

Image 4: Close-up view of the potentiometer switch on the MYJG power supply, which enables or disables current adjustment from the LCD meter.

OPERATING INSTRUCTIONS

After successful installation and power-on, the LCD display will show real-time operational data.

Display Information



Image 5: The Cloudray LCD Display showing "Current output" in milliamperes (mA), "Water protection" status (ON/OFF), and "Laser signal" status (ON/OFF).

- **Current Output:** Displays the real-time current (in milliamperes, mA) being supplied to the laser tube.

- **Water Protection:** Indicates the status of the water protection system. "ON" means the water protection is active and functioning; "OFF" means it is not active or there is an issue.
- **Laser Signal:** Shows whether a laser signal is being sent to the power supply. "ON" indicates a signal is present; "OFF" indicates no signal.

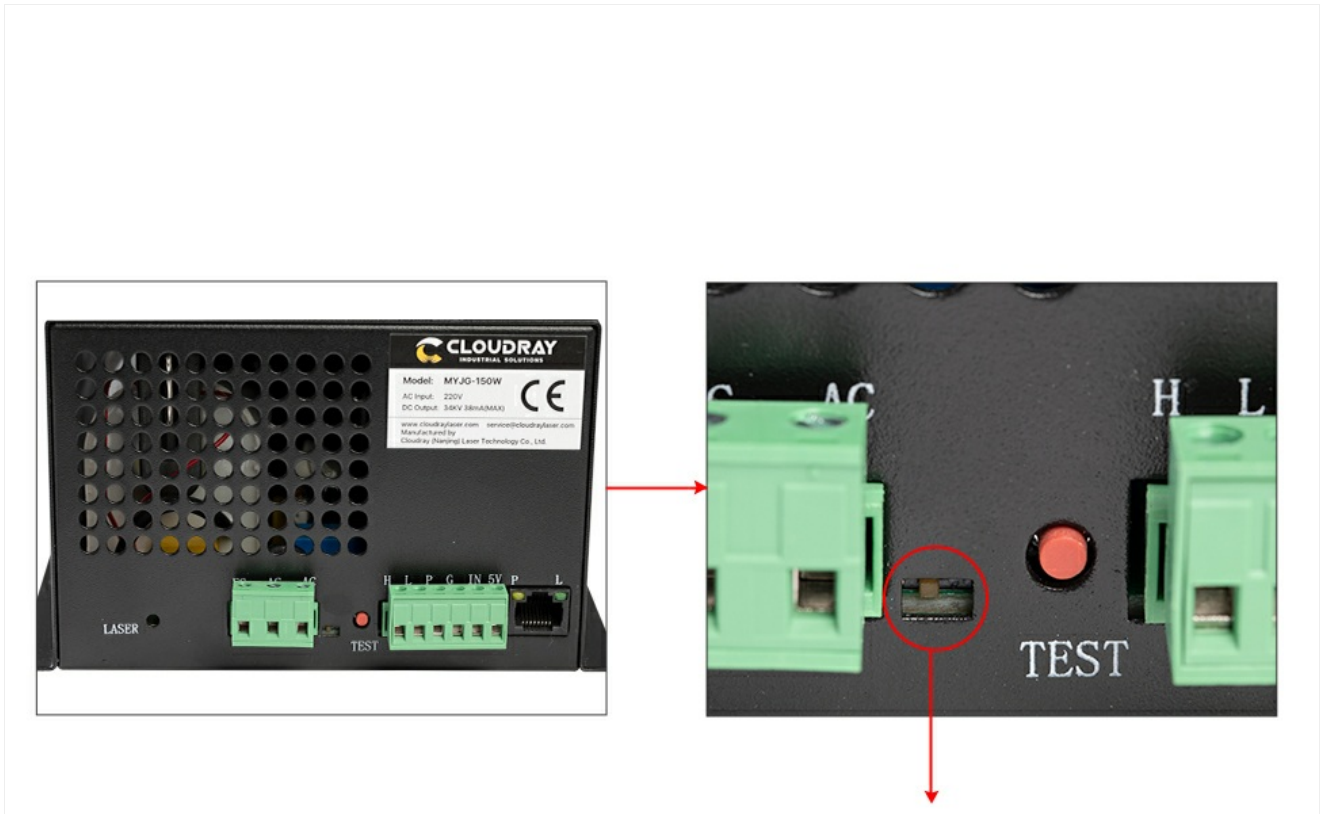

Image 6: Various states of the Cloudray LCD Display, illustrating different combinations of current output, water protection, and laser signal statuses.

Current Adjustment (MYJG 100W/150W only)

If your MYJG power supply is 100W or 150W and the internal switch was set to the right during setup, you can adjust the laser current using the rotary knob on the display meter.

- **Rotary Knob:** Turn the knob clockwise to increase the current output and counter-clockwise to decrease it. Observe the "Current output" value on the LCD screen as you adjust.
- **TEST Button:** Press the "TEST" button to momentarily activate the laser at the set current. This is useful for testing the laser output without initiating a full job.

Note: For MYJG 50W, 60W, and 80W power supplies, the rotary knob on the display meter will not adjust the current. It will only function as a display unit.

MAINTENANCE

The Cloudray LCD Display Current Meter requires minimal maintenance. Follow these guidelines to ensure its longevity and accurate performance:

- **Cleaning:** Gently wipe the screen and casing with a soft, dry cloth. Avoid using abrasive cleaners or solvents that could damage the display or finish.
- **Connections:** Periodically check the Ethernet cable connection to ensure it is secure and free from damage. A loose connection can lead to intermittent readings or loss of functionality.
- **Environment:** Operate the device within its specified environmental conditions (temperature, humidity) to prevent damage.

TROUBLESHOOTING

If you encounter issues with your Cloudray LCD Display Current Meter, refer to the following troubleshooting steps:

Problem	Possible Cause	Solution
Display does not light up or shows no information.	<ul style="list-style-type: none">No power to the MYJG power supply.Loose or incorrect Ethernet cable connection.Incompatible power supply model.	<ul style="list-style-type: none">Ensure the laser machine and MYJG power supply are powered on.Check that the Ethernet cable is securely connected at both ends.Verify your MYJG power supply is compatible (MYJG 50W-150W series).
Current adjustment knob does not work.	<ul style="list-style-type: none">Power supply is MYJG 50W, 60W, or 80W (display-only models).Internal switch on MYJG 100W/150W power supply is set to "left" (potentiometer disabled).	<ul style="list-style-type: none">Confirm your power supply model. Adjustment is only available for MYJG 100W/150W.For MYJG 100W/150W, ensure the internal switch on the power supply is set to the right to enable the display's potentiometer.
Inaccurate or fluctuating current readings.	<ul style="list-style-type: none">Loose connection.Electrical interference.	<ul style="list-style-type: none">Check all cable connections.Ensure proper grounding of the laser system.

SPECIFICATIONS

Feature	Detail
Model Name	PS06ZMLCD
Brand	Cloudray
Compatible Devices	MYJG 50W-150W CO ₂ Laser Power Supplies
Functionality (MYJG 50W/60W/80W)	Current display only
Functionality (MYJG 100W/150W)	Current display and adjustment
Product Dimensions (L x W x H)	6.8 x 3.7 x 4.5 inches (approx. 173 x 94 x 114 mm)
Item Weight	8.8 ounces (approx. 0.25 kg)
Connection Type	Ethernet (RJ45)

WARRANTY AND SUPPORT

For warranty information and technical support, please refer to the documentation provided with your original purchase or contact Cloudray customer service directly. Keep your purchase receipt as proof of purchase for any warranty claims.

You can typically find support contact details on the official Cloudray website or through the retailer where the product was purchased.

