

Manuals+

[Q & A](#) | [Deep Search](#) | [Upload](#)

manuals.plus /

› [AWESAFE](#) /

› [AWESAFE 7-Inch 2 DIN Car Radio for Ford User Manual](#)

AWESAFE 37cbddce-472d-47e9-933c-925437b7f636

AWESAFE 7-Inch 2 DIN Car Radio for Ford User Manual

Model: 37cbddce-472d-47e9-933c-925437b7f636

1. INTRODUCTION

This manual provides comprehensive instructions for the installation, operation, and maintenance of your AWESAFE 7-inch 2 DIN car radio. This unit is designed for specific Ford models and offers a range of features including a touch screen, Bluetooth connectivity, GPS navigation, FM/RDS radio, CD/DVD player, USB/SD media playback, steering wheel control support, Mirrorlink functionality, and parking assistance.

Applicable Ford Models:

- Ford Mondeo: 2008-2011
- Ford Focus: 2008-2011
- Ford S-Max: 2008-2011
- Ford C-Max: 2008-2011
- Ford Galaxy: 2010-2012

The front panel dimensions are 216 mm x 112 mm. Please confirm these dimensions and your vehicle's compatibility before installation.



MODELOS APLICABLES



For Ford/Mondeo 2008-2011
For Ford/Focus 2008-2011
For Ford/S-Max 2008-2011
For Ford/C-Max 2008-2011
For Ford/Galaxy 2010-2012



Figure 1.1: Applicable Ford models for the AWESAFE car radio. Please verify your vehicle's model and year for compatibility.

2. SETUP AND INSTALLATION

Careful installation is crucial for optimal performance. It is recommended that installation be performed by a qualified professional.

2.1 Package Contents

Verify that all components are present in the package:

- AWESAFE Car Radio Unit
- Microphone
- GPS Antenna
- Installation Tool
- Canbus Decoder
- Power Cable Kits (for different head unit connectors)
- USB Cables (including one for Mirrorlink)
- Radio Antenna Adapter

- User Manual
- SD Card with Pre-loaded Maps

Accesorios

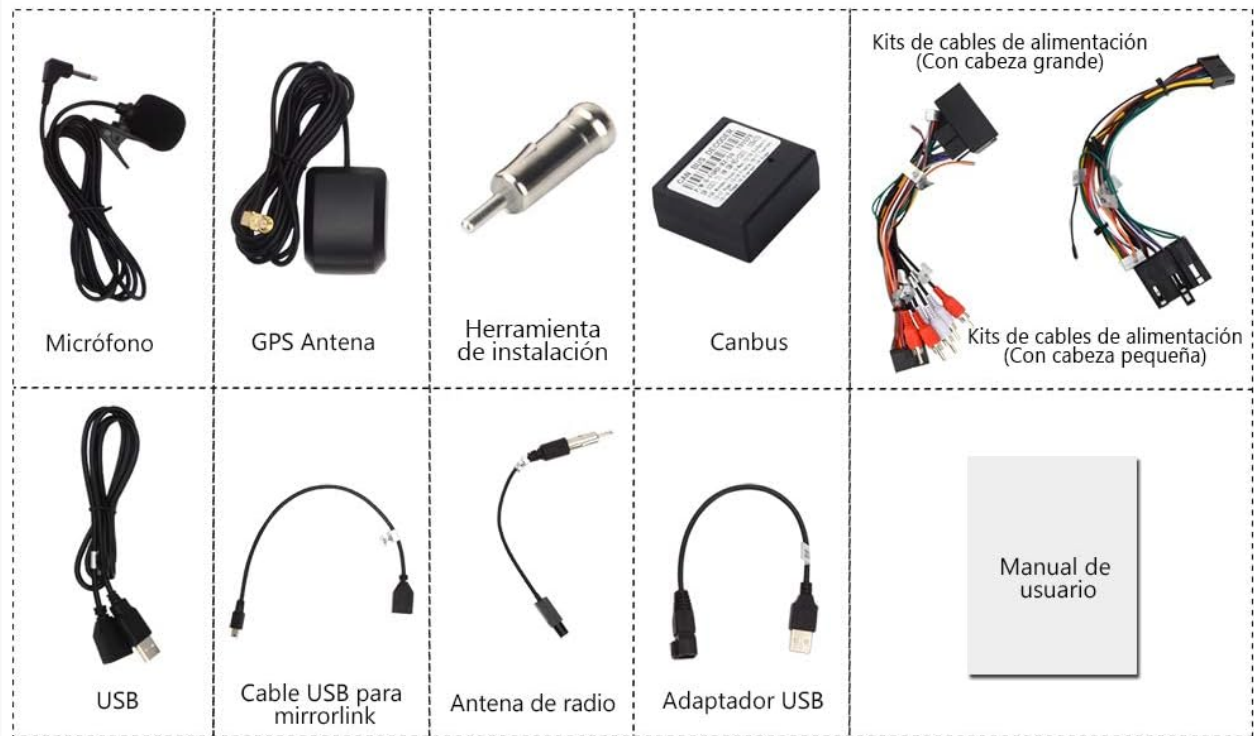

Figure 2.1: Included accessories with the AWESAFE car radio. Ensure all items are present before proceeding with installation.

2.2 Pre-Installation Check

Before beginning installation, ensure the unit's dimensions (216 mm x 112 mm) and your Ford model's year are compatible. In some cases, if the dimensions match but the year is outside the specified range, steering wheel controls may not function correctly.

2.3 Wiring and Connections

Refer to the detailed wiring diagrams provided in the physical user manual for specific connection instructions. Ensure all cables are securely connected to prevent malfunctions.

- **Power Cables:** Use the appropriate power cable kit for your vehicle.
- **Radio Antenna:** Connect the radio antenna using the provided adapter. Note that some vehicles may have dual antenna connections; ensure the primary antenna is connected.
- **GPS Antenna:** Mount the GPS antenna in a location with a clear view of the sky for optimal signal reception.
- **Microphone:** Connect the external microphone for improved hands-free call quality.

- **Rear Camera (Optional):** If installing a rear camera (not included), connect it to the designated input.

2.4 GPS Map Setup

The unit comes with an SD card containing pre-loaded European maps. Insert the SD card into the designated slot. The navigation system is ready for use upon startup.

3. OPERATING INSTRUCTIONS

This section details the primary functions and controls of your AWESAFE car radio.



Figure 3.1: Front panel controls and equalizer interface. The unit features a 7-inch display.

3.1 Basic Controls

- **Volume Knob:** Adjusts audio output level.
- **MENU Button:** Accesses the main menu or settings.
- **BAND Button:** Switches between radio bands (FM/AM).
- **NAVI Button:** Launches the GPS navigation application.
- **BT Button:** Activates Bluetooth functions.
- **TUNE Knob:** Adjusts radio frequency or navigates menus.
- **Eject CD/DVD Button:** Ejects discs from the slot.
- **Next/Previous Buttons:** Skips tracks or radio stations.

- **DVD Button:** Selects DVD playback mode.

3.2 Bluetooth Functionality

The unit supports Bluetooth for hands-free calling and audio streaming from compatible mobile devices (iOS and Android).

- **Pairing:** Activate Bluetooth on your mobile device and search for the car radio. Select the unit from the list and enter the PIN (usually 0000) if prompted.
- **Hands-Free Calls:** Make and receive calls directly through the car radio. The built-in microphone or external microphone (if connected) will be used.
- **Audio Streaming:** Play music from your paired device wirelessly.



Figure 3.2: Bluetooth connection interface. Allows for hands-free calls and music playback.

3.3 GPS Navigation

Utilize the integrated GPS navigation system with pre-loaded European maps.

- **Route Planning:** Plan your route using postcode, address, Points of Interest (POI), or coordinates.
- **Map Display:** Choose between 2D and 3D map views.
- **Simultaneous Operation:** Navigate while listening to music.

- **Automatic Startup:** Configure the navigation system to start automatically when the vehicle is turned on.



Figure 3.3: GPS navigation display. Features pre-loaded maps and route guidance.

3.4 Steering Wheel Controls

The unit supports your vehicle's existing steering wheel controls, allowing for convenient operation without taking your hands off the wheel. Configuration may be required in the settings menu.

3.5 Audio Features

- **FM/AM Radio:** High-quality digital stereo tuner with RDS (Radio Data System). Supports automatic and semi-automatic station search.
- **Equalizer (EQ):** Adjust audio settings with preset modes (Jazz, Rock, Pop, Classical) or customize your own sound profile. Control individual speaker volumes (front/rear).

3.6 Multimedia Playback

Play audio and video files from various sources:

- CD/DVD discs
- USB drives

- SD cards
- Bluetooth streaming from mobile devices

3.7 Display and Customization

- **Brightness Control:** Adjust screen brightness automatically or manually for day and night driving.
- **Custom Car Logo:** Personalize the unit with your car's logo.
- **RGB Button Lighting:** Select from seven different colors for the physical buttons or set a single preferred color.
- **AV Output:** Transfer video content to external displays, such as headrest monitors.

3.8 Mirrorlink Functionality

Mirrorlink allows you to duplicate your Android smartphone's screen onto the car radio display. This feature is compatible with Android smartphones only and does not support iPhones.

3.9 Vehicle Information Display

The unit can display various vehicle parameters, including:

- Remaining oil level
- Outside temperature
- Battery voltage
- Seatbelt status
- Trunk status
- Handbrake status
- Cleaning fluid level
- Engine speed
- Instantaneous speed
- Mileage

3.10 Parking Assistance

Connect an optional rear-view camera (not included) to receive visual assistance on the screen when reversing, enhancing parking safety.



Figure 3.4: Parking assistance feature. Requires an optional rear camera for visual guidance.

4. MAINTENANCE

Proper maintenance ensures the longevity and optimal performance of your car radio.

- **Cleaning:** Use a soft, dry cloth to clean the screen and unit. Avoid using abrasive cleaners, solvents, or chemical sprays, as these can damage the surface.
- **Software Updates:** Periodically check the AWESAFE official website for any available software updates to ensure you have the latest features and bug fixes.
- **SD Card Handling:** Handle the GPS map SD card with care. Avoid exposing it to extreme temperatures or physical damage.
- **Environmental Conditions:** Avoid exposing the unit to extreme temperatures, direct sunlight for prolonged periods, or excessive moisture.

5. TROUBLESHOOTING

This section addresses common issues you might encounter with your car radio.

5.1 Steering Wheel Controls Not Functioning

If steering wheel controls do not work after installation, verify that your vehicle's model year falls within the compatible range specified (e.g., Ford Mondeo 2008-2011). Even if the unit fits physically, year incompatibility can prevent control functionality.

5.2 Rear Camera Screen Turns Off/Sound Mutes

If the screen turns off or audio mutes when engaging reverse gear, this may be due to a specific configuration. Contact AWESAFE customer support for assistance in adjusting these settings.

5.3 Mirrorlink Issues

- **Compatibility:** Mirrorlink is only compatible with Android smartphones. It does not support iPhones.
- **Required App:** Ensure the necessary Mirrorlink application is installed on your Android phone. If not available on the Play Store, you may need to download the APK from the manufacturer's website.
- **Developer Options:** You might need to enable 'Developer options' and 'USB debugging' on your Android phone for Mirrorlink to function correctly.
- **Performance:** Screen mirroring performance can vary. Some users report slow response times or lag.
- **Charging:** The USB connection for Mirrorlink may provide low amperage, resulting in slow or no charging of your phone during use.

5.4 FM Radio Signal Quality

If FM radio quality is lower than your original factory radio, ensure the antenna connection is secure and properly installed. In some cases, an antenna signal booster may be required.

5.5 No Power / No Sound

Check all power connections and fuses. Ensure the unit is correctly wired to the vehicle's power supply. For no sound, verify speaker connections and audio settings.

5.6 GPS Signal Issues

Ensure the GPS antenna is mounted in a location with an unobstructed view of the sky. Check the antenna connection to the unit.

6. SPECIFICATIONS

Feature	Specification
Model Number	37cbddce-472d-47e9-933c-925437b7f636
ASIN	B082PFK2LB
Display Size	7 Inches
Front Panel Dimensions	216 mm x 112 mm
Product Dimensions	32.2 x 24.2 x 19.6 cm

Feature	Specification
Weight	2.7 kg
Connectivity Technology	USB, Bluetooth
Special Features	Touch screen, RDS
Compatible Devices	Smartphone (Android, iOS, Windows)
Audio Output Mode	Stereo
Surround Sound Channel Configuration	2.0
Color	Black
Output Power	50 Watts
Control Method	Touch
Audio Output Type	Speakers
Format	Digital

7. WARRANTY AND SUPPORT

For specific warranty information, please refer to the documentation included with your product or contact AWESAFE customer service directly.

If you encounter any issues not covered in this manual, require technical assistance, or need help with specific configurations (e.g., rear camera settings), please contact AWESAFE customer support. They can provide detailed guidance and solutions for your product.