

[Manuals.plus](#) /

> [Dweekiy](#) /

> Dweekiy Crankshaft Positioning Tool User Manual

Dweekiy Dweekiygx892dt6qy

Dweekiy Crankshaft Positioning Tool User Manual

Model: Dweekiygx892dt6qy | Brand: Dweekiy

1. INTRODUCTION

This user manual provides detailed instructions for the proper use, setup, operation, maintenance, and troubleshooting of the Dweekiy Crankshaft Positioning Tool. Please read this manual thoroughly before using the product to ensure safe and efficient operation.

2. PRODUCT OVERVIEW

The Dweekiy Crankshaft Positioning Tool is designed for precise crankshaft positioning during timing chain maintenance or replacement on Ford 5.4L, 4.6L, and 3V engines. It ensures the crankshaft is held in the correct position, which is critical for accurate engine timing.

2.1. Package Contents

- 1 x Crankshaft Positioning Wrench
- 1 x Crank Tool

2.2. Product Components



Figure 2.2.1: The two main components of the Dweekiy Crankshaft Positioning Tool: the crankshaft positioning wrench and the crank tool.

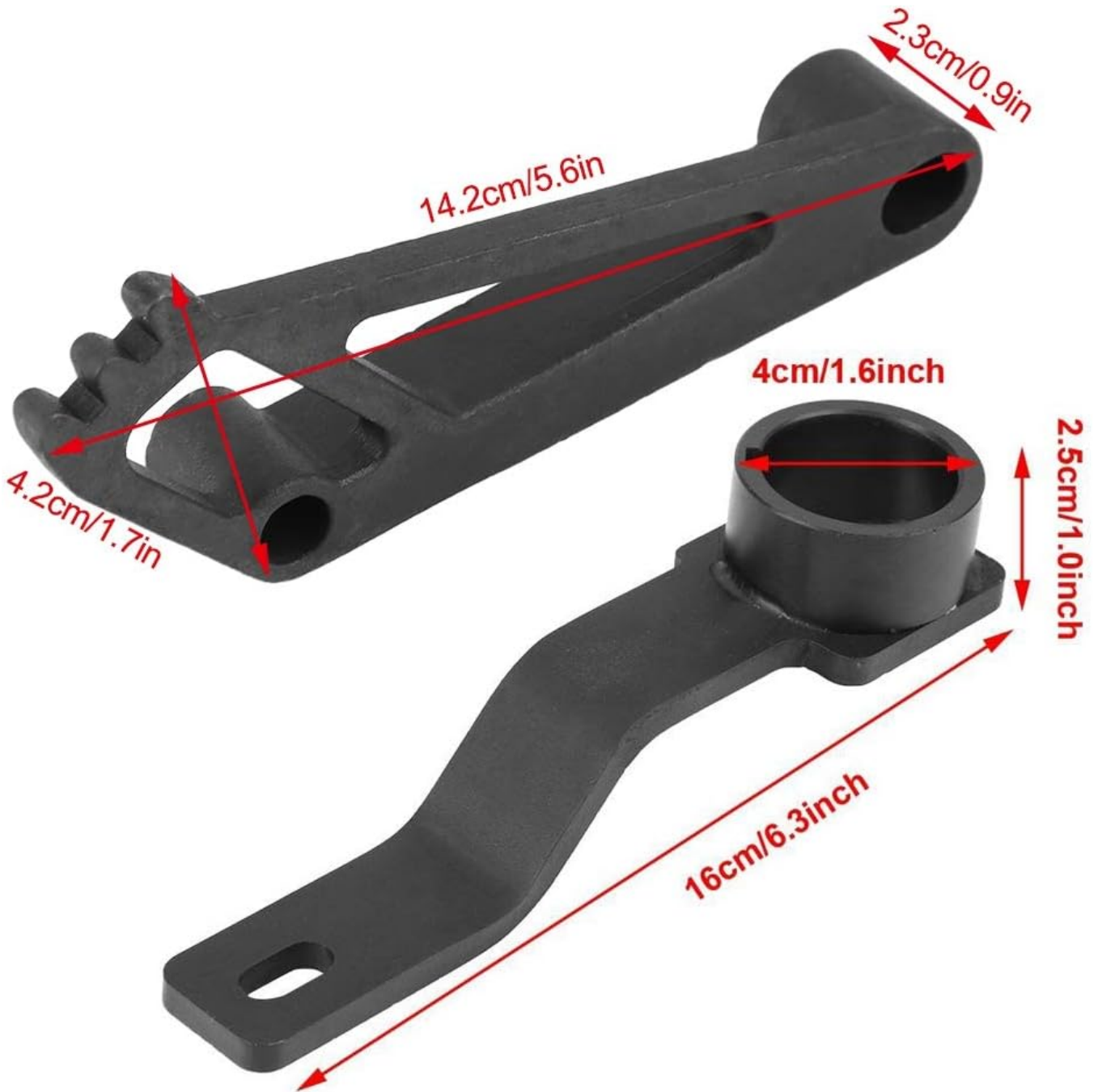

Figure 2.2.2: Dimensions of the crankshaft positioning tool, showing lengths and widths in both centimeters and inches for precise measurement.

3. SETUP

Before beginning any work on your engine, ensure the vehicle is safely supported and the engine is cool. Always refer to your vehicle's specific service manual for detailed instructions regarding engine timing procedures.

3.1. Safety Precautions

- Always wear appropriate personal protective equipment (PPE), including safety glasses and gloves.
- Ensure the vehicle's battery is disconnected to prevent accidental engine cranking.
- Work in a well-ventilated area.
- Keep hands and clothing clear of moving engine parts.

3.2. Required Tools (Not Included)

- Torque wrench
- Socket set
- Ratchet
- Vehicle-specific service manual

4. OPERATING INSTRUCTIONS

This tool is specifically designed for Ford 5.4L, 4.6L, and 3V engines. Follow these general steps for using the crankshaft positioning tool. Always consult your vehicle's service manual for exact procedures and torque specifications.

1. **Prepare the Engine:** Access the crankshaft pulley and timing cover as per your vehicle's service manual.
2. **Locate Timing Mark:** Rotate the crankshaft until the engine is at Top Dead Center (TDC) on the compression stroke for cylinder #1, or as specified by your service manual for timing chain procedures.
3. **Insert Crankshaft Positioning Wrench:** Insert the crankshaft positioning wrench into the designated slot on the crankshaft or crankshaft pulley, ensuring it engages properly to prevent rotation.
4. **Use Crank Tool (if applicable):** If your procedure requires turning the crankshaft with the tool, attach the crank tool to the crankshaft bolt and use it to carefully rotate the crankshaft to the desired position. The positioning wrench will help hold it in place.
5. **Perform Timing Chain Work:** With the crankshaft securely positioned, proceed with timing chain removal, installation, or adjustment as required by your vehicle's service manual.
6. **Remove Tools:** Once timing chain work is complete and all components are reassembled and torqued to specification, carefully remove the crankshaft positioning tool.
7. **Reassemble Engine:** Reassemble all engine components, ensuring all bolts are tightened to factory specifications.



Figure 4.1: Illustrative diagram showing the general location of the crankshaft and timing components within a vehicle engine, where the tool would be applied.



Figure 4.2: Close-up view of the crankshaft positioning tool alongside engine components, indicating its function in relation to the crankshaft and timing chain system.

5. MAINTENANCE

Proper maintenance of your Dweekiy Crankshaft Positioning Tool will ensure its longevity and continued accuracy.

- **Cleaning:** After each use, wipe the tool clean with a dry cloth to remove any oil, grease, or debris.
- **Storage:** Store the tool in a dry, clean environment, away from moisture and corrosive materials. A toolbox or dedicated storage case is recommended.
- **Inspection:** Periodically inspect the tool for any signs of wear, damage, or deformation. Do not use the tool if it appears bent, cracked, or otherwise compromised, as this could lead to inaccurate positioning or failure.

- **Lubrication:** No lubrication is required for this tool.

6. TROUBLESHOOTING

This section addresses common issues that may arise during the use of the crankshaft positioning tool.

Problem	Possible Cause	Solution
Tool does not fit into crankshaft slot.	Incorrect engine model or year; debris in slot; tool damage.	Verify tool compatibility with your specific Ford 5.4L/4.6L/3V engine. Clean the crankshaft slot. Inspect the tool for damage.
Crankshaft still rotates slightly after tool insertion.	Tool not fully seated; excessive force applied to crankshaft.	Ensure the tool is fully and correctly seated. Avoid applying excessive rotational force to the crankshaft once the tool is in place.
Tool appears bent or damaged after use.	Improper use; excessive force; manufacturing defect.	Discontinue use immediately. This tool is for positioning, not for breaking loose seized bolts. Contact customer support if damage occurred under normal, intended use.

7. SPECIFICATIONS

Key specifications for the Dweekiy Crankshaft Positioning Tool.

Brand: Dweekiy

Model Number: Dweekiygx892dt6qy

Item Weight: 1.1 pounds (approx. 0.5 kg)

Product Dimensions: 9.84 x 3.94 x 2.76 inches (approx. 25 x 10 x 7 cm)

Compatibility: Ford 5.4L, 4.6L, 3V Engines

Material: High-strength steel (implied by tool type)

8. WARRANTY AND SUPPORT

For warranty information or technical support, please contact Dweekiy customer service. Keep your purchase receipt as proof of purchase.

- **Customer Service:** Refer to the contact information provided with your product packaging or visit the official Dweekiy store page on Amazon.
- [Visit the Dweekiy Store on Amazon](#)

