



[Manuals.plus](#) /

> [Glacier Bay](#) /

> Fairhurst Single-Handle Pull-Down Sprayer Kitchen Faucet User Manual

Glacier Bay HD67726W-1108D2

Fairhurst Single-Handle Pull-Down Sprayer Kitchen Faucet User Manual

Model: HD67726W-1108D2 | Brand: Glacier Bay

INTRODUCTION

Thank you for choosing the Glacier Bay Fairhurst Single-Handle Pull-Down Sprayer Kitchen Faucet. This manual provides comprehensive instructions for the installation, operation, and maintenance of your new faucet. Please read this manual thoroughly before beginning installation or use to ensure proper function and longevity of your product. Keep this manual for future reference.

SAFETY INFORMATION

Always adhere to basic safety precautions when installing or servicing plumbing fixtures. Failure to do so may result in property damage or personal injury.

- Always turn off the main water supply before beginning any installation or repair work.
- Wear safety glasses and appropriate personal protective equipment during installation.
- Ensure all connections are secure to prevent leaks.
- If you are unsure about any part of the installation process, consult a qualified plumber.
- Do not use harsh chemicals or abrasive cleaners on the faucet finish.

PACKAGE CONTENTS

Verify that all components are present before beginning installation.

- Faucet Assembly (Main Body with Spout and Handle)

- Pull-Down Sprayer Wand
- Mounting Hardware (FastMount System)
- Supply Hoses (Pre-attached)
- Deck Plate (Optional for 3-hole installations)
- Weight for Pull-Down Hose



Image: The complete Fairhurst Single-Handle Pull-Down Sprayer Kitchen Faucet assembly, showcasing the high-arc spout, single lever handle, and pull-down sprayer in a stainless steel finish.

INSTALLATION INSTRUCTIONS

Before You Begin

Ensure you have the following tools and materials:

- Adjustable Wrench
- Phillips Head Screwdriver
- Plumber's Putty or Silicone Sealant
- Bucket (for catching drips)
- Flashlight

Step-by-Step Installation

1. **Turn Off Water Supply:** Locate the hot and cold water supply valves under the sink and turn them off completely. Open the existing faucet to drain any remaining water.
2. **Remove Old Faucet:** Disconnect the supply lines from the old faucet. Unscrew the mounting nuts and remove the old faucet from the sink. Clean the sink surface thoroughly.
3. **Install Deck Plate (Optional):** If your sink has three holes, place the deck plate over the holes. Apply a thin bead of plumber's putty or silicone sealant around the base of the deck plate to create a watertight seal.
4. **Mount the Faucet:** Insert the faucet body through the center hole of the sink (and deck plate, if used). From underneath the sink, slide the rubber washer, then the metal washer, onto the faucet shank.
5. **Secure with FastMount System:** Thread the FastMount nut onto the faucet shank from below the sink. Push the FastMount over the shank and twist to tighten it securely by hand. This system is designed for quick and easy installation.

FastMount™

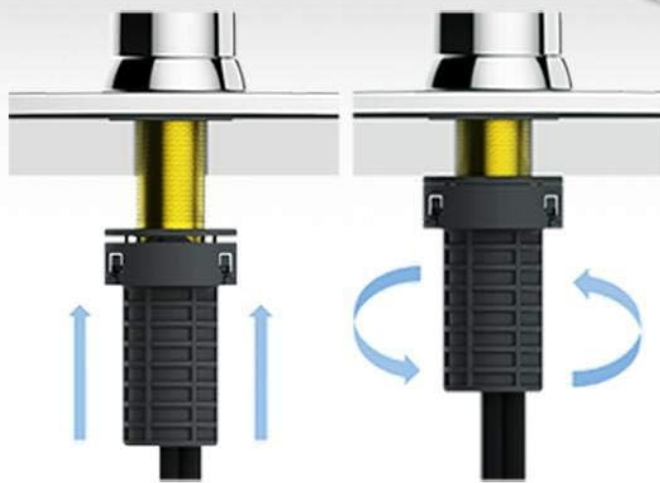

INSTALLS IN SECONDS!
 PUSH THE FASTMOUNT™ OVER THE SHANK,
 AND TWIST TO TIGHTEN.

Image: Diagram illustrating the FastMount installation system. It shows how to push the FastMount component over the faucet shank and twist it to secure the faucet quickly and easily to the countertop from underneath.

6. **Connect Supply Lines:** Connect the hot and cold supply lines from the faucet to your water supply valves. The faucet comes with pre-attached 3/8-inch connections. Ensure connections are tight but do not overtighten.
7. **Install Sprayer Hose and Weight:** Feed the pull-down sprayer hose through the faucet spout. Connect the sprayer hose to the quick-connect fitting on the main supply line under the sink. Attach the hose weight to the pull-down hose at the marked location (approximately 6-8 inches from the loop) to ensure proper retraction.
8. **Check for Leaks:** Slowly turn on the hot and cold water supply valves. Check all connections for leaks. If leaks occur, tighten the connections slightly until they stop.
9. **Flush the Faucet:** Remove the sprayer head and turn on the water to flush out any debris from the lines for about 1 minute. Reattach the sprayer head.

OPERATING YOUR FAUCET

Water Flow and Temperature Control

The Fairhurst faucet features a single lever handle for easy control of both water flow and temperature.

- **To Turn On/Off:** Lift the handle upwards to turn on the water. Push it downwards to turn off the water.
- **To Adjust Flow:** The further you lift the handle, the greater the water flow.
- **To Adjust Temperature:** Move the handle to the left for hot water and to the right for cold water.

Sprayer Functions

The pull-down sprayer wand offers versatile cleaning options.

- **Pull-Down Function:** Grasp the sprayer head and pull it down from the spout. The hose extends up to 59 inches, providing a 14-inch reach for easy cleaning of pots and sink areas.
- **Spray Modes:** The sprayer head features two distinct spray modes:
 - **Aerated Spray:** Ideal for everyday tasks like washing hands or filling pots.
 - **TurboSpray™:** Provides focused water columns with 30% more power than standard pull-down faucets, perfect for heavy-duty cleaning and rinsing stubborn food particles. Press the button on the sprayer head to switch to TurboSpray.
- **Retraction:** When finished, simply guide the sprayer head back into the spout. The hose weight will assist in smooth retraction.



Image: Diagram illustrating the TurboSpray™ technology. It shows a close-up of the sprayer head and a visual representation of focused water columns delivering 30% more cleaning power compared to a standard spray.

CARE AND MAINTENANCE

Proper care will ensure the lasting beauty and performance of your faucet.

Cleaning

- Clean the faucet regularly with a soft cloth and mild soap.
- Rinse thoroughly with clean water and dry with a soft cloth to prevent water spots.
- Avoid using abrasive cleaners, steel wool, or harsh chemicals (e.g., ammonia, bleach, alcohol) as they can damage the finish.
- For the sprayer nozzles, gently rub them with your finger to dislodge any mineral buildup.

TROUBLESHOOTING

Refer to the table below for common issues and their solutions.

| Problem | Possible Cause | Solution |
|---------------------------------|---|---|
| Low water flow | Aerator clogged; Supply valves not fully open; Kink in supply line. | Clean or replace aerator; Fully open supply valves; Check supply lines for kinks. |
| Faucet leaks from spout | Worn cartridge; Debris in cartridge. | Replace cartridge; Flush lines and clean cartridge. |
| Water leaks from base of faucet | Loose mounting nut; Improperly sealed base. | Tighten mounting nut; Reapply plumber's putty or silicone sealant. |
| Sprayer does not retract fully | Hose weight misplaced or obstructed; Hose kinked. | Adjust hose weight position; Clear any obstructions; Straighten hose. |
| No hot or cold water | Supply valve closed; Supply line kinked. | Open supply valve; Straighten supply line. |

PRODUCT SPECIFICATIONS

| Feature | Specification |
|-------------|-----------------------------|
| Brand | Glacier Bay |
| Model Name | Fairhurst (HD67726W-1108D2) |
| Finish Type | Stainless Steel |

| Feature | Specification |
|-----------------------|-----------------------------------|
| Material | Stainless Steel |
| Mounting Type | Deck Mount |
| Number of Handles | 1 (Single-Handle) |
| Hole Count | 1 (or 3 with included deck plate) |
| Maximum Flow Rate | 1.8 Gallons Per Minute (GPM) |
| Spout Reach | 14 Inches |
| Hose Length (Sprayer) | 59 Inches |
| Supply Hose Length | 36 Inches (32 inches workable) |
| Connection Size | 3/8-inch |
| Item Weight | 4.94 pounds |
| Package Dimensions | 21.9 x 10.7 x 2.8 inches |

WARRANTY AND SUPPORT

Glacier Bay products are manufactured to high-quality standards and are backed by a limited warranty. For specific warranty details, please refer to the warranty card included with your product or visit the official Glacier Bay website. If you require assistance with installation, parts, or have any questions regarding your Fairhurst faucet, please contact Glacier Bay Customer Service. Contact information can typically be found on the product packaging or the brand's official website.