

## Speaka SP-7870508

# SpeaKa Professional HDMI Connection Cable SP-7870508 User Manual

Model: SP-7870508

## 1. PRODUCT OVERVIEW

The SpeaKa Professional SP-7870508 is a high-quality HDMI connection cable designed for reliable audio and video transmission. This cable features gold-plated connectors for optimal signal integrity and supports advanced functionalities such as Audio Return Channel (ARC) and HDMI Ethernet Channel. Its compact 0.3-meter length and angled connector design make it suitable for installations where space is limited or a specific cable routing is required.

### Key Features:

- **Angled HDMI Connector:** One connector is angled at 90 degrees for convenient installation in tight spaces.
- **HDMI Ethernet Channel (HEC):** Allows for network data transmission over the HDMI cable.
- **3D Support:** Compatible with 3D video formats.
- **4K2K Resolution:** Supports resolutions up to 4K2K (3840 x 2160) at 30Hz.
- **Audio Return Channel (ARC):** Enables audio to be sent from a TV to an audio receiver via a single HDMI cable.
- **Gold-Plated Connectors:** Ensures corrosion resistance and enhanced signal transfer.



Figure 1: The SpeaKa Professional HDMI cable, featuring a 90-degree angled connector on one end and a straight connector on the other, both gold-plated. The cable is black and approximately 30 cm long.

## 2. SETUP INSTRUCTIONS

---

This section details the steps for connecting your SpeaKa Professional HDMI cable to your devices.

### 2.1 Connecting the Cable

1. **Identify HDMI Ports:** Locate the HDMI output port on your source device (e.g., Blu-ray player, game console, computer) and the HDMI input port on your display device (e.g., TV, monitor, projector). Ensure both devices are powered off before connecting.
2. **Connect Source Device:** Insert one end of the SpeaKa Professional HDMI cable into the HDMI output port of your source device. The angled connector can be particularly useful for devices mounted close to a wall or in tight spaces.
3. **Connect Display Device:** Insert the other end of the HDMI cable into the HDMI input port of your display device.

4. **Secure Connection:** Ensure both connectors are fully seated in their respective ports to establish a stable connection. Do not force the connectors.



Figure 2: Example of HDMI cable connections on the rear panel of electronic devices. The image shows various ports, including HDMI, with cables properly inserted, illustrating a typical setup configuration.

## 2.2 Initial Power-Up

1. **Power On Devices:** Turn on your display device first, then your source device.
2. **Select Input:** On your display device, select the correct HDMI input source using your remote control or device menu.
3. **Verify Signal:** Confirm that the audio and video signal from your source device is displayed correctly on your screen.

## 3. OPERATING INSTRUCTIONS

Once connected, the SpeakKa Professional HDMI cable facilitates the transmission of high-definition audio and video

signals. No specific operational steps are required for the cable itself, as it functions passively to transmit data between compatible devices.

### 3.1 Audio Return Channel (ARC)

If your TV and audio receiver both support ARC, connect the HDMI cable to the designated "HDMI ARC" port on both devices. This allows audio from your TV's internal tuner or smart apps to be sent back to your audio receiver without needing a separate optical audio cable.

### 3.2 HDMI Ethernet Channel (HEC)

For devices that support HEC, this cable can share an internet connection among multiple HDMI-connected devices without the need for a separate Ethernet cable. Ensure both connected devices are HEC-compatible and configured correctly in their respective settings.

## 4. MAINTENANCE AND CARE

---

Proper care of your HDMI cable will ensure its longevity and consistent performance.

- **Handling:** Always grasp the connector housing when plugging or unplugging the cable. Avoid pulling directly on the cable itself, as this can damage the internal wires or connectors.
- **Cleaning:** If connectors become dusty, gently wipe them with a dry, lint-free cloth. Do not use liquid cleaners directly on the connectors.
- **Storage:** When not in use, store the cable loosely coiled in a dry, cool place. Avoid sharp bends or kinks, which can damage the cable's internal structure.
- **Environment:** Keep the cable away from extreme temperatures, direct sunlight, and moisture.

## 5. TROUBLESHOOTING

---

If you encounter issues with your HDMI connection, refer to the following common troubleshooting steps:

- **No Picture/Sound:**
  - Ensure both devices are powered on.
  - Verify that the HDMI cable is securely connected to both the source and display devices.
  - Check that the correct HDMI input is selected on your display device.
  - Try connecting the cable to a different HDMI port on your display device, if available.
  - Test the cable with another set of devices, if possible, to rule out a faulty cable or device.
- **Intermittent Signal:**
  - Ensure the cable is not bent sharply or kinked.
  - Check for any physical damage to the cable or connectors.
  - Minimize interference by keeping the HDMI cable away from power cables or other electronic devices.
- **Poor Picture Quality (Flickering, Artifacts):**
  - Ensure your source device is outputting a resolution supported by your display device.
  - Check the display settings on both your source and display devices.
- **ARC/HEC Not Working:**
  - Confirm that both your TV and audio device support ARC/HEC and that the cable is connected to the designated ARC-enabled HDMI ports.
  - Enable ARC/HEC in the settings menus of both your TV and audio device.

## 6. TECHNICAL SPECIFICATIONS

---

Below are the detailed technical specifications for the SpeaKa Professional HDMI Connection Cable SP-7870508.

Feature	Specification
Model Number	SP-7870508
Cable Length	0.3 meters (30 cm)
Connector 1	HDMI Type A (Standard), Male, Straight
Connector 2	HDMI Type A (Standard), Male, Angled (90 degrees)
Connector Plating	Gold
Color	Black
Supported Resolutions	Up to 3840 x 2160 (4K2K) at 30Hz
Supported Video Modes	720p, 1080i, 1080p, 2160p
Data Transfer Rate	10.2 Gbit/s
Features	3D, Audio Return Channel (ARC), HDMI Ethernet Channel (HEC), Plug and Play
AWG Wire Size	30

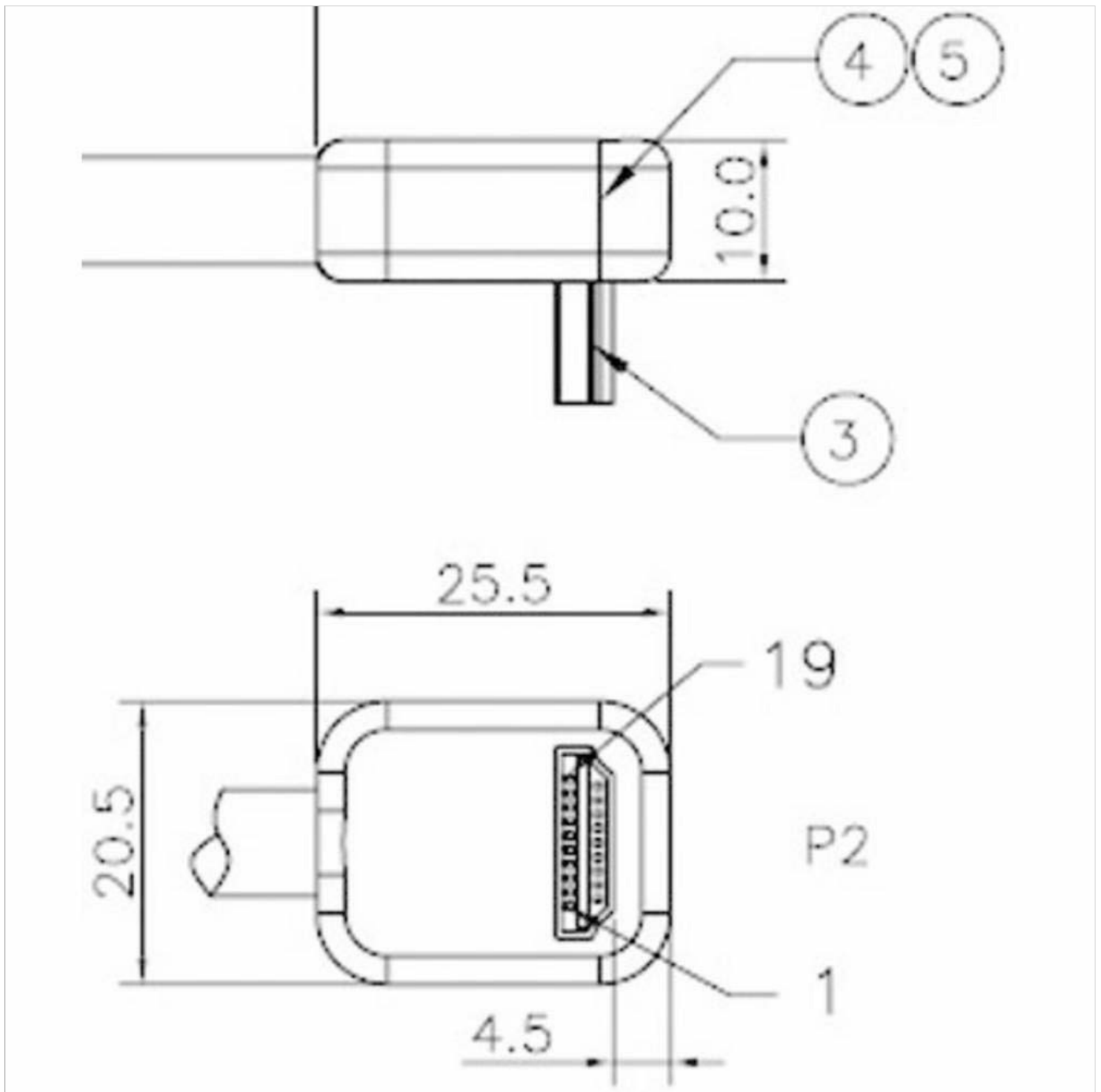

Figure 3: Technical drawing illustrating the dimensions of the HDMI connector, including measurements for width, height, and pin configuration. This diagram provides precise details for compatibility and design.

## 7. WARRANTY AND SUPPORT







For information regarding warranty coverage and technical support for your SpeaKa Professional HDMI Connection Cable, please refer to the documentation provided with your purchase or visit the official SpeaKa Professional website. Contact details for customer service are typically available on the manufacturer's website.

**Manufacturer:** SpeaKa Professional

**Date First Available:** October 23, 2020

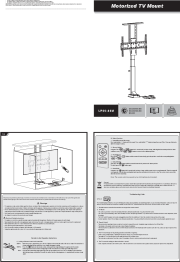

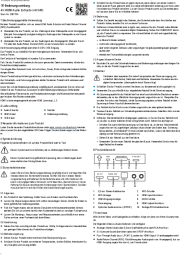
Related Documents - SP-7870508

	<p><a href="#">SpeaKa Smart Motorized TV Ceiling Mount User Manual and Safety Information</a></p> <p>Comprehensive guide for the SpeaKa Smart Motorized TV Ceiling Mount (models 2531304/SP-TVCM-510 and 2531305/SP-TVCM-520), covering intended use, safety instructions, installation, operation, cleaning, maintenance, and technical specifications.</p>
	<p><a href="#">SpeaKa Monitor Desk Stand Installation Instructions and Safety Guide</a></p> <p>Comprehensive installation instructions and safety guidelines for the SpeaKa Monitor Desk Stand (models 2523221 White, 2523220 Black). Learn how to safely assemble and use your monitor stand.</p>
	<p><a href="#">Motorized TV Mount LP66-46M Installation Manual</a></p> <p>Comprehensive installation manual for the LP66-46M Motorized TV Mount, detailing assembly, operation, and troubleshooting.</p>
	<p><a href="#">SpeaKa HT 60/80 Datasheet: Technical Specifications &amp; Frequency Response</a></p> <p>Detailed technical specifications and SPL vs. Frequency response graph for the SpeaKa HT 60/80 speaker. Includes impedance, power handling, frequency range, SPL, mounting dimensions, and more from Conrad Electronic.</p>
	<p><a href="#">SpeaKa Professional 4K HDMI Audio Extractor with ARC User Manual</a></p> <p>This manual provides instructions for the SpeaKa Professional 4K HDMI Audio Extractor with ARC, detailing its intended use, delivery contents, safety instructions, operation, cleaning, disposal, and technical specifications. It covers setup for various audio outputs including stereo, 5.1 surround sound, and pass-through audio, as well as the Audio Return Channel (ARC) functionality.</p>
	<p><a href="#">SpeaKa Professional SP-HDS-700 HDMI Extender User Manual</a></p> <p>User instructions for the SpeaKa Professional SP-HDS-700 HDMI 1x4 Splitter over Ethernet cable, detailing setup, operation, and technical specifications.</p>