

MARIE 1102-S

MARIE Automatic Door Closer User Manual

Model: 1102-S | For 55-100 lbs Residential and Commercial Light Doors

1. INTRODUCTION

This manual provides detailed instructions for the installation, operation, and maintenance of your MARIE Automatic Door Closer, Model 1102-S. Designed for residential and light-duty commercial applications, this hydraulic door closer ensures controlled and quiet door closure for doors weighing between 55 and 99 lbs (25-45 kg) and up to 32 inches (80 cm) wide. Please read this manual thoroughly before installation and use to ensure proper function and safety.

2. SAFETY INFORMATION

- Ensure all components are present and undamaged before installation.
- Do not attempt to disassemble the main closer body, as it contains pressurized hydraulic fluid.
- Adjustments to closing and latching speeds should be made carefully and incrementally. Over-tightening or completely unscrewing adjustment valves can cause oil leakage and damage the unit.
- Keep hands and fingers clear of moving parts during operation and adjustment.
- This product is designed for specific door weights and sizes. Using it on doors outside the recommended range may lead to improper function or damage.

3. PACKAGE CONTENTS

Verify that all the following items are included in your package:

- 1 x MARIE Automatic Door Closer Body
- 1 x Main Arm Assembly

- 1 x Parallel Arm Bracket
- Mounting Screws and Hardware
- Installation Template
- User Manual (this document)



Image: All components of the MARIE Automatic Door Closer, including the main body, arm, parallel arm bracket, and mounting screws.

4. SPECIFICATIONS

Feature	Detail
Model Number	1102-S
Applicable Door Weight	55-99 lbs (25-45 kg)
Applicable Door Width	Up to 32 inches (80 cm)

Feature	Detail
Material	Aluminum
Color	Sliver
Product Dimensions (Closer Body)	5.71 x 2.36 x 2.17 inches
Overall Product Dimensions	10.24"L x 3.07"W x 2.76"H
Item Weight	2.44 pounds
Installation Type	Screw-In
Recommended Uses	Residential and commercial, fire doors, exterior/interior doors
Certifications	CE, UL, EN1154

MARIE

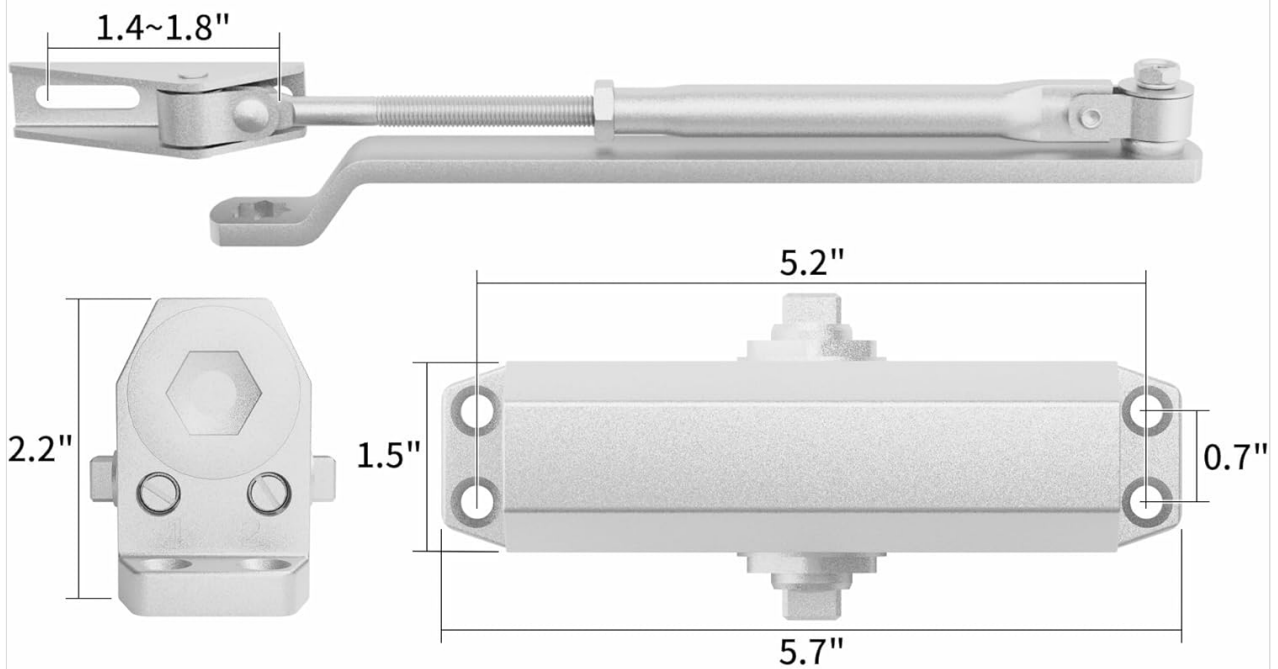

APPLICABLE DOOR WIDTH

MODEL	SIZE	DIMENSION	INTERIOR DOOR	DOOR WEIGHT
MD1101	1	5.7 × 1.5 × 2.2"	≤ 32"	33~66 Lbs
MD1102	2	5.7 × 1.5 × 2.2"	≤ 36"	55~99 Lbs
MD1303	3	7 × 1.6 × 2.5"	≤ 42"	99~143 Lbs
MD4404	4	8.7 × 2.1 × 1.8"	≤ 48"	143~189 Lbs
MD8626	1~6	9.3 × 2.4 × 1.7"	≤ 54"	66~264 Lbs

Image: Detailed dimensions of the door closer and a table indicating applicable door widths and weights for various models, highlighting MD1102 (Size 2) for 55-99 lbs doors.

5. SETUP AND INSTALLATION

The MARIE Automatic Door Closer offers universal installation options for various door configurations. Always use the provided template for accurate drilling.

5.1 Installation Methods

There are three primary installation methods:

1. **Regular Arm Installation:** Closer installs on the PULL/HINGE side of the door.
2. **Top Jamb Installation:** Closer installs on the frame on the PUSH/STOP side of the door.
3. **Parallel Arm Installation:** Closer installs on the PUSH/STOP side of the door, utilizing the parallel arm bracket. This method is often used when the door and frame are not on the same plane or for specific aesthetic requirements.

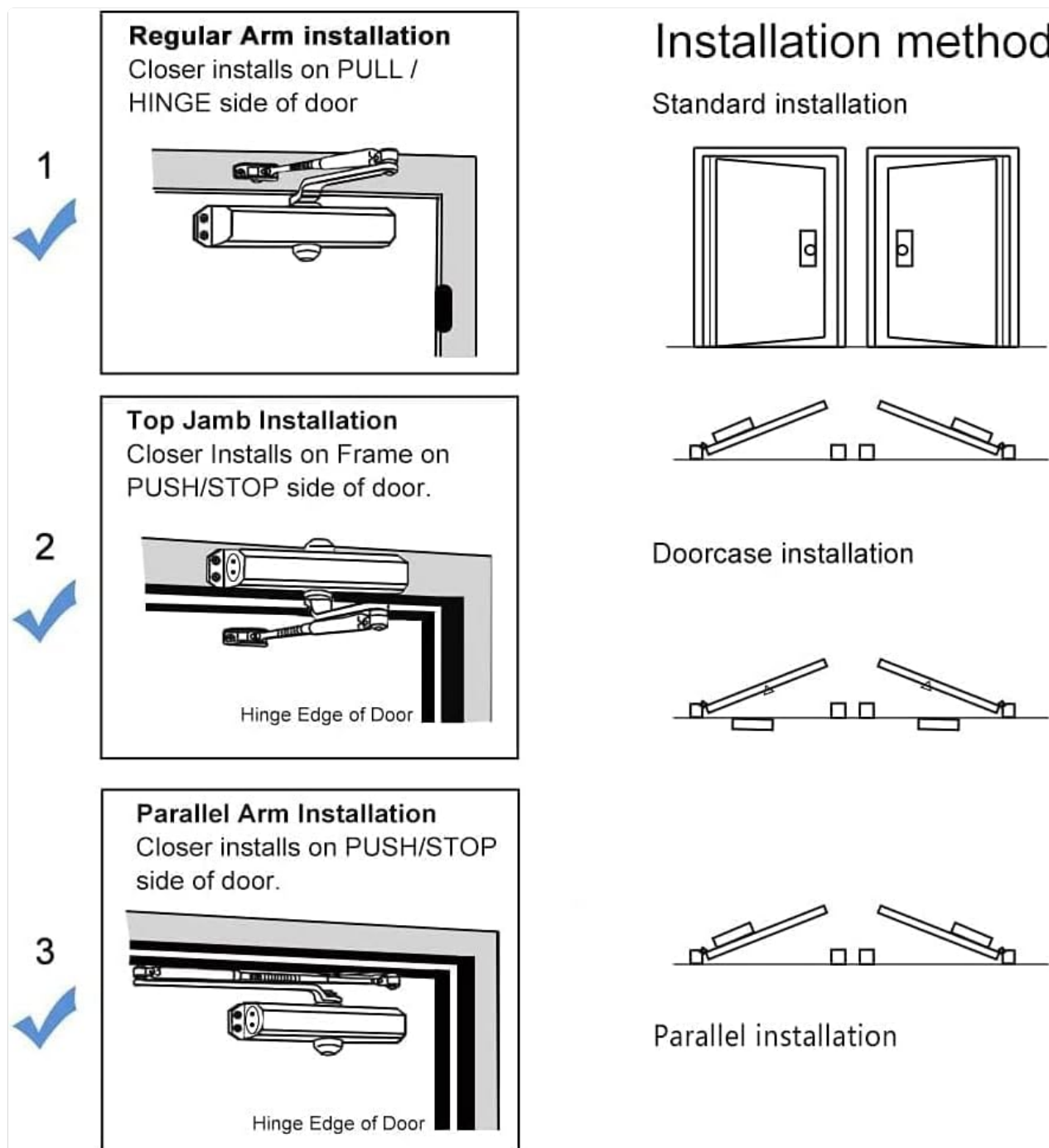

Image: Diagrams illustrating Regular Arm, Top Jamb, and Parallel Arm installation methods for the door closer.

5.2 Door Type Compatibility

This door closer is suitable for various door types, including metal doors, fire doors, wood doors, and glass doors with frames. For installations where the door and door frame are not on the same plane (within 5cm/1.97 inches), a parallel plate may be required. Contact support if you need this component.



Image: Examples of compatible door types (metal, fire, wood, glass) and a note regarding the need for a parallel plate if the door and frame are not flush.

5.3 Installation Video

For a visual guide, please refer to the official installation video. This video demonstrates the step-by-step process for a smooth installation.

Your browser does not support the video tag.

Video: Official installation guide for the MARIE Automatic Door Closer, demonstrating the setup process.

6. OPERATING INSTRUCTIONS AND ADJUSTMENTS

The MARIE Automatic Door Closer features adjustable closing and latching speeds to provide a soft, quiet, and controlled door closure.

6.1 Adjusting Closing and Latching Speed

The door closer has two adjustment valves (screws) located on the main body:

- **Valve 1 (Closing Speed Adjustment):** Controls the closing speed of the door from 15° to 180° (the main sweep). Turning clockwise decreases speed (cuts speed), turning anti-clockwise increases speed (speeds up).
- **Valve 2 (Latching Speed Adjustment):** Controls the latching speed of the door from 0° to 15° (the final closing phase). Turning clockwise decreases speed (cuts speed), turning anti-clockwise increases speed

(speeds up).

Attention: These valves must not be screwed out of the door closer body, as this will cause oil leakage and render the unit unusable.



Image: Close-up view of Valve 1 (closing speed) and Valve 2 (latching speed) adjustment screws, with directional indicators for increasing/decreasing speed.

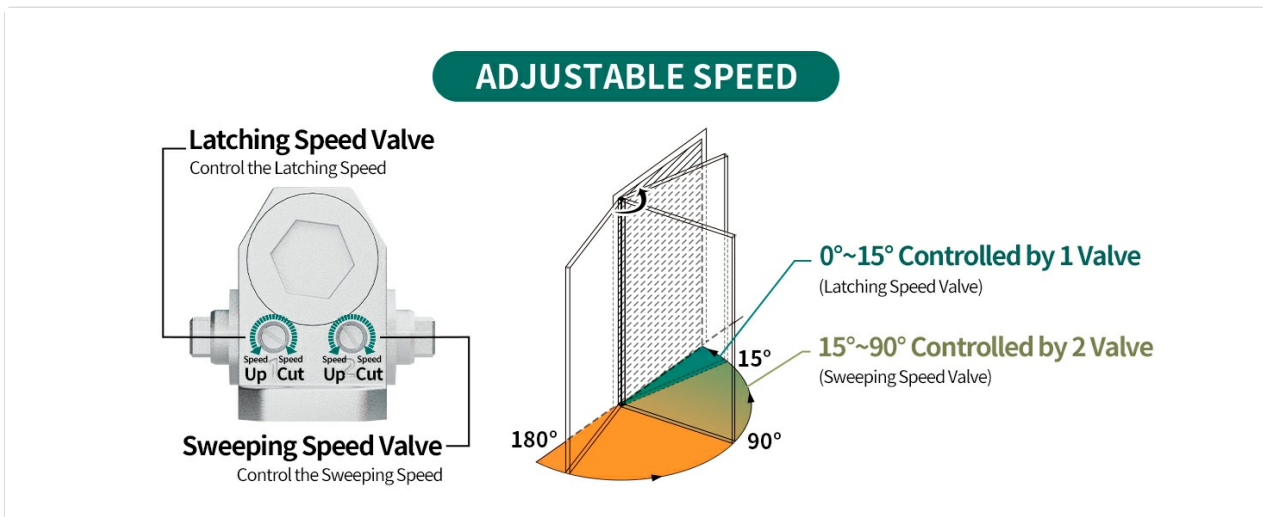

Image: Diagram illustrating how Valve 1 controls the closing speed from 15-90 degrees and Valve 2 controls the latching speed from 0-15 degrees.

6.2 Power Adjustment of Arm Shoe

The power of the door closer can be effectively increased or decreased by adjusting the position of the arm shoe. Moving the arm shoe closer to the door closer body generally increases the closing power, while moving it further away decreases it. This allows for fine-tuning the force required to close the door.

Effectively increase/decrease the power of the door closer



Image: Diagram showing how adjusting the arm shoe position affects the closing power (EN3 for 40-65KG, EN2 for 25-45KG, EN1 for 15-25KG).

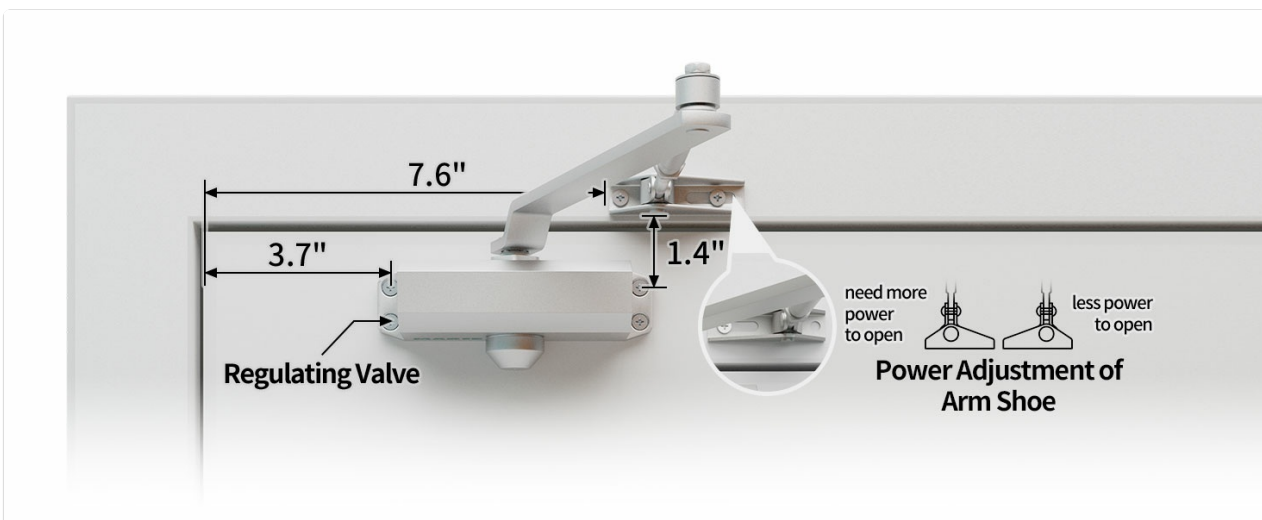

Image: Detailed diagram showing the regulating valve and how the arm shoe position can be adjusted to increase or decrease closing power.

6.3 Push/Pull Door Compatibility

The door closer is designed to work effectively with both push and pull doors, providing consistent closing performance regardless of the door's opening direction.

SUITABLE FOR PUSH/PULL DOORS



Image: Visual representation of the door closer installed on both a 'Pull' door and a 'Push' door, demonstrating its versatility.

6.4 Soft Close and Buffer Function

Proper adjustment of the closing and latching speeds enables a soft close, preventing the door from slamming shut. This buffer function enhances safety and reduces noise, making it suitable for environments where quiet operation is desired.

SOFT CLOSE, QUIET & BUFFER

Adjust the closing speed and latching speed
It can prevent you from getting caught by the door.
And frightened by closing the door vigorously.



Image: Illustration depicting the soft close and buffer feature, showing how the door closer prevents fingers from being caught and ensures quiet closure.

7. MAINTENANCE

The MARIE Automatic Door Closer is designed for durability and requires minimal maintenance. The stable hydraulic fluid ensures constant lubrication and reliable operation in various climates.

- **Regular Inspection:** Periodically check all mounting screws to ensure they are tight.
- **Cleaning:** Wipe the exterior of the door closer with a soft, damp cloth to remove dust and grime. Avoid using harsh chemicals.
- **Lubrication:** The internal hydraulic system is self-lubricating and does not require external lubrication.
- **Environmental Resistance:** The unit is designed to be weatherproof, heat-resistant, frost-resistant, and anti-rust, making it suitable for both indoor and outdoor use.

CAN BE USED INDOORS & OUTDOORS



WEATHER PROOF



HEAT RESISTANCE



FROST RESISTANCE



ANTI-RUST



Image: Icons and text indicating the door closer's suitability for indoor and outdoor use, highlighting its weatherproof, heat resistance, frost resistance, and anti-rust properties.

8. TROUBLESHOOTING

If you encounter issues with your door closer, refer to the following common problems and solutions:

Problem	Possible Cause	Solution
Door slams shut	Closing or latching speed is too fast.	Turn Valve 1 (closing speed) and/or Valve 2 (latching speed) clockwise to decrease speed. Adjust incrementally.
Door does not close completely	Closing or latching speed is too slow, or insufficient power.	Turn Valve 1 and/or Valve 2 anti-clockwise to increase speed. Check arm shoe position for power adjustment. Ensure no obstructions.

Problem	Possible Cause	Solution
Oil leakage from closer body	Adjustment valves unscrewed too far, or unit is damaged.	Ensure adjustment valves are not fully unscrewed. If leakage persists, the unit may be damaged and require replacement. Do not attempt to repair internally.
Door closer makes excessive noise	Improper installation or loose components.	Verify all mounting screws are tight. Check for proper alignment of the arm assembly. Adjust closing speeds to prevent slamming.

9. WARRANTY

All MARIE hydraulic door closers are warranted for **Five (5) years** from the date of purchase. This warranty covers defects in materials and workmanship under normal use. If you are not satisfied with the product, you may return or exchange it within 30 days of purchase. For any quality problems with the door closer, please contact us for assistance.

10. SUPPORT

For further assistance, technical support, or warranty claims, please contact MARIE customer service. Refer to your purchase documentation or the MARIE brand store on Amazon for contact details.

Visit the [MARIE Store on Amazon](#).