

Ibergrif M14026B

Ibergrif M14026B Arial Black Kitchen Tap User Manual

Model: M14026B | Brand: Ibergrif

1. PRODUCT OVERVIEW

The Ibergrif M14026B Arial Black Kitchen Tap is a modern and functional sink mixer designed for kitchen use. It features a durable matte black finish and a 360-degree swiveling spout for maximum control and flexibility. Equipped with a superior ceramic cartridge, this faucet ensures reliable, leak-free operation for its lifespan. Its design focuses on ease of installation and maintenance, providing a comfortable and efficient user experience.

UNIT:MM

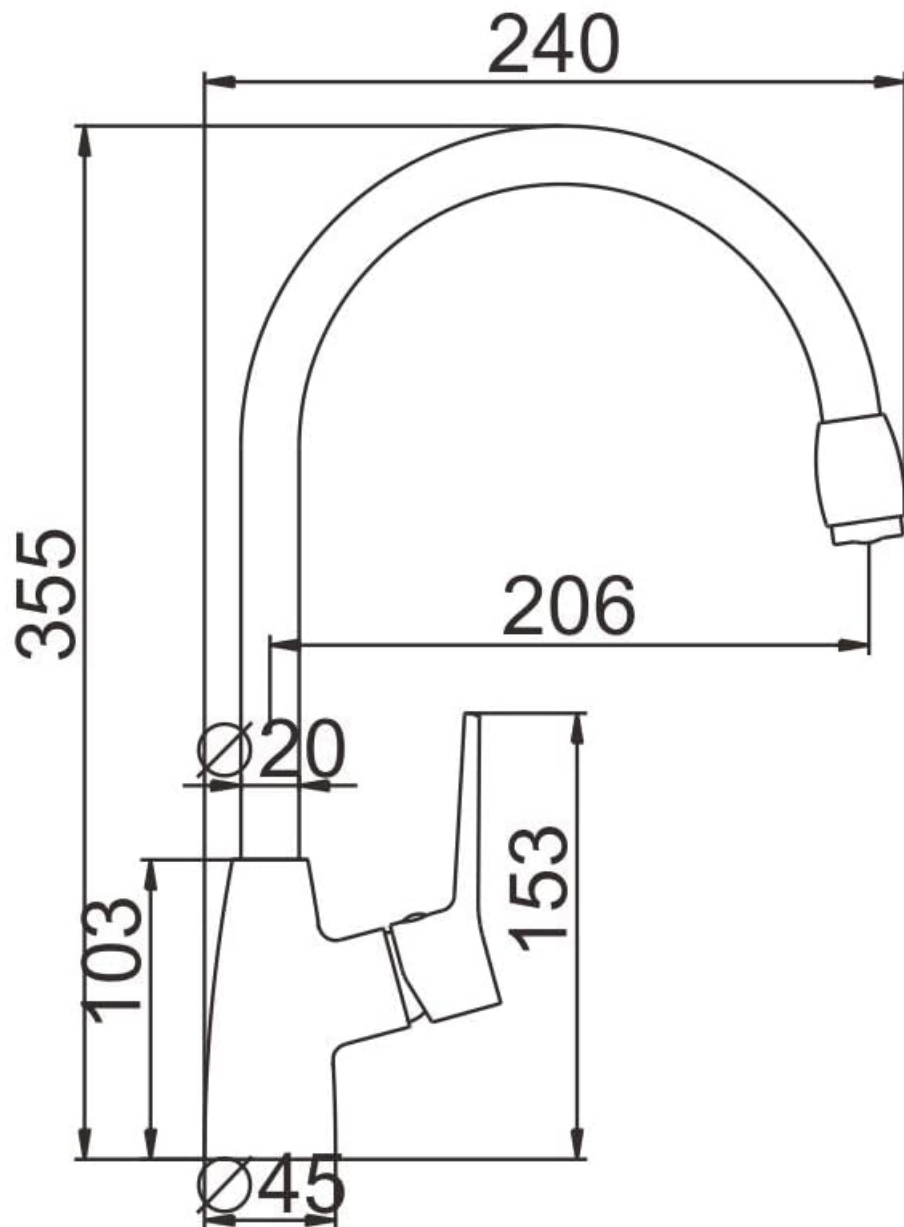

A complete view of the Ibergrif M14026B Arial Black Kitchen Tap, showcasing its matte black finish and elegant design.

2. PACKAGE CONTENTS

Please verify that all components are present and undamaged before beginning installation.

- 1 x Kitchen Tap (Ibergrif M14026B)
- 1 x Installation Kits (mounting hardware)
- 2 x 40 cm G3/8 inch Hose Pipes (flexible connectors)



An overview of all parts supplied with the Ibergrif M14026B kitchen tap, such as the tap body, flexible hoses, and installation kit.

3. SPECIFICATIONS

Feature	Detail
Model Number	M14026B
Manufacturer	Ibergrif Griferias S.L
Colour	Black
Finish Type	Matte Black
Style	Traditional
Installation Method	Single Hole
Mounting Type	Deck Mount

Number of Handles	1
Handle Material	Brass
Special Features	360° Swivel Spout
Product Dimensions	42 x 21 x 5 cm
Item Weight	1.39 kg



A schematic diagram providing precise measurements and dimensions for the Ibergrif M14026B kitchen tap, useful for installation planning.

4. SAFETY INFORMATION

- Always turn off the main water supply before attempting any installation or maintenance.
- Wear appropriate personal protective equipment, such as safety glasses and gloves, during installation.
- Ensure all connections are tightened securely to prevent leaks, but do not overtighten.
- If you are unsure about any part of the installation process, consult a qualified plumber.

- Keep small parts out of reach of children.

5. INSTALLATION GUIDE

This section provides general steps for installing your Ibergrif M14026B kitchen tap. Refer to the detailed instructions included in your installation kit for specific diagrams and additional guidance.

Tools You May Need:

- Adjustable wrench
- Phillips screwdriver
- Basin wrench (optional, for tight spaces)
- Sealant tape (Teflon tape)
- Bucket and towels

Installation Steps:

1. **Prepare the Sink Area:** Turn off the main water supply to your kitchen. Open the existing faucet to drain any remaining water. Place a bucket under the sink to catch drips.
2. **Remove Old Faucet (if applicable):** Disconnect the hot and cold water supply lines from the old faucet. Unscrew the mounting nuts from underneath the sink and remove the old faucet. Clean the sink surface thoroughly.
3. **Install the New Faucet:** Insert the new Ibergrif M14026B tap into the single hole on your sink or countertop. Ensure the rubber gasket is placed between the faucet base and the sink surface to create a watertight seal.
4. **Secure the Faucet:** From underneath the sink, slide the metal washer and mounting nut onto the threaded rod of the faucet. Hand-tighten the nut, then use an adjustable wrench to secure it firmly. Do not overtighten.
5. **Connect Water Supply Lines:** Attach the two 40 cm G3/8 inch hose pipes (included) to the hot and cold water inlets on the bottom of the faucet. Ensure the hot water line connects to the hot inlet and the cold water line to the cold inlet. Use sealant tape on the threads for a better seal.
6. **Connect to Main Water Supply:** Connect the other ends of the flexible hoses to your hot and cold water supply valves. Tighten connections with an adjustable wrench.
7. **Test for Leaks:** Slowly turn on the main water supply. Check all connections for leaks. If leaks are present, tighten the connections slightly until they stop.
8. **Flush the Faucet:** Remove the aerator from the spout. Turn on the faucet to full hot and cold positions for a few minutes to flush out any debris from the water lines. Turn off the faucet, reattach the aerator, and check for proper water flow.



The base of the Ibergriif M14026B tap, showing the threaded rod and mounting plate for secure installation.

6. OPERATION

The Ibergriif M14026B kitchen tap features a single lever handle for controlling both water temperature and flow, along with a highly versatile swiveling spout.

- **Water Flow Control:** Lift the handle upwards to increase water flow. Push it downwards to decrease or turn off the water.
- **Temperature Control:** Move the handle to the left for hot water and to the right for cold water. Adjust the position between left and right to achieve your desired water temperature.
- **Swiveling Spout:** The spout can rotate 360 degrees, allowing you to direct water precisely where needed in your sink, making it ideal for double sinks or large pots.



The Ibergriif M14026B kitchen tap shown in an installed setting, demonstrating water flow into a sink.

7. MAINTENANCE

Proper maintenance will ensure the longevity and continued performance of your Ibergriif M14026B kitchen tap.

- **Cleaning the Finish:** The matte black surface is designed for easy cleaning. Use a soft cloth and mild soap and water to clean the tap. Avoid abrasive cleaners, harsh chemicals, or scouring pads, as these can damage the finish. Rinse thoroughly and dry with a soft cloth to prevent water spots.
- **Aerator Cleaning:** If water flow becomes restricted or uneven, the aerator may be clogged with mineral deposits. Unscrew the aerator from the end of the spout, clean it with a brush under running water, or soak it in a vinegar solution to remove mineral buildup. Rinse and reattach.
- **Ceramic Cartridge:** The tap is equipped with a high-quality ceramic cartridge designed for leak-free operation. No regular maintenance is typically required for the cartridge itself. If persistent leaks occur from the handle area, consult a professional plumber.



A magnified image of the aerator located at the tip of the Ibergrif M14026B tap spout, designed for efficient water flow.

8. TROUBLESHOOTING

This section addresses common issues you might encounter with your kitchen tap.

- **Low Water Flow:**

Possible Cause: Clogged aerator.

Solution: Remove and clean the aerator as described in the Maintenance section.

Possible Cause: Partially closed water supply valves.

Solution: Ensure both hot and cold water supply valves under the sink are fully open.

- **Leaks from Spout:**

Possible Cause: Damaged aerator or internal seals.

Solution: Clean or replace the aerator. If the leak persists, contact customer support.

- **Leaks from Base of Faucet:**

Possible Cause: Loose mounting nut or improper seal.

Solution: Tighten the mounting nut underneath the sink. Ensure the rubber gasket is correctly seated. If the leak persists, you may need to re-install the faucet with new sealant.

- **Leaks from Handle:**

Possible Cause: Worn ceramic cartridge.

Solution: While the ceramic cartridge is designed for long-term use, if a leak develops from the handle, the cartridge may need replacement. Contact customer support for assistance.

9. WARRANTY AND SUPPORT

Ibergriif products are manufactured to high-quality standards and are backed by a manufacturer's warranty. For specific warranty details, please refer to the documentation included with your purchase or visit the official Ibergriif website.

If you require technical assistance, have questions about installation, or need to report a defect, please contact Ibergriif customer support. Contact information can typically be found on the product packaging or the official Ibergriif website.