

AMIR JGUS-WA43

AMIR Wireless Refrigerator Thermometer User Manual

MODEL: JGUS-WA43

Your guide to setting up, operating, and maintaining your AMIR Wireless Digital Refrigerator Thermometer.

1. Introduction

The AMIR Wireless Refrigerator Thermometer is designed to help you monitor temperatures in your refrigerator, freezer, or even outdoors with ease. It features two wireless sensors and a main display unit, providing real-time temperature readings and an audible alarm for temperature fluctuations, ensuring optimal food storage conditions.



Figure 1: Main display unit and two wireless remote sensors.

2. Package Contents

Please check the package for the following items:

- 1 x Main Display Unit
- 2 x Wireless Remote Sensors
- 1 x USB Power Cable (for main unit)
- 1 x User Manual (this document)

Note: 3 x AAA batteries for the main unit and 2 x AA batteries for each remote sensor (total 4 x AA batteries) are NOT included and must be purchased separately.

3 Mounting Options

Magnet, Standing, Hanging

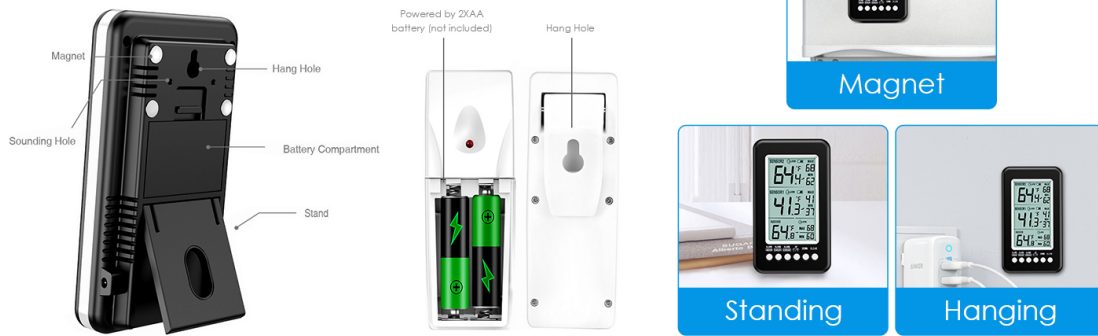

Figure 2: Components of the thermometer system, highlighting battery requirements.

3. Product Features

- **Dual Wireless Sensors:** Monitor indoor temperature and two separate outdoor/appliance temperatures simultaneously.
- **Audible Alarm:** Set customizable maximum and minimum temperature thresholds. The main unit will sound an alarm if temperatures exceed or fall below these set points.

UPPER/LOWER LIMIT ALARM

Allows you to set alerts when temperature readings reach certain thresholds



Figure 3: Visual representation of the upper/lower limit alarm feature.

- **Easy-to-Read LCD Display:** Features a large digit display for clear visibility. Records and displays Min/Max historical temperature readings, allowing you to track temperature changes.

Large Screen Display

- 1 Sensor Alarm2
- 2 Sensor Alarm1
- 3 Indoor Alarm
- 4 Up/Celsius temperature /Fahrenheit temperature
- 5 Down Value
- 6 Clear Max/Min Value
- 7 Temperature (Indoor)
- 8 MAX Temperature
- 9 MIN Temperature



Figure 4: Detailed view of the large LCD screen and its various indicators.

- **Wide Temperature Range:**

- Indoor: -10°C to 60°C (14°F to 140°F)
- Outdoor/Sensor: -40°C to 60°C (-40°F to 140°F)

- **Long Transmission Range:** Wireless transmission range of up to 100 meters (328 feet) in open areas.

- **Multiple Installation Options:** The main display unit can be placed on a table using its built-in stand, mounted on a wall using the hang hole, or attached to a metal surface with its integrated magnet. Remote sensors can be clipped or hung.

3 Mounting Options



Figure 5: Various mounting options for the main display unit.

4. Setup Guide

4.1. Battery Installation

1. **Main Display Unit:** Open the battery compartment on the back. Insert 3 x AAA batteries, ensuring correct polarity (+/-). Alternatively, connect the provided USB cable for continuous power.

2 Power Supply Modes



Powered by USB
Cable (included)



Powered by 3×AAA
battery (not included)

Figure 6: Power supply options for the main unit (USB or AAA batteries).

2. **Wireless Remote Sensors:** Open the battery compartment on each sensor. Insert 2 x AA batteries into each sensor, observing correct polarity.

4.2. Sensor Pairing

The sensors should automatically pair with the main unit once batteries are installed. If pairing does not occur, ensure both the main unit and sensors have fresh batteries and are within range. You may need to press a reset button on the sensor or main unit (refer to specific button functions in Section 5.1) to initiate pairing.

4.3. Placement

- **Main Display Unit:** Place it in a convenient location where you can easily read the display. Use the fold-out stand for tabletop placement, the magnet for refrigerator doors, or the hang hole for wall mounting.
- **Wireless Remote Sensors:** Place one sensor inside your refrigerator and the other inside your freezer. They can be clipped to a shelf or hung. For outdoor use, ensure the sensor is protected from direct weather exposure.

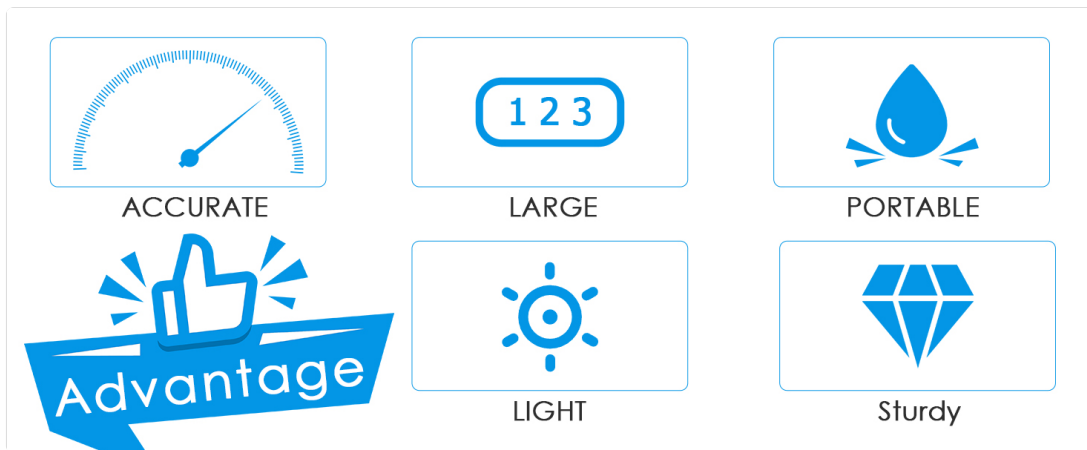

Figure 7: Examples of sensor and main unit placement.

5. Operating Instructions

5.1. Button Functions

The main unit has several buttons for operation:

- **ALARM:** Activates/deactivates the audible alarm.
- **INDOOR/SENSOR1/SENSOR2:** Cycles through alarm settings for indoor, sensor 1, and sensor 2 temperatures.
- **°C/°F:** Toggles between Celsius and Fahrenheit temperature units.
- **UP/DOWN:** Adjusts alarm temperature settings.
- **CLEAR:** Clears recorded Min/Max temperatures.

5.2. Reading Temperatures

The LCD display shows three temperature readings:

- **INDOOR:** Temperature at the main display unit's location.
- **SENSOR 1:** Temperature from the first wireless remote sensor.
- **SENSOR 2:** Temperature from the second wireless remote sensor.

Each reading also shows the recorded MAX (highest) and MIN (lowest) temperatures since the last reset.

5.3. Setting Temperature Alarms

To set high and low temperature alarms for each channel:

1. Press the **ALARM** button to select the channel (INDOOR, SENSOR 1, or SENSOR 2) you wish to set an alarm for.
2. Press the **UP** or **DOWN** buttons to adjust the desired maximum (MAX) temperature.
3. Press the **ALARM** button again to move to the minimum (MIN) temperature setting for the selected channel.
4. Press the **UP** or **DOWN** buttons to adjust the desired minimum (MIN) temperature.
5. Repeat for other channels as needed.
6. Ensure the alarm function is activated (an alarm icon should be visible on the display for the respective channel).

6. Specifications

Feature	Detail
Model Number	JGUS-WA43
Indoor Temperature Range	-10°C ~ 60°C (14°F ~ 140°F)
Outdoor/Sensor Temperature Range	-40°C ~ 60°C (-40°F ~ 140°F)
Transmission Range	100M / 328ft (open area)
Main Unit Power	3 x AAA batteries (not included) or USB cable (included)
Sensor Power	2 x AA batteries per sensor (not included)
Display Type	Digital LCD
Outer Material	Plastic
Color	Black
Connectivity Technology	Bluetooth
Package Dimensions	6.22 x 3.9 x 2.72 inches
Item Weight	9.91 ounces



7. Maintenance

- **Cleaning:** Wipe the unit and sensors clean with a soft, damp cloth. Do not immerse in water.
- **Battery Replacement:** Replace batteries in both the main unit and sensors when the low battery indicator appears on the display to ensure continuous and accurate readings.
- **Storage:** If storing the thermometer for an extended period, remove all batteries to prevent leakage.
- **Freezer Safe:** The remote sensors are designed to operate safely within freezer temperatures.

8. Troubleshooting

- **No Temperature Reading / Sensor Offline:**
 - Check if batteries are correctly installed and have sufficient power in both the main unit and the remote sensor. Replace if necessary.
 - Ensure the remote sensor is within the 100M (328ft) transmission range of the main unit, especially in open areas. Walls and obstacles can reduce range.
 - Try re-pairing the sensor by removing and reinserting its batteries, then ensuring the main unit is powered on.
- **Inaccurate Readings:**
 - Ensure sensors are not placed directly next to cooling vents or heating elements, which can cause localized temperature anomalies.
 - Allow sufficient time (e.g., 30 minutes) for the sensors to stabilize after placement.
- **Alarm Not Sounding:**
 - Verify that the alarm function is activated for the specific channel (check for the alarm icon on the display).
 - Confirm that the set MAX/MIN alarm temperatures are appropriate for your desired range.
- **Min/Max Readings Resetting Unexpectedly:**
 - The device may have an automatic reset interval for Min/Max readings. Consult the quick start guide or product support for specific details on this feature.
 - Ensure stable power supply to the main unit. Power interruptions can sometimes reset readings.

9. Warranty and Support

AMIR is committed to providing high-quality products and excellent customer service.

- **Quality Guarantee:** This product comes with a 12-month quality guarantee from the date of purchase.
- **Customer Support:** Enjoy 24/7 support and lifetime customer service. For any inquiries or assistance, please refer to the contact information provided with your product packaging or visit the official AMIR website.

