

Manuals.plus /

- › EACCESSORIES EA /
- › EACCESSORIES EA Universal License Plate Tag Holder Mount Instruction Manual

EACCESSORIES EA Flat License Plate Bracket / License Plate Tag Holder

EACCESSORIES EA Universal License Plate Tag Holder Mount Instruction Manual

Model: Flat License Plate Bracket / License Plate Tag Holder

1. INTRODUCTION

This manual provides detailed instructions for the installation and use of the EACCESSORIES EA Universal License Plate Tag Holder Mount. Designed for a wide range of vehicles, this bracket offers a secure and aesthetic solution for mounting standard 6 x 12-inch license plates from the USA, Canada, and Mexico. It is constructed from durable ABS plastic to withstand various weather conditions.

Key Features:

- **Easy Installation:** Features 4 built-in nuts for a straightforward setup.
- **Universal Compatibility:** Suitable for all flat bumpers on cars, SUVs, trucks, and golf carts.
- **Complete Hardware:** Includes all necessary mounting hardware.
- **Standard Size:** Fits 6 x 12-inch license plates.
- **Durable Material:** Made from robust ABS plastic.

2. SETUP AND INSTALLATION

The EACCESSORIES EA License Plate Bracket is designed for easy installation. Please follow the steps below carefully.

2.1 Package Contents

Verify that all components are present in your package:

- EACCESSORIES EA Universal License Plate Bracket
- Sharp Screws (2)
- Flat Screws (4)
- Zip Ties (2)



Image 2.1: Overview of the EACCESSORIES EA Universal License Plate Bracket and included mounting hardware.

2.2 Installation Instructions

There are two primary methods for installation, depending on whether your vehicle has existing holes on the bumper.

BOLTS DESIGN !



All bolts are made under the Phillips screwdriver!



Impossible to unscrew the license plate with a Star Key Wrench and Flat Head

Image 2.2: Visual guide for installing the license plate bracket on a vehicle bumper.

Method 1: Vehicles with Existing License Plate Holes on the Bumper

1. Align the bracket with existing holes in the bumper. Use the two sharp screws provided to securely fasten the bracket. It is recommended to use the screws that come with this bracket.
2. Align the four holes of your license plate with the four round holes (with copper nuts) in the bracket.

3. Use the four flat screws to fasten your license plate to the bracket.

Method 2: Vehicles without License Plate Holes on the Bumper

1. Decide on the mounting location for the bracket on your vehicle's bumper.
2. Place the bracket on the chosen mounting location and mark the position of the holes on the bumper. The distance between two holes cannot exceed the maximum possible distance of pushed-in slots on the bracket.
3. **For Curved Bumpers:** If attaching the bracket in the center of a curved bumper is not possible, place screws close to the center of the bracket. Alternatively, the bracket can be placed on a left/right flat side of the bumper.
4. Drill screw holes at the previously marked points. The screw holes must be smaller in diameter than the provided sharp screws.
5. Place the bracket onto the bumper and use the two sharp screws, pushing them through the bracket's pushed-in slots into the drilled holes of the bumper. Tighten one screw at a time.
6. Align the four holes of your license plate with the four round holes (with copper nuts) in the bracket.
7. Use the four flat screws to fasten your license plate to the bracket.

Alternative Installation with Zip Ties: The tag holder can also be installed using the plastic zip ties included in the pack, especially useful for temporary mounting or when drilling is not desired.



Image 2.3: Bracket secured with zip ties for flexible mounting.

2.3 Important Notes on Screws

All included bolts are designed for a Phillips screwdriver. This design prevents removal with a Star Key Wrench or Flat Head screwdriver, enhancing security.



License Plate Bracket

This bracket is designed to hold USA & Canada standard 6" x 12" License Plate

INSTALLATION INSTRUCTIONS:

Vehicles with existing license plate holes on the bumper from the previous use.

1. Align bracket with existing 2 holes in a bumper and use sharp screws (2) that came with this bracket to tight in securely to bumper (we recommend to use the wrench that comes with this bracket).
2. Align 4 holes of your License plate with 4 round holes with copper nuts in bracket. Use flat screws (4) to fasten your license plate.

Vehicles without license plate holes on the bumper.

1. Decide on the mounting location of the bracket on your vehicle's bumper.
2. Place the bracket to the chosen mounting location and mark the position of the holes on the bumper (distance between 2 holes cannot exceed maximum possible distance of pushed in slots on the bracket).
- 2a. When placing the bracket on the center of the curved bumper, place screws close to the center of the bracket.
- 2b. If it's not possible to attach the bracket in the center of the curved bumper, it can be placed on left/right flat side of the bumper.
3. Drill the screw holes at the previously marked points (the screw holes, must be smaller in diameter than provided sharp screws).

4. Place the bracket to the bumper and using sharp screws (2) going through the bracket's pushed in slots into drilled holes of the bumper and tighten it one screw at a time.

5. Align 4 holes of your license plate with 4 round holes with copper nuts in bracket. Use flat screws (4) to fasten your license plate.

****Please see the diagram for visual assistance****

THIS PACKAGE INCLUDES:

- (2) sharp screws
- (4) flat screws
- (2) zip ties

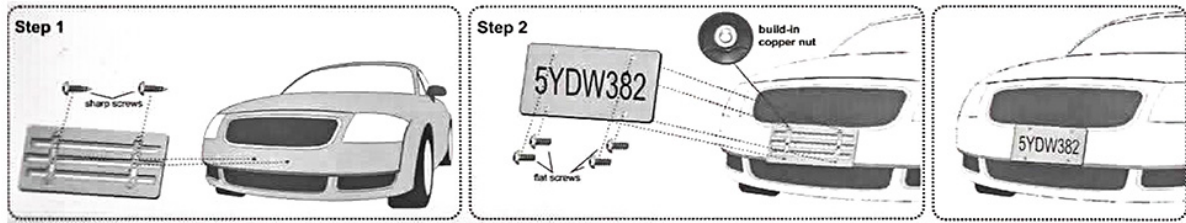

Image 2.4: Illustration of the Phillips head screw design.

The provided screws are specifically sized to match the bracket's depth, ensuring they do not protrude from the rear side and potentially scratch your bumper.

3. OPERATING INSTRUCTIONS

Once installed, the EACCESSORIES EA Universal License Plate Tag Holder Mount requires no specific operational procedures. It functions as a static mounting point for your license plate. Ensure all screws are tightened securely to prevent rattling or detachment during vehicle operation.



Image 3.1: The license plate bracket securely mounted on a vehicle's front bumper.

4. MAINTENANCE

The EACCESSORIES EA License Plate Bracket is made from durable ABS plastic, designed for minimal maintenance. To ensure longevity and appearance:

- **Cleaning:** Clean the bracket periodically with mild soap and water to remove dirt and road grime. Avoid harsh chemicals or abrasive cleaners.
- **Inspection:** Regularly check all mounting screws and zip ties (if used) for tightness. Re-tighten as necessary to prevent loosening due to vehicle vibrations.
- **Damage:** In case of damage to the bracket, consider replacement to ensure secure license plate attachment.

5. TROUBLESHOOTING

This section addresses common issues you might encounter during installation or use.

5.1 Bracket Does Not Fit

- **Issue:** The bracket does not sit flush on the bumper.
- **Solution:** This universal bracket is designed for flat bumper surfaces. It will not work on curved sections of a bumper. Ensure you are attempting to mount it on a flat area.

**SCREWS THAT OTHER SELLERS PROVIDE ARE LONGER THAN
BRACKET DEPTH
THEY MAY SCRATCH YOUR BUMPER !!!
(OUR SCREWS PERFECTLY MATCH DEPTH OF OUR BRACKET AND WILL
NEVER STICK OUT FROM THE REAR SIDE OF IT)**

This is not an OEM bracket.

It's a universal design made to fit all make and models.

May require new holes in the bumper.

**"Use your vehicle's original screws if holes are already
present on the bumper."**

Universal Front License Plate Bracket has Flat shape.

**This is universal bracket that needs to be mounted on flat
shape part of the bumper.**

**You can fit this bracket to your bumper on plastic zipper also.
Will Not Work On Curved Spots Of Bumper.**

Image 5.1: Important note regarding flat bumper compatibility.

- **Issue:** Existing bumper holes do not align with the bracket.
- **Solution:** The bracket may require additional holes to be drilled in the bumper. Alternatively, if holes are already present, you may use your vehicle's original screws if they are compatible. The bracket also supports installation using the provided plastic zip ties.

5.2 Screws Do Not Fit or Are Missing

- **Issue:** Screws provided are not as described or are missing.
- **Solution:** Verify package contents against the list in Section 2.1. If components are missing or incorrect, contact customer support. Note that the screws are Phillips head, not star head or allen key.

6. SPECIFICATIONS

Detailed technical specifications for the EACCESSORIES EA Universal License Plate Tag Holder Mount.

Attribute	Detail
Brand	EACCESSORIES EA
Model	Flat License Plate Bracket / License Plate Tag Holder
Manufacturer Part Number	USULPB_X1_X200
UPC	751499132764
Color	Black
Product Dimensions	6"L x 12"W
Finish Type	Plastic
Material	ABS Plastic
Vehicle Service Type	Car, SUV, Truck, Van, convertible, coupe, pick-up, sedan, sport car
Automotive Fit Type	Vehicle Specific Fit (for flat bumpers)

UNIVERSAL BRACKET THAT FITS ALL BRANDS OF CARS!

12 inches

6 inches

Use Amazon Car Fitment Tool To Make Sure That Bracket Fits Your Vehicle!

6" x 12" USA, CANADA & MEXICO STANDARD

Image 6.1: Dimensions of the EACCESSORIES EA Universal License Plate Bracket.

7. WARRANTY INFORMATION

Specific warranty details for the EACCESSORIES EA Universal License Plate Tag Holder Mount are not provided in the product information. For warranty inquiries, please refer to the seller's return policy or contact the manufacturer directly.

8. CUSTOMER SUPPORT

For further assistance, questions, or to report issues, please contact the seller or manufacturer through the platform where the product was purchased. Refer to your purchase documentation for specific contact information.

