

## Manuals+

[Q & A](#) | [Deep Search](#) | [Upload](#)

Manuals.plus /

> [weJupit](#) /

> WeJupit Wireless USB C to HDMI Extender Kit WJEXT15-2 Instruction Manual

## weJupit WJEXT15-2

# WeJupit Wireless USB C to HDMI Extender Kit

MODEL: WJEXT15-2

## 1. Product Overview

The WeJupit Wireless USB C to HDMI Extender Kit (Model WJEXT15-2) provides a seamless solution for wirelessly transmitting high-definition 1080p video and audio from your USB Type-C enabled devices to a TV or projector. Designed for ease of use, this plug-and-play system eliminates the need for complex wiring, offering flexibility and convenience for various applications.

### Key Features:

- **Wireless HD Transmission:** Supports video and audio transmission via USB Type-C to HDMI.
- **Smooth Performance:** Engineered for minimal lag and strong anti-interference capabilities, operating at a 5GHz frequency.
- **Easy Setup:** Features a plug-and-play design for quick and effortless installation without software or drivers.
- **High Resolution:** Supports resolutions up to 1080p at 60Hz.
- **HDMI 1.3 & HDCP 1.2 Compatible:** Ensures broad compatibility with various display devices.
- **USB Type-C Powered:** Both transmitter and receiver are powered directly by the input source via USB Type-C ports.
- **Point-to-Point Configuration:** Supports direct wireless connection between the transmitter and receiver.
- **Extended Range:** Capable of 15m (50ft) long-range transmission with clear line of sight.

## 2. What's in the Box

Verify that all components are present in your package:

- 1x Wireless HDMI Transmitter (TX)
- 1x Wireless HDMI Receiver (RX)
- 2x Micro USB Power Cables
- 1x HDMI Extension Cable
- 1x User Guide

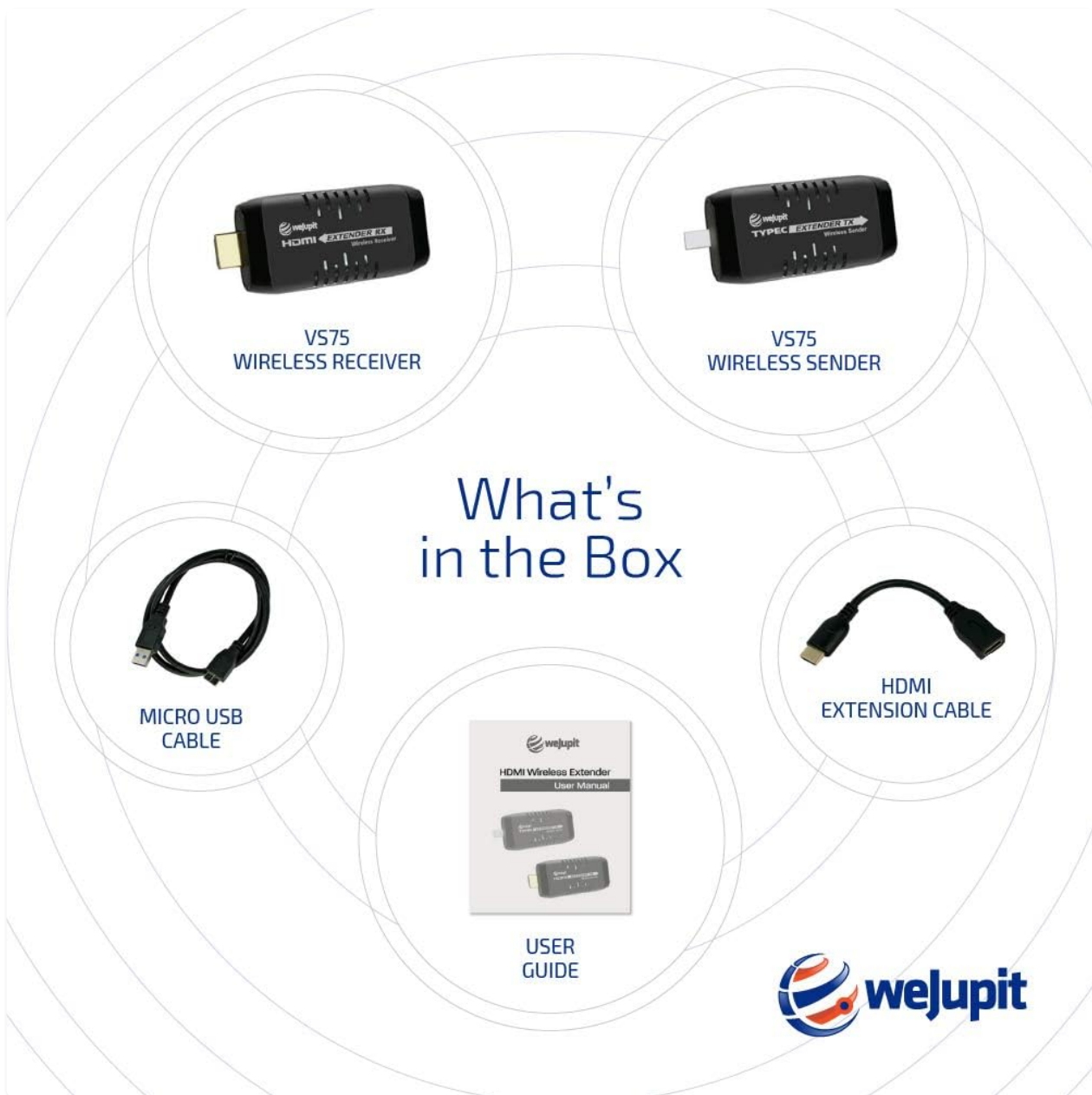

**Figure 1:** The package contents include the Transmitter (TX), Receiver (RX), two Micro USB power cables, an HDMI extension cable, and the user guide.

### 3. Setup Instructions

Follow these simple steps to set up your WeJupit Wireless USB C to HDMI Extender Kit:

#### 1. Connect the Receiver (RX):

- Plug the HDMI Receiver (RX) into an available HDMI input port on your TV or projector.
- Connect one of the provided Micro USB power cables to the RX unit and the other end to a USB power source (e.g., a USB port on your TV/projector or a USB wall adapter). Ensure the RX unit is powered on.

#### 2. Connect the Transmitter (TX):

- Plug the USB Type-C Transmitter (TX) into the USB Type-C port of your laptop, PC, or other compatible source device.
- Connect the second Micro USB power cable to the TX unit and the other end to a USB power source (e.g., a USB port on your laptop or a USB wall adapter). Ensure the TX unit is powered on.

### 3. Select HDMI Input:

- On your TV or projector, select the correct HDMI input channel where the RX unit is connected.

### 4. Pairing (if necessary):

- The TX and RX units are pre-paired at the factory. If no display appears or the connection is abnormal, you may need to re-pair them.
- Long press the 'Reset' button on the RX unit until the screen displays 'Ready to Pair'.
- Long press the 'Pairing' button on the TX unit until its indicator light begins to flicker rapidly.
- Wait approximately 15 seconds for the units to successfully pair. The screen on your display device should then mirror or extend your source device's display.

# 3 EASY STEPS FOR STREAMING

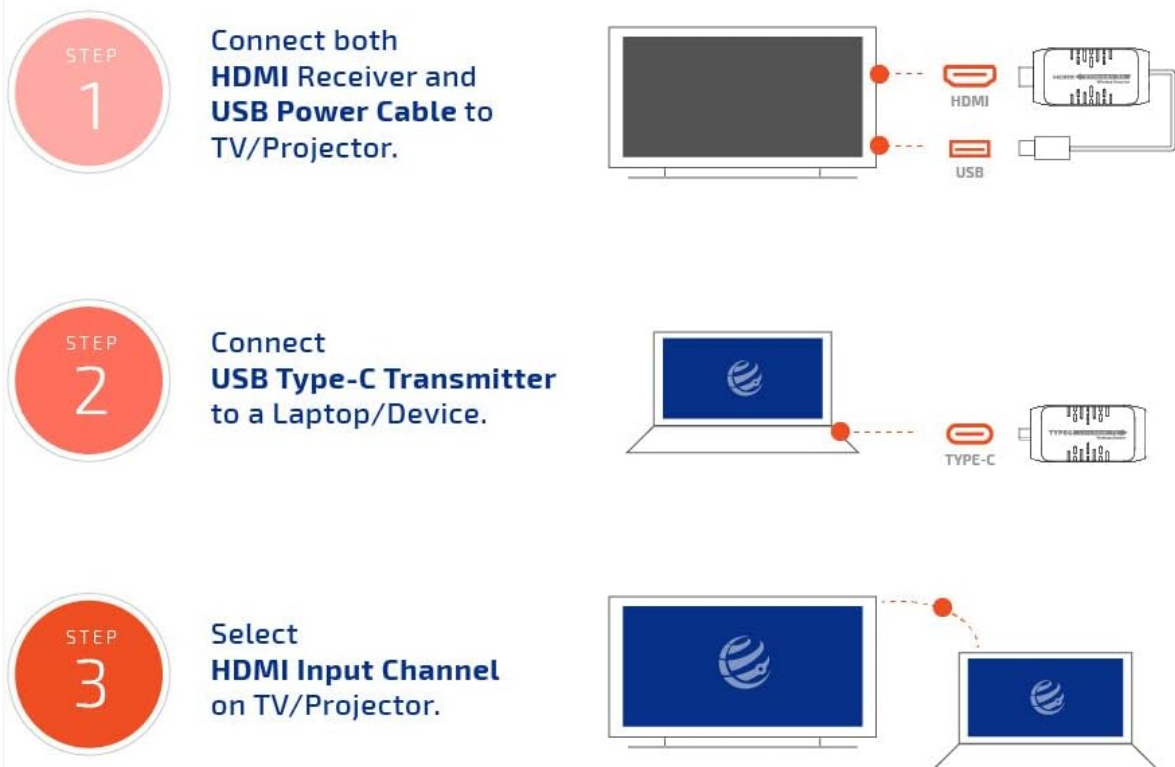

Figure 2: Visual guide for the three easy steps to set up the wireless extender kit.

# Stream in Minutes



**Made for :** USB-C laptops with a video-enabled USB-C port  
The device will work on any video source output with an Alternate mode-supported USB-C port.  
Please figure out if your laptop, tablet or other AV source are **USB Type-C port**.



**On a laptop or Tablet:**  
Connect the transmitter to the USB-C port, and transmitter powered by input source through USB Type-C port.



**On a TV or projector**  
Connect the receiver to the HDMI input.  
Connect USB power cable to a USB input.  
Make sure that the input source on your display corresponds to the HDMI port that the transmitter is connected to.



Enjoy the vivid images and realistic sounds

**Figure 3:** Detailed steps for connecting the USB-C transmitter to a laptop and the receiver to a TV or projector.

CONNECT  
**USB TYPE-C**  
**PORT**  
TO  
**WIRELESS**  
**HDMI**



**Figure 4:** Connection diagram showing the USB Type-C transmitter wirelessly sending signals to the HDMI receiver.



**Figure 5:** Example of the wireless extender kit in a meeting room, transmitting content from a laptop to a projector.

# WIRELESS TYPEC EXTENDER

Simply connect the tiny TypeC dongle you can wirelessly display content from a smartphone, computer or tablet to big HDTV or Projector. Anything you can see on your local side you can see on your HDTV or Projector. Sit back and watch movies from Netflix, Hulu, Amazon, or YouTube...



**Figure 6:** The wireless extender in action, displaying content from a smartphone on a large TV screen.

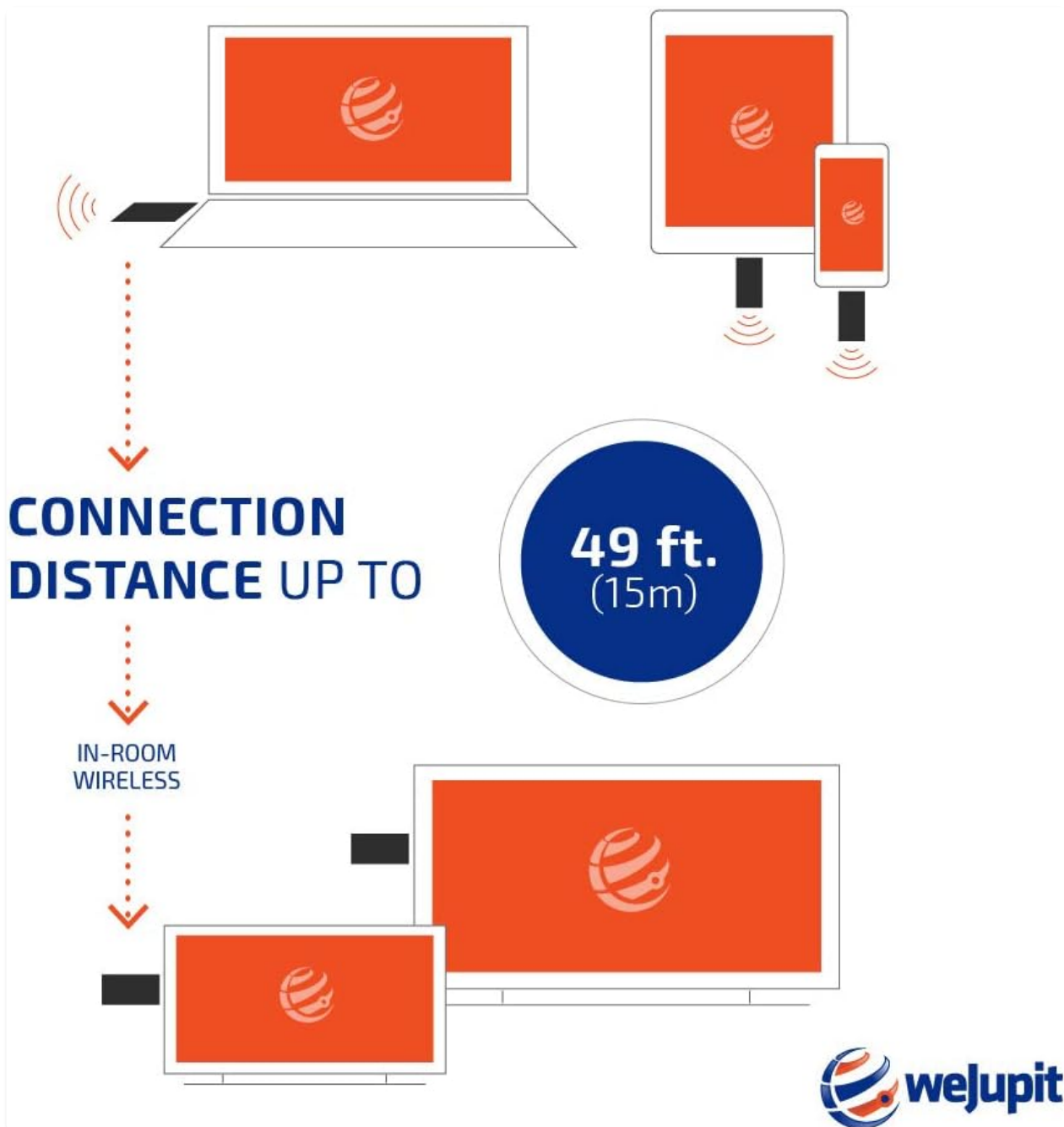

Figure 7: The effective wireless transmission range of the extender kit, up to 15 meters (49 feet).

## 4. Operating Instructions

Once the setup is complete and the devices are paired, the extender kit operates automatically. Your source device's display will be mirrored or extended to the connected TV or projector.

- **Mirroring/Extending Display:** Depending on your source device's operating system settings, you can choose to mirror your screen (duplicate) or extend it (use the external display as a second monitor).
- **Supported Devices:** Compatible with laptops, personal computers, DVD players, tablets, and other devices with a video-enabled USB Type-C port.
- **Content Compatibility:** The kit supports virtually any local or online content, including movies, videos, music, photos, games, online TV shows, web browsing, applications, and presentations.

## 5. Maintenance

To ensure optimal performance and longevity of your WeJupit Wireless USB C to HDMI Extender Kit, follow

these maintenance guidelines:

- **Cleaning:** Use a soft, dry cloth to clean the devices. Avoid liquid cleaners or harsh chemicals.
- **Storage:** Store the kit in a cool, dry place away from direct sunlight and extreme temperatures when not in use.
- **Handling:** Handle the transmitter and receiver units with care to prevent physical damage to the ports or internal components.
- **Power Supply:** Always use the provided USB power cables or certified equivalents to ensure stable power delivery.

## 6. Troubleshooting

---

If you encounter issues with your extender kit, refer to the following common troubleshooting steps:

- **No Display/Connection Failure:**
  - Ensure both the TX and RX units are properly powered via their respective USB Type-C ports.
  - Verify that the correct HDMI input is selected on your TV or projector.
  - If the units are not pairing automatically, perform the manual pairing process as described in Section 3, Step 4.
  - Check if your source device's USB Type-C port supports video output (Alternate Mode).
- **Intermittent Connection/Signal Drop:**
  - Reduce the distance between the TX and RX units. The maximum effective range is 15m (50ft) with a clear line of sight.
  - Ensure there are no significant obstructions (walls, large furniture) between the transmitter and receiver.
  - Minimize interference from other 5GHz wireless devices.
  - Ensure both units are receiving adequate power. If using USB ports on the display/source, try an external USB wall adapter for more stable power.
- **Overheating:**
  - If the units become excessively hot and disconnect, ensure they have proper ventilation. Avoid placing them in enclosed spaces.
  - Confirm adequate power supply. Insufficient power can sometimes lead to overheating.

### Troubleshooting Videos:

**Video 1:** This video demonstrates how to troubleshoot connection failures and re-pair the transmitter and receiver units for the WeJupit Wireless HDMI Extender Kit.

**Video 2:** This video provides step-by-step instructions for connecting and pairing the WeJupit Wireless HDMI Extender Kit, useful for resolving initial setup issues.

## 7. Specifications

---

Specification	Detail
Brand	weJupit
Model Name	WJEXT15-2
Connectivity Technology	Wi-Fi, HDMI, USB Type-C
Connector Type	HDMI, USB Type-C
Resolution	1080p (1920x1080 Pixels)
Specification Met	HDMI 1.3
Item Weight	7.1 ounces
Package Dimensions	5.91 x 4.69 x 2.99 inches
Color	Black
Compatible Devices	Television, Personal Computer, Laptop, Tablet

## 8. Warranty and Support

WeJupit is committed to providing quality products and customer satisfaction. This product typically comes with a 1-year guarantee, as indicated by customer feedback. For any technical assistance, troubleshooting, or warranty claims, please contact our USA-based customer support team.

For further information or support, please refer to the contact details provided in your product packaging or visit the official WeJupit website.