

Manuals+

[Q & A](#) | [Deep Search](#) | [Upload](#)

manuals.plus /

- › [EAGLE PEAK](#) /
- › [EAGLE PEAK 8x6 Portable Walk-in Greenhouse Instruction Manual](#)

EAGLE PEAK GH48-GRN-AZ

EAGLE PEAK 8x6 Portable Walk-in Greenhouse Instruction Manual

Model: GH48-GRN-AZ

1. INTRODUCTION

The EAGLE PEAK 8x6 Portable Walk-in Greenhouse is designed to provide an optimal environment for your plants, vegetables, and fruits to flourish. Its innovative pop-up technology allows for quick and easy setup, making it a convenient solution for both indoor and outdoor gardening. This manual provides essential information for assembly, operation, maintenance, and troubleshooting to ensure the longevity and effective use of your greenhouse.

Key Features:

- **Easy Setup:** Patented center lock technology enables one-person setup in seconds, with no tools required.
- **Stable and Sturdy:** Constructed with a durable steel-ceiling roof and a 35lb steel frame for enhanced stability.
- **Spacious Design:** 8x6 ft walk-in area provides ample room for plants and shelving.
- **Premium Cover:** Features a three-layer UV resistant PE film cover for superior plant protection and environmental friendliness.
- **Ventilation:** Equipped with zippered roll-up doors and mesh windows for optimal airflow.



Figure 1: The EAGLE PEAK 8x6 Portable Walk-in Greenhouse in use.

2. SETUP INSTRUCTIONS

The EAGLE PEAK greenhouse features an innovative easy setup technology designed for quick assembly by one person. No tools are required.

Assembly Steps:

1. **Step 1: Open the Frame.** Carefully unfold the pre-assembled steel frame. Ensure there is enough clear space around the frame for it to expand fully.

EASY SETUP

STEP 01 ▶
Open the frame



◀ **STEP 02**

Push up on the Easy Peak Center-Push mechanism to raise and lock the canopy frame

STEP 03 ▶

Adjust the height or angle for preferred shade coverage



Figure 2: Unfolding the greenhouse frame.

- Step 2: Push up on the Easy Peak Center-Push Mechanism.** Locate the red center-push mechanism at the top of the frame. Push upwards on this mechanism to raise and lock the canopy frame into its fully extended position. This patented system allows for pinch-free operation.

THE ORIGINAL POP UP GREENHOUSE

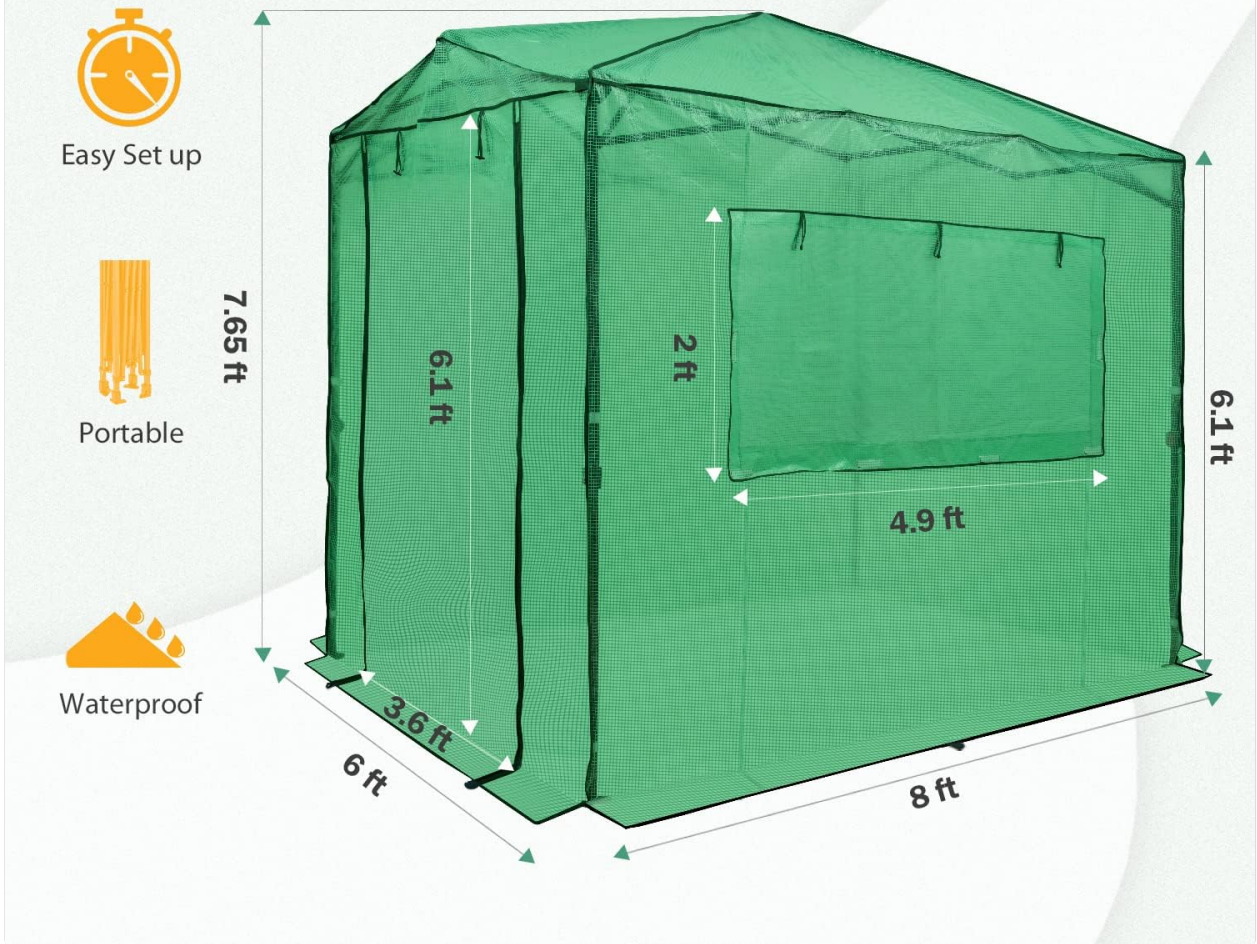

Figure 3: Engaging the center-push mechanism to lock the frame.

- Step 3: Adjust Height or Angle (if applicable).** For some models, you may adjust the height or angle for preferred shade coverage. Ensure all leg sliders are securely locked into place.

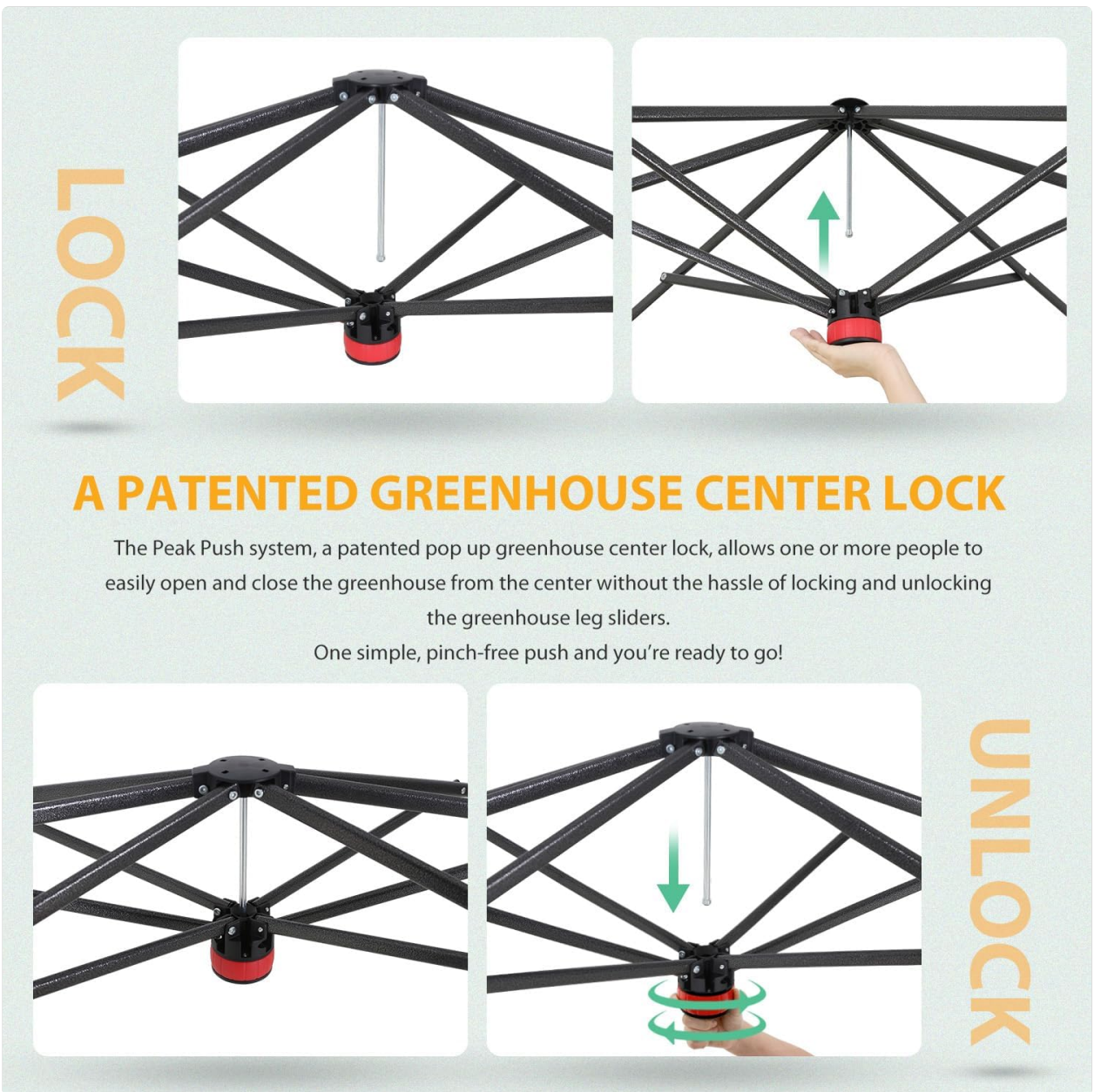

Figure 4: Adjusting the greenhouse height.

- Step 4: Secure the Greenhouse.** Use the provided ground stakes and ropes to secure the greenhouse to the ground, especially in windy conditions. The greenhouse also features a skirt for ground seal, which can be weighed down with rocks or soil for added stability.

EAGLE PEAK

WALK-IN DESIGN

offers growing space and ventilation for plants.

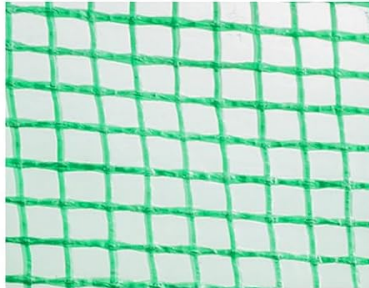

Three-layer UV Resistant PE film with tear-resistant reinforcement



2 Large windows (list size) for **ventilation**



2 Large Roll Up doors for **walk-in access** and **cross ventilation**

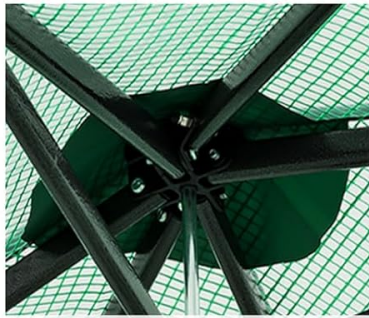

Double layer reinforcement at corners and peak

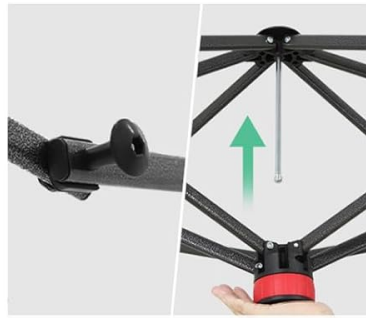

Hook

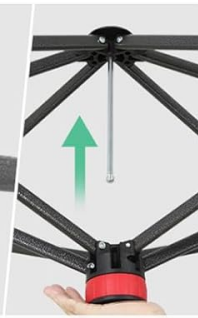

Center push



Skirt for ground seal

Figure 5: Key design features for stability and ventilation.

To disassemble, reverse the steps. The center-push mechanism allows for easy closing without the hassle of locking and unlocking individual leg sliders.

3. OPERATING YOUR GREENHOUSE

Your EAGLE PEAK greenhouse is designed for optimal plant growth and ease of use.

Ventilation:

The greenhouse features two zippered roll-up doors and two mesh windows. Utilize these for cross-ventilation to regulate temperature and humidity inside. Open them during warmer periods to prevent overheating and close them to retain heat during cooler times.



Figure 6: Interior view demonstrating the spacious walk-in design.

Space Utilization:

The 8x6 ft walk-in design provides ample space for various plants and allows for comfortable movement. You can add shelving (sold separately) to maximize your growing area.

4. MAINTENANCE

Regular maintenance will extend the life of your greenhouse and ensure optimal performance.

- **Ventilation:** Ensure proper ventilation to prevent overheating and humidity buildup, which can harm plants and create mold. Regularly open doors and windows as needed.
- **Cleaning:** Clean the PE cover periodically with mild soap and water. Avoid harsh chemicals that could damage the material.
- **Snow and Ice:** In areas with snowfall, regularly clear snow and ice from the roof to prevent excessive weight

buildup, which could damage the frame.

- **Anchoring:** Periodically check the ground stakes and ropes to ensure they remain securely anchored, especially after strong winds.
- **Storage:** When not in use for extended periods, or during severe weather, it is recommended to disassemble and store the greenhouse in a dry, protected area.

5. TROUBLESHOOTING

Here are some common issues and their solutions:

- **Greenhouse Unstable in Wind:** Ensure all ground stakes are fully inserted and ropes are taut. Consider adding additional weight to the skirt (e.g., rocks, sandbags) or using heavier-duty anchors for increased stability.
- **Difficulty Opening/Closing Frame:** Check for any obstructions or debris in the frame joints. Ensure the center-push mechanism is properly aligned. Do not force the frame; gently adjust components.
- **Tears or Damage to Cover:** Small tears can often be repaired with greenhouse repair tape. For significant damage, a replacement cover may be necessary. Contact customer support for replacement parts.
- **Excessive Humidity/Heat Inside:** Increase ventilation by opening both zippered doors and mesh windows. Consider using a small fan to circulate air if natural airflow is insufficient.

6. SPECIFICATIONS

Product Dimensions	96"L x 72"W x 91.8"H (8 ft x 6 ft x 7.65 ft)
Item Weight	35 pounds
Cover Material	Reinforced Polyethylene Film (PE)
Frame Material	Alloy Steel
Closure Type	Zipper (Roll-Up Doors)
Number of Doors	2
Number of Vents	2 (Mesh Windows)
Color	Green
Model Number	GH48-GRN-AZ
UPC	714735033294



PACKAGE INCLUDES



Figure 7: Package contents for the EAGLE PEAK greenhouse.

7. WARRANTY AND SUPPORT

EAGLE PEAK stands behind the quality of its products.

Warranty Information:

EAGLE PEAK offers a **1-year limited after-sale protection** from the original date of purchase. This warranty covers both the frame and the top cover of your greenhouse. This commitment highlights EAGLE PEAK's dedication to quality and customer satisfaction.

Customer Support:

Should you have any questions, concerns, or require assistance with your EAGLE PEAK greenhouse, please do not hesitate to contact our professional service team. We are committed to providing reliable American support to ensure you have the best possible experience with your product.

