



[Manuals.plus](#) /

› [KKCOOL](#) /

› [KKCOOL Smart Switch 3 Gang User Manual](#)

KKCOOL KS-602

KKCOOL Smart Switch 3 Gang User Manual

Model: KS-602

Brand: KKCOOL

1. PRODUCT OVERVIEW

The KKCOOL Smart Switch 3 Gang is a Wi-Fi enabled light switch designed for convenient control of your home lighting. It integrates seamlessly with popular smart home platforms like Amazon Alexa, Google Home, and IFTTT, allowing for voice control and remote management via a smartphone application. This smart switch features a sleek design with touch-sensitive controls and indicator lights.

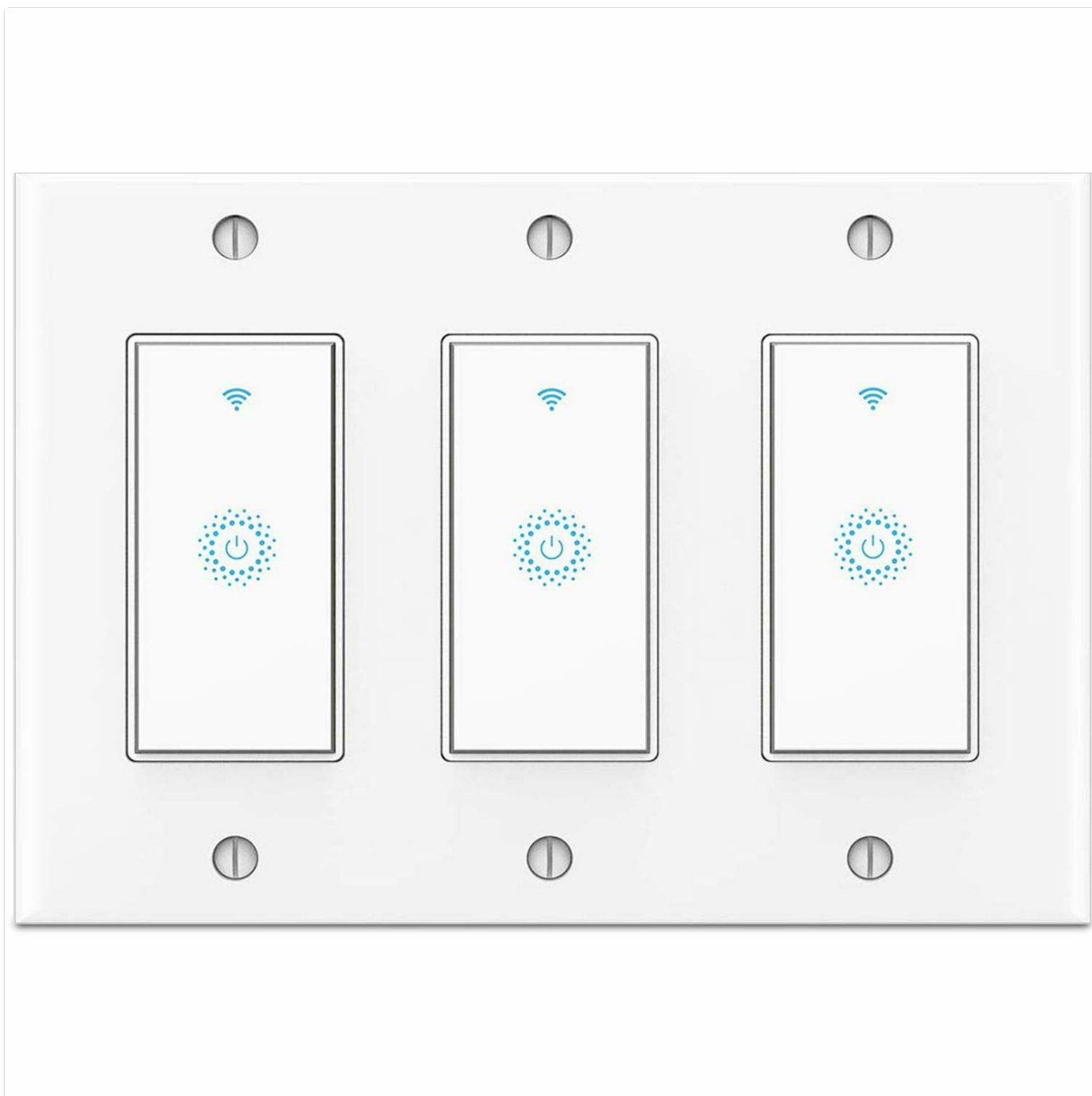

Figure 1.1: Front view of the KKCOOL Smart Switch 3 Gang with three individual touch panels.

Smart WiFi Switch 3 Gang

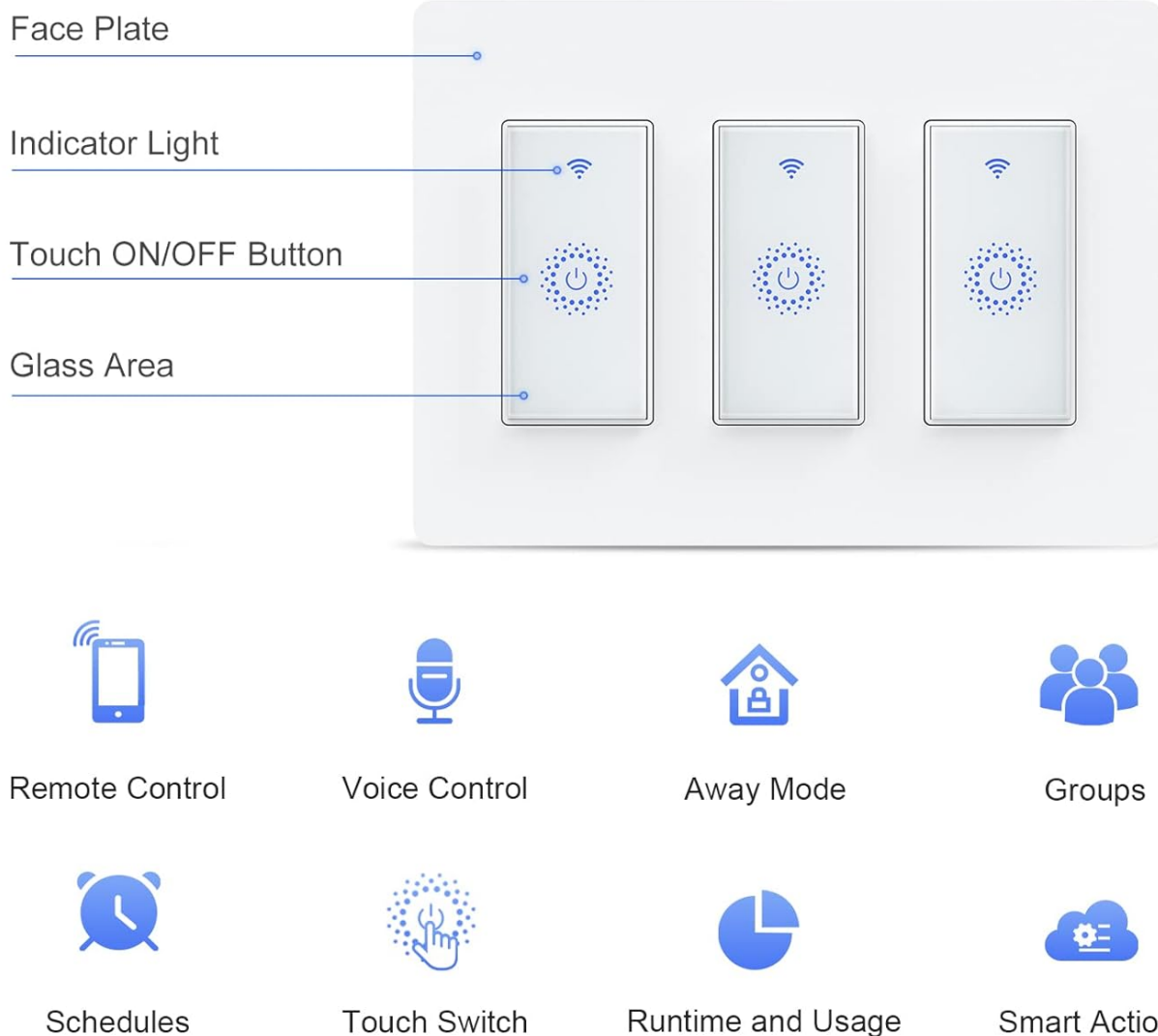

Figure 1.2: Key features of the Smart WiFi Switch 3 Gang, including face plate, indicator light, touch ON/OFF button, glass area, and functionalities like Remote Control, Voice Control, Away Mode, Groups, Schedules, Touch Switch, Runtime and Usage, and Smart Actions.

2. IMPORTANT NOTES AND SAFETY WARNINGS

- **Neutral Wire Required:** Installation requires a neutral wire. If your house was built or remodeled before the mid-1980s, you may not have a neutral wire. Consult a qualified electrician if unsure.
- **Wi-Fi Compatibility:** This smart switch only supports 2.4 GHz Wi-Fi networks. It does NOT support 5 GHz Wi-Fi.
- **Wi-Fi Network Name:** Ensure your Wi-Fi network name (SSID) contains only letters and numbers. Special symbols (e.g., hyphens) are not allowed.
- **Switch Type:** This is a ONE-way switch only. It does NOT support 2-way, 3-way, or multi-way switch configurations.
- **Dimmer Functionality:** This switch is NOT a dimmer switch and cannot be used to control dimmable lights.
- The product has passed FCC and ETL certification, ensuring safety and quality.
- Incorrect wiring or a missing neutral wire will prevent the switch from functioning correctly.

Need Neutral Wire





-  Your house was built or remodeled **before mid-80's**. (Probably No Neutral Wire. Check the description below to confirm)
-  Can **NOT** use as a **dimmer switch**.
-  Can **NOT** use as a **3-way switch or multi-way**.
-  Does **NOT** support **5GHz Wi-Fi**.



Figure 2.1: Visual guide emphasizing the need for a neutral wire, and clarifying that the switch is for 1-way use only (not 3-way or multi-way) and supports only 2.4GHz Wi-Fi.

3. INSTALLATION GUIDE

3.1. Pre-Installation Checklist

- Confirm the presence of a neutral wire in your electrical box.
- Ensure your Wi-Fi network is 2.4 GHz.
- Turn off power at the circuit breaker before beginning any electrical work.

3.2. Wiring Instructions

The KKCOOL Smart Switch requires a Neutral + Live wire power supply. Refer to the wiring diagram on the back of the switch and the provided instructions for proper connection. It is highly recommended to consult a qualified electrician for installation if you are not familiar with electrical wiring.

DIMENSION

Size:4.1X1.8X1.5 inch Weight:120g

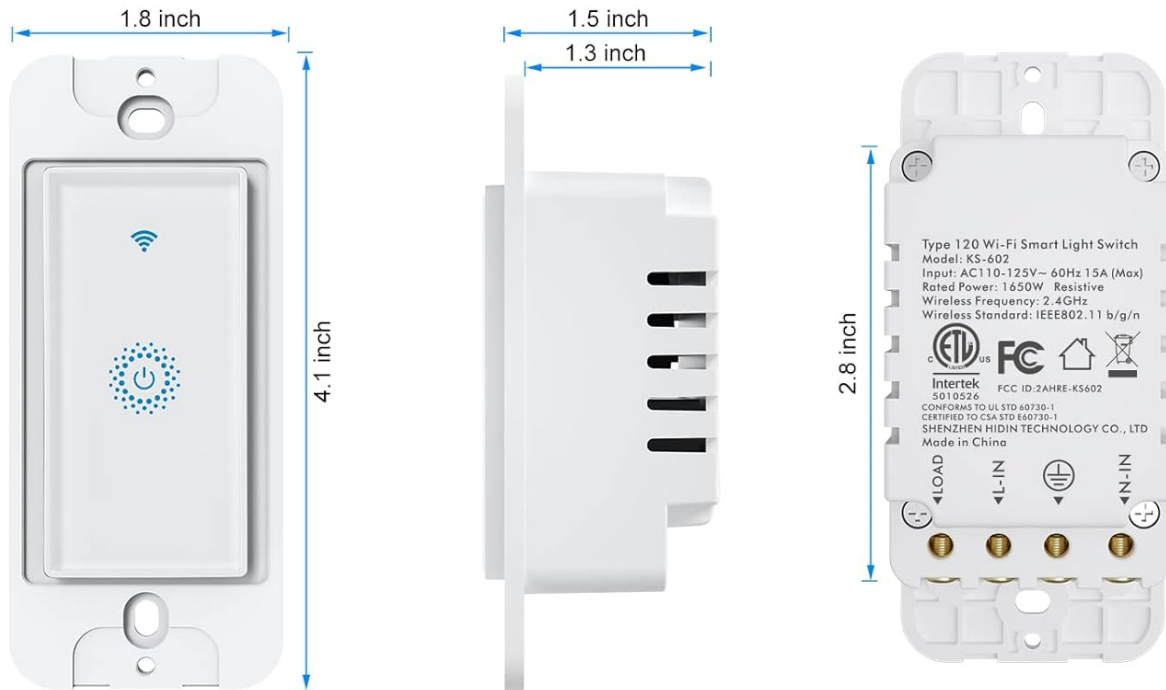

ATTENTION:

1. Need Neutral Wire
2. Only Support To 2.4GHz WiFi
3. Not A Dimmer Switch
4. Not A 3-Way or Multi-Way Switch

Figure 3.1: Detailed dimensions of the smart switch (4.1x1.8x1.5 inches) and a clear view of the wiring terminals (L, N, L-OUT, L-IN) on the back, along with important attention notes.

The package includes three separate switches and one 3-gang wall plate. The wall plate can be found at the bottom of the package box. If any accessories are missing or the package is defective, please contact customer support with a photo for a free replacement.

4. APP SETUP AND REMOTE CONTROL

4.1. Downloading the App

1. Download the "Smart life" application from the App Store (for iOS devices) or Google Play Store (for Android devices).

4.2. Connecting to Wi-Fi

2. Connect your mobile device to your 2.4GHz Wi-Fi network.
3. Launch the "Smart life" app and follow the on-screen instructions to add a new device.
4. Connect the Smart Switch to your home network by following the pairing steps provided in the app. This typically involves

putting the switch into pairing mode (often by long-pressing the ON/OFF button until the indicator light flashes quickly).

4.3. Remote Control Functionality

Once connected, you can remotely control your lights from anywhere using the Smart Life / Tuya APP. This allows you to turn appliances on or off even when you are away from home.

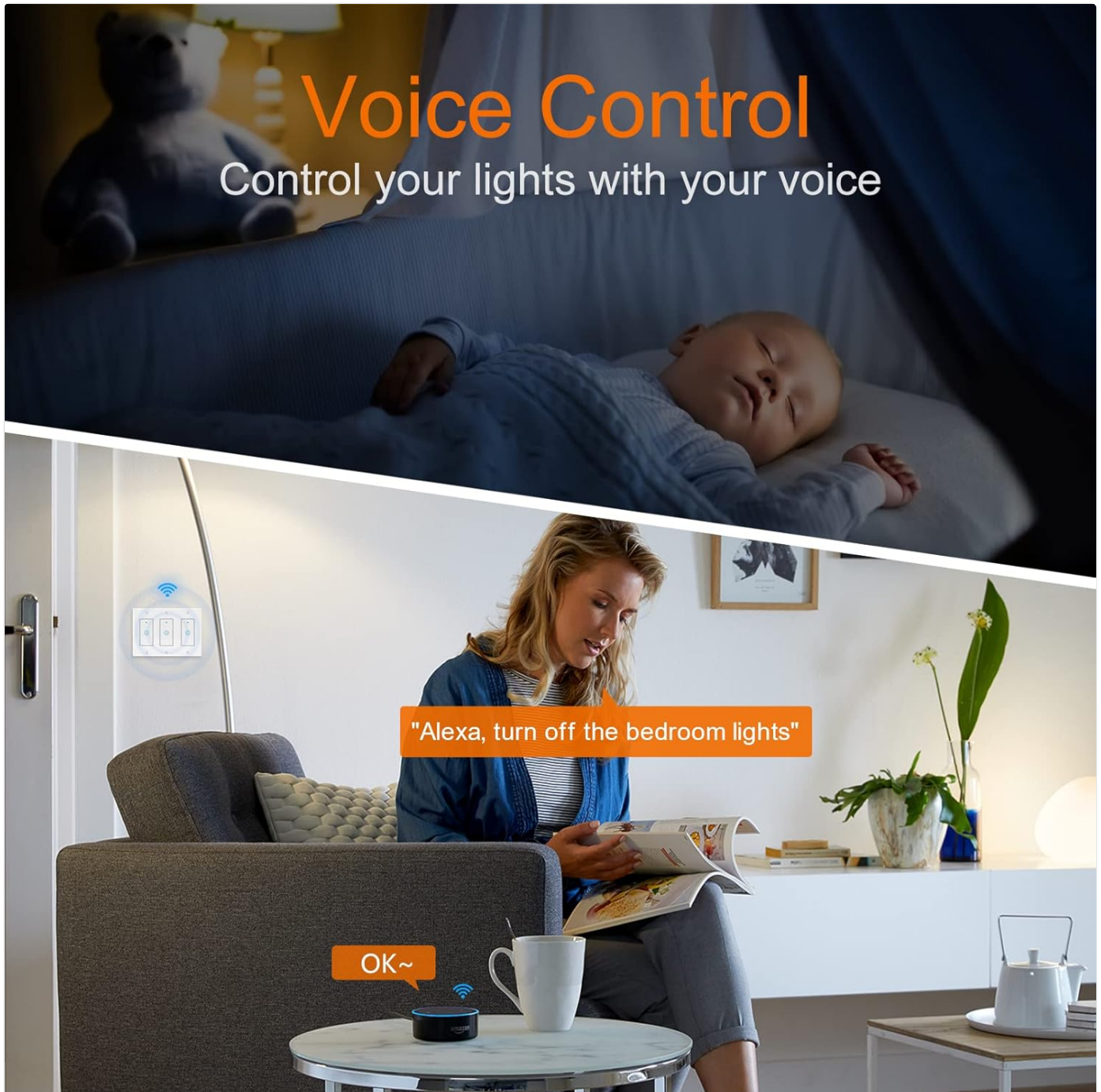

Figure 4.1: Illustration of remote control capability via the Smart Life or Tuya app on a smartphone, allowing users to turn lights on/off from any location.

5. VOICE CONTROL INTEGRATION

The KKCOOL Smart Switch is compatible with Amazon Alexa, Google Assistant, and IFTTT, enabling convenient voice control of your connected devices.

5.1. Pairing with Amazon Alexa

1. Open the Amazon Alexa app.
2. Navigate to "Skills" or "Skills & Games".

3. Search for the “Smart Life” skill.
4. Click “Enable” or “Enable To Use”.
5. Log into your Smart Life account and click “Link now” to authorize the connection.
6. Discover devices (Alexa will usually do this automatically, or you can say “Alexa, discover my devices”).

5.2. Pairing with Google Assistant

1. Open the Google Home app.
2. Find “Home Control” or “Works with Google”.
3. Click “add a device” (the plus icon).
4. Search for “Smart Life”.
5. Sign in with your Smart Life account to link the service.



Figure 5.1: Example of voice control in action, showing a user commanding Alexa to turn off bedroom lights, demonstrating seamless integration.

6. ADDITIONAL FEATURES

6.1. Schedules and Timers

You can program the smart switch to automatically turn lights on and off according to your daily schedule. This feature helps in energy saving and provides convenience. For example, set a countdown or a specific schedule to prevent lights from being left on unnecessarily.

6.2. Family Sharing

The Smart Life app allows you to share control of your smart switch with family members. This enables multiple users to manage the connected devices from their own smartphones.

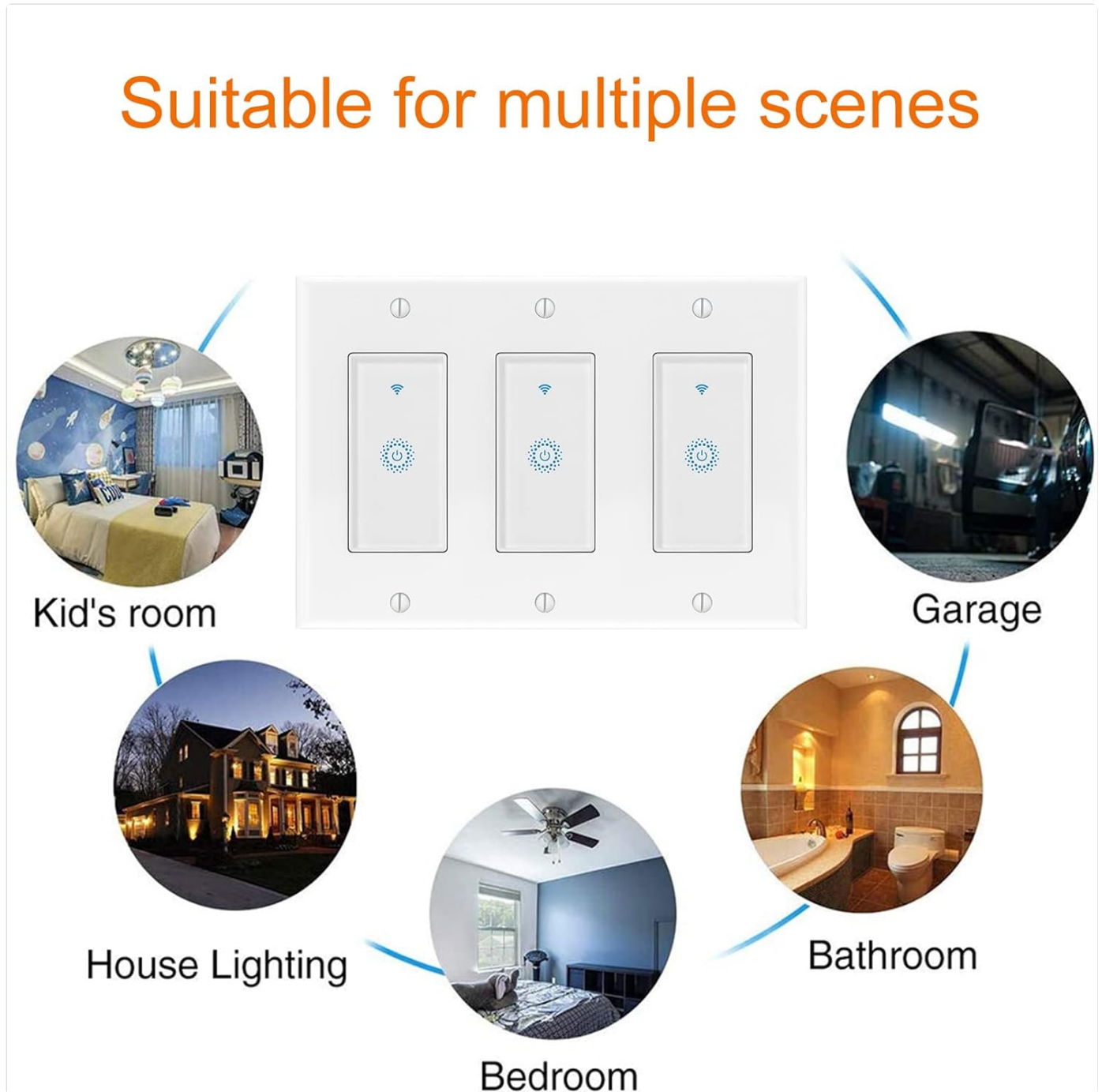

Figure 6.1: Illustration of the family sharing feature, where multiple family members can control the smart switch from their individual mobile devices.

6.3. Multiple Scene Applications

The KKCOOL Smart Switch is suitable for various applications throughout your home, including kid's rooms, garages, general house lighting, bedrooms, and bathrooms.

APP Remote Control

Turn on/off your light from anywhere&anytime



Figure 6.2: Visual representation of the smart switch's versatility, suitable for use in various home environments such as kid's rooms, garages, general house lighting, bedrooms, and bathrooms.

7. SPECIFICATIONS

Parameter	Value
Model Number	KS-602
Power Supply	Neutral + Live wire
Rated Current	15A
Rated Voltage	AC110V-125V~50/60Hz
Rated Power (Incandescent)	1650W
Rated Power (LED)	300W

Working Frequency	IEEE802.11b/g/n / 2.4GHz
Safety Protocols	WEP/WPA-PSK/WPA2-PSK
Static Power Loss	≤0.5W
Working Temperature	-20°C 75°C
Humidity	<95%
Control Distance	No limitation (via Wi-Fi)
Dimensions	4.1 x 1.8 x 1.5 inches
Weight	120g

8. TROUBLESHOOTING AND FAQ

Q1: Does this work with Apple HomeKit?

A1: No, the KKCOOL Smart Switch is not compatible with Apple HomeKit. However, it is fully compatible with Amazon Alexa, Google Home, and IFTTT.

Q2: The touch option on the wall plate no longer works, but I can still control it with Alexa or the app. How can I fix this?

A2: This issue is typically caused by a firmware update. You need to upgrade the firmware to the latest version. Alternatively, you can remove the switch from the Smart Life app and then re-add it back to the app. This often resolves connectivity and touch response issues.

Update to the latest Firmware Version

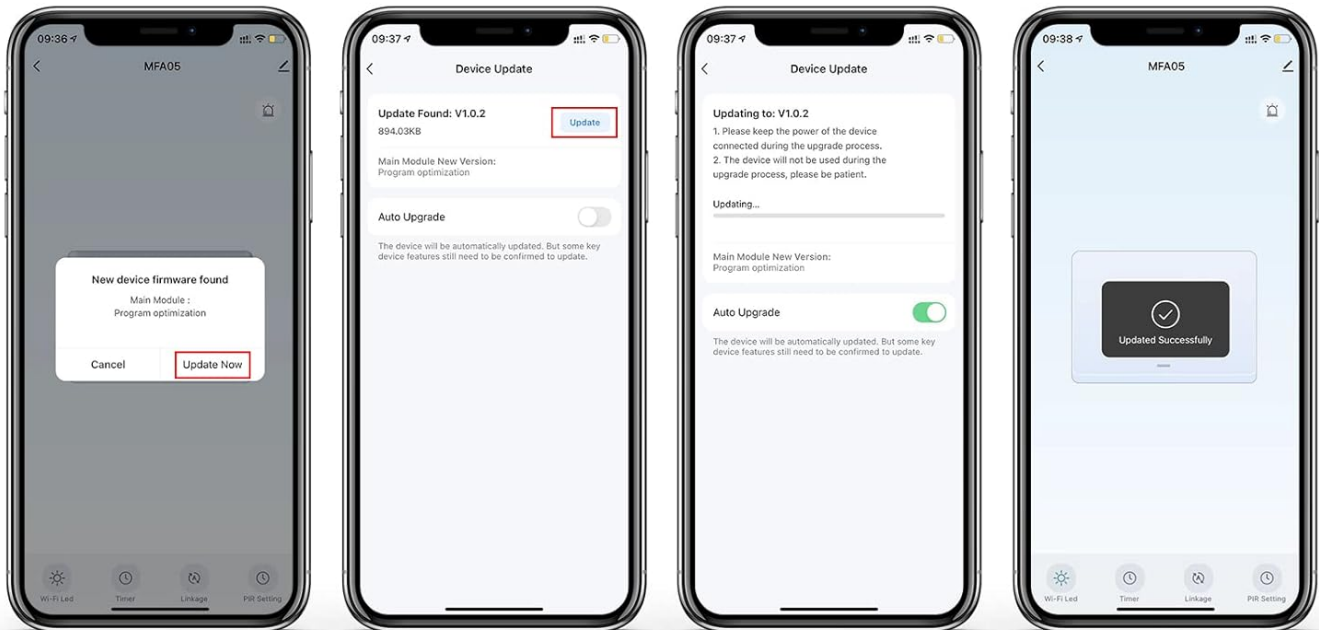

STEP 1

STEP 2

STEP 3

STEP 4

Update your Smart Life to the latest firmware so that your smart light switch will Not disconnections and enjoy stable device performance.

Figure 8.1: Step-by-step guide within the Smart Life app demonstrating how to update the firmware of your smart light switch to ensure stable performance and prevent disconnections.

General Troubleshooting Tips:

- If the indicator light is not flashing quickly during setup, long-press the ON/OFF button on the middle of the switch until it flashes rapidly, then attempt setup again.
- Ensure your Wi-Fi router is broadcasting a 2.4 GHz signal and your mobile device is connected to it during setup.
- Verify that the neutral wire is correctly connected. Incorrect wiring is a common cause of non-functionality.

9. WARRANTY AND SUPPORT

The KKCOOL Smart Switch has passed FCC and ETL certification, indicating adherence to high quality and safety standards. If you encounter any questions, issues, or require assistance with your product, please do not hesitate to contact KKCOOL customer support. We are committed to providing timely assistance for your convenience.

