



Manuals.plus /

› carsun /

› carsun Digital Air Compressor User Manual

carsun

Digital Air Compressor User Manual

Brand: carsun

PRODUCT OVERVIEW

The carsun Digital Air Compressor is a portable tire inflator designed for convenience and efficiency. It features a digital display for precise pressure settings and an automatic shut-off function to prevent over-inflation. Equipped with an LED light, it ensures visibility during nighttime use or in low-light conditions. This versatile device is suitable for inflating various items, including car tires, bicycle tires, sports balls, and other inflatables.

Key features include a maximum working pressure of 150 PSI and an airflow of 35 liters per minute, allowing for rapid inflation. For instance, a 195/65/R15 car tire can be inflated from 0 to 35 PSI in under 5 minutes.



Figure 1: The carsun Digital Air Compressor and its accessories.

PRODUCT COMPONENTS

The carsun Digital Air Compressor comes with the following main components and accessories:

- Main Air Compressor Unit with Digital Display
- Inflation Hose with Press Valve
- 12V DC Power Cable with Lighter Plug (10ft / 3 meters)
- Additional Nozzles (4 types) for various inflatables
- Spare Fuse



Figure 2: Labeled components of the carsun Digital Air Compressor.

Dense storage



Figure 3: Product dimensions and internal storage for accessories.

SETUP INSTRUCTIONS

1. **Start Vehicle Engine:** Ensure your vehicle's engine is running before connecting the air compressor. This provides stable power and prevents draining your car battery.
2. **Connect to 12V Power Outlet:** Plug the 12V power cable of the air compressor into your vehicle's cigarette lighter socket.
3. **Connect to Tire Valve:** Securely attach the inflation nozzle to the tire valve stem. Ensure a tight seal to prevent air leakage during inflation.

Easy to use

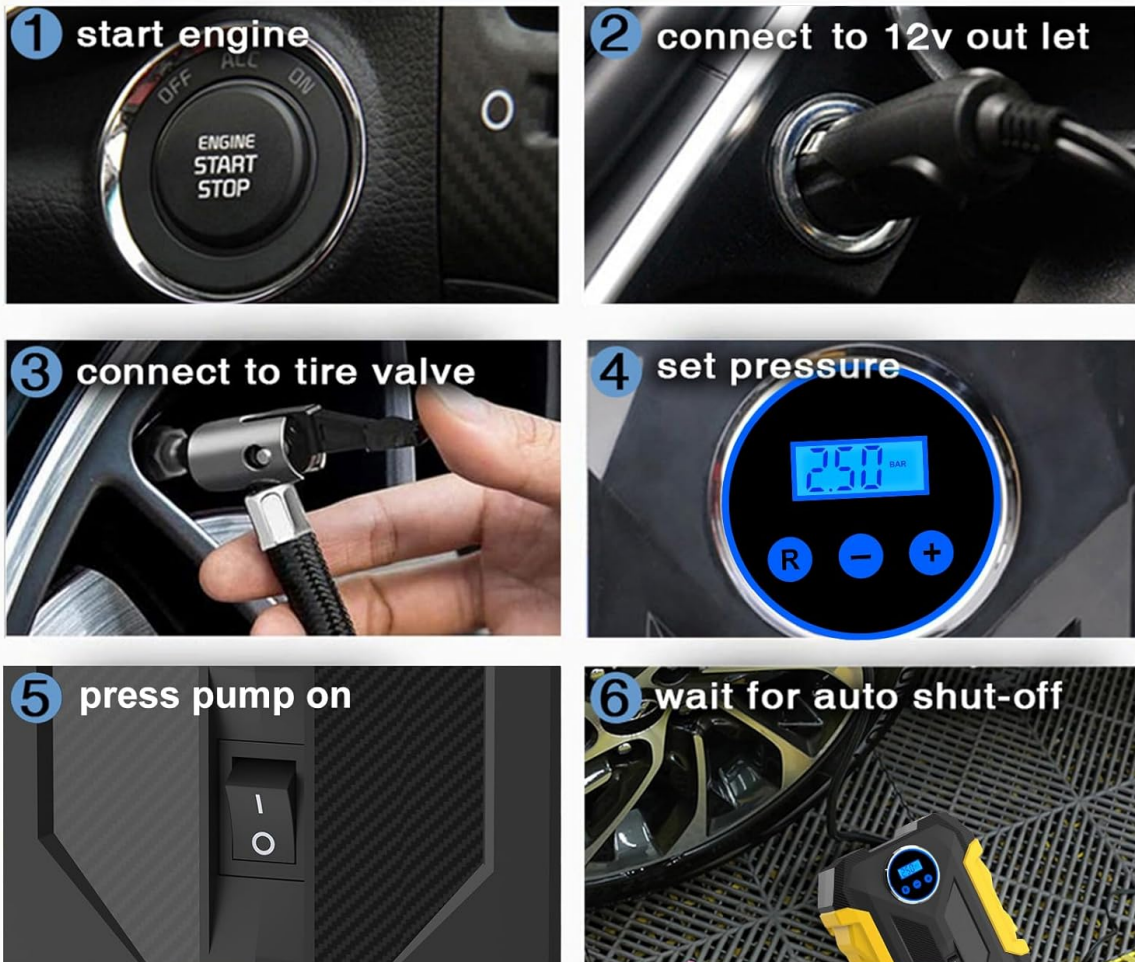

Figure 4: Visual guide for connecting the air compressor.

OPERATING INSTRUCTIONS

- 1. Set Desired Pressure:** Use the pressure value adjustment buttons (+/-) on the digital display to set the target tire pressure (PSI, BAR, KPA, KG/CM²). Refer to your vehicle's owner's manual or the sticker on the driver's side door jamb for recommended tire pressure.
- 2. Start Inflation:** Press the power button (ON/OFF switch) to begin the inflation process. The digital display will show the current tire pressure as it inflates.
- 3. Automatic Shut-Off:** The air compressor will automatically stop once the preset tire pressure is reached.
- 4. Disconnect:** Once inflation is complete and the unit has shut off, disconnect the inflation nozzle from the tire valve and unplug the 12V power cable from the outlet.
- 5. Using LED Light:** The integrated LED light can be activated independently to provide illumination in dark environments.
- 6. Using Additional Nozzles:** Select the appropriate nozzle adapter for items such as bicycle tires, sports balls, or inflatable toys. Attach it to the inflation hose before connecting to the item.

Fast Inflation

Quickly inflate the 195/65 R15 car tire from 0 to 35Psi in 5 min



Figure 5: Fast inflation in progress.

Multiple Purpose

3 nozzle adapters to meet your various inflation needs
1 spare fuse allows you to use the product without worrying



Cars



Balls



Bicycles



Air bed



Kayaking



Motorcycle

Figure 6: Examples of items that can be inflated using the provided nozzles.

MAINTENANCE

To ensure the longevity and optimal performance of your carsun Digital Air Compressor, follow these maintenance guidelines:

- **Cleaning:** Wipe the unit with a soft, damp cloth after each use to remove dust and debris. Do not use harsh chemicals or abrasive cleaners.
- **Storage:** Store the air compressor in a cool, dry place, away from direct sunlight and extreme temperatures. Ensure the hose and power cord are neatly coiled and stored in the designated compartment to prevent damage.
- **Hose and Nozzle Inspection:** Regularly inspect the inflation hose and nozzle adapters for any signs of wear, cracks, or damage. Replace if necessary to maintain proper sealing and performance.
- **Fuse Replacement:** If the unit fails to power on, check the fuse located within the 12V lighter plug. A spare fuse is provided for convenience. To replace, unscrew the tip of the plug, remove the old fuse, and insert the new one.

TROUBLESHOOTING

Problem	Possible Cause	Solution
Unit does not turn on.	No power from 12V outlet; Blown fuse in plug; Loose connection.	Ensure vehicle engine is running. Check 12V outlet for power. Replace fuse in the lighter plug if blown. Ensure plug is fully inserted.
Tire not inflating or inflating slowly.	Hose not securely attached; Tire valve damaged; Leak in hose/nozzle; Object obstructing air flow.	Ensure inflation nozzle is tightly sealed to the tire valve. Inspect tire valve for damage. Check hose and nozzles for leaks or blockages.
Inaccurate pressure reading.	Sensor calibration issue; External factors (temperature).	Ensure the unit is on a stable surface. Compare reading with a known accurate gauge. If persistent, contact customer support.
Unit overheats and shuts off.	Continuous operation for too long.	Allow the unit to cool down for 10-15 minutes before resuming operation. Avoid prolonged continuous use.

SPECIFICATIONS

Feature	Detail
Brand	carsun
Model Number	CAP-001
Voltage	12 Volts DC
Power Source	Corded Electric (12V Car Outlet)
Maximum Working Pressure	150 PSI
Air Flow Capacity	35 Liters Per Minute (LPM)
Noise Level	75 dB
Product Dimensions (L x W x H)	6.2" x 2.3" x 7.8"
Item Weight	862 Grams (1.9 pounds)
Hose Length	3 Meters (approx. 10 feet)
Special Feature	Digital Display, LED Light, Auto Shut-Off
Included Components	Nozzles (4 additional), Spare Fuse
UPC	824918355676

WARRANTY AND SUPPORT

carsun is committed to providing high-quality products and services. Your Digital Air Compressor comes with a worry-free guarantee.

If you encounter any issues or have questions regarding the product, please do not hesitate to contact our customer support team. We are dedicated to assisting you and resolving any problems you may experience.

For support, please email us directly. (Specific email address not provided in data, so general instruction is given).