

Manuals+

[Q & A](#) | [Deep Search](#) | [Upload](#)

manuals.plus /

- › [BENFEI](#) /
- › [BENFEI 2-in-1 USB-C to SD and TF Card Reader Adapter User Manual](#)

BENFEI 000271grey

BENFEI 2-in-1 USB-C to SD and TF Card Reader Adapter User Manual

Model: 000271grey

1. PRODUCT OVERVIEW

The BENFEI 2-in-1 USB-C Card Reader is designed for high-speed data transfer from SD (Secure Digital) and Micro SD (TF) cards. Its integrated design offers convenient access to two different card types simultaneously, making it an essential tool for managing digital media.



Image 1.1: The BENFEI 2-in-1 USB-C to SD and TF Card Reader Adapter, showcasing its compact design and USB-C connector.

2. KEY FEATURES

- **Integrated Design:** Provides high-speed data access to both SD (Secure Digital) and Micro SD (TF) card types.
- **Incredible Performance:** Utilizes the latest USB Type-C port for transfer rates up to 104MB/sec in UHS-I mode, backward compatible with USB 2.0/1.1. Allows instant browsing and viewing of photos on USB-C smartphones/laptops. *(Note: Final data speed depends on the card and USB slot type.)*
- **Superior Stability:** Features a built-in advanced IC chip for stable high-speed data transfer, enabling HD movie transfers in seconds. Supports simultaneous reading and writing of two cards.
- **Broad Compatibility:** Compatible with a wide range of USB-C devices including MacBook Pro (2019/2018/2017/2016), MacBook (2017/2016/2015), iPad Pro 2018, Surface Book 2, Samsung Galaxy S10/S9/S8/Note 8/Note 9, HTC U11/U12, Pixelbook, Dell XPS 15 / XPS 13, Galaxy Book, and many others. *(Note: SDXC cards (64GB or larger) use "exFAT" format, which may not be supported by older operating systems like Windows XP, Windows Vista before SP1, and Mac OS X before 10.6.6.)*
- **Plug & Play:** No driver installation required for immediate use.

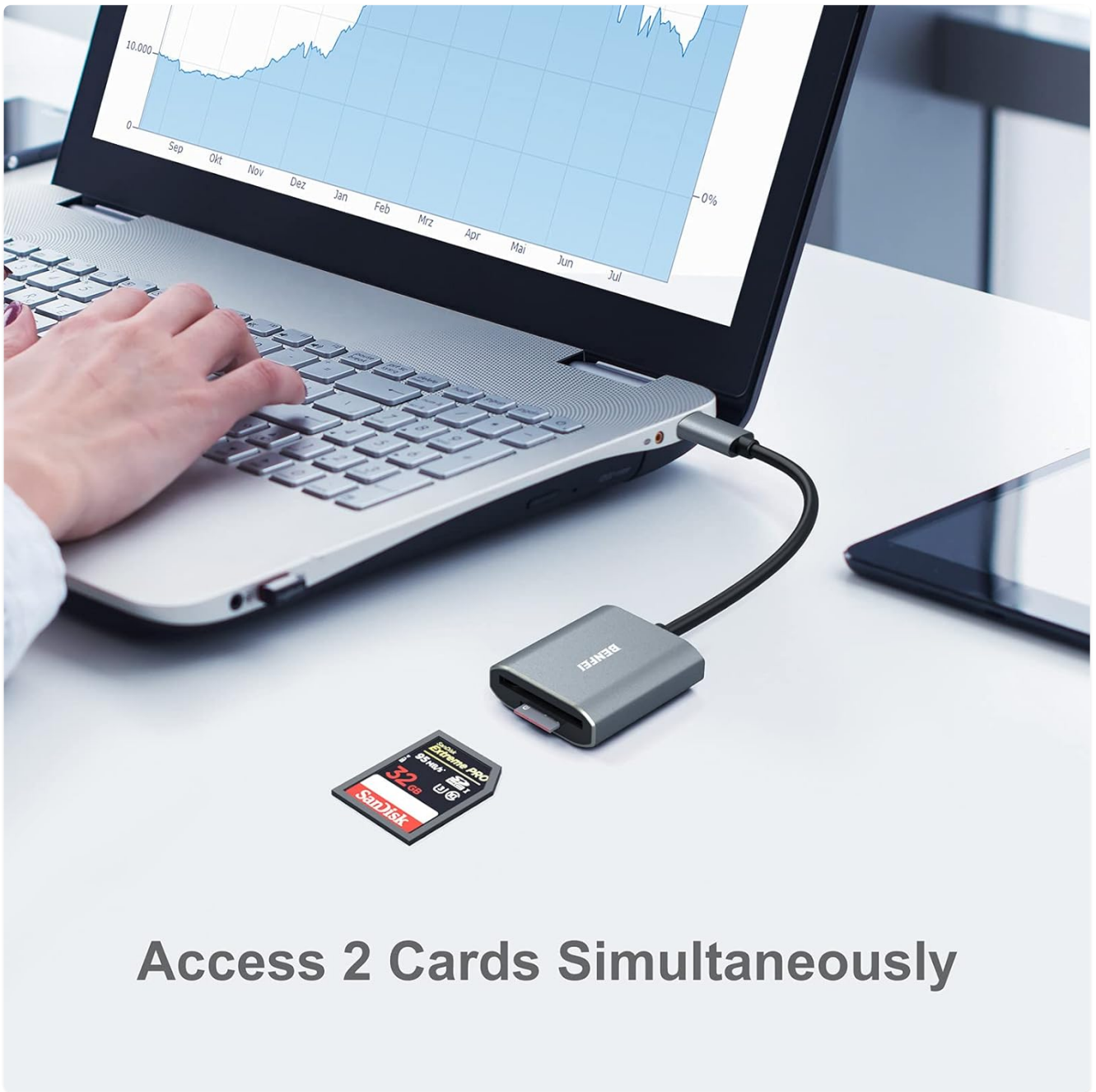

Access 2 Cards Simultaneously

Image 2.1: The card reader connected to a laptop, demonstrating its ability to access two cards simultaneously (SD and MicroSD).

Universal SD Compatibility

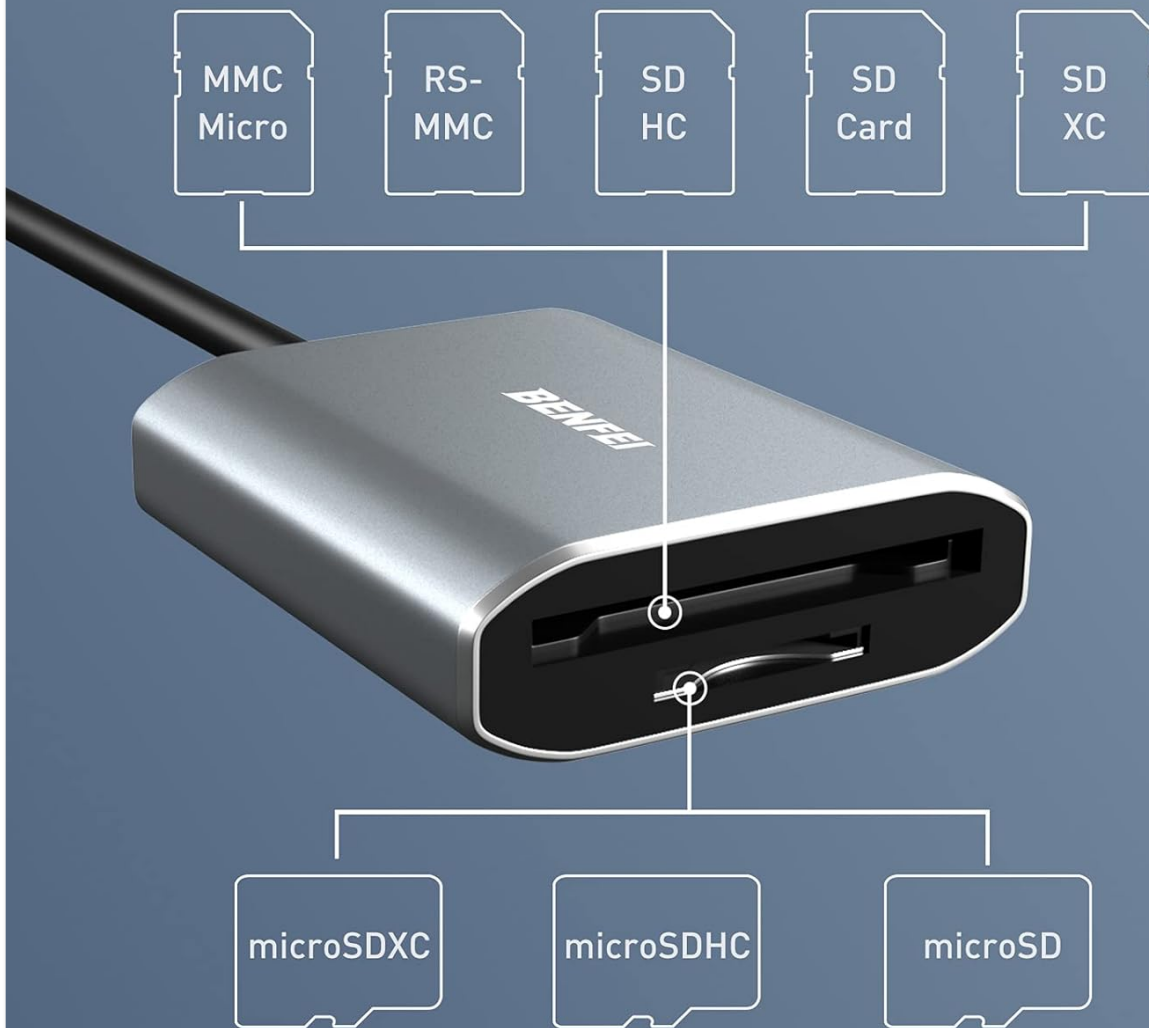

Image 2.2: Diagram illustrating the universal compatibility of the card reader with various SD card types, including MMC Micro, RS-MMC, SDHC, SD Card, SDXC, microSDXC, microSDHC, and microSD.



Image 2.3: Visual representation of the USB 3.1 Gen SD/TF solution, highlighting super speed data transfer up to 5Gbps compared to USB 2.0's 480 Mbps.

3. SETUP GUIDE

3.1 Connecting the Card Reader

1. Locate an available USB-C port on your computer, laptop, tablet, or smartphone.
2. Insert the USB-C connector of the BENFEI card reader firmly into the USB-C port.
3. The device is plug-and-play, meaning it should be recognized automatically by your operating system without the need for additional drivers.

Highly Compatibility

Compatible Devices



MacBook Pro/MacBook Air/
Yoga/XPS



Ipad Pro 2020/2019/2018/Google
Galaxy Not 8/10/10+/S8/S8+/S9/S10

Compatible Operating Systems

Windows

macOS

Chrome OS

iPadOS

Andriod



Image 3.1: The card reader demonstrating high compatibility with various devices including MacBooks, iPads, and Android smartphones.

3.2 Driver Installation (Not Required)

The BENFEI 2-in-1 USB-C Card Reader is designed for immediate response and does not require any driver installation. Simply plug it into a compatible USB-C port, and your operating system will automatically detect and configure the device.

No Installation Needed

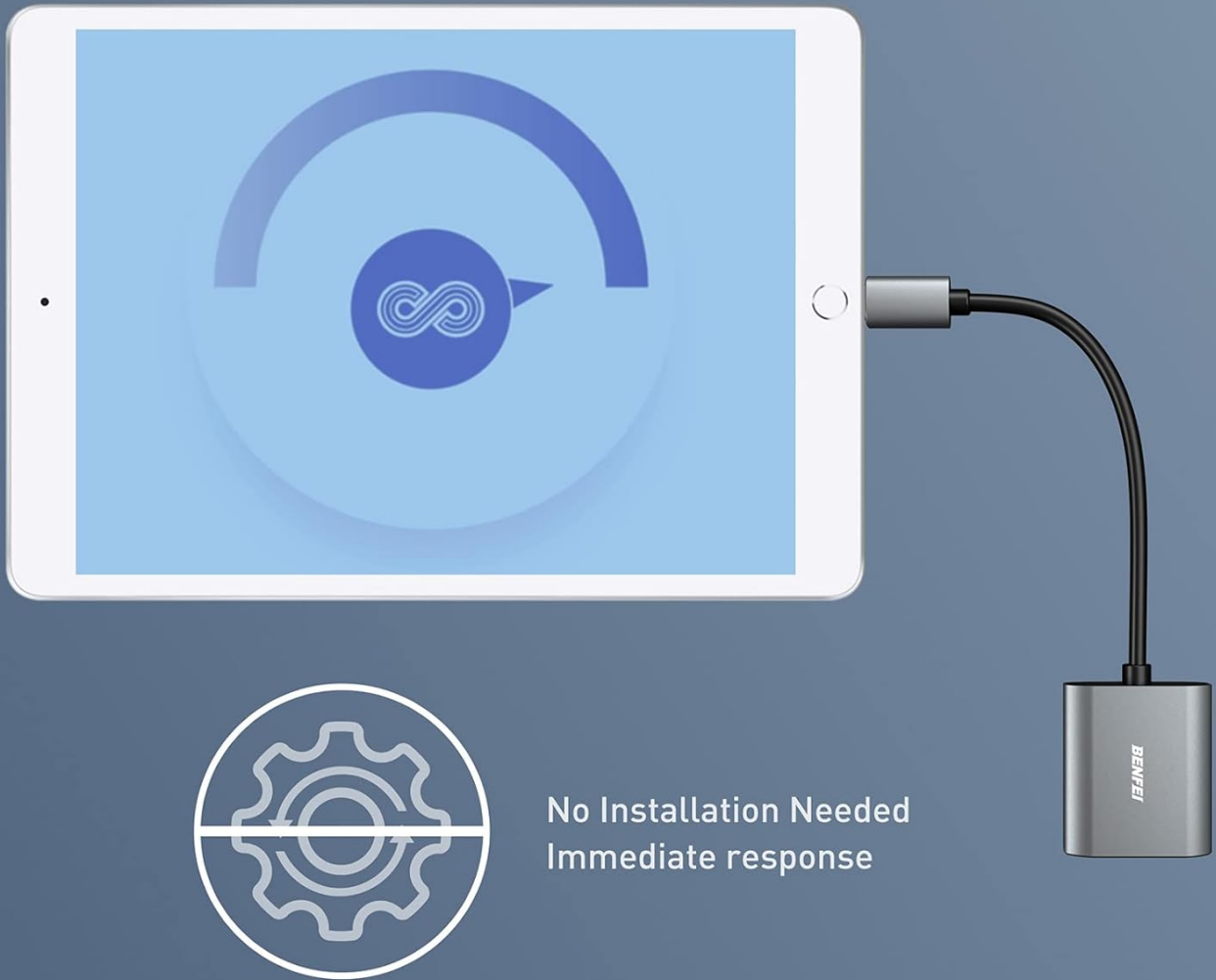

Image 3.2: Illustration showing the plug-and-play functionality of the card reader, indicating no installation is needed.

4. OPERATING INSTRUCTIONS

4.1 Inserting Memory Cards

- **For SD Cards:** Gently insert your SD card into the larger slot on the card reader until it clicks into place. Ensure the card is inserted with the correct orientation (contacts facing down).
- **For Micro SD (TF) Cards:** Gently insert your Micro SD card into the smaller slot on the card reader until it clicks into place. Ensure the card is inserted with the correct orientation (contacts facing down).

4.2 Accessing Data

Once the card reader is connected and a memory card is inserted, your operating system should recognize it as a removable storage device. You can then access the files on the card through your computer's file explorer (Windows) or Finder (macOS), or through a file management app on your mobile device.

4.3 Simultaneous Card Access

The BENFEI 2-in-1 card reader supports reading and writing to both SD and Micro SD cards simultaneously. This allows for easy transfer of files between the two card types or to and from your connected device at the same time.

5. CARE AND MAINTENANCE

- **Cleaning:** Use a soft, dry cloth to clean the exterior of the card reader. Avoid using liquid cleaners or solvents.
- **Storage:** Store the card reader in a cool, dry place away from direct sunlight and extreme temperatures.
- **Handling:** Avoid dropping the device or subjecting it to strong impacts. Do not force memory cards into the slots.
- **Disconnecting:** Always safely eject the card reader from your operating system before physically disconnecting it to prevent data corruption.

6. TROUBLESHOOTING

| Issue | Possible Cause | Solution |
|---|--|--|
| Card not recognized. | Incorrect insertion, faulty card, incompatible format, loose connection. | Ensure card is fully and correctly inserted. Try another memory card. Check if the card's file system (e.g., exFAT) is supported by your OS. Re-plug the card reader into the USB-C port. Try a different USB-C port if available. |
| Slow data transfer speeds. | Using a USB 2.0 port, slow memory card, background processes. | Ensure you are connected to a USB 3.0/3.1/3.2 (USB-C) port for optimal speeds. Use a high-speed memory card (UHS-I or faster). Close unnecessary applications running in the background. |
| "exFAT" formatted SDXC card not readable. | Older operating system version. | Update your operating system to a version that supports exFAT (e.g., Windows Vista SP1+, Mac OS X 10.6.6+). Alternatively, reformat the card to FAT32 if data loss is acceptable and the card size is 32GB or less. |
| Card reader gets warm during use. | Normal operation during high data transfer. | This is normal, especially during prolonged high-speed data transfers. If it becomes excessively hot or emits smoke/smell, disconnect immediately and contact support. |

7. PRODUCT SPECIFICATIONS

| Specification | Detail |
|-------------------------|--|
| Brand | BENFEI |
| Model Number | 000271grey |
| Connectivity Technology | USB Type C |
| Media Types Supported | microSDHC, microSD, SDXC, SDHC, UHS-1, SD Card |

| Specification | Detail |
|--------------------------------|---------------------------|
| Operating System Compatibility | Windows, Mac OS |
| Item Weight | 1.13 ounces |
| Product Dimensions (LxWxH) | 0.39 x 0.39 x 0.39 inches |
| Color | Grey |
| Special Feature | Plug & Play, Compact |

8. WARRANTY AND SUPPORT

BENFEI offers an exclusive **18-month warranty** for this product, ensuring long-term satisfaction with your purchase. This warranty covers manufacturing defects and ensures the product performs as described.

For any questions, technical assistance, or warranty claims, please contact BENFEI customer service. Our friendly and easy-to-reach customer service team is available to solve your problems timely.

You can find more information and contact details on the official BENFEI store page: [BENFEI Store](#).