

[Manuals.plus](#) /

> [Audoc](#) /

> Audoc Replacement Blades for Peanut Hair Clippers (Model #2068-300 / AUDOC-Peanut-2WB)

Audoc AUDOC-Peanut-2WB

Audoc Replacement Blades for Peanut Hair Clippers

Model: AUDOC-Peanut-2WB (Compatible with #2068-300)

1. INTRODUCTION

This manual provides instructions for the installation and maintenance of Audoc replacement blades for Peanut hair clippers. These blades are designed to offer precise trimming and outlining, restoring the performance of your compatible clipper.

Product Name: Audoc Replacement Blades for Peanut Hair Clippers

Model Number: AUDOC-Peanut-2WB

Compatibility: Designed for Wahl Professional Peanut trimmers models 8685, 8655, 8685-1301, and 8663.



Image: Two white Audoc replacement blades, ready for installation.

2. SAFETY INFORMATION

Always handle clipper blades with care. Blades are sharp and can cause injury if mishandled. Keep out of reach of children. Disconnect the clipper from its power source before attempting to replace blades or perform maintenance.

3. SETUP AND INSTALLATION

Follow these steps to replace the blades on your compatible Peanut hair clipper:

1. **Prepare the Clipper:** Ensure your clipper is turned off and unplugged from any power source.
2. **Remove Old Blade:** Carefully detach the old blade assembly from the clipper. This usually involves a snap-on mechanism.
3. **Clean Clipper:** Use a small brush to remove any accumulated hair or debris from the clipper's head and internal mechanisms.
4. **Attach New Blade:** Align the new Audoc replacement blade with the clipper's head and gently press until it snaps securely into place. Ensure it is firmly seated.

5. **Lubricate:** Apply a few drops of clipper oil (not included) to the new blades before first use to ensure smooth operation and longevity.

INSTALLATION NOTES

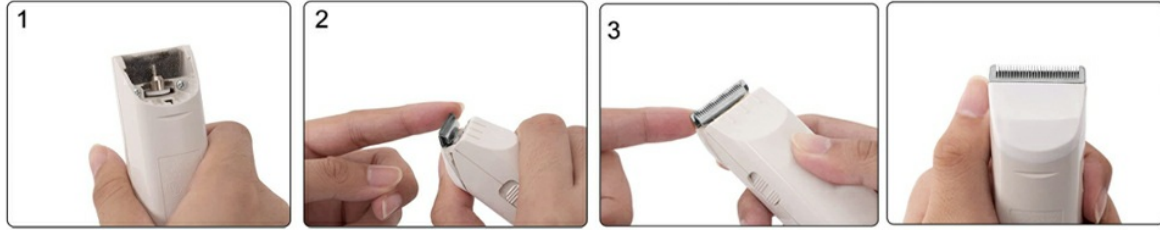

Image: Visual guide for installing replacement blades, showing the process of removing the old blade, cleaning, and snapping the new blade into position.

COMPATIBLE WITH MODEL



Fit Wahl Peanut Clipper

Image: Illustration showing different models of Wahl Peanut clippers that are compatible with these replacement blades.

4. OPERATING WITH NEW BLADES

Once the new blades are installed and lubricated, your clipper is ready for use. The blades are designed

for precision trimming and outlining. For optimal performance, ensure the clipper is fully charged or connected to a stable power source.

5. MAINTENANCE

Regular maintenance ensures the longevity and performance of your Audoc replacement blades:

- **Cleaning:** After each use, brush off any hair or debris from the blades using a small cleaning brush.
- **Lubrication:** Apply a few drops of clipper oil to the blades before or after each use. This reduces friction, prevents rust, and maintains cutting efficiency.
- **Storage:** Store the clipper with the blades in a clean, dry place to prevent damage and corrosion.

6. TROUBLESHOOTING

Problem	Possible Cause	Solution
Blades do not cut smoothly or pull hair.	Insufficient lubrication; blades are dull; hair buildup.	Clean blades thoroughly and apply clipper oil. If blades are old, consider replacing them.
New blades do not fit or snap into place.	Incorrect model compatibility; improper alignment.	Verify your clipper model number against the listed compatible models. Ensure correct alignment during installation. Do not force the blades.
Clipper motor does not work after blade replacement.	Blades not properly seated, obstructing motor mechanism.	Remove and re-install the blades, ensuring they are correctly snapped into place without obstruction. If the issue persists, contact support.

7. SPECIFICATIONS

- **Brand:** Audoc
- **Model Number:** AUDOC-Peanut-2WB
- **UPC:** 653846984678
- **Package Dimensions:** 2.36 x 1.97 x 0.94 inches
- **Item Weight:** 1.13 ounces (0.03 Kilograms)
- **Color:** White
- **Compatibility:** Fits Wahl Professional Peanut trimmers (models 8685, 8655, 8685-1301, 8663)

Size: 1.4x1.2 inches, Fit Wahl Peanut Clipper

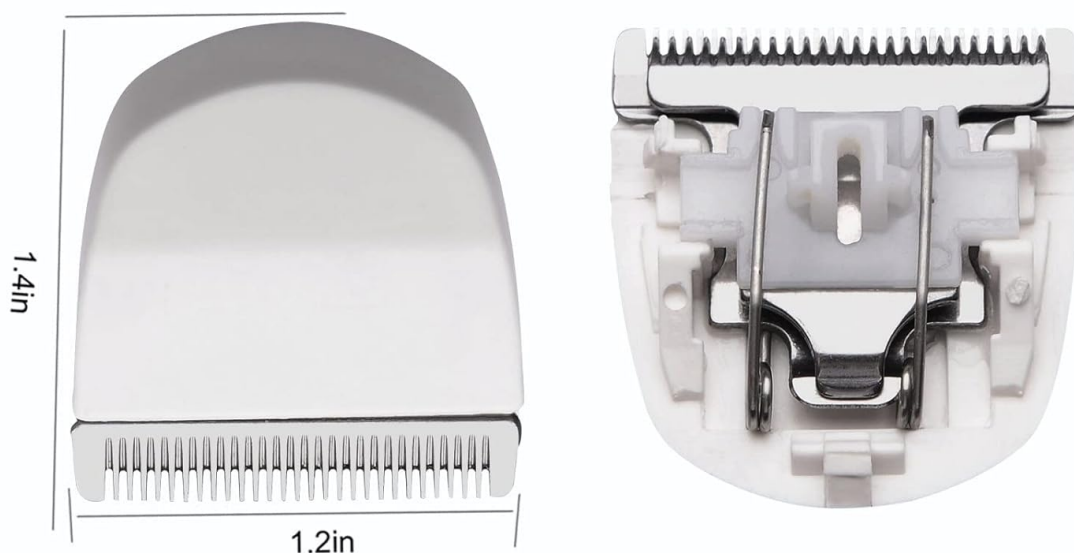

Image: Diagram showing the dimensions of the replacement blade: 1.4 inches in length and 1.2 inches in width.

8. WARRANTY AND SUPPORT

Audoc stands by its products. If you encounter any problems with your Audoc replacement blades, please contact the seller or Audoc customer support for assistance. They are committed to offering solutions to product issues.

For further support, you may visit the [Audoc Store on Amazon](#).