

## PRUNUS J-288

# PRUNUS J-288 Portable Radio User Manual

Model: J-288 | Brand: PRUNUS

## 1. PRODUCT OVERVIEW

The PRUNUS J-288 is a versatile portable radio offering AM/FM reception, Bluetooth speaker functionality, and an integrated MP3 player supporting USB disk and TF card inputs. Designed for convenience and high-quality audio, it features an ultra-long antenna for enhanced signal reception, a power-saving display, and a sleep timer function.



Figure 1.1: Front view of the PRUNUS J-288 Portable Radio, showcasing its compact design, speaker grilles, digital display, and control buttons.

## 2. KEY FEATURES

- **Excellent Reception:** Equipped with a 56cm ultra-long antenna for enhanced signal stability, capable of auto-saving up to 99 AM (522-1620KHZ) and 98 FM (87-108MHZ) stations.
- **5-in-1 Stereo Radio Speaker:** Supports TF card, Bluetooth, AUX input, USB flash drive, and radio modes. Features dual 3W magnetic speakers for clear bass and immersive stereo sound.
- **Bluetooth & Hands-Free:** Upgraded Bluetooth 4.0 technology for fast transmission and automatic re-connection. Functions as a hands-free telephone receiver (Note: Bluetooth headphones are not supported).
- **Sleep Timer:** Allows setting a shutdown time in advance (15min, 30min, 60min, 90min, 120min, 240min) for convenient listening before sleep.
- **Power-Saving Battery:** Features a 1200mAh Li-ion rechargeable battery and an upgraded AOD (Always-On Display) screen unit that turns black when not in manual operation, providing up to 10 hours of playtime at 30% volume.

### 3. PACKAGE CONTENTS

---

Please check the package contents upon unboxing to ensure all items are present:

- PRUNUS J-288 Portable Radio
- Hand Strip
- USB Charging Cable (*Inferred, typically included*)
- User Manual (*This document*)

### 4. SAFETY INFORMATION

---

To ensure safe and proper operation of your PRUNUS J-288 radio, please observe the following safety precautions:

- Do not expose the device to rain, moisture, or extreme temperatures.
- Avoid dropping or subjecting the device to strong impacts.
- Do not disassemble, repair, or modify the unit yourself. Refer all servicing to qualified personnel.
- Keep the device away from direct sunlight, heat sources, and open flames.
- Use only the specified charging cable and power adapter (if applicable) to charge the battery.
- Dispose of batteries properly according to local regulations.

### 5. SETUP

---

#### 5.1 Charging the Battery

The PRUNUS J-288 comes with a built-in 1200mAh Li-ion rechargeable battery. Before first use, it is recommended to fully charge the device.

1. Connect the USB charging cable to the charging port on the radio.
2. Connect the other end of the USB cable to a standard USB power adapter (e.g., 5V/1A) or a computer's USB port.
3. The charging indicator light will illuminate. Once fully charged, the indicator will turn green.

#### 5.2 Antenna Setup

For optimal radio reception, extend the telescopic antenna fully. Adjust its direction for the best signal clarity.



Figure 5.1: The PRUNUS J-288 with its ultra-long telescopic antenna extended, illustrating its role in enhancing radio signal reception.

### 5.3 Initial Power On

Press and hold the **Power** button (🔌) to turn on the radio. The display will light up, indicating the current mode or frequency.

## 6. OPERATING INSTRUCTIONS

---

### 6.1 Power On/Off

- Press and hold the **Power** button to turn the device ON or OFF.

### 6.2 Mode Selection

Press the **MODE** button to cycle through available modes: FM Radio, AM Radio, Bluetooth, TF Card, USB Disk, and AUX Input.

### 6.3 Radio Mode (AM/FM)

1. Switch to FM or AM mode using the **MODE** button.
2. **Auto Scan:** Press the **SCAN** button to automatically search and save available stations. The radio can save up to 99 AM and 98 FM stations.
3. **Manual Tuning:** Use the numeric keypad to directly enter a frequency (e.g., 1062 for 106.2 MHz FM).
4. **Browse Saved Stations:** Use the **Previous** (⏮) and **Next** (⏭) buttons to navigate through saved stations.

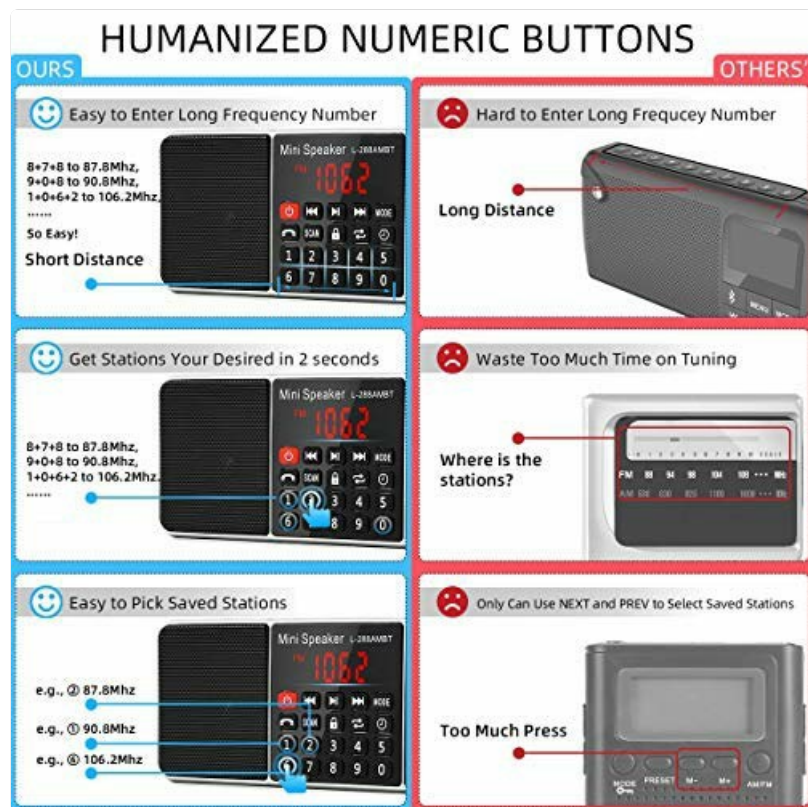

Figure 6.1: The numeric keypad on the PRUNUS J-288, allowing for direct frequency input and easy selection of saved stations.

## 6.4 Bluetooth Mode

1. Switch to Bluetooth mode using the **MODE** button. The display will show "BT" and a Bluetooth icon.
2. On your mobile device, enable Bluetooth and search for "PRUNUS J-288".
3. Select the device to pair. A confirmation sound will indicate successful pairing.
4. You can now play audio from your connected device through the radio.
5. To use the hands-free function, answer incoming calls directly from your phone; audio will be routed through the radio.



# WIRELESS BLUETOOTH SPEAKER

Free to enjoy your favorite music



Figure 6.2: The PRUNUS J-288 functioning as a wireless Bluetooth speaker, connected to a smartphone playing music.

## 6.5 MP3 Player Mode (USB Disk / TF Card)

1. Insert a USB flash drive or TF (Micro SD) card containing MP3 audio files into the respective slot on the radio.
2. The radio will automatically switch to the corresponding mode (USB or TF) and begin playing the first compatible audio file. If not, press the **MODE** button to select.
3. Use the **Previous** (⏮) and **Next** (⏭) buttons to skip tracks.
4. Press the **Play/Pause** button (⏮) to pause or resume playback.

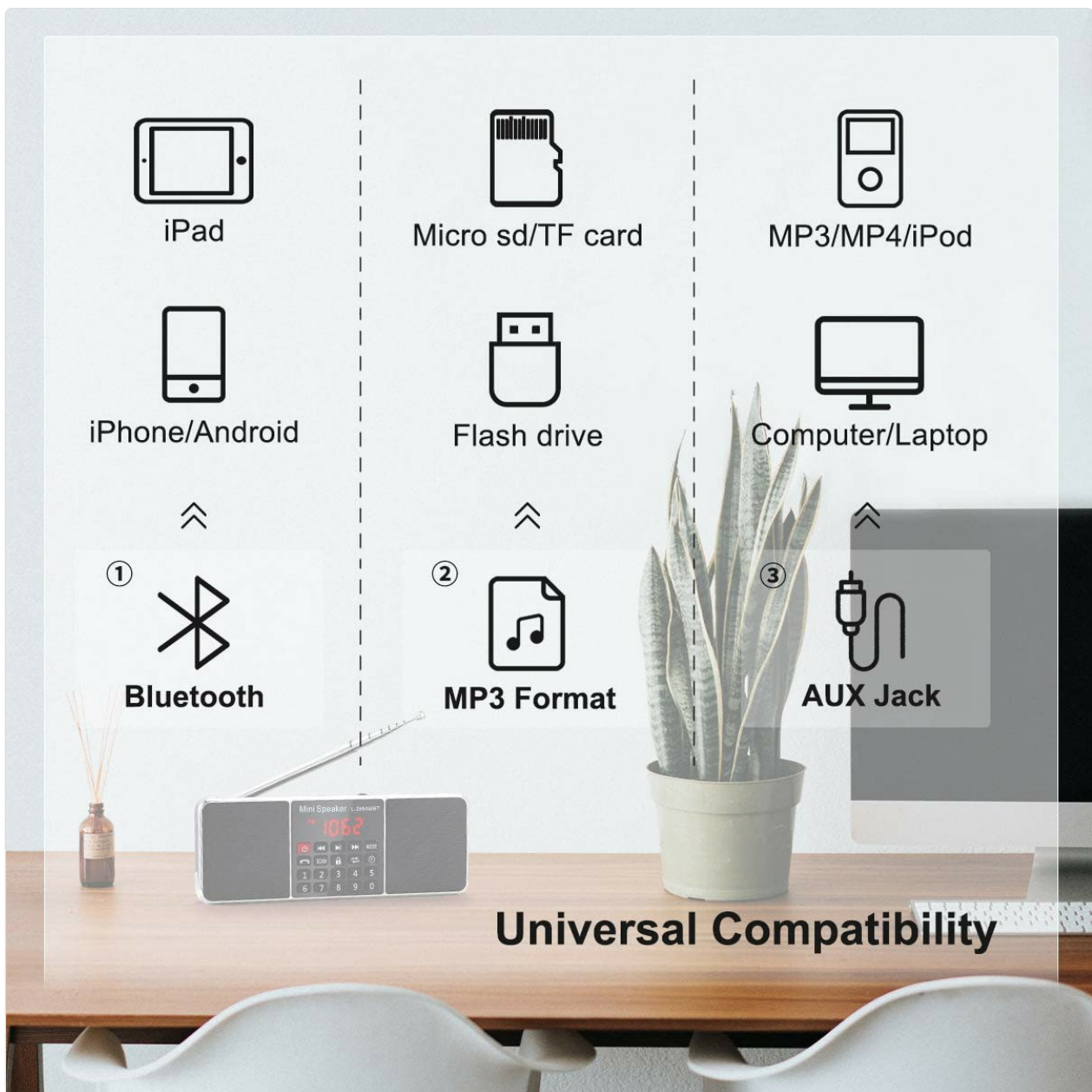

Figure 6.3: Diagram illustrating the universal compatibility of the PRUNUS J-288, showing support for Bluetooth, MP3 format via USB/TF card, and AUX input.

## 6.6 AUX Input Mode

1. Connect an external audio device (e.g., MP3 player, smartphone) to the AUX input port on the radio using a 3.5mm audio cable (not included).
2. Switch to AUX mode using the **MODE** button.
3. Audio from the connected device will now play through the radio's speakers. Control playback from your external device.

## 6.7 Sleep Timer Function

The sleep timer allows the radio to automatically turn off after a set period.

1. Press the **CLOCK** button (often labeled with a clock icon or integrated with the sleep timer function).
2. Repeatedly press the button to cycle through the available sleep timer options: 15min, 30min, 60min, 90min, 120min, 240min.
3. The selected time will be displayed. The radio will automatically power off after the set duration.



Figure 6.4: The PRUNUS J-288 displaying the sleep timer function, allowing users to set automatic shutdown times.

## 7. MAINTENANCE

Proper care and maintenance will extend the life of your PRUNUS J-288 radio.

- **Cleaning:** Use a soft, dry cloth to clean the exterior of the radio. Do not use abrasive cleaners, waxes, or solvents.
- **Storage:** When not in use for extended periods, store the radio in a cool, dry place, away from direct sunlight and extreme temperatures.
- **Battery Care:** To maintain battery health, avoid fully discharging the battery frequently. If storing for a long time, charge the battery to about 50% every few months.
- **Antenna:** Handle the telescopic antenna gently to prevent bending or breaking. Retract it when not in use or when transporting the radio.

## 8. TROUBLESHOOTING

If you encounter issues with your PRUNUS J-288, please refer to the following common problems and solutions:

Problem	Possible Cause	Solution
Radio does not power on.	Battery is depleted.	Charge the battery fully.
Poor radio reception.	Antenna not extended or positioned correctly; weak signal area.	Fully extend the antenna and adjust its direction. Try moving to an area with better signal.



Problem	Possible Cause	Solution
Bluetooth device cannot pair.	Radio not in Bluetooth mode; device too far; Bluetooth not enabled on external device.	Ensure radio is in Bluetooth mode. Move devices closer. Enable Bluetooth on your external device and search again.
No sound from USB/TF card.	Incorrect file format; card/drive not inserted properly; radio not in correct mode.	Ensure files are MP3 format. Reinsert the USB drive/TF card. Press MODE to select USB/TF mode.
Sound distortion.	Volume too high; weak signal; interference.	Lower the volume. Adjust antenna or move radio to reduce interference.

## 9. SPECIFICATIONS

Brand	PRUNUS
Model	J-288
Product Dimensions	18L x 2W x 6H Centimeters (approx. 2.03 x 17.78 x 5.84 cm)
Item Weight	308 g
Battery	1200mAh Lithium Ion (included, rechargeable)
Power Source	Battery Powered (5 Volts)
Tuner Technology	FM, AM
Radio Bands Supported	AM (522-1620KHZ), FM (87-108MHZ)
Hardware Interface	Bluetooth 5
Compatible Devices	Headphone, Smartphone, MP3 Player, USB Storage Device
Speakers Maximum Output Power	3 Watts
Display Type	LCD (LED Display Technology)
Material	Acrylonitrile Butadiene Styrene (ABS)
Includes Remote	No
Country of Origin	USA

## 10. WARRANTY AND SUPPORT

PRUNUS offers a manufacturer's warranty for the J-288 Portable Radio. Please refer to the warranty card included with your purchase or visit the official PRUNUS website for detailed warranty terms and conditions.

For technical support, troubleshooting assistance, or warranty claims, please contact PRUNUS customer service through their official channels. Contact information can typically be found on the product packaging or the brand's official website.

*Note: No official product videos were available from the seller for embedding in this manual.*