

AMP Research 75135-01A

AMP Research PowerStep Automatic Electric Running Boards

USER MANUAL FOR JEEP GLADIATOR JT (2020-2024)

Model: 75135-01A

1. Introduction

The AMP Research PowerStep is an automatic, electric-powered running board system designed to provide convenient vehicle access. These steps extend instantly when a door is opened and retract out of sight when doors are closed, enhancing ground clearance, aerodynamics, and overall vehicle appearance. Constructed with die-cast aluminum alloy components and precision stainless steel pivot pins, the PowerStep offers stability and reliability. This manual provides essential information for the installation, operation, maintenance, and troubleshooting of your PowerStep system.



Image 1.1: The AMP Research PowerStep system, showing both running boards and their deployment mechanisms.

2. Safety Information

Please read and understand all safety instructions before installation and operation to prevent injury or damage to the product or vehicle.

- **Moving Parts:** Keep hands and clothing clear of the PowerStep when it is deploying or retracting.
- **Pinch Hazard:** The PowerStep is equipped with 'Anti-Pinch' technology. However, always exercise caution and ensure no obstructions are present during operation.
- **Weight Limit:** Do not exceed the maximum weight capacity of 600 pounds per step.
- **Secure Installation:** Ensure all components are securely fastened according to the installation guide to prevent accidental detachment.
- **Electrical Connections:** Disconnect the vehicle's battery before performing any electrical work. Ensure all wiring is properly insulated and routed away from heat sources or moving parts.

3. Package Contents

Verify that all components are present before beginning installation:

- PowerSteps (Left and Right)
- Mounting Hardware
- Wiring Harness
- Control Module
- LED Lights
- Vehicle-Specific Installation Guide

4. Setup and Installation

Installation of the AMP Research PowerStep requires mechanical aptitude and basic tools. A detailed, vehicle-specific installation guide is included with your product. Refer to this guide for precise instructions tailored to your 2020-2024 Jeep Gladiator JT.

Key Installation Considerations:

- **Pre-Assembly:** It is recommended to mount the motors to their respective brackets before attaching the steps to the vehicle.
- **Wiring:** The wiring harness connects to the vehicle's electrical system. Pay close attention to the instructions for routing wires to protect them from damage, heat, and moving components. Some users have noted that wire extensions may be necessary for optimal routing in certain areas.
- **Grommet Access:** For the Jeep Gladiator, a rubber grommet near the brake booster is typically used for routing wires into the cabin.
- **Initial Power-Up:** After all components are connected, apply power. The steps are designed to self-align upon initial deployment. Avoid manually forcing alignment.
- **Step Board Attachment:** Attach the step boards as the final step of the mechanical installation. Center them as desired before tightening all fasteners.

If you are not comfortable performing the installation yourself, it is highly recommended to seek assistance from a qualified professional installer.

INNOVATION IN MOTION.

POWERSTEP™



Image 4.1: A person utilizing the deployed PowerStep to enter a truck, demonstrating its functionality.

5. Operating Instructions

The AMP Research PowerStep operates automatically based on door activity.

- **Deployment:** When a vehicle door is opened, the corresponding PowerStep will automatically deploy to a convenient stepping position.
- **Retraction:** When all vehicle doors are closed, the PowerStep will automatically retract and hide out of sight beneath the vehicle.
- **LED Lighting:** Integrated LED lights illuminate the step surface upon deployment, providing enhanced visibility in low-light conditions.



POWERSTEP™
BEST EVERYDAY STEP.
Excellent ground clearance and attractive appearance.

Image 5.1: A close-up view of a foot on the textured, slip-resistant surface of the deployed PowerStep.



Image 5.2: The PowerStep featuring low-profile LED lighting for improved visibility and a textured, slip-resistant surface.

6. Maintenance

Regular maintenance ensures the longevity and optimal performance of your PowerStep system.

- **Cleaning:** Clean the step surfaces and pivot points regularly with mild soap and water. Avoid harsh chemicals or abrasive cleaners.
- **Lubrication:** Periodically apply a silicone-based lubricant to the pivot points to ensure smooth operation.
- **Inspection:** Routinely inspect all mounting hardware, wiring, and electrical connections for any signs of wear, corrosion, or looseness. Tighten any loose fasteners.
- **Debris Removal:** Ensure that no debris (mud, ice, rocks) obstructs the movement of the steps or the pivot mechanisms.

7. Troubleshooting

If you encounter issues with your PowerStep, refer to the following common troubleshooting steps:

- **Steps Not Deploying/Retracting:**

- Check all electrical connections for secure fitment and corrosion.
 - Verify that the vehicle's battery has sufficient charge.
 - Inspect for any physical obstructions preventing movement.
 - Ensure door sensors are functioning correctly (if applicable to your specific installation).
- **Unusual Noises:**
 - Lubricate pivot points as described in the Maintenance section.
 - Check for loose hardware or components.
 - **LED Lights Not Functioning:**
 - Inspect wiring to the LED lights for damage or loose connections.
 - Ensure the main power connection to the system is secure.

For persistent issues, consult the detailed installation guide or contact AMP Research customer support.

8. Specifications

| Feature | Detail |
|--------------------------------|-------------------------------|
| Model Number | 75135-01A |
| Compatibility | 2020 - 2024 Jeep Gladiator JT |
| Material | Die-cast Aluminum Alloy |
| Exterior Finish | Black Aluminum |
| Step Width | 6 inches (cab-length) |
| Weight Capacity | 600 Pounds per step |
| Lighting | Integrated LED Step Lights |
| Safety Features | 'Anti-Pinch' Technology |
| Item Weight | Approximately 54 Pounds |
| Product Dimensions (L x W x H) | 88 x 11.25 x 10.25 inches |

9. Warranty and Support

AMP Research stands behind its products with a comprehensive warranty.

- **Warranty Period:** The PowerStep system is backed by a 5-year/60,000-mile warranty.
- **Support:** For technical assistance, warranty claims, or further inquiries, please refer to the contact information provided in your product packaging or visit the official AMP Research website.

10. Official Product Videos

Based on the provided product data, no official seller videos are available for embedding in this manual. For visual guides or demonstrations, please check the manufacturer's official website or authorized channels.

Related Documents - 75135-01A

| | |
|---|---|
|  | <p>AMP Research PowerStep Installation Guide for Sprinter Van (2019-2021)</p> <p>Detailed installation instructions for AMP Research PowerStep running boards on 2019-2021 Sprinter Vans. Includes parts list, tools required, and step-by-step guidance for safe and proper installation.</p> |
|  | <p>AMP Research PowerStep Installation Guide for Chevrolet Silverado/GMC Sierra</p> <p>Comprehensive installation guide for AMP Research PowerStep automatic running boards on Chevrolet Silverado and GMC Sierra models (2014-2019). Includes parts list, tools required, step-by-step instructions, operation, maintenance, and warranty information.</p> |
|  | <p>AMP Research PowerStep Installation Guide for Chevrolet Silverado and GMC Sierra</p> <p>Detailed installation guide for AMP Research PowerStep running boards on Chevrolet Silverado and GMC Sierra models (2007-2014). Includes parts list, tools required, step-by-step instructions, operation, maintenance, and warranty information.</p> |
|  | <p>AMP Research PowerStep Smart Series Installation Guide for Chevrolet Silverado and GMC Sierra</p> <p>Comprehensive installation guide for AMP Research PowerStep Smart Series running boards on Chevrolet Silverado and GMC Sierra models (2019-2023). Includes application details, parts list, tools required, step-by-step installation instructions, operation, maintenance, and warranty information.</p> |
|  | <p>AMP Research PowerStep Installation Guide for Dodge Ram</p> <p>Comprehensive installation guide for AMP Research PowerStep automatic running boards on Dodge Ram vehicles. Includes application details, parts list, step-by-step instructions, wiring diagrams, operation, maintenance, and warranty information.</p> |
|  | <p>AMP Research PowerStep Installation Guide for Chevrolet Silverado and GMC Sierra</p> <p>Detailed installation guide for AMP Research PowerStep running boards on Chevrolet Silverado 1500/2500/3500 and GMC Sierra 1500/2500/3500 models (2022-2024). Includes parts list, tools required, step-by-step instructions, and warranty information.</p> |

lang:en score:28 filesize: 2.7 M page_count: 17 document date: 2022-08-26

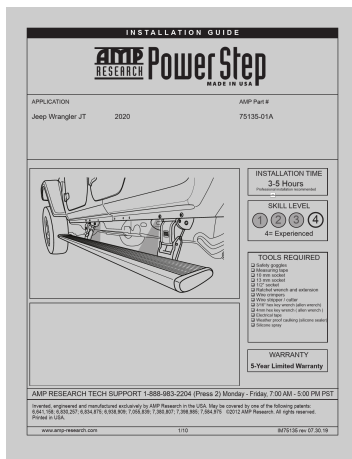
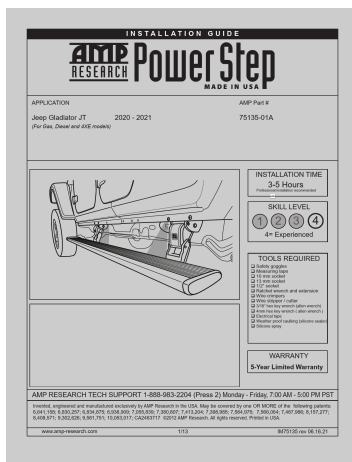



CAPE FEAR

CUSTOMS

BUILD SHEET

Vehicle Equipment & Pricing (MSRP) 05/01/2008

Valid through September 30, 2025 through September 30, 2026

Casting Description - AMP Research - All Products

- 12.5 % DISCOUNT OFF MSRP

| Current P/N | Type | Year | Year | Year | Model | Model | MSRP |
|-------------|------------------------|------|------|------|-------|-------|---------|
| 11881-CA-01 | BE11712431-CA-01-01-01 | 1999 | 2001 | 2002 | CLUB | CLUB | 1100.00 |
| 11881-CA-02 | BE11712431-CA-02-01-01 | 1999 | 2001 | 2002 | CLUB | CLUB | 1100.00 |
| 11881-CA-03 | BE11712431-CA-03-01-01 | 1999 | 2001 | 2002 | CLUB | CLUB | 1100.00 |
| 11881-CA-04 | BE11712431-CA-04-01-01 | 1999 | 2001 | 2002 | CLUB | CLUB | 1100.00 |
| 11881-CA-05 | BE11712431-CA-05-01-01 | 1999 | 2001 | 2002 | CLUB | CLUB | 1100.00 |
| 11881-CA-06 | BE11712431-CA-06-01-01 | 1999 | 2001 | 2002 | CLUB | CLUB | 1100.00 |
| 11881-CA-07 | BE11712431-CA-07-01-01 | 1999 | 2001 | 2002 | CLUB | CLUB | 1100.00 |
| 11881-CA-08 | BE11712431-CA-08-01-01 | 1999 | 2001 | 2002 | CLUB | CLUB | 1100.00 |
| 11881-CA-09 | BE11712431-CA-09-01-01 | 1999 | 2001 | 2002 | CLUB | CLUB | 1100.00 |
| 11881-CA-10 | BE11712431-CA-10-01-01 | 1999 | 2001 | 2002 | CLUB | CLUB | 1100.00 |
| 11881-CA-11 | BE11712431-CA-11-01-01 | 1999 | 2001 | 2002 | CLUB | CLUB | 1100.00 |
| 11881-CA-12 | BE11712431-CA-12-01-01 | 1999 | 2001 | 2002 | CLUB | CLUB | 1100.00 |
| 11881-CA-13 | BE11712431-CA-13-01-01 | 1999 | 2001 | 2002 | CLUB | CLUB | 1100.00 |
| 11881-CA-14 | BE11712431-CA-14-01-01 | 1999 | 2001 | 2002 | CLUB | CLUB | 1100.00 |
| 11881-CA-15 | BE11712431-CA-15-01-01 | 1999 | 2001 | 2002 | CLUB | CLUB | 1100.00 |
| 11881-CA-16 | BE11712431-CA-16-01-01 | 1999 | 2001 | 2002 | CLUB | CLUB | 1100.00 |
| 11881-CA-17 | BE11712431-CA-17-01-01 | 1999 | 2001 | 2002 | CLUB | CLUB | 1100.00 |
| 11881-CA-18 | BE11712431-CA-18-01-01 | 1999 | 2001 | 2002 | CLUB | CLUB | 1100.00 |
| 11881-CA-19 | BE11712431-CA-19-01-01 | 1999 | 2001 | 2002 | CLUB | CLUB | 1100.00 |
| 11881-CA-20 | BE11712431-CA-20-01-01 | 1999 | 2001 | 2002 | CLUB | CLUB | 1100.00 |
| 11881-CA-21 | BE11712431-CA-21-01-01 | 1999 | 2001 | 2002 | CLUB | CLUB | 1100.00 |
| 11881-CA-22 | BE11712431-CA-22-01-01 | 1999 | 2001 | 2002 | CLUB | CLUB | 1100.00 |
| 11881-CA-23 | BE11712431-CA-23-01-01 | 1999 | 2001 | 2002 | CLUB | CLUB | 1100.00 |
| 11881-CA-24 | BE11712431-CA-24-01-01 | 1999 | 2001 | 2002 | CLUB | CLUB | 1100.00 |
| 11881-CA-25 | BE11712431-CA-25-01-01 | 1999 | 2001 | 2002 | CLUB | CLUB | 1100.00 |
| 11881-CA-26 | BE11712431-CA-26-01-01 | 1999 | 2001 | 2002 | CLUB | CLUB | 1100.00 |
| 11881-CA-27 | BE11712431-CA-27-01-01 | 1999 | 2001 | 2002 | CLUB | CLUB | 1100.00 |
| 11881-CA-28 | BE11712431-CA-28-01-01 | 1999 | 2001 | 2002 | CLUB | CLUB | 1100.00 |
| 11881-CA-29 | BE11712431-CA-29-01-01 | 1999 | 2001 | 2002 | CLUB | CLUB | 1100.00 |
| 11881-CA-30 | BE11712431-CA-30-01-01 | 1999 | 2001 | 2002 | CLUB | CLUB | 1100.00 |
| 11881-CA-31 | BE11712431-CA-31-01-01 | 1999 | 2001 | 2002 | CLUB | CLUB | 1100.00 |
| 11881-CA-32 | BE11712431-CA-32-01-01 | 1999 | 2001 | 2002 | CLUB | CLUB | 1100.00 |
| 11881-CA-33 | BE11712431-CA-33-01-01 | 1999 | 2001 | 2002 | CLUB | CLUB | 1100.00 |
| 11881-CA-34 | BE11712431-CA-34-01-01 | 1999 | 2001 | 2002 | CLUB | CLUB | 1100.00 |
| 11881-CA-35 | BE11712431-CA-35-01-01 | 1999 | 2001 | 2002 | CLUB | CLUB | 1100.00 |
| | | | | | | | |

[\[pdf\]](#) Installation Guide Guide Warranty Catalog

AMP Research 75132 01A PowerStep Offroad Alliance IS 75135 catalograck ImgVD |||

INSTALLATION GUIDE APPLICATION Jeep Gladiator JT 2020 - 2021 For Gas,
Diesel and 4XE models AMP Part # **75135-01A** INSTALLATION TIME 3-5 Hours
Professional installation recommended SKILL LEVEL 123 4 4= Experienced TOOLS
REQUIRED q Safety goggles q Measuring tape q 10 mm socket q 13 mm socket q...
lang:en score:23 filesize: 2.45 M page_count: 15 document date: 2021-06-16

[\[pdf\]](#) Installation Guide Guide Warranty

IS 75135 AMP Research PowerStep Electric Running Boards 01A 2020 Jeep Gladiator Dale s Super
Store is75135 dalessuperstore 327595 |||

INSTALLATION GUIDE APPLICATION Jeep Wrangler JT 2020 AMP Part # **75135-01A** INSTALLATION TIME 3-5 Hours Professional installation recommended SKILL LEVEL 123 4 4= Experienced TOOLS REQUIRED q Safety goggles q Measuring tape q 10 mm socket q 13 mm socket q 1/2 socket q Ratchet wrench and extension...

[\[pdf\]](#) Catalog Price List

AMP Research Price List MyVendorlinkCatalog Discount All Products 12.5 % DISCOUNT OFF OF 76152
01A POWERSTEP PLUG PLAY 2021 2024 FORD F 150 \$1 799.99 76153 01ABUILD

Researchmyvendorlink external vfile d vrf s 185793 v 110794 sv i 184 ft b |||

BUILD SHEET Vehicle Equipment Upfitting Bid 26-12-0909 Valid through September 09, 2025 through Se ... 75115-01A 75116-01A 75118-01A 75120-01A 75121-01A 75122-01A 75125-01A 75126-01A 75132-01A 75134-01A **75135-01A** 75137-01A 75138-01A-B 75141-01A 75142-01A 75146-01A 75154-01A-B 75155-01A 75162-01A 75163-...

lang:i-klngon score:17 filesize: 187.14 K page_count: 5 document date:

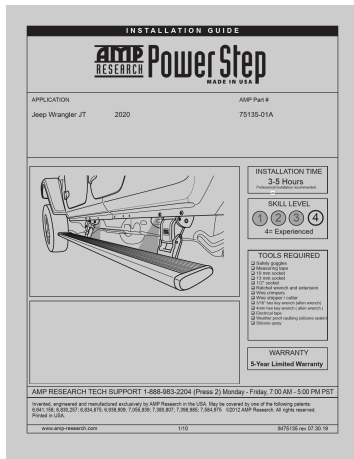

[pdf] Installation Guide Guide Warranty

AMPIS 75135 1ddf4b1b856a39e33863 d785dc0e3b62b5e0ef07f55db00b0659 ssl cf2 rackcdn LUND International |||

INSTALLATION GUIDE APPLICATION Jeep Wrangler JT 2020 AMP Part # **75135-01A** INSTALLATION TIME 3-5 Hours Professional installation recommended SKILL LEVEL 1 2 3 4 = Experienced TOOLS REQUIRED q Safety goggles q Measuring tape q 10 mm socket q 13 mm socket q 1/2 socket q Ratchet wrench and extension... lang:en score:16 filesize: 2 M page_count: 12 document date: 2020-02-18



[pdf] Warranty Catalog

Page 056 069Durable Bumpers Side Protection for Your Jeep FORTEC4x4Catalog 2021 56 69 bcdn shopify s files 1 2032 1321 Catalog b |||

Page 56 07 Bumpers 07 Bumpers Page 57 SpyderShellTM Armor Coat Black Proprietary, industrial-qua ... ght in under one second. 18-up JL Wrangler 4-Door AMP 75132-01A 1,399.00 20-up JT Gladiator AMP **75135-01A** 1,799.00 Installation Time 4 Hours Reduces Step Height by 13 Power Step in Down Posi... lang:en score:11 filesize: 6.42 M page_count: 7 document date: 2021-09-16