

## Eywamage CA-MA005-S3-GREY

# Eywamage Smoke Grey Glass Flameless Candles with Remote

Instruction Manual for Model CA-MA005-S3-GREY

## 1. INTRODUCTION

This manual provides instructions for the setup, operation, and maintenance of your Eywamage Smoke Grey Glass Flameless Candles. These LED pillar candles are designed to provide ambient lighting with the convenience of remote control and timer functions.

## 2. PACKAGE CONTENTS

- 3 x Eywamage Smoke Grey Glass Flameless Candles (various heights)
- 1 x Remote Control
- 1 x User Manual (this document)

## 3. SPECIFICATIONS

Feature	Description
Model Name	CA-MA005-S3-GREY
Material	Glass, Paraffin Wax
Color	Smoke Grey
Light Source	LED
Power Source	Battery Powered (2 x AA per candle, not included)

Feature	Description
Remote Control Battery	1 x CR2025 coin cell (included)
Battery Life (Candles)	350+ hours
LED Bulb Life	50,000+ hours
Control Method	Remote Control
Special Features	Built-in Timer (4/8 hours), Cordless, Flickering Effect, Dimmable
Product Dimensions	3"D x 3"W x 6"H (largest candle)



Image 1: Dimensions of the three flameless candles. The candles have a 3-inch diameter and heights of 4, 5, and 6 inches respectively.

## 4. SETUP

Follow these steps to prepare your flameless candles for use:

### 1. Install Batteries in Candles:

- Locate the battery compartment at the bottom of each candle.
- Open the battery cover.
- Insert 2 x AA batteries (not included) into each candle, ensuring correct polarity (+/-).

- Close the battery cover securely.

## 2. Prepare Remote Control:

- The remote control is powered by one CR2025 coin cell battery, which is included.
- Remove the clear plastic insulating sheet from the remote control's battery compartment before first use.

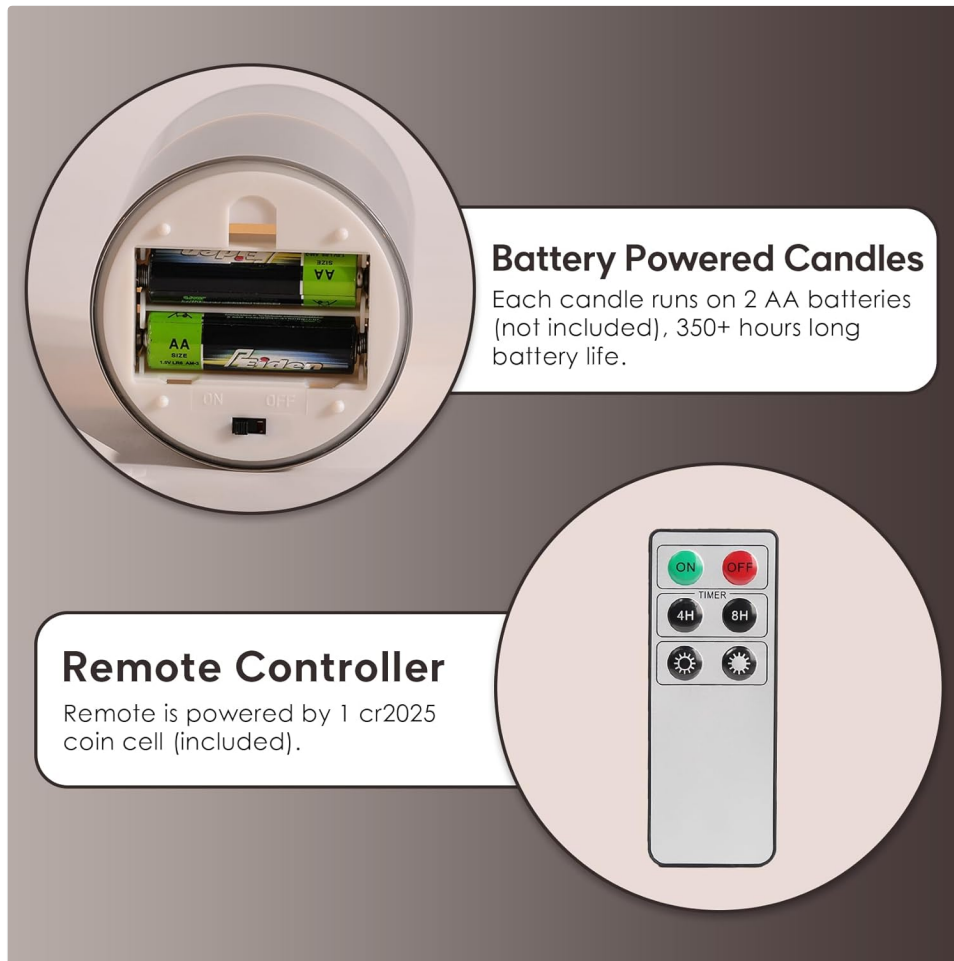

Image 2: Battery installation for the candles and remote control. Each candle requires 2 AA batteries, and the remote uses a CR2025 coin cell.

## 5. OPERATING INSTRUCTIONS

Use the included remote control to operate your flameless candles. The remote can control all three candles simultaneously from up to 20 feet away.



Image 3: The set of three smoke grey flameless candles and their remote control.

### Remote Control Functions:

- **ON/OFF Button:** Press the **ON** button to turn the candles on. Press the **OFF** button to turn the candles off.
- **Timer Buttons (4H/8H):**
  - Press **4H** to set a 4-hour timer. The candles will stay on for 4 hours and then turn off automatically. They will turn on again at the same time the next day.
  - Press **8H** to set an 8-hour timer. The candles will stay on for 8 hours and then turn off automatically. They will turn on again at the same time the next day.
  - To cancel the timer, press the **OFF** button.
- **Brightness Adjustment Buttons:**
  - Use the **brightness up** button (sun icon with plus) to increase the candle's brightness.
  - Use the **brightness down** button (sun icon with minus) to decrease the candle's brightness.

# Remote Magic

## Your World in One Tap

Use remote to control power, set 4/8 hours timer and customize brightness from up to 20 feet away.



Note: please remove the insulating sheet in the remote before use.

Image 4: Remote control in use, demonstrating its functions for power, timer, and brightness.

## 6. MAINTENANCE

Proper care will ensure the longevity and appearance of your flameless candles.

- **Cleaning:** Wipe the glass and wax surfaces with a soft, dry cloth. Avoid abrasive cleaners or solvents.
- **Battery Replacement:** Replace batteries when the light dims or the candles stop responding. Always replace all batteries in a candle at the same time with new ones. Dispose of used batteries responsibly.
- **Storage:** If storing the candles for an extended period, remove the batteries to prevent leakage and corrosion. Store in a cool, dry place.
- **Handling:** Handle the glass candles with care to prevent breakage.

## QUALITY YOU CAN FEEL



Hand-poured real wax  
with an realistic  
black wick



Crafted from heavy-grade  
glass for a brilliant glow



Image 5: Details on the quality materials, including hand-poured wax and heavy-grade glass, which benefit from proper maintenance.

## 7. TROUBLESHOOTING

If you encounter issues with your flameless candles, refer to the following common solutions:

- **Candles do not turn on:**

- Ensure batteries are inserted correctly with proper polarity.
- Replace old batteries with new ones.
- Check if the ON/OFF switch at the bottom of the candle is in the 'ON' position.

- **Remote control is not working:**

- Ensure the plastic insulating sheet has been removed from the remote's battery compartment.
- Replace the CR2025 coin cell battery in the remote control.
- Ensure you are within the 20-foot operating range and there are no obstructions between the remote and the candles.

- **Candle light is dim or inconsistent:**

- This usually indicates low battery power. Replace the AA batteries in the affected candle(s).
- Use the brightness adjustment buttons on the remote to increase the light intensity.

- **Timer function is not working correctly:**

- Ensure the timer was set by pressing either the 4H or 8H button while the candles were on.
- To reset the timer, turn the candles off and then on again, and re-select your desired timer setting.

## 8. SAFETY INFORMATION

---

These flameless candles are designed with safety in mind, eliminating common hazards associated with traditional candles.

- **No Fire Risk:** As these are LED candles, there is no open flame, reducing the risk of fire.
- **No Smoke or Drips:** Enjoy the ambiance without smoke, soot, or wax drips.
- **Child and Pet Safe:** The flameless design makes these candles safer for homes with children and pets.
- **Indoor Use Only:** These candles are designed for indoor use. Avoid exposure to water or extreme temperatures.



Image 6: Illustration of the safety benefits of flameless candles in a home environment.

## 9. WARRANTY AND SUPPORT

---

Eywamage products are designed for quality and customer satisfaction.

- **Return Policy:** This product is typically eligible for returns within 30 days of receipt, subject to the

retailer's return policy. Please refer to your purchase documentation for specific details.

- **Customer Support:** For further assistance or inquiries, please visit the official Eywamage store or contact customer service through your purchase platform.