

TESmart HSW0501A1U

TESmart HSW0501A1U 5x1 HDMI Switch User Manual

Model: HSW0501A1U

1. INTRODUCTION

The TESmart HSW0501A1U is a 5x1 HDMI switch designed to connect up to five HDMI source devices to a single HDMI display. This device supports high-resolution video up to 4K@60Hz, including HDCP 2.2, Deep Color, 3DTV, HDR, and Dolby Vision. It is suitable for various applications such as home theater, gaming setups, meeting rooms, and classrooms, allowing for easy switching between multiple video sources. The switch features automatic input detection, front panel push-button control, and an infrared (IR) remote control for convenient operation.



Image 1.1: The TESmart 5x1 HDMI Switch and its accompanying IR remote control. The switch features multiple input ports and a single output port, with indicator lights for selected inputs.

2. FEATURES

- Connects up to 5 HDMI input devices to 1 HDMI output display.
- Supports video resolutions up to 4K@60Hz.
- Compatible with HDCP 2.2, Deep Color, 3DTV, HDR, and Dolby Vision.
- Data transfer rate up to 18 Gbps.
- Supports lossless audio formats including LPCM 7.1, Dolby TrueHD, and DTS-HD Master Audio.
- Automatic input detection and switching to the newly connected source.
- Multiple switching methods: front panel button and IR remote control.
- Compact design with durable ABS material and gold-plated interfaces for enhanced signal integrity.

4K@60Hz UHD

Sharp Picture and Impeccable quality



Video and Audio Synchronization

Image 2.1: A monitor displaying high-quality 4K@60Hz Ultra HD content, illustrating the video resolution capabilities of the HDMI switch.

3. PACKAGE CONTENTS

Please verify that all items are included in your package:

- 1 x TESmart 5x1 HDMI Switch (HSW0501A1U)
- 1 x IR Remote Control (CR2025 battery required, not included)
- 1 x IR Receiver Cable
- 1 x USB Power Cable (DC 5V)
- 1 x Quick Start Guide

Scope of Delivery

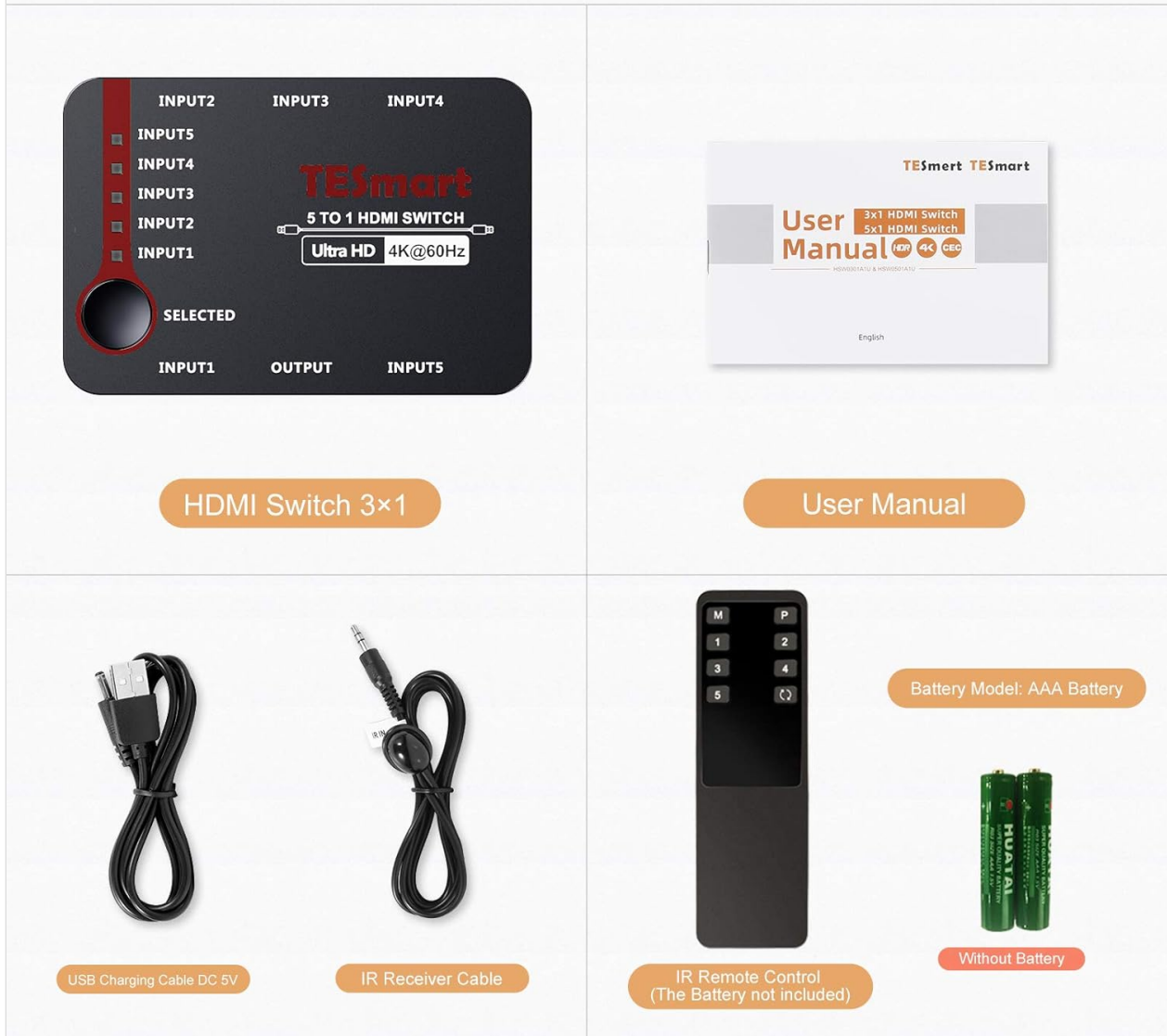

Image 3.1: An illustration of the items included in the product package: the HDMI switch, user manual, USB charging cable, IR receiver cable, and IR remote control (note: batteries are not included).

4. SETUP AND INSTALLATION

Follow these steps to set up your TESmart 5x1 HDMI Switch:

- 1. Connect HDMI Sources:** Plug your HDMI source devices (e.g., Xbox, PS4, Blu-ray player, laptop) into the HDMI INPUT ports (INPUT1 to INPUT5) on the switch.
- 2. Connect to Display:** Connect one end of an HDMI cable to the HDMI OUTPUT port on the switch and the other end to the HDMI input of your display (TV, monitor, projector).
- 3. Connect IR Receiver:** Plug the IR receiver cable into the 'IR' port on the switch. Position the IR receiver in a location where it has a clear line of sight to your remote control.
- 4. Install Remote Battery:** Open the battery compartment of the IR remote control and insert a CR2025 battery (not included), ensuring correct polarity.
- 5. Power On:** Connect the USB power cable to the DC 5V port on the switch and plug the other end into a USB power source (e.g., a USB port on your TV, a USB wall adapter). The switch will power on automatically.

Not Enough HDMI Input Ports?

Connect 5 devices to your TV by using 1 HDMI cable
Reduce cable clutter behind the TV and increase the number of source devices

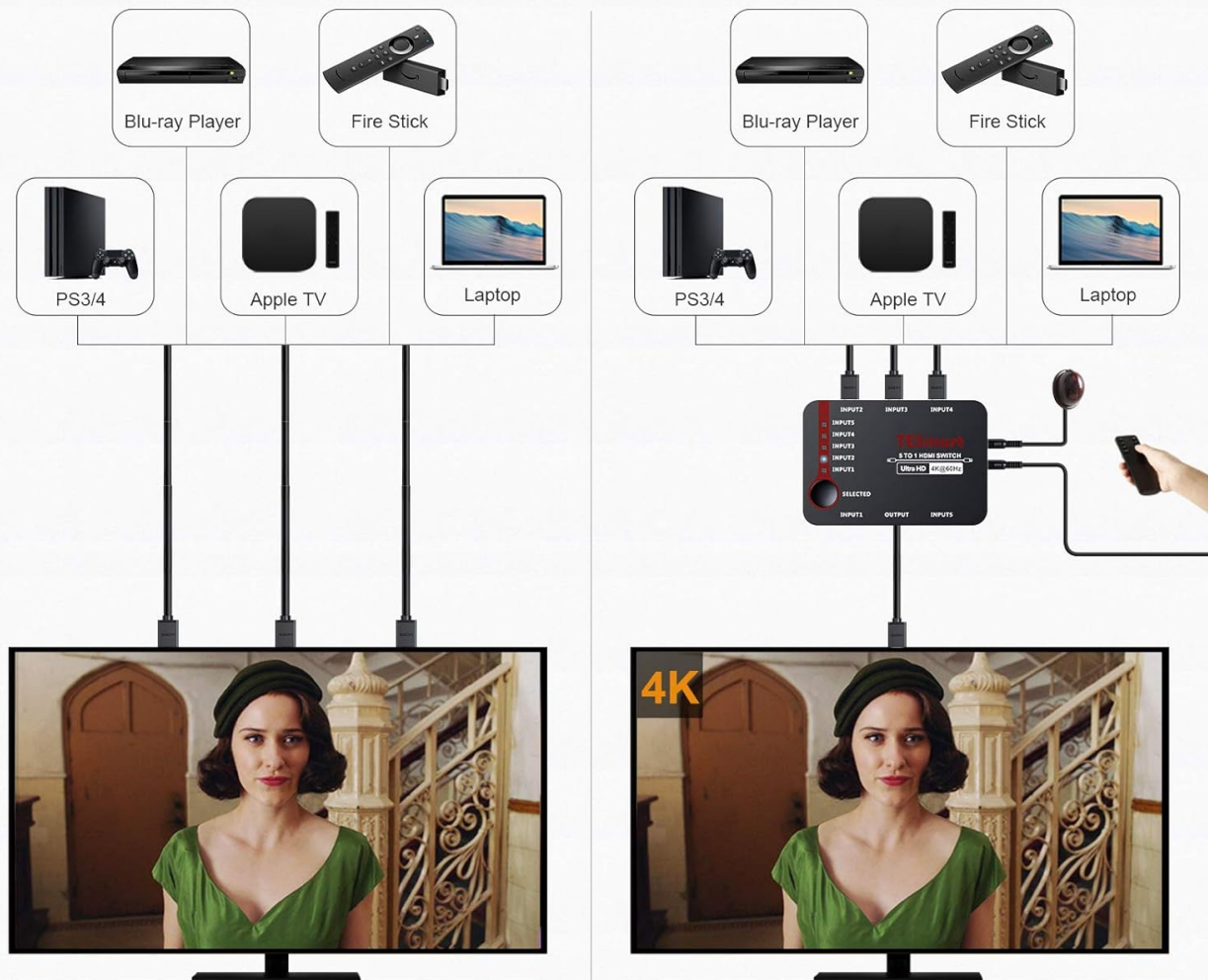

Image 4.1: A diagram illustrating how to connect multiple HDMI source devices (such as Blu-ray players, Fire Sticks, PS3/PS4 consoles, Apple TVs, and laptops) to a single television display using the TESmart 5x1 HDMI switch.



Image 4.2: A four-panel image demonstrating the installation of the battery into the IR remote control. It shows connecting the IR cable, opening the battery compartment, inserting the CR2025 battery, and using the remote with the switch.

5. OPERATING INSTRUCTIONS

The TESmart 5x1 HDMI Switch offers multiple methods for switching between connected HDMI sources:

- **Front Panel Button:** Press the 'SELECTED' button on the front panel of the switch to cycle through the HDMI input sources (INPUT1 to INPUT5). The corresponding LED indicator will light up to show the currently active input.
- **IR Remote Control:** Use the provided IR remote control to directly select an input. Press the numbered buttons (1-5) on the remote to switch to the desired HDMI input.
- **Automatic Switching:** The switch supports automatic input detection. When a new HDMI source device is powered on or connected, the switch will automatically detect it and switch to that input. If the currently active source is turned off, the switch may automatically switch to the next active source.

Multi-switching Methods



Front Panel Push Buttons



IR Remote Control



Auto Switch

Automatically Switches to a Newly Plugged-in Source



Image 5.1: An illustration of the various methods for switching inputs on the HDMI switch, including using the front panel push buttons, the IR remote control, and the automatic switching feature.

6. TROUBLESHOOTING

If you encounter issues with your TESmart 5x1 HDMI Switch, refer to the following common problems and solutions:

- **No Video/Audio Output:**

- Ensure all HDMI cables are securely connected to both the source devices, the switch, and the display.
- Verify that the switch is powered on and the correct input is selected.
- Try using different HDMI cables, as faulty cables can cause signal loss.
- Check your display's input settings to ensure it is set to the correct HDMI port connected to the switch.
- Restart all connected devices (source, switch, display).

- **Remote Control Not Working:**

- Ensure the CR2025 battery is correctly installed in the remote control and is not depleted.
 - Verify that the IR receiver cable is securely plugged into the switch and positioned with a clear line of sight to the remote.
 - Remove any obstructions between the remote and the IR receiver.
- **Intermittent Signal/Flickering:**
 - This can sometimes be caused by long or low-quality HDMI cables. Use certified high-speed HDMI cables, especially for 4K resolutions.
 - Ensure the power supply to the switch is stable.
 - Check if the resolution or refresh rate of your source device exceeds the capabilities of your display or the switch.
- **Automatic Switching Issues:**
 - Some source devices may not fully power down, preventing the switch from detecting a change. Manually switch inputs using the front panel button or remote if auto-switching is inconsistent.

7. SPECIFICATIONS





| Feature | Specification |
|------------------------|---|
| Brand | TESmart |
| Model Number | HSW0501A1U |
| Color | Black |
| Material | Plastic (ABS) |
| Input Ports | 5 x HDMI |
| Output Ports | 1 x HDMI |
| Max Resolution | 4K@60Hz (3840 x 2160) |
| HDCP Compliance | HDCP 2.2 |
| Data Rate | 18 Gbps |
| Supported Features | Deep Color, 3DTV, HDR, Dolby Vision |
| Audio Support | LPCM 7.1, Dolby TrueHD, DTS-HD Master Audio |
| Switching Methods | Front Panel Button, IR Remote, Auto-Switching |
| Power Supply | DC 5V (via USB cable) |
| Dimensions (L x W x H) | 8.8 x 6 x 1.9 cm |
| Compatible Devices | PS3 / PS4, PS4 Pro, Xbox, TV Box, Fire TV Stick, DVD Player |

8. WARRANTY AND SUPPORT

The TESmart HSW0501A1U 5x1 HDMI Switch comes with a one-year manufacturer's warranty from the date of purchase. This warranty covers defects in materials and workmanship under normal use. For technical assistance or warranty claims, please contact the TESmart customer support team. Lifetime free technical support is provided to ensure you get the most out of your product.

Contact Information: Please refer to the contact details provided in your Quick Start Guide or visit the official TESmart website for support.

Related Documents - HSW0501A1U

| | |
|---|--|
|  | <p>TESmart 4x1 HDMI KVM Switch User Manual - 4K@60Hz, USB 2.0</p> <p>Comprehensive user manual for the TESmart 4x1 HDMI KVM Switch. Learn about features, panel description, connection diagram, hotkey controls, IR remote operation, and warranty information for seamless 4K@60Hz video and USB 2.0 device sharing.</p> |
|  | <p>TESmart HSW0401A1U 4x1 HDMI Switch User Manual</p> <p>User manual for the TESmart HSW0401A1U 4x1 HDMI Switch. This guide provides detailed information on features, setup, connection, operation, safety tips, and technical support for the HDMI switch.</p> |
|  | <p>TESmart 8x1 and 16x1 HDMI Switch User Manual</p> <p>Comprehensive user manual for TESmart 8x1 and 16x1 HDMI Switches (models HSW0801A1U & HSW1601A1U), detailing features, connections, operation via front panel buttons, IR remote, RS232, and LAN control. Includes safety tips, warranty information, and software controller usage.</p> |
|  | <p>TESmart KVM Switch Troubleshooting Guide</p> <p>Comprehensive troubleshooting guide for TESmart KVM switches, covering common issues with hotkeys, keyboard/mouse, video signals, and refresh rates. Includes solutions and support information for models like HKS0401A1U.</p> |
|  | <p>TESmart Dual Monitor KVM Switch User Manual</p> <p>Comprehensive user manual for the TESmart 4x2 Dual Monitor KVM Switch. This guide covers product features, packing list, panel descriptions, display modes, connection diagrams, usage instructions, keyboard hotkeys, IR remote control, verified peripherals, warranty information, and technical support.</p> |

| | |
|---|---|
|  | <p>TESmart Dual Monitor KVM User Manual: Control Two Computers with Dual Displays</p> <p>Explore the TESmart Dual Monitor KVM Switch user manual for detailed setup, features, and operation. Learn to manage two computers with a single set of peripherals and dual monitors efficiently.</p> |
|---|---|