

manuals.plus /

> **Cumbor** /

> **Cumbor 29.7-46 Inch Baby Gate for Stairs and Doorways Instruction Manual**

## Cumbor S7V2

# Cumbor 29.7-46 Inch Baby Gate Instruction Manual

Model: S7V2

## 1. INTRODUCTION

---

Thank you for choosing the Cumbor Baby Gate. This instruction manual provides essential information for the safe and effective installation, operation, and maintenance of your new gate. Designed for openings between 29.7 and 46 inches wide and 30.5 inches high, this pressure-mounted gate offers a secure barrier for children and pets in various home environments, including stairs and doorways. Please read this manual thoroughly before installation and retain it for future reference.



Figure 1.1: Cumbor Baby Gate in a home setting, securing a staircase.

## 2. SAFETY INFORMATION

---

Your child's safety is paramount. Always follow these safety guidelines:

- Read all instructions before assembly and installation.
- This safety barrier is suitable for use with children from 6 to 24 months of age.
- This product is designed for domestic use only.
- Never leave a child unattended.
- Ensure the gate is securely installed and latched at all times.
- Regularly check all fittings and components to ensure they are in good working order.
- Do not use the safety barrier if any components are damaged or missing.

- The gate must be installed in a structurally sound opening.
- This safety barrier features a double-lock safety release mechanism to prevent toddlers from opening it easily.
- When installed at the top of stairs, the gate should be placed on the top step, away from the edge.
- When installed at the bottom of stairs, the gate should be placed on the lowest level.

### 3. PACKAGE CONTENTS

Verify that all components are present before beginning installation:

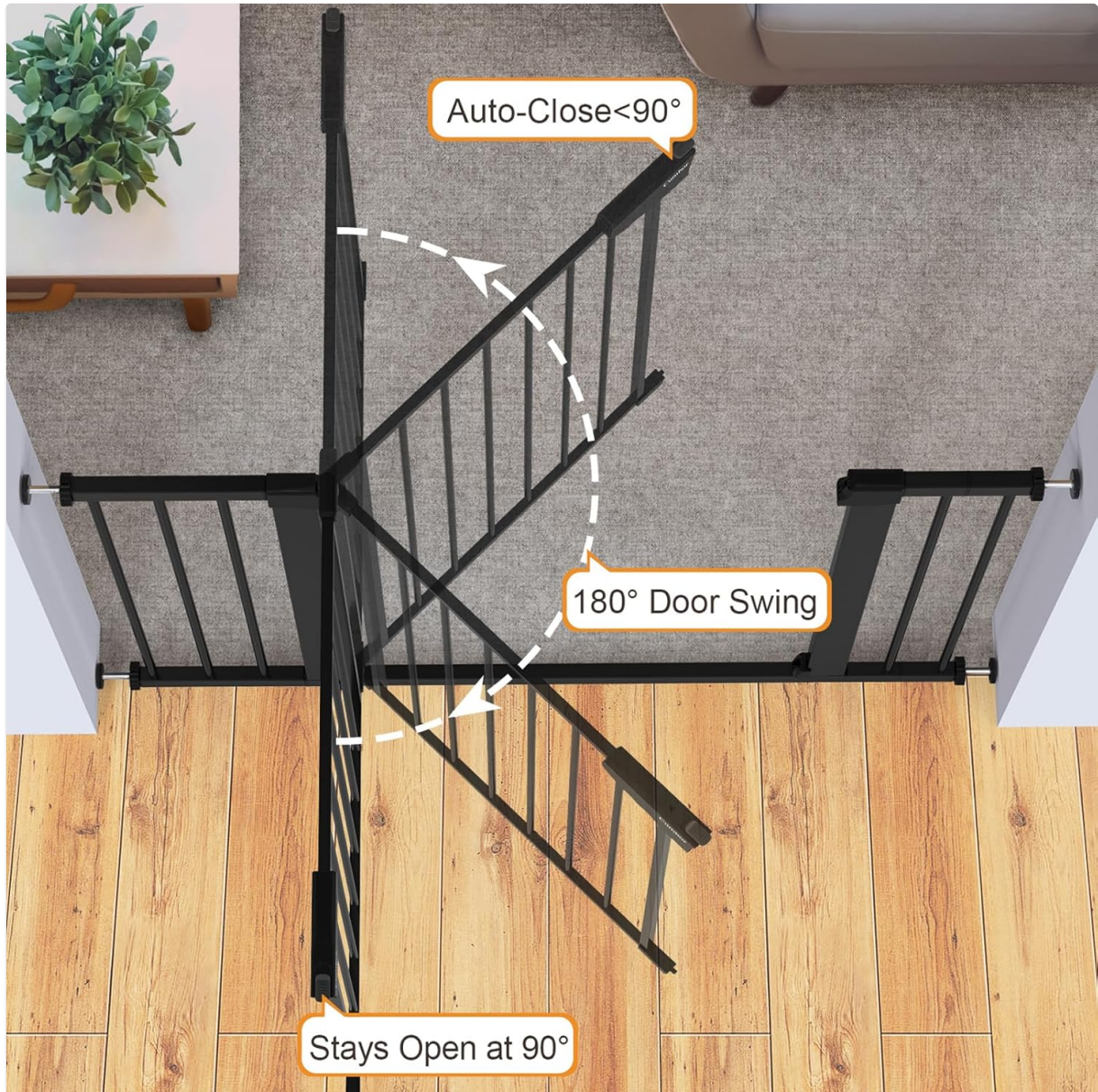

Figure 3.1: Illustrated list of package contents.

- **A: Main Gate** (x1)
- **B: Extension** (x3)
- **C: Tension Bolt** (x4)
- **D: Wall Cup** (x4)
- **E: Pedal** (x1)
- **F: Position Plate** (x1)
- **G: Stair Tension Bolt** (x2) - *Optional for rounded banisters*
- **H: U-Cup** (x2) - *Optional for rounded banisters*

- **I: Wall Anchor** (x4) - For hardware mounting
- **J: Screw** (x4) - For hardware mounting
- **K: Sticky Pad** (x4)
- **L: Wrench** (x1)

## 4. SETUP AND INSTALLATION

---

The Cumbor Baby Gate can be installed using either pressure mounting (no tools required) or hardware mounting for added security. Always measure your opening carefully.

### 4.1 Measuring Your Opening

This gate is designed for openings between 29.7 and 46 inches (75.4 cm - 116.8 cm) wide. Measure the installation distance at both the top and bottom mounting points. If baseboards are present, measure between the baseboards, not the wall edges.



Figure 4.1: Correct measurement for gate installation width.

### 4.2 Pressure-Mount Installation (No Hardware Required)

This method is suitable for most doorways and openings. No drilling is required.

1. **Assemble Gate:** Attach any necessary extensions (B) to the main gate (A) to fit your opening width.

2. **Insert Tension Bolts:** Screw the four tension bolts (C) into the corners of the gate frame.
3. **Position Gate:** Place the gate in the desired opening. Initially, there will be a gap between the gate door and the frame. This is normal and will close as the gate is tightened.
4. **Tighten Tension Bolts:** Rotate the tension bolts (C) clockwise to extend them and apply pressure against the walls. Tighten evenly until the gate is secure and the gap between the lock and door frame disappears. Use the provided wrench (L) for final tightening.
5. **Remove Zip Tie:** Once the gate is fully secure and the gap is closed, you may remove the zip tie connecting the door and frame.

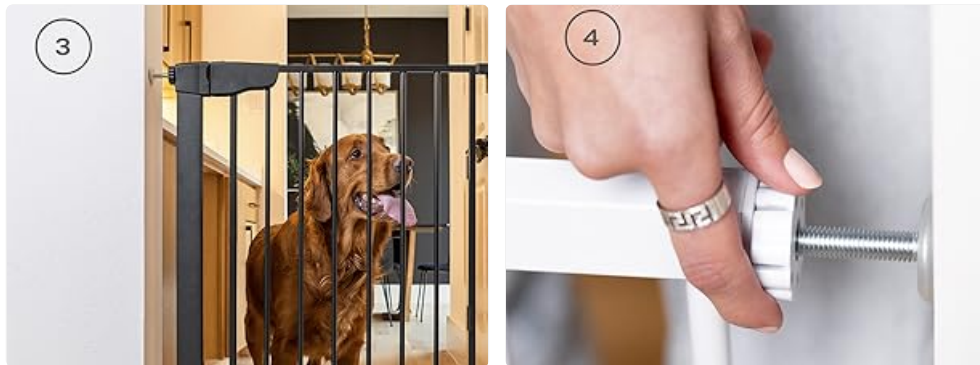

Figure 4.2: The initial gap (left) and closed gap (right) after tightening tension bolts.

### 4.3 Hardware-Mount Installation (Optional for Added Security)

For permanent installation or use at the top of stairs, hardware mounting is recommended.

1. **Mark Holes:** Place the gate in the desired location and use a pencil to mark the position of the screw holes for the wall cups (D).
2. **Install Wall Anchors:** Use a drill to create pilot holes. Insert the wall anchors (I) into the holes and tap them flush with a hammer.



Figure 4.3: Installing wall anchors for hardware mounting.

3. **Attach Wall Cups:** Attach the wall cups (D) to the wall using the screws (J) and a screwdriver or drill.



Figure 4.4: Attaching wall cups and inserting tension bolts.

4. **Insert and Tighten Tension Bolts:** Insert the tension bolts (C) into the gate and then into the attached wall cups. Rotate the tension bolts clockwise to increase pressure until the gate is firmly secured.
5. **Remove Zip Tie:** Once the gate is fully secure and the gap is closed, remove the zip tie.

#### 4.4 Installation on Rounded Banisters (Optional)

For rounded banisters, use the optional stair tension bolts (G) and U-cups (H) instead of standard tension bolts and wall cups. These components are designed to provide a secure fit on curved surfaces.



Figure 4.5: Y-pressure mount for rounded banisters and standard pressure mount.

## 5. OPERATING INSTRUCTIONS

The Cumbor Baby Gate is designed for ease of use while maintaining high safety standards.

### 5.1 Opening the Gate

To open the gate, simultaneously press the button on the top of the handle and lift the gate door. The double-lock safety release mechanism requires two actions, making it difficult for children to open.



### Double-lock safety release

Enhanced security prevents unwanted gate openings by children or pets

Figure 5.1: Operating the double-lock safety release.

### 5.2 Auto-Close and 180-Degree Door Swing

The gate features an auto-close function, meaning it will automatically swing shut and lock when opened less than 90 degrees. If opened past 90 degrees, the gate will remain open, providing convenient walk-through access. The door swings in both directions (180 degrees).



Figure 5.2: Auto-close and 180-degree door swing functionality.

### 5.3 Accessible Ramp

An accessible ramp (E) is included to minimize tripping hazards over the bottom bar, making it easier to walk through, especially when pushing a stroller or carrying items.



## Accessible Ramp

Our accessible ramp installs in seconds allowing you to breeze through the gate with ease

Figure 5.3: Accessible ramp for easy passage.

## 6. MAINTENANCE

---

To ensure the longevity and proper function of your Cumbor Baby Gate, follow these maintenance guidelines:

- **Cleaning:** Wipe the gate with a soft, damp cloth and mild soap. Do not use abrasive cleaners or harsh chemicals, as these can damage the finish.
- **Regular Checks:** Periodically inspect all parts, including the tension bolts, locking mechanism, and hinges, to ensure they are secure and functioning correctly. Tighten any loose bolts as needed.
- **Lubrication:** If the gate hinges become stiff, apply a small amount of silicone-based lubricant to ensure smooth operation.
- **Storage:** If storing the gate, disassemble it carefully and keep all components in a dry, safe place to prevent damage or loss.

## 7. TROUBLESHOOTING

---

If you encounter issues with your Cumbor Baby Gate, refer to the following common solutions:

| Problem | Possible Cause | Solution |
|---------|----------------|----------|
|---------|----------------|----------|

| Problem   | Possible Cause  | Solution   |
|---|---|--|
| Gate does not close or latch properly.                    | Tension bolts are not tight enough; gate is not level.            | Ensure tension bolts are tightened evenly until the gap between the door and frame is closed and the latch engages securely. Check that the gate is level. |
| Gate feels unstable or wobbly.                            | Insufficient pressure from tension bolts; incorrect installation. | Retighten all four tension bolts evenly. If using hardware mount, ensure wall cups are securely fastened.  |
| Gap between gate door and frame remains after tightening. | This is a design feature before full tightening.                  | Continue tightening the tension bolts evenly until the gap closes completely and the latch mechanism aligns.   |
| Gate is difficult to open or close.                       | Over-tightened tension bolts; hinges need lubrication.            | Slightly loosen tension bolts if over-tightened. Apply silicone lubricant to hinges if stiff.  |

## 8. SPECIFICATIONS

---

- **Model Number:** S7V2
- **Material:** Metal
- **Color:** Black
- **Product Dimensions:** 29.7-46 inches (Width) x 30.5 inches (Height)
- **Mounting Type:** Pressure Mounted (with optional hardware mounting)
- **Item Weight:** 14.27 pounds
- **Age Range (Description):** 6-24 Months
- **Additional Features:** Dual Lock, Auto Close, Two-Way Access, Walk Through, Accessible Ramp, Optional Hardware Mounting, Y-Mount for Rounded Banisters
- **UPC:** 696177815747

## 9. WARRANTY AND SUPPORT

---

For warranty information or technical support, please refer to the official Cumbor website or contact Cumbor customer service directly. You can also find a digital version of this user guide and other support documents at <https://manuals.plus/m/85332f75d0d363a238351610b301c5580b4d56f422e23a571fa76df457152cd0>.