

hygger Sponge Filter Instruction Manual

Model: petdogteehww1-04

For 10 to 40-gallon tanks (Size S)

1. INTRODUCTION

This manual provides instructions for the proper setup, operation, and maintenance of your hygger Sponge Filter. This filter is designed to provide both mechanical and biological filtration for your aquarium, contributing to a healthy aquatic environment. Please read these instructions thoroughly before use.



Image 1.1: The hygger Sponge Filter, illustrating its dual sponge design and water flow.

2. PRODUCT FEATURES

- **Biochemical Filtration:** Utilizes an air pump (not included) to power multi-level filtration. The sponge absorbs fine particles for mechanical filtration, while the ceramic balls provide surface area for beneficial bacteria, ensuring biological filtration. The water flow is gentle, preventing stress to fish.
- **Changeable Filter Material:** Features two types of replaceable filter media: sponge and ceramic filter balls. Sponges can be easily removed for cleaning or replacement. Includes 4 sponges in total. Two media boxes are provided for ceramic filters or other media.
- **Adjustable Design:** The outlet pipe can be adjusted to change the direction and height of the water flow. The bottom direction is 360 degrees rotatable for flexible placement.
- **Quiet Operation:** Designed for ultra-quiet performance, minimizing disturbance to your aquatic environment.
- **Secure Installation:** Equipped with strong suction cups for secure attachment to the aquarium wall.



Image 2.1: Key features of the hygger Sponge Filter, including 360-degree rotatable parts, replaceable filter boxes, height-adjustable tube, double suction cups, and biological filter cotton.

3. PACKAGE CONTENTS

Please verify that all items are present and in good condition upon opening the package:

- Dual Sponge Filter Unit
- 4 x Biochemical Sponges (2 pre-installed, 2 spare)
- 1 Bag of Filtered Ceramic Balls
- Air Outlet Tube (Height-adjustable telescopic tube)
- 2 x Suction Cups

WHERE IS THE EXTRA SPONGE



Image 3.1: Illustration of the package contents, highlighting the spare sponges and ceramic balls.

4. SETUP INSTRUCTIONS

Follow these steps to assemble and install your Hygger Sponge Filter:

1. **Unpack Components:** Carefully remove all filter parts from the packaging.
2. **Remove Sponges:** Gently slide the two sponges off the filter pipes.
3. **Open Media Lids:** Open the lids of the two media containers located at the base of the sponges.
4. **Remove Spare Sponges:** Take out the two spare sponges from inside the containers and set them aside. These are for future replacement.
5. **Fill Media Containers:** Fill each of the two media containers approximately 2/3 full with the provided ceramic media balls.
6. **Reattach Sponges:** Slide the main sponges back onto the filter pipes, ensuring they are securely seated over the media containers.
7. **Install Suction Cups:** Attach the two suction cups onto the air outlet tube. Press firmly to secure them.
8. **Insert Air Outlet Tube:** Insert the assembled air outlet tube into the central connection point of the filter base.
9. **Connect Air Hose:** Connect a 4mm air hose (not included) to the end of the air outlet tube and the other end to an air pump (not included).

Dual Sponge Aquarium Filter Assembly Steps

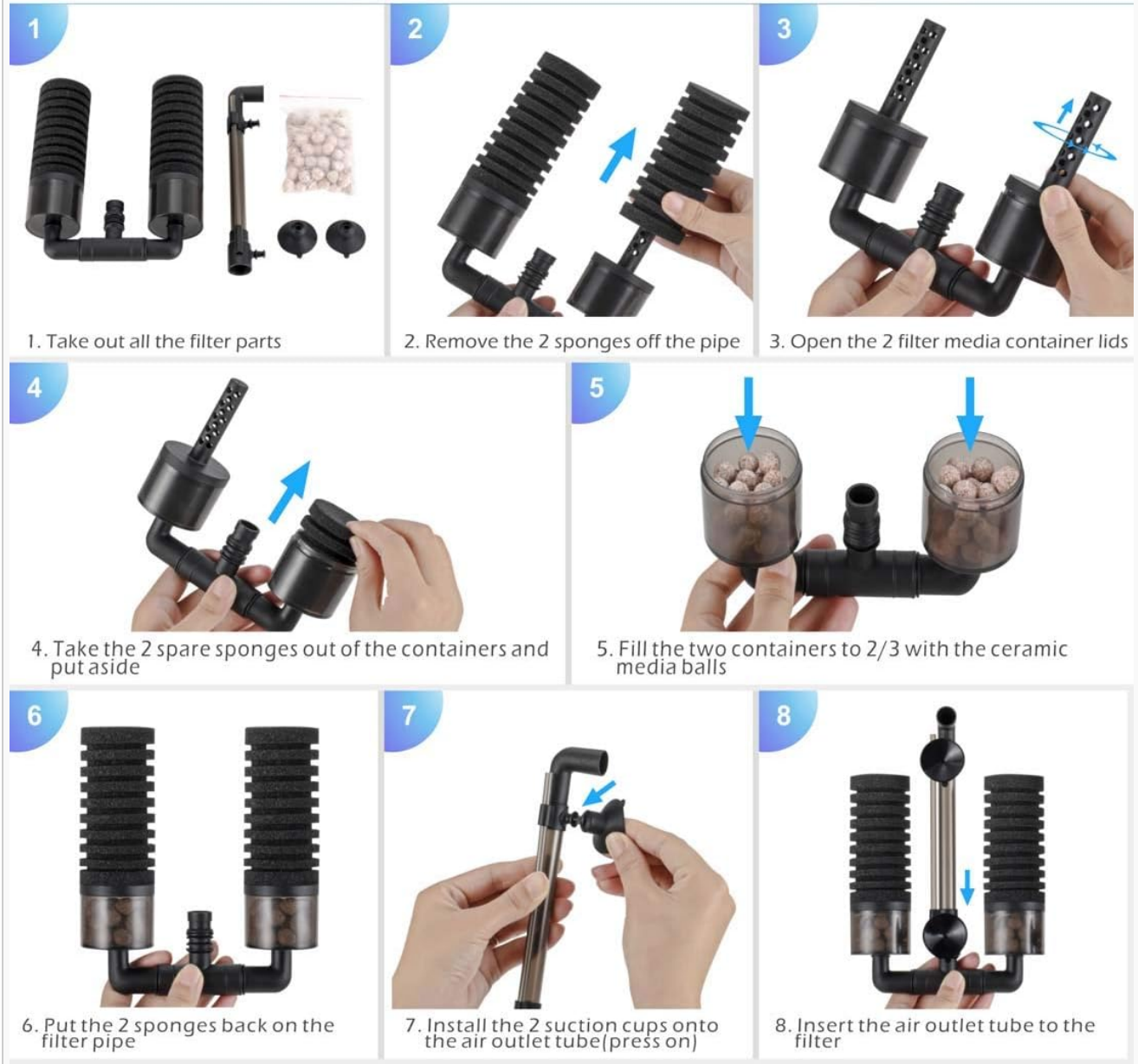

Image 4.1: Visual guide for assembling the dual sponge aquarium filter.



Image 4.2: The hygger sponge filter installed in an aquarium, connected to an external air pump.

5. OPERATING INSTRUCTIONS

Once assembled and installed, operate the filter as follows:

1. **Placement:** Submerge the filter completely in your aquarium. Use the suction cups to secure it to the tank wall.
2. **Air Pump Connection:** Ensure the air hose is securely connected to both the filter and your air pump.
3. **Power On:** Plug in and turn on your air pump. Air will be pushed through the filter, creating bubbles and drawing water through the sponges and media.
4. **Adjust Water Flow:** The outlet pipe can be rotated 360 degrees and adjusted in height to direct the water flow as desired. This allows for customization to suit different tank inhabitants and setups.

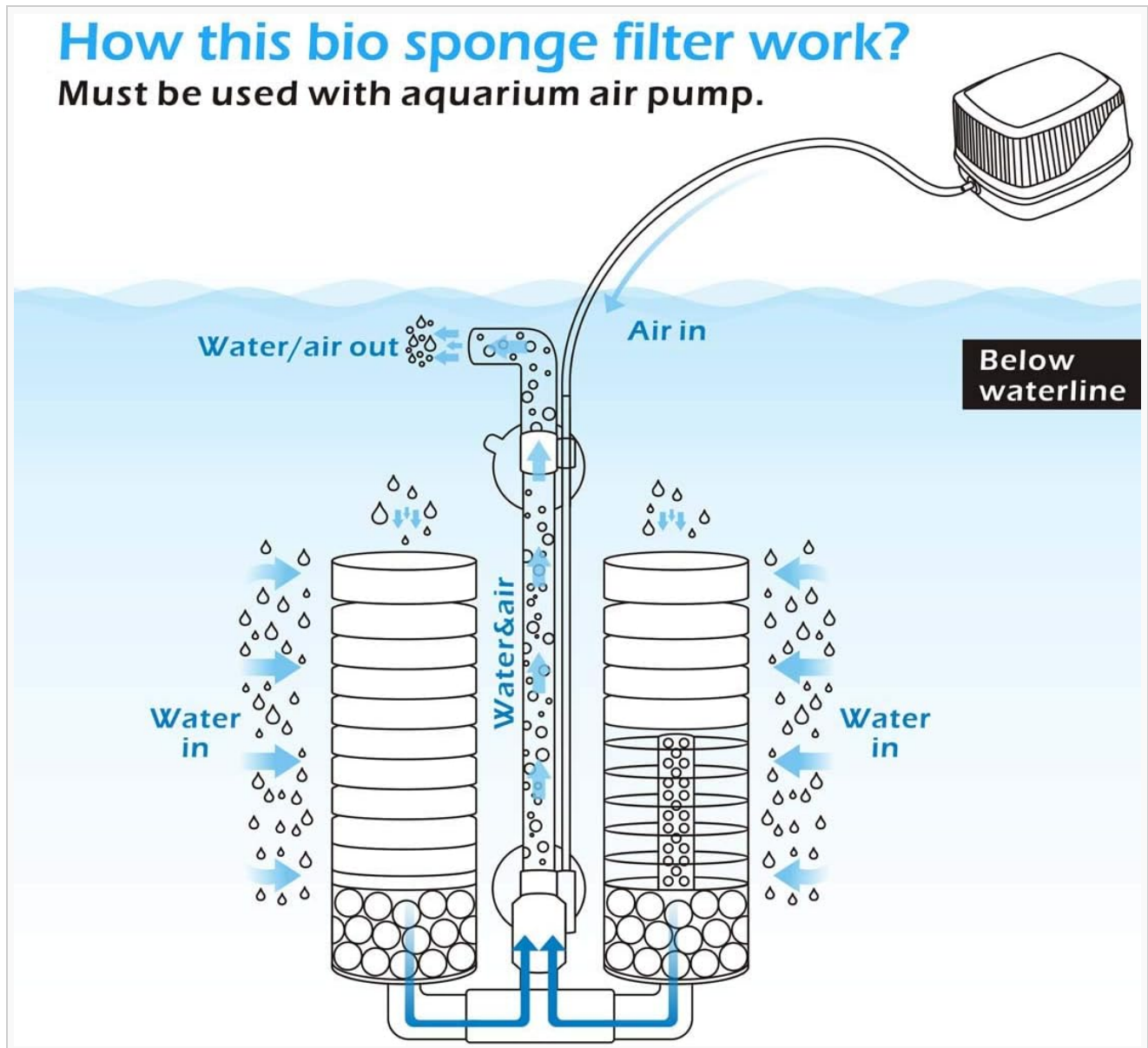

Image 5.1: Operational diagram showing water and air flow through the sponge filter, powered by an external air pump.

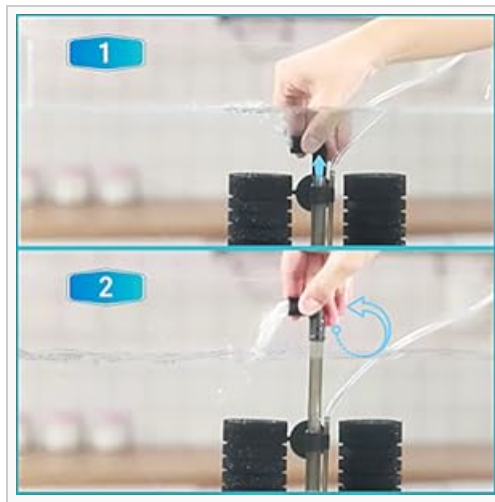

Image 5.2: Demonstration of the adjustable water flow feature, allowing users to change the direction of the output.

6. MAINTENANCE

Regular maintenance is crucial for optimal filter performance and water quality:

- **Sponge Cleaning:** Periodically, or when water flow decreases, remove the sponges from the filter. Gently rinse them in old aquarium water (from a water change) to preserve beneficial bacteria. Avoid using tap water directly, as chlorine can harm bacteria.
- **Sponge Replacement:** Replace sponges when they become too worn or clogged to clean effectively. Use the provided spare sponges.
- **Ceramic Media:** The ceramic balls rarely need cleaning. If necessary, rinse them gently in old aquarium water. Do not replace them unless they are physically damaged.
- **Filter Unit Cleaning:** Occasionally, wipe down the hard plastic parts of the filter to remove any algae or debris buildup.



Image 6.1: Instructions for removing the sponges from the filter unit for cleaning or replacement.

7. TROUBLESHOOTING

If you encounter issues with your hygger Sponge Filter, consider the following:

- **No Air Bubbles/Low Flow:**
 - Check if the air pump is powered on and functioning correctly.

- Ensure the air hose is not kinked or blocked.
- Verify that the connection between the air hose and the filter is secure.
- Clean the sponges, as they may be clogged with debris.
- Ensure the air stone (if used with the air pump) is not clogged.

- **Filter Detaches from Tank Wall:**

- Ensure the suction cups are clean and free of algae or debris.
- Press the suction cups firmly against a clean, smooth glass surface.
- If suction cups are old or damaged, they may need replacement.

- **Noisy Operation:**

- Ensure the air pump itself is not the source of the noise.
- Check that the filter is fully submerged and not vibrating against the tank glass.
- If the air outlet is above the waterline, it may create splashing noise. Adjust the height or direction if desired.

8. SPECIFICATIONS

Specification	Detail (Size S)
Product Dimensions (W x H)	6 inches (width) x 9 to 13 inches (height, adjustable)
Sponge Inside Circle Diameter	0.39 inches
Ceramic Media Balls Weight	0.25 lbs (0.8-1cm size)
Air Tube Size Compatibility	4mm
Recommended Tank Size	10 to 40-gallon tank
Item Weight	10.6 ounces
Model Number	petdogteehww1-04
ASIN	B07VTT5CJM

Small











Image	Size Name	Small Filter
	Hole diameter of the sponge	0.39inch
	Weight of ceramic media balls (0.8-1cm)	0.25lbs
	Air tube size	4mm
For tank size (Buy 2 more filters for tank large than 60Gal)		10-40Gal

Image 8.1: Detailed dimensions and specifications for the small size hygger sponge filter.

9. WARRANTY AND SUPPORT

For warranty information or technical support, please refer to the contact details provided with your purchase or visit the official hygger website. Keep your purchase receipt for warranty claims.

© 2025 hygger. All rights reserved.

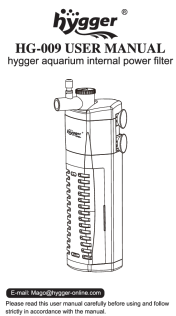
 <p>Hygger aquarium biochemical sponge filter is a type of hanging filter. It is perfect for all types of aquarium tanks and fishes.</p>	<p>Hygger HG-908 Aquarium Biochemical Sponge Filter User Manual</p> <p>User manual for the Hygger HG-908 Aquarium Biochemical Sponge Filter, detailing features, specifications, installation, maintenance, and warranty for aquarium enthusiasts.</p>
 <p>E-mail: info@hyggeraquarium.com Website: www.hyggeraquarium.com</p>	<p>Hygger HG903 Ceramic Bio Media Blocks User Manual</p> <p>User manual for the Hygger HG903 Ceramic Bio Media Blocks, detailing product features, specifications, application methods, warnings, and warranty information for aquarium filtration.</p>
 <p>E-mail: info@hyggeraquarium.com Website: www.hyggeraquarium.com</p>	<p>Hygger HG176 USB Electric Aquarium Sponge Filter User Manual</p> <p>Comprehensive user manual for the Hygger HG176 USB Electric Aquarium Sponge Filter, detailing product features, specifications, installation instructions, maintenance, warnings, warranty information, disposal guidelines, and contact details.</p>
 <p>Hygger USB Electric Aquarium Sponge Filter is a versatile device that serves as a filter, oxygenator, and water circulator, ideal for various aquarium tanks and fish species. PLEASE NOTE: THE PACKAGE DOES NOT INCLUDE A DC 5V 1A ADAPTER.</p>	<p>Hygger HG176 USB Electric Aquarium Sponge Filter User Manual</p> <p>User manual for the Hygger HG176 USB Electric Aquarium Sponge Filter, detailing its features, specifications, installation, maintenance, and disposal. This versatile device serves as a filter, oxygenator, and water circulator for various aquarium tanks.</p>
 <p>The hygger backpack aquarium filter with built-in waste collector contains chemical, biological, and water change media's perfect for use in medium-sized fish tanks and turtle tanks.</p>	<p>Hygger HG150 Backpack Aquarium Filter User Manual</p> <p>Comprehensive user manual for the Hygger HG150 Backpack Aquarium Filter, detailing product features, installation instructions, troubleshooting, cleaning, and specifications for optimal aquarium maintenance.</p>
 <p>Please read this user manual carefully before using and follow strictly in accordance with the manual.</p>	<p>Hygger 009 Aquarium Internal Power Filter User Manual</p> <p>Comprehensive user manual for the Hygger 009 internal power filter, covering features, technical specifications, installation, operation, and maintenance for freshwater and saltwater aquariums.</p>